

TRI-SLIDE BETA COMPONENTS

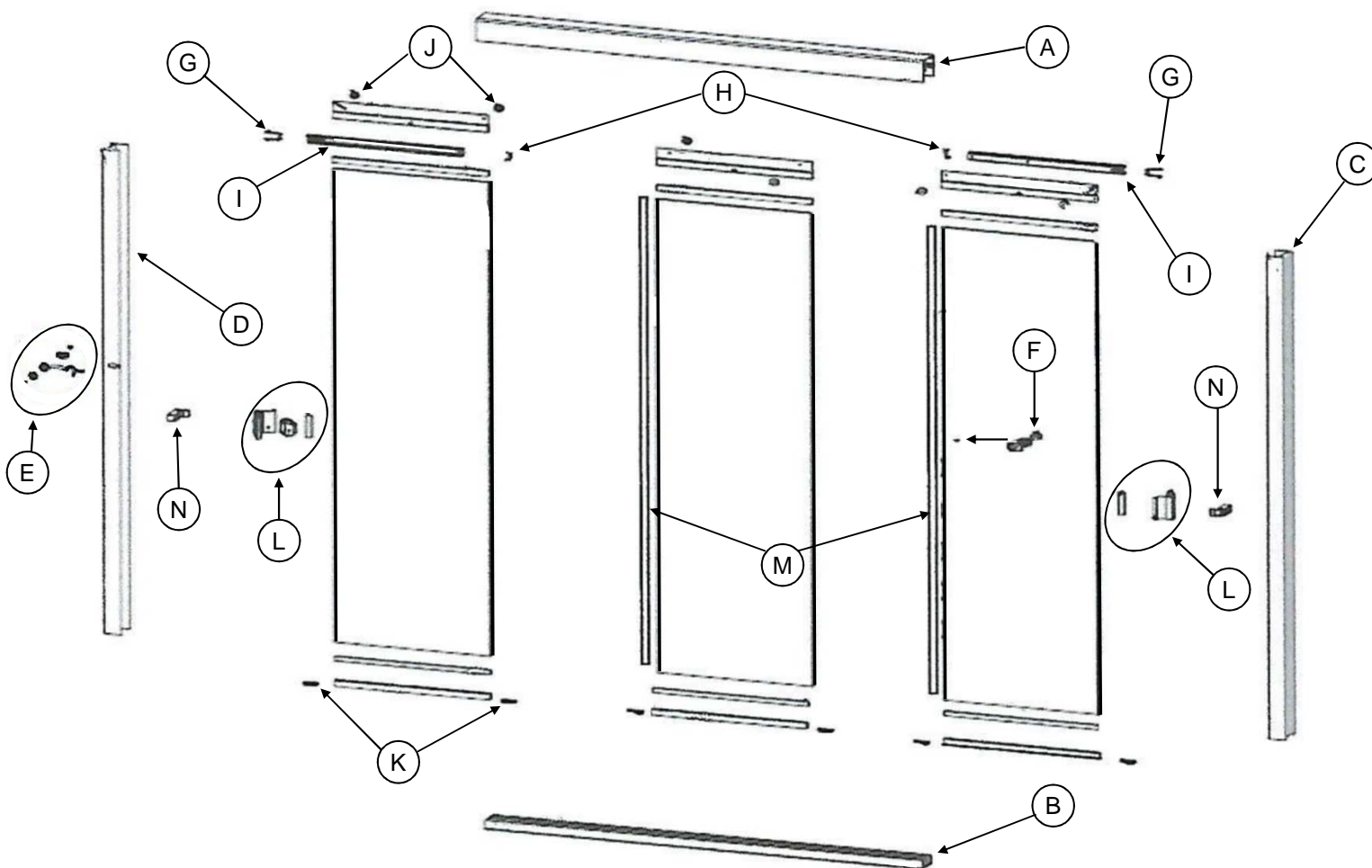

FIGURE PART NUMBER DESCRIPTION

A	TRI-HDR-BN	Header (Brushed Nickel - Must cut to size)
	TRI-HDR-DZ	Header (Dark Bronze - Must cut to size)
	TRI-HDR-PT	Header (Platinum - Must cut to size)
B	TRI-SILL-BN	Sill (Brushed Nickel - Must cut to size)
	TRI-SILL-DZ	Sill (Dark Bronze - Must cut to size)
	TRI-SILL-PT	Sill (Platinum - Must cut to size)
C	1066-01-BN	Wall Jamb - Non Latch Side (Brushed Nickel)
	1066-01-DZ	Wall Jamb - Non Latch Side (Dark Bronze)
	1066-01-PT	Wall Jamb - Non Latch Side (Platinum)
D	1066-02-BN	Wall Jamb - W/Latch (Brushed Nickel)
	1066-02-DZ	Wall Jamb - W/ Latch (Dark Bronze)
	1066-02-PT	Wall Jamb - W/ Latch (Platinum)
E	I-152-DZ	Travel Latch Assembly (Dark Bronze)
	I-152-BS	Travel Latch Assembly (Polished Silver)
F	3SB-CATCH	Travel Latch Knob/Catch Assembly
G	TRI-LG-CLIP-4PK	Large Stop-Clip Assembly 4-Pack
H	TRI-SM-CLIP-4PK	Small Stop-Clip Assembly 4-Pack
I	1069-SET	Roller Track Pair (L&R)
J	TRI-TOP-RLR-8PK	Top Roller 8-Pack W/ Hardware
K	TRI-BTM-RLR-6PK	Bottom Roller Assembly 6-Pack
L	TRI-HNDL-SET-BN	Handle Pair (L&R) W/ Inner Vinyl (Brushed Nickel)
	TRI-HNDL-SET-DZ	Handle Pair (L&R) W/ Inner Vinyl (Dark Bronze)
	TRI-HNLD-SET-PT	Handle Pair (L&R) W/ Inner Vinyl (Platinum)
M	TRI-GAP-VNL-RND	Bulb Gap Seal (For Textured Glass)
	V-64	Straight Fin Gap Seal (For Clear Glass)
N	TRI-HB-DZ	Hardware Bag (Dark Bronze)
	TRI-HB-PT	Hardware Bag (Platinum)