

Note:
On each pair of jacks in this system, one jack will have (1) 1124 fitting and the other will have (2) 1124 fittings.

Equalizer

55169 COUNTY ROAD 3
ELKHART, IN 46515

NOTICE - This drawing, including principles of design, is the property of Days Corporation, Elkhart, Indiana, with the agreement that it is not to be reproduced, copied, or loaned in any manner that may constitute a detriment directly or indirectly to Days Corporation. Acceptance of this will be construed as an agreement of the above.

#	REVISIONS	BY:	DATE:

UNLESS OTHERWISE
SPECIFIED:
TOLERANCES:
.XXX ± 0.010
.XX ± 0.010
.X ± 0.030
ANG. ± 1/2"
REMOVE ALL BURRS AND
SHARP EDGES .015 MAX

TITLE			USED ON:		
MH 16 SL LEG ASSEMBLY			NEWMAR		
SIZE	SCALE	MATERIAL	NOTED		
A	1: 1	AS			
DRW BY:	DATE:	PART NAME:			
SJ	3/30/12	MH 16 SL LEG ASSEMBLY			
APP'D BY	DATE:	PAGE:	DWG NO.:	REV:	
-	-	2 OF 3	P7214/7761	-	

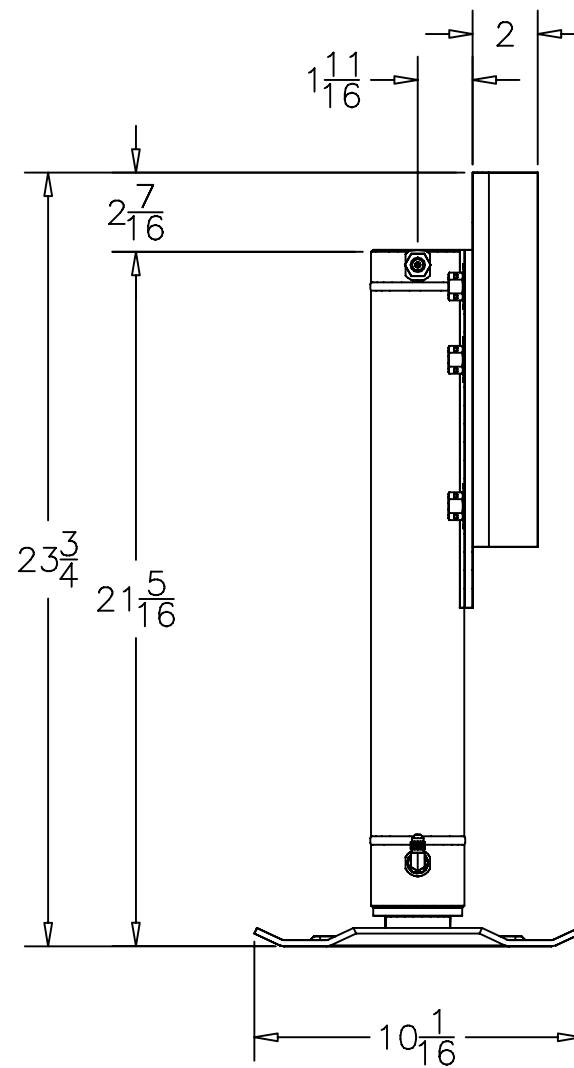
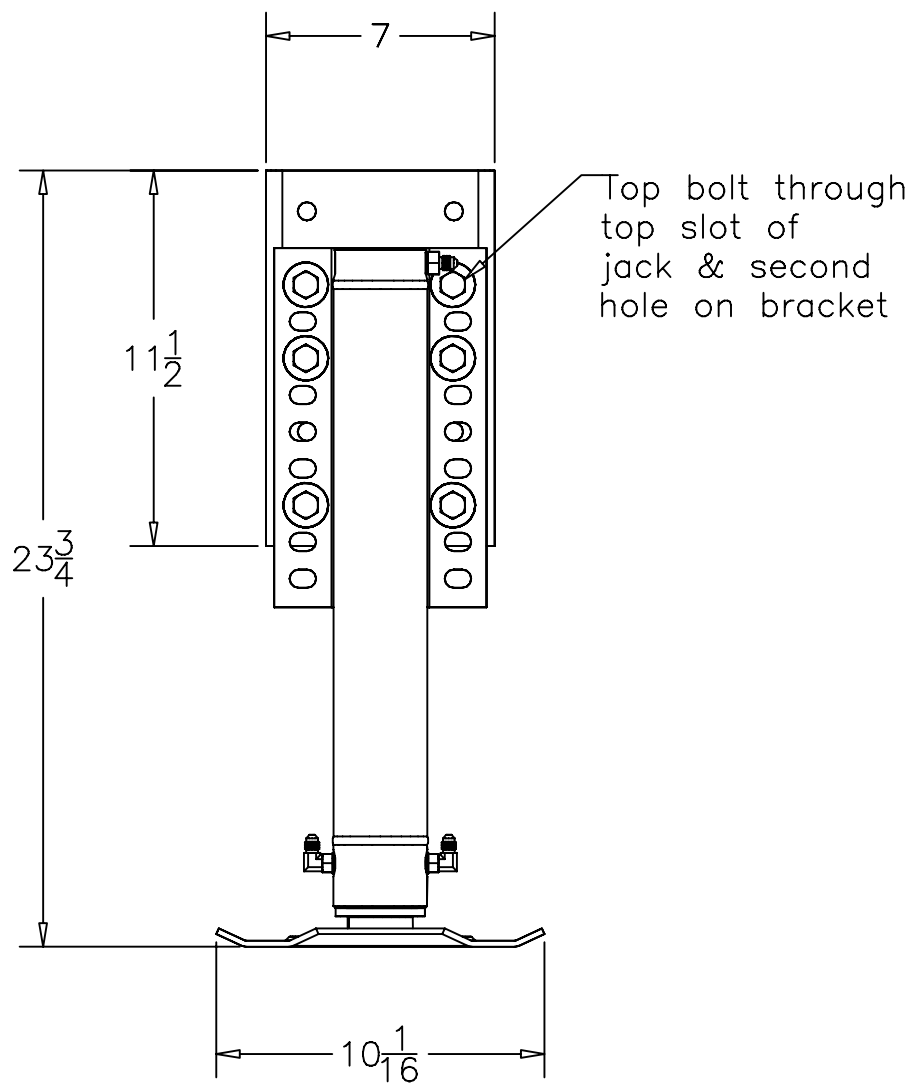

Equalizer

55169 COUNTY ROAD 3
ELKHART, IN 46515

NOTICE - This drawing, including principles of design, is the property of Days Corporation, Elkhart, Indiana, with the agreement that it is not to be reproduced, copied, or loaned in any manner that may constitute a detriment directly or indirectly to Days Corporation. Acceptance of this will be construed as an agreement of the above.

#	REVISIONS	BY:	DATE:

UNLESS OTHERWISE SPECIFIED:
TOLERANCES:
.XXX \pm 0.010
.XX \pm 0.010
.X \pm 0.030
ANG. \pm 1/2"
REMOVE ALL BURRS AND SHARP EDGES .015 MAX

TITLE MH 16 SL LEG ASSEMBLY		USED ON: NEWMAR	
SIZE A	SCALE 1: 1	MATERIAL AS NOTED	
DRW BY: SJ	DATE: 3/30/12	PART NAME: MH 16 SL LEG ASSEMBLY	
APP'D BY -	DATE: -	PAGE: 3 OF 3	DWG NO.: P7214/7761
		REV:	-

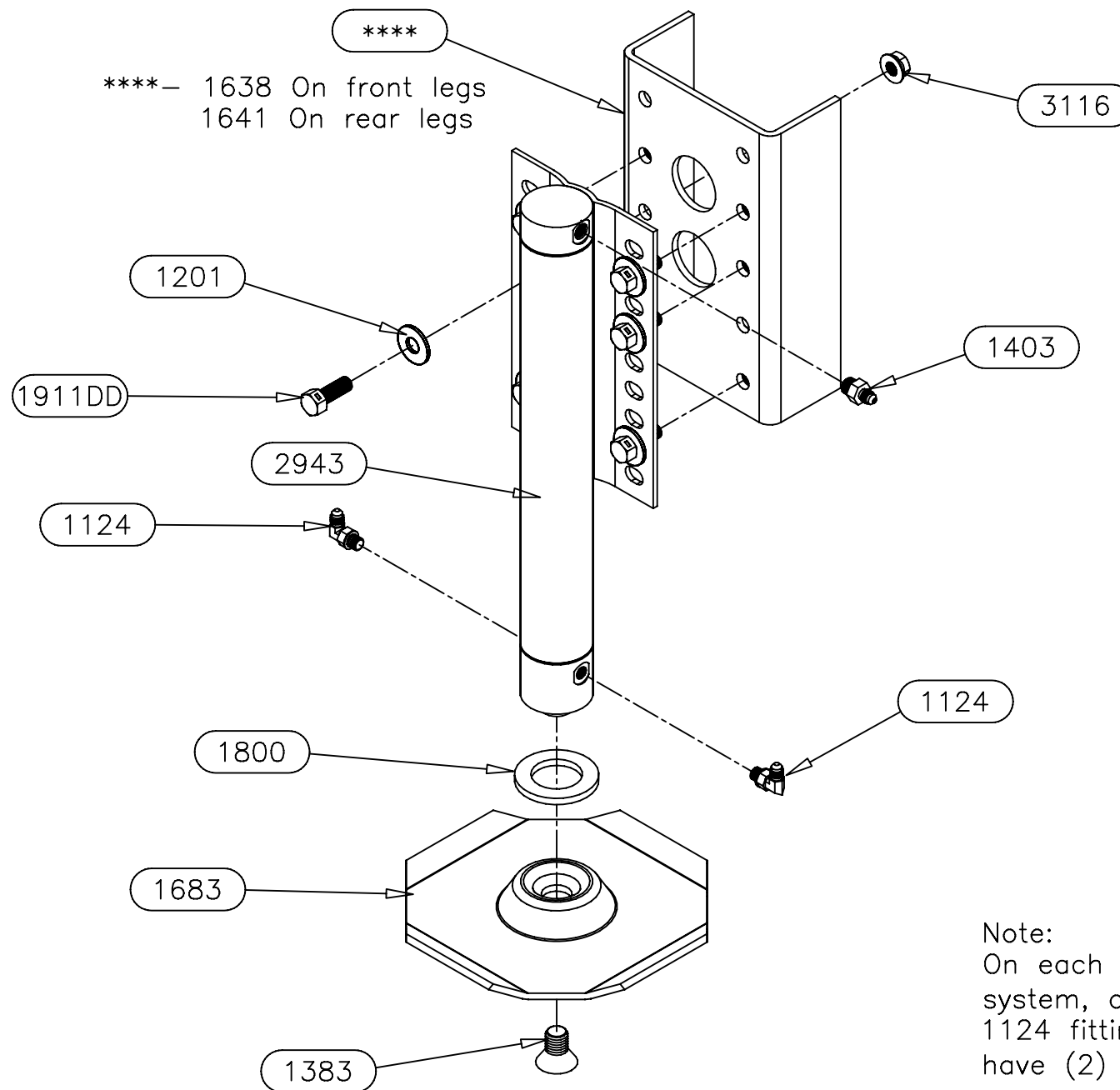

Note:
On each pair of jacks in this system, one jack will have (1) 1124 fitting and the other will have (2) 1124 fittings.

Equalizer

55169 COUNTY ROAD 3
ELKHART, IN 46515

NOTICE - This drawing, including principles of design, is the property of Days Corporation, Elkhart, Indiana, with the agreement that it is not to be reproduced, copied, or loaned in any manner that may constitute a detriment directly or indirectly to Days Corporation. Acceptance of this will be construed as an agreement of the above.

#	REVISIONS	BY:	DATE:
A	Updated hardware	SJ	4/6/12
B	Added dimensions	SJ	2/6/13

UNLESS OTHERWISE
SPECIFIED:
TOLERANCES:
.XXX ± 0.010
.XX ± 0.010
.X ± 0.030
ANG. ± 1/2"
REMOVE ALL BURRS AND
SHARP EDGES .015 MAX

TITLE			USED ON:		
MH 15 SL LEG ASSEMBLY			NEWMAR		
SIZE	SCALE	MATERIAL			
A	1: 1	AS NOTED			
DRW BY:	DATE:	PART NAME:			
SJ	5/3/11	MH 15 SL LEG ASSEMBLY			
APP'D BY	DATE:	PAGE:	DWG NO.:	REV:	
—	—	2 OF 3	P7636/7761	B	

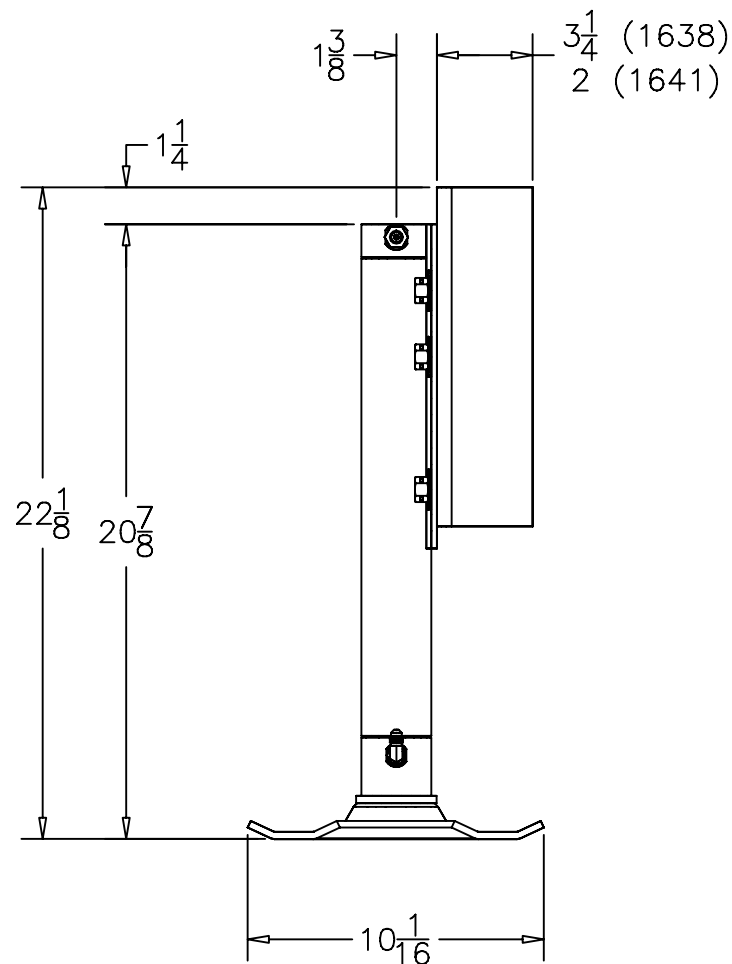
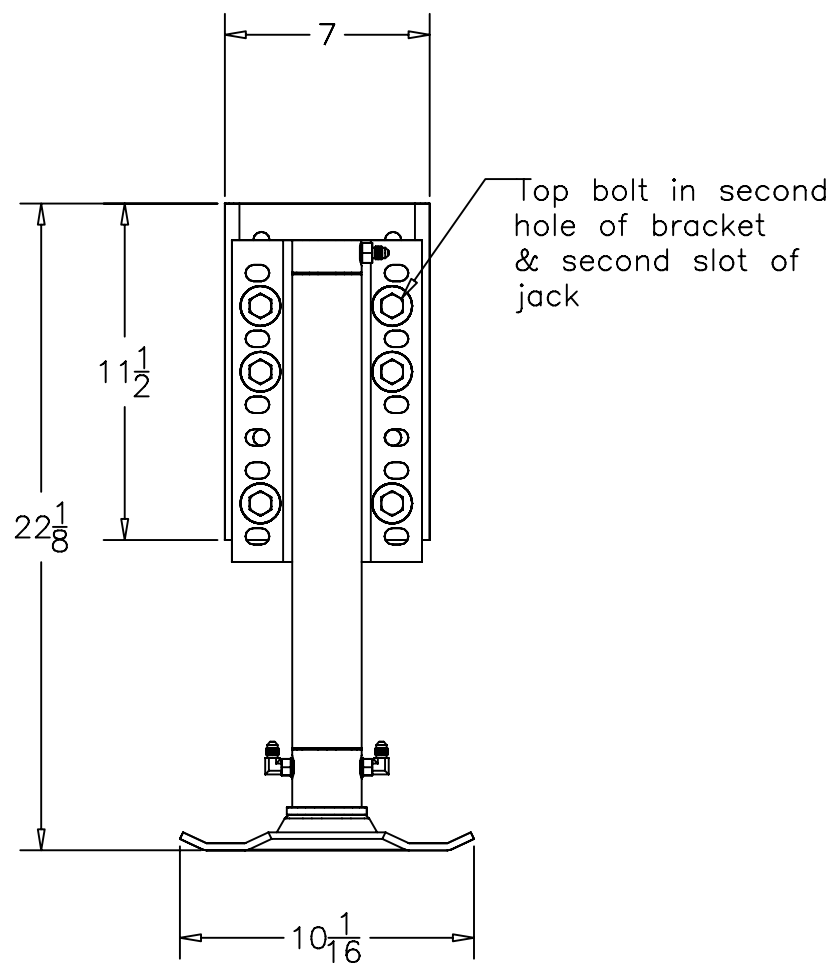

Equalizer

55169 COUNTY ROAD 3
ELKHART, IN 46515

#	REVISIONS	BY:	DATE:
A	Updated hardware	SJ	4/6/12
B	Added dimensions	SJ	2/6/13

NOTICE - This drawing, including principles of design, is the property of Days Corporation, Elkhart, Indiana, with the agreement that it is not to be reproduced, copied, or loaned in any manner that may constitute a detriment directly or indirectly to Days Corporation. Acceptance of this will be construed as an agreement of the above.

UNLESS OTHERWISE
SPECIFIED:
TOLERANCES:
.XXX ± 0.010
.XX ± 0.010
.X ± 0.030
ANG. ± 1/2"
REMOVE ALL BURRS AND
SHARP EDGES .015 MAX

TITLE MH 15 SL LEG ASSEMBLY		USED ON: NEWMAR	
SIZE A	SCALE 1: 1	MATERIAL AS NOTED	
DRW BY: SJ	DATE: 5/3/11	PART NAME: MH 15 SL LEG ASSEMBLY	
APP'D BY -	DATE: -	PAGE: 3 OF 3	DWG NO.: P7636/7761 REV: B