

F I S H E R & P A Y K E L

SINGLE DISHDRAWER™ DISHWASHER

DD24SI, DD24STI & DD24SHTI models

INSTALLATION GUIDE

US CA

591386 A 08.17

⚠ WARNING!	
	<p>Electrical Shock Hazard Before installing the dishwasher, remove the house fuse or open the circuit breaker. If permanently connecting the dishwasher, be sure the power is isolated and the dishwasher unplugged.</p>
	<p>GROUNDING INSTRUCTIONS This appliance must be grounded. In the event of a malfunction or breakdown, grounding will reduce the risk of electric shock by providing a path of least resistance for electric current. This appliance is equipped with a cord having an equipment-grounding conductor and a grounding plug. The plug must be plugged into an appropriate outlet that is installed and grounded in accordance with all local codes and ordinances. WARNING - Improper connection of the equipment-grounding conductor can result in a risk of electric shock. Check with a qualified electrician or service representative if you are in doubt as to whether the appliance is properly grounded.</p>
	<p>If the dishwasher is installed as a permanently connected appliance: GROUNDING INSTRUCTIONS - This appliance must be connected to a grounded metal, permanent wiring system, or an equipment-grounding conductor must be run with the circuit conductors and connected to the equipment-grounding terminal or lead on the appliance. Do not modify the power supply plug provided with the appliance - if it will not fit the outlet, have a proper outlet installed by a qualified electrician. Do not use an extension cord, adapter plug or multiple outlet box. Failure to follow this advice may result in electrical shock or death.</p>

⚠ WARNING!	
<p>Fitting integrated front panels requires access to electrical service areas. This work must be performed and certified by a qualified electrical service technician.</p>	
	<p>Electrical Shock Hazard WARNING: To reduce the risk of electrical shock, fire, or injury to persons, the installer must ensure that the dishwasher is completely enclosed at the time of installation. Before fitting the front panels and connecting the 'knock to pause' module (if necessary), the installer must ensure that the dishwasher is disconnected from the power supply. After installing the front panels, the installer must ensure that the following components are electrically grounded: the panel bracket and any custom metal component (e.g. handle) that extends past the rubber seal. Failure to follow these warnings may result in electrical shock, injury or fire.</p>

⚠ WARNING!	
	<p>Cut Hazard Take care - panel edges are sharp. Failure to use caution could result in injury or cuts.</p>

IMPORTANT SAFETY INSTRUCTIONS

- Installation of this dishwasher requires basic mechanical and electrical skills.
- Be sure to leave these Instructions with the Customer.
- Installation must comply with your local building, electricity, and plumbing regulations.
- At the completion of the dishwasher installation, the Installer must perform the Final Checklist.
- Remove all packaging materials supplied with the dishwasher.
- This dishwasher is manufactured for indoor use only.
- Ensure all water connections are turned OFF. It is the responsibility of the plumber and electrician to ensure that each installation complies with all Codes and Regulations.
- The dishwasher **MUST** be installed to allow for future removal from the enclosure if service is required.
- The switched power outlet must be outside the dishwasher cavity, so that it is accessible after installation.
- Care should be taken when the appliance is installed or removed to reduce the likelihood of damage to the power supply cord and hoses.
- If the dishwasher is to be relocated from one installation to another it must be kept upright to avoid damage from water spillage.
- Make sure only new hoses are used for connection (supplied with the dishwasher). Old hoses should not be reused.
- Failure to install the dishwasher correctly could invalidate any warranty or liability claims.
- If the product is installed in a motor vehicle, boat or similar mobile facility, you must bring the vehicle, boat or mobile facility containing the product to the service shop at your expense or pay the service technician's travel to the location of the product.
- This dishdrawer is intended for connection to the hot-water supply.
- Failure to install the dishwasher correctly could invalidate any warranty or liability claims.
- Ensure the product is not plugged in when fitting custom panels.
- Installation of custom panels requires basic mechanical and electrical skills.
- Installation must comply with your local building and electricity regulations.
- Failure to install the custom panels correctly could invalidate any warranty or liability claims.

IMPORTANT! SAVE THESE INSTRUCTIONS

The models shown in this installation guide may not be available in all markets and are subject to change at any time. For current details about model and specification availability in your country, please go to our website www.fisherpaykel.com or contact your local Fisher & Paykel dealer.

2 PARTS SUPPLIED

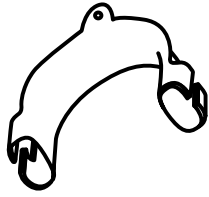

Drain hose support (1)

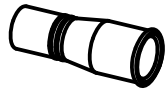

Drain hose joiner (1)



Wire clip (1)
(for securing
Drain hose joiner)



Clamp (1)
(for securing
Drain hose joiner)



Side mounting
bracket kit
(A and B) (2)
OPTIONAL

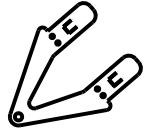

Top
mounting
brackets (2)
OPTIONAL



Phillips
16 mm
screws (7)



38 mm
bottom fixing
screws & metal
washers (2)



Rubber washer
for inlet hose (1)
(comes already
fitted)



Moisture protection
tape (1)
(to prevent moisture
damage to cabinetry)

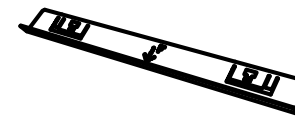

Cavity Bracket Kit (1)
(supplied with Tall
Height Models only)

(fitted before installation
in order to conceal
the gap at the top of
the cavity left after
installation.)



Edge Protector (1)
(If the services hole
is through a metal
partition, the hole must
be protected with the
Edge Protector supplied
to prevent damage to the
power cord or hoses.)

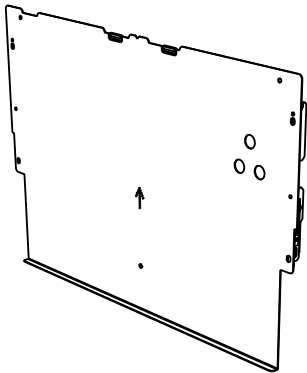

Panel bracket (1)
& Knock-to-Pause Module (1)
(shipped fixed to product)



Panel mounting
screws (6)

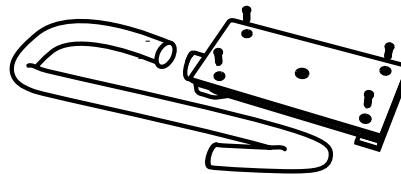

External Venting kit (1)

If the Drain hoses supplied are not long enough to reach your services, you must use a Drain Hose Extension Kit P/N 525798 which will extend the drain hoses by 11' 10" (3.6m). The kit is available from the nearest Fisher & Paykel Authorized Service Center, or Toll free 1.888.936.7872 or www.fisherpaykel.com

3 OPTIONALLY HARD WIRING PRIOR TO INSTALLATION

3-A REMOVE THE DRAWER

To prevent kinked hoses

Either sit the drawer down on the left hand side (recommended) or rotate the drawer clockwise, resting it on its side after removal.

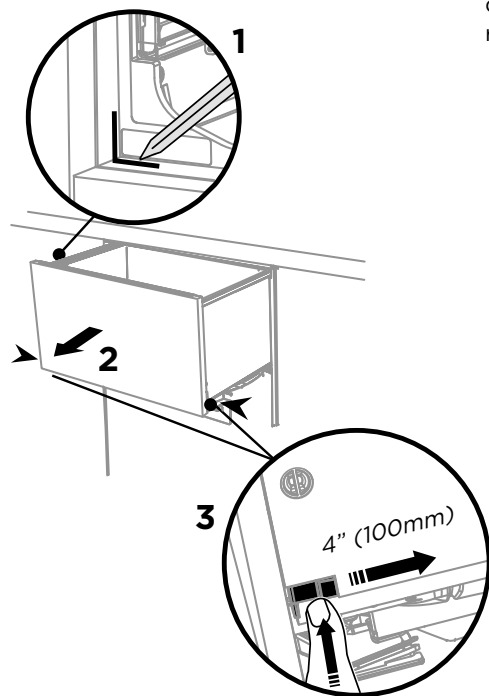

Press the release tabs in on either side and push back to release drawer from runners. Lift drawer off runners.

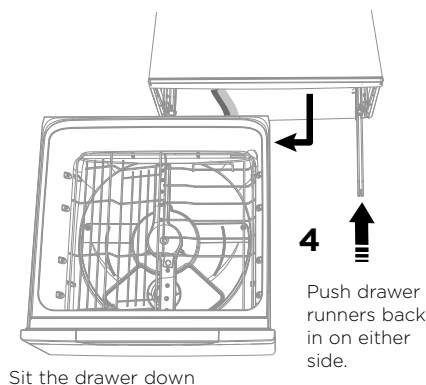

Sit the drawer down

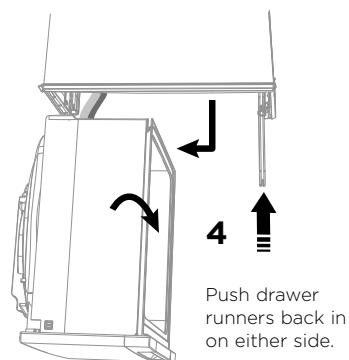

Push drawer runners back in on either side.

Rotate the drawer clockwise (max. 90°) and rest on side.

3-B REMOVE THE ACCESS COVER & REMOVE POWER

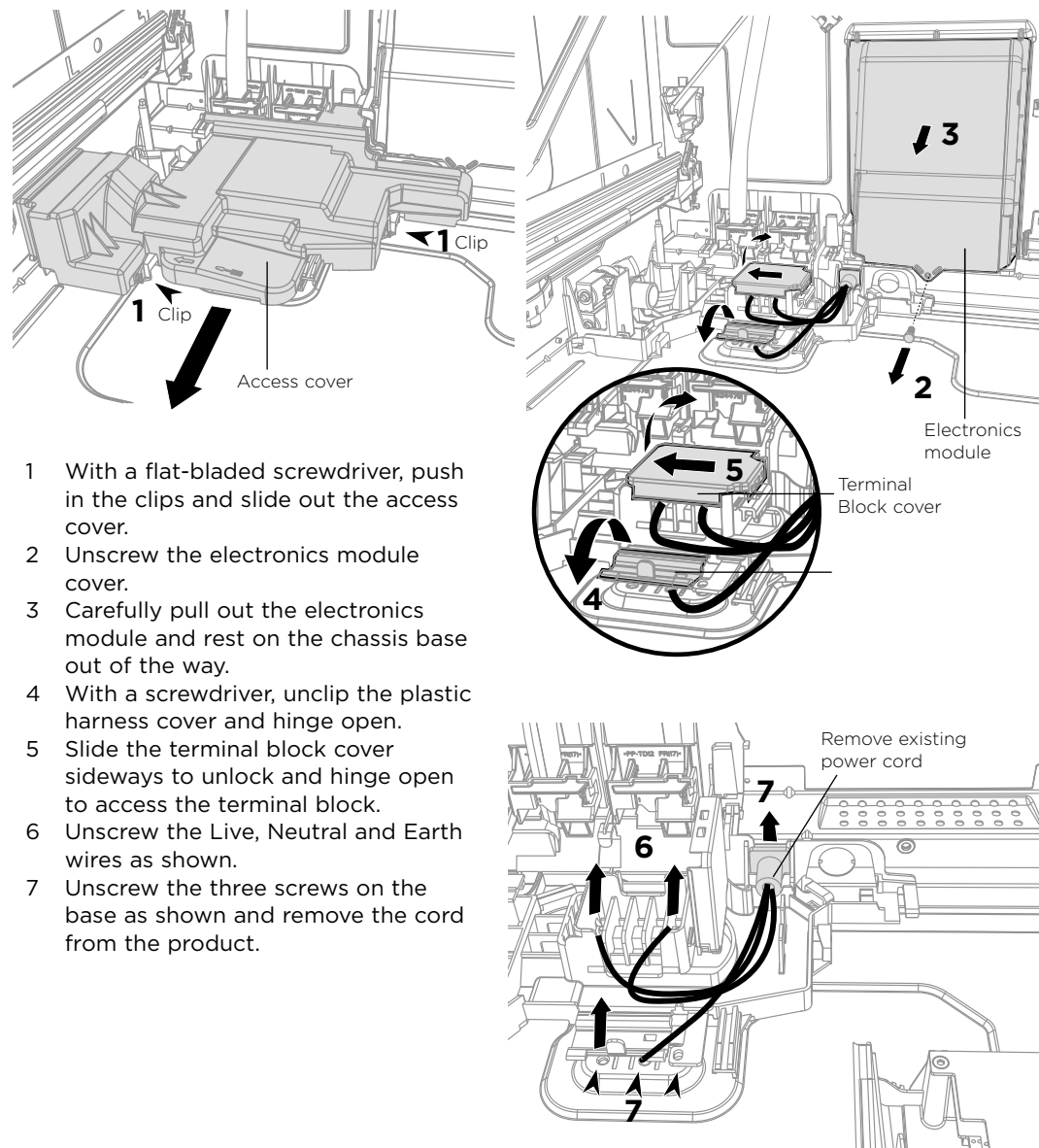

- 1 With a flat-bladed screwdriver, push in the clips and slide out the access cover.
- 2 Unscrew the electronics module cover.
- 3 Carefully pull out the electronics module and rest on the chassis base out of the way.
- 4 With a screwdriver, unclip the plastic harness cover and hinge open.
- 5 Slide the terminal block cover sideways to unlock and hinge open to access the terminal block.
- 6 Unscrew the Live, Neutral and Earth wires as shown.
- 7 Unscrew the three screws on the base as shown and remove the cord from the product.

③ OPTIONALLY HARD WIRING PRIOR TO INSTALLATION

③-C TERMINATE MAINS WIRING AS SHOWN AND REPLACE MODULE AND COVERS

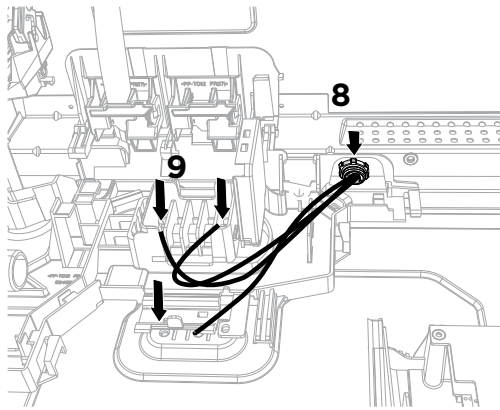

IMPORTANT!

Ensure the mains wires are routed **UNDERNEATH** all other harness wiring from the electronics module.

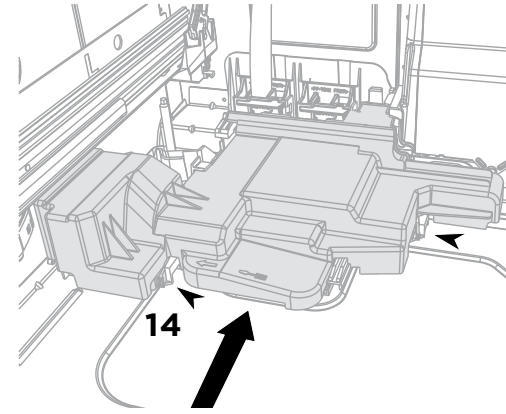
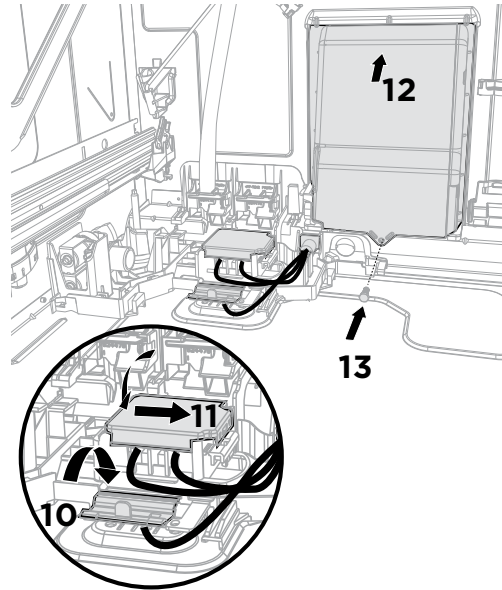

- 8 Fit a suitable cable clamp for the conduit through the metal knockout. Ensure wiring is routed through or under under housing ribs.
- 9 Screw down the Live, Neutral and Earth wires correctly.
- 10 Push the plastic harness cover back over. It should clip back into place.
- 11 Fold down and slide back the terminal block cover.
- 12 Refit the electronics module back into position, being careful of wiring.
- 13 Replace the screw securing the electronics module.
- 14 Slide the access cover back, ensuring the 2 clips shown are fully locked in place.

NOTE: Use copper conductors only.

③-D REFIT THE DRAWER ONTO THE RUNNERS & CLOSE

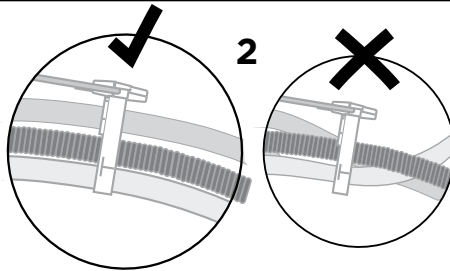

Before refitting the drawer, ensure the hoses are not twisted and the latches at the rear of each drawer runner are facing forward.

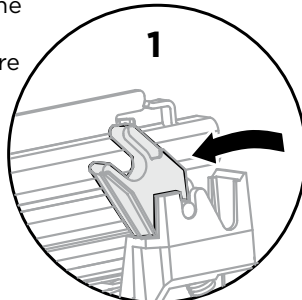

Lift or rotate counterclockwise the drawer back onto the drawer runners on either side.

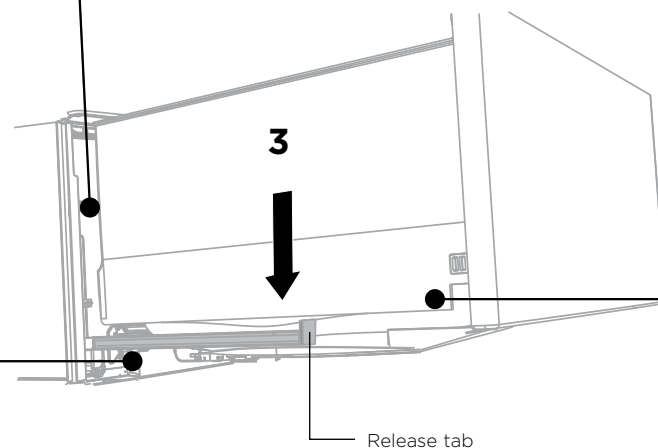

Release tab

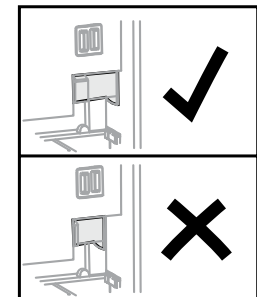
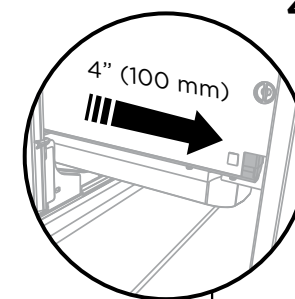

Pull the release tabs forward on both sides 4" (100 mm). Ensure the tabs are fully pulled forward and click into place.

4 PRODUCT DIMENSIONS

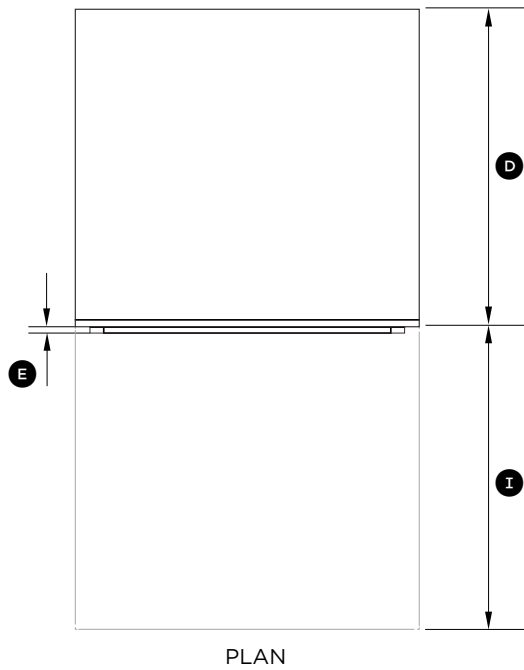
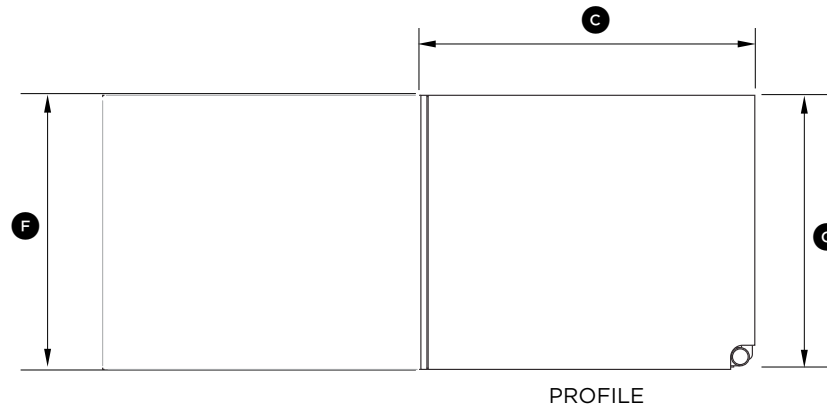
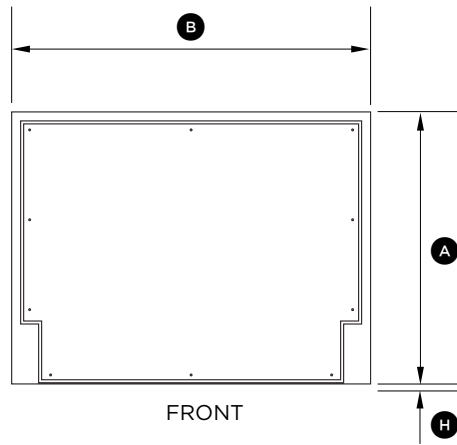

PRODUCT DIMENSIONS	STANDARD HEIGHT MODELS	TALL HEIGHT MODELS
	DD24SI	DD24STI DD24SHTI
	INCHES (MM)	INCHES (MM)
(A) Overall height of product ¹	16 1/8" (410)	min. 17 7/8" (454)
(B) Overall width of product	23 9/16" (599)	23 9/16" (599)
(C) Overall depth of product ²	22 1/2" (571)	22 1/2" (571)
(D) Depth of chassis (to back of front drawer panel)	21 3/4" (553)	21 3/4" (553)
(E) Depth of drawer front panel	5/8" - 13/16" (16-20)	5/8" - 13/16" (16-20)
(F) Height of drawer front panel	min. 16 1/16" (408) ³	min. 17 13/16" (452) ⁴
(G) Height of chassis ¹	16 1/8" (410)	17 7/8" (454)
(H) Ventilation gap below drawer front panel	min. 1/6" (2)	min. 1/6" (2)
(I) Maximum extension of drawer ²	21 7/16" (545)	21 7/16" (545)

¹ includes 1/16" (2mm) high bracket slots ² assuming a front panel thickness of 11/16" (18mm)

³ recommended for a 1/16" (2mm) ventilation gap below panel, if cavity height is 16 1/4" (412mm)

⁴ recommended for a 1/16" (2mm) ventilation gap below panel

5 CABINETY DIMENSIONS

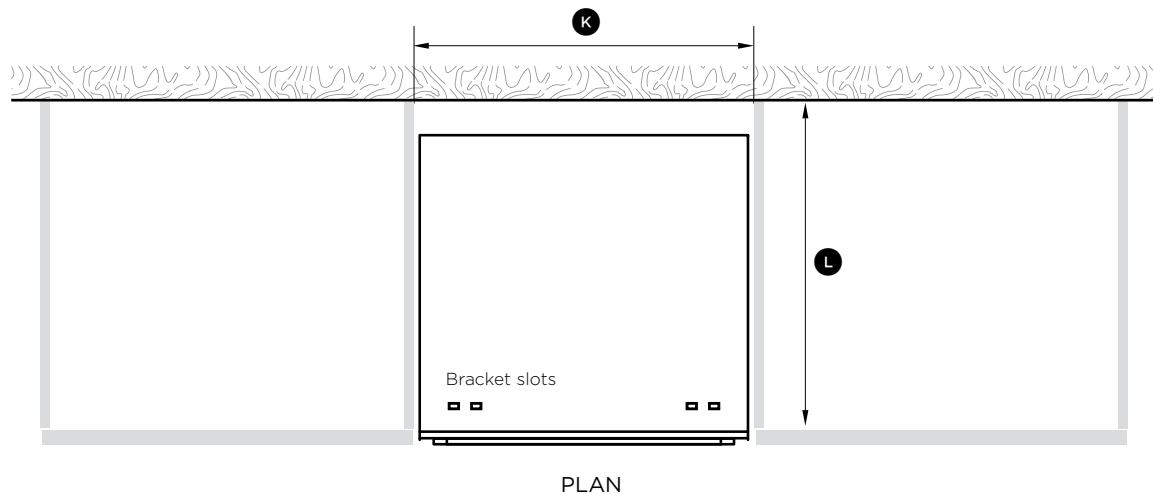

STANDARD
HEIGHT
MODELS

TALL
HEIGHT
MODELS

DD24SI

DD24STI
DD24SHTI

CABINETY DIMENSIONS	INCHES (MM)	INCHES (MM)
ⓐ Inside height of cavity	min. 16 1/4" (412)	min. 18" (456)
Ⓚ Inside width of cavity	23 5/8" (600)	23 5/8" (600)
Ⓛ Inside depth of cavity	min. 22 1/16" (560)	min. 22 1/16" (560)

Minimum clearances from adjacent cabinetry

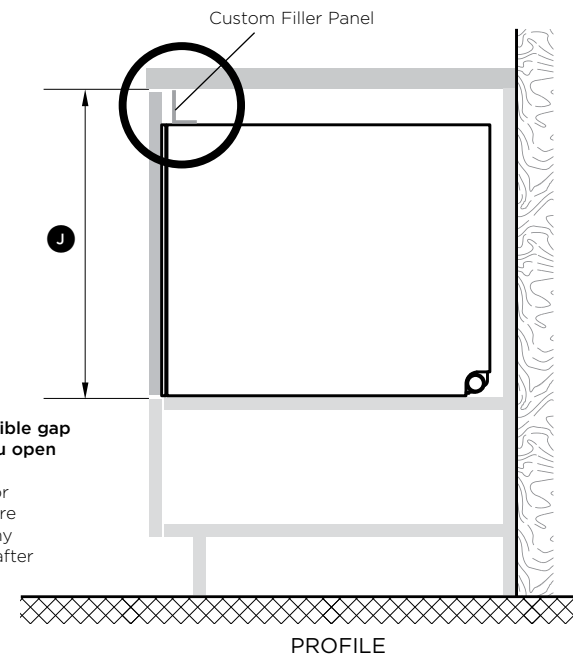
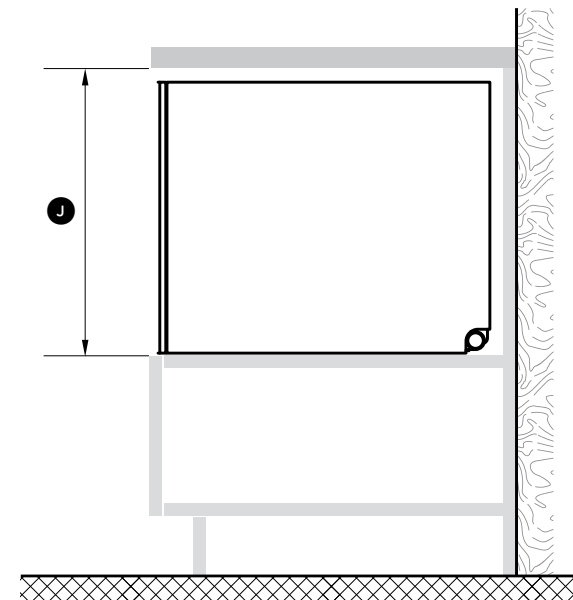
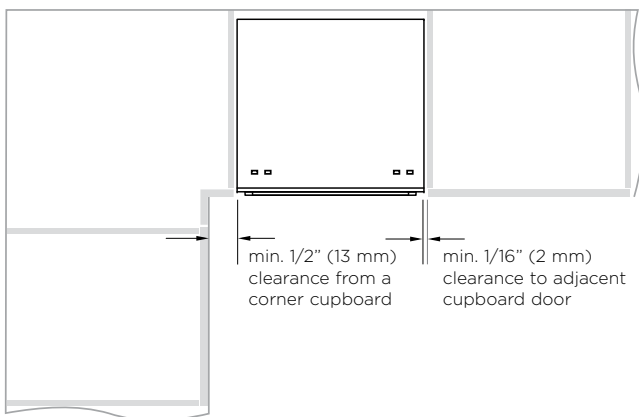

If your cavity height leaves a visible gap under your countertop when you open the drawer:

Fit the supplied cavity bracket (or a custom cavity filler panel) before installation in order to conceal any gap at the top of the cavity left after installation.

6 CUSTOM DRAWER PANEL SPECIFICATIONS

FRONT PANEL MATERIAL SPECIFICATIONS

- 5/8 - 13/16" (16 - 20mm) panel thickness
- Adequately sealed to withstand moisture (122°F/50°C @ 80% RH)
Because of it being a hot and wet environment generally, the back and sides of the panel should be completely sealed with a waterproof vapour barrier (ie polyurethane) to prevent damage to the panel.
- The back of the panel (including any integrated handle) should be completely flush so that the seal between the panel and the rubber trim is maintained.
- Installation outside these specs may result in condensation on cabinetry surfaces.
- Maximum weight of panel: 20lb (9kg)

The following calculations assume the top of the upper panel is aligned with the top of the adjacent cabinetry.

WIDTH OF THE PANEL

Measure **A** (the width between adjacent door/drawer fronts) and write it in the first box below, then complete the equation.

WIDTH OF PANEL

$$\boxed{A} - 2 \times \boxed{\text{Clearance to adjacent cabinet front}} = \boxed{\text{WIDTH OF PANEL}}$$

(min. 1/16" (2mm)) (23 7/16"-24 3/16" (596-615mm))

HEIGHT OF THE PANEL

HEIGHT OF PANEL

$$\boxed{B} - \boxed{\text{Ventilation Gap}} = \boxed{\text{HEIGHT OF PANEL}}$$

(min. 1/16" (2mm))

Note: when the top of the dishwasher has to be lower than the adjacent cabinetry, the top of the panel can extend above the chassis where required, however a min. 1/16" (2mm) gap to the benchtop must be maintained.

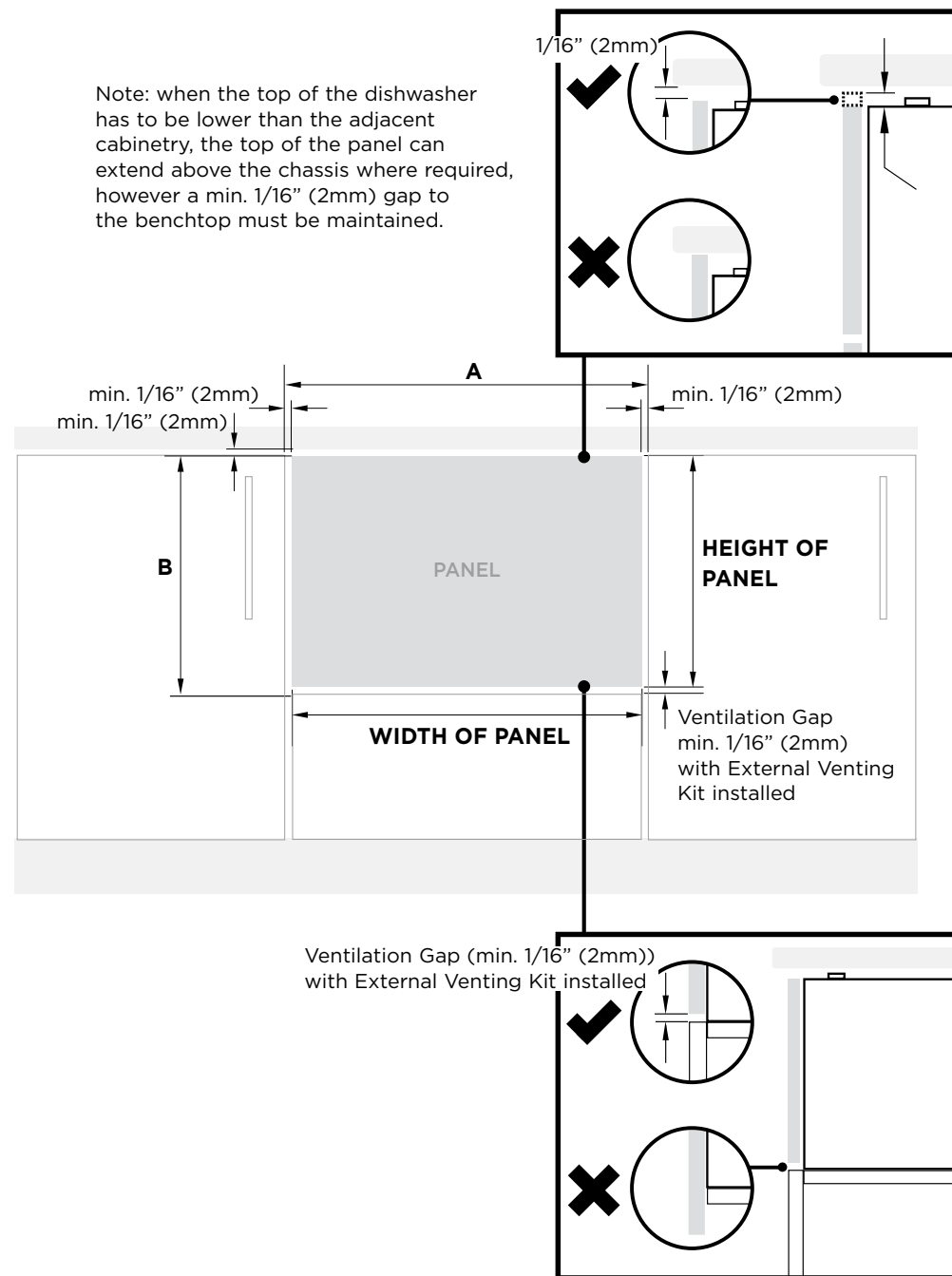

7 CAVITY PREPARATION

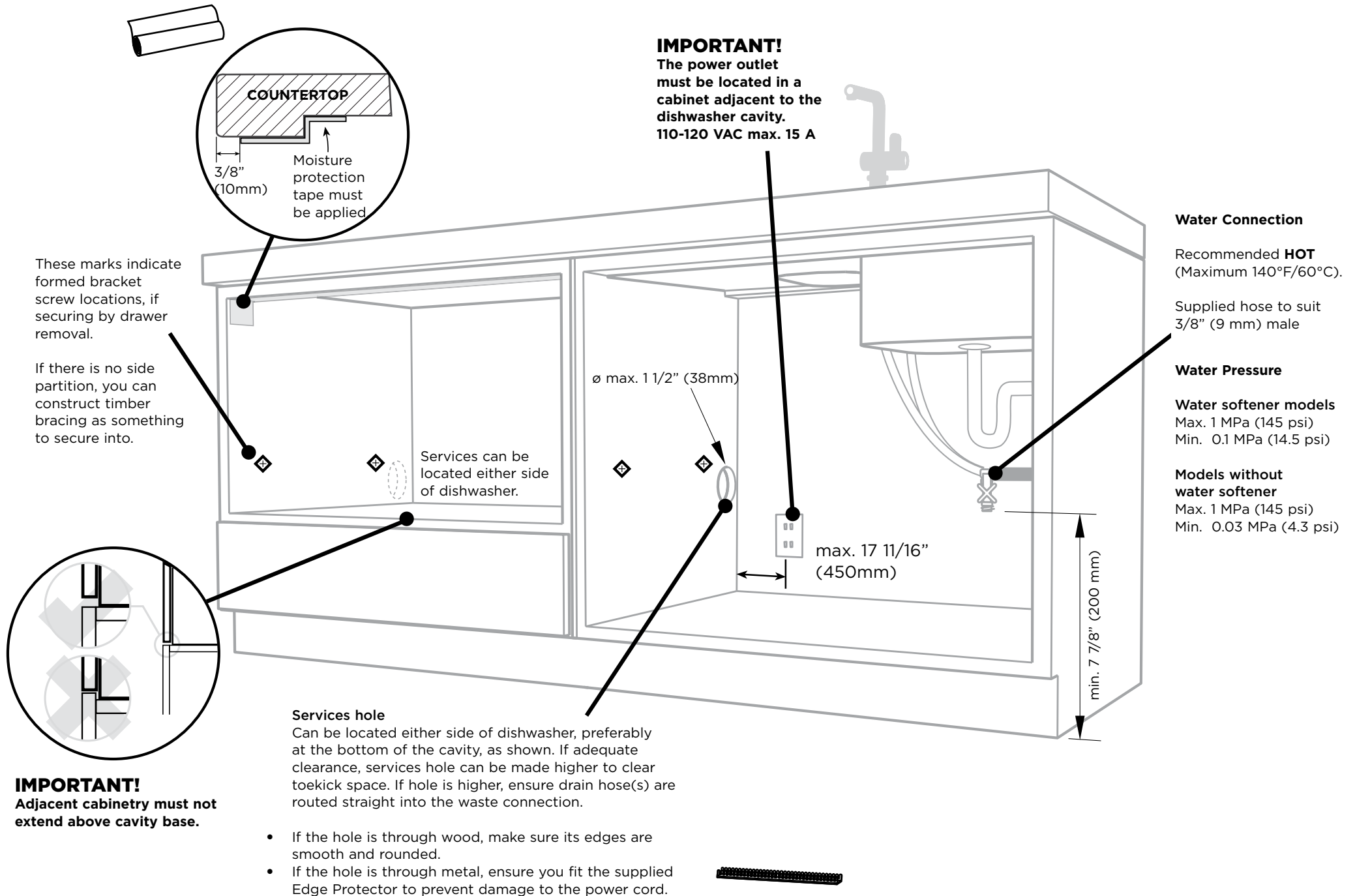

8 PREPARATION FOR EXTERNAL VENTING THROUGH SAME CABINET

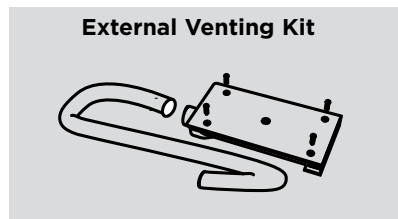

Services can be located either side of dishwasher

IMPORTANT!

To prevent pooling of condensation from the vent hose, a toe kick height of no less than 4" (100mm) is required.

Services hole

- If the hole is through wood, make sure its edges are smooth and rounded.
- If the hole is through metal, ensure you fit the supplied Edge Protector to prevent damage to the power cord.

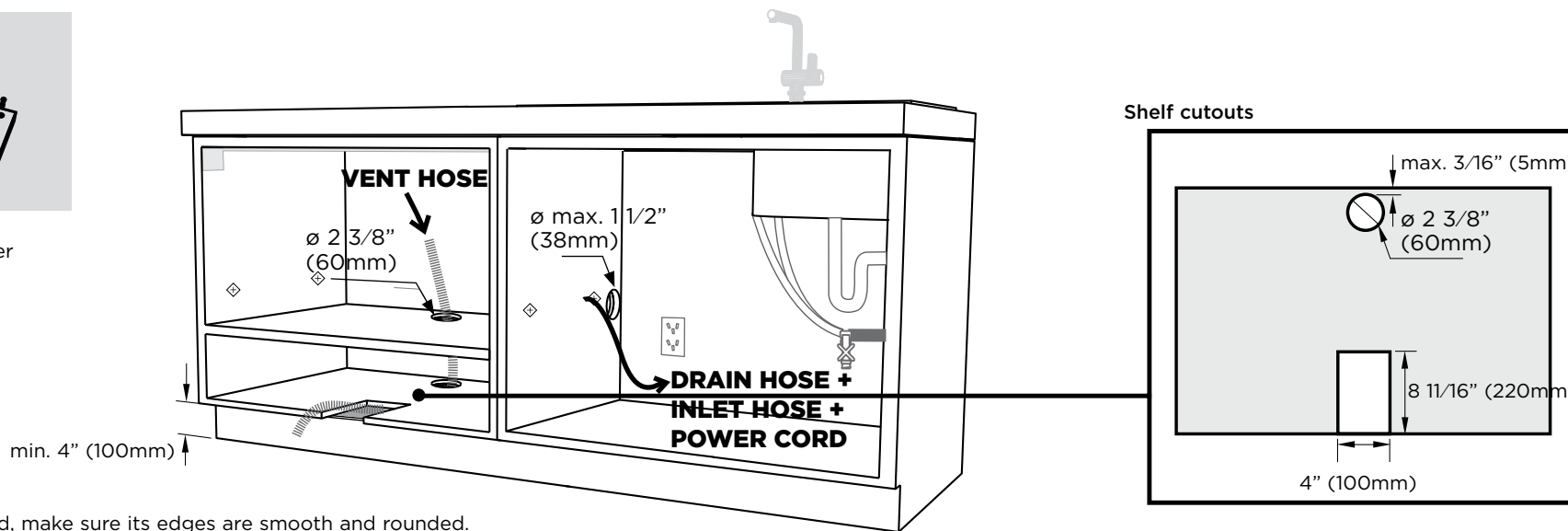

8 PREPARATION FOR EXTERNAL VENTING THROUGH ADJACENT CABINET

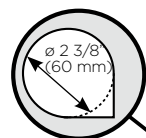

The $\varnothing 2 \frac{3}{8}$ " (60mm) services hole should be enlarged to accommodate the extra venting hose by cutting out some material from the bottom corner.

IMPORTANT!

To prevent pooling of condensation from the vent hose, a toe kick height of no less than 4" (100mm) is required.

Services hole

- If the hole is through wood, make sure its edges are smooth and rounded.
- If the hole is through metal, ensure you fit the supplied Edge Protector to prevent damage to the power cord.

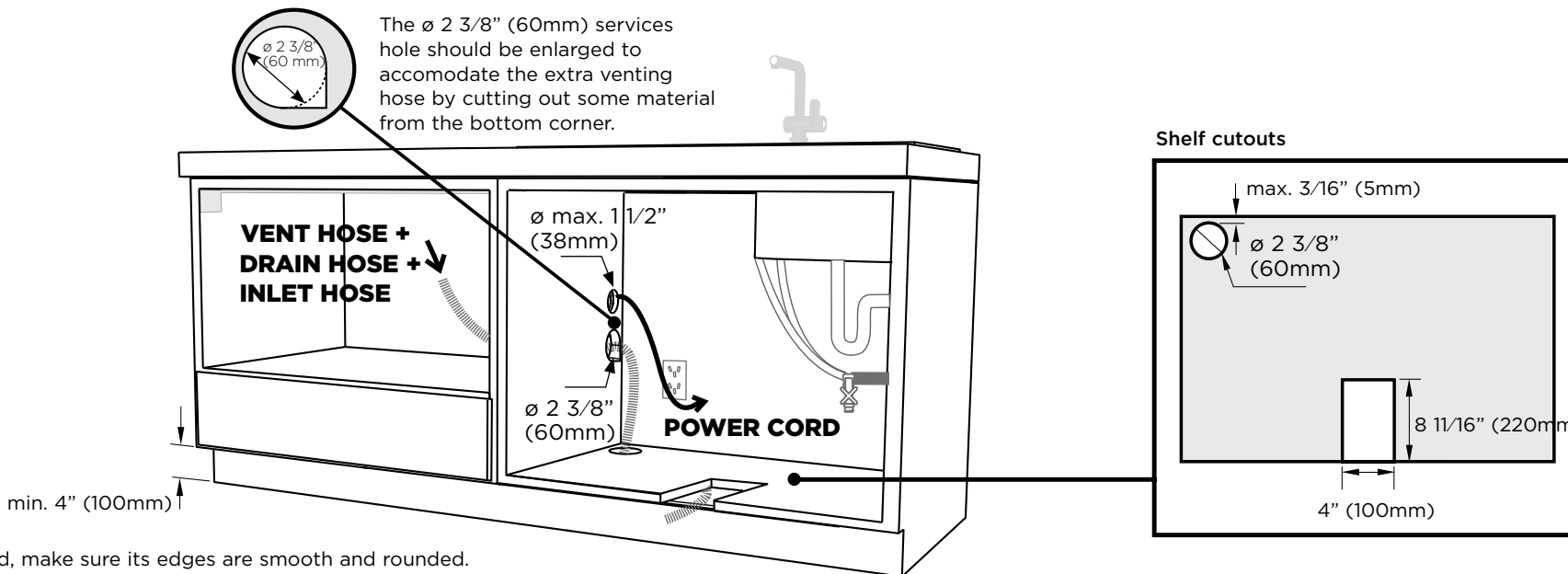

9 MAXIMUM DISTANCE OF HOSES & CORD FROM CHASSIS EDGE



10 TALL HEIGHT INTEGRATED MODELS FOR 18 7/8" (480MM) CAVITY ONLY - ATTACH CAVITY BRACKET

IMPORTANT!

The enclosed cavity bracket is fitted before installation in order to conceal the gap at the top of the cavity left after installation.

1

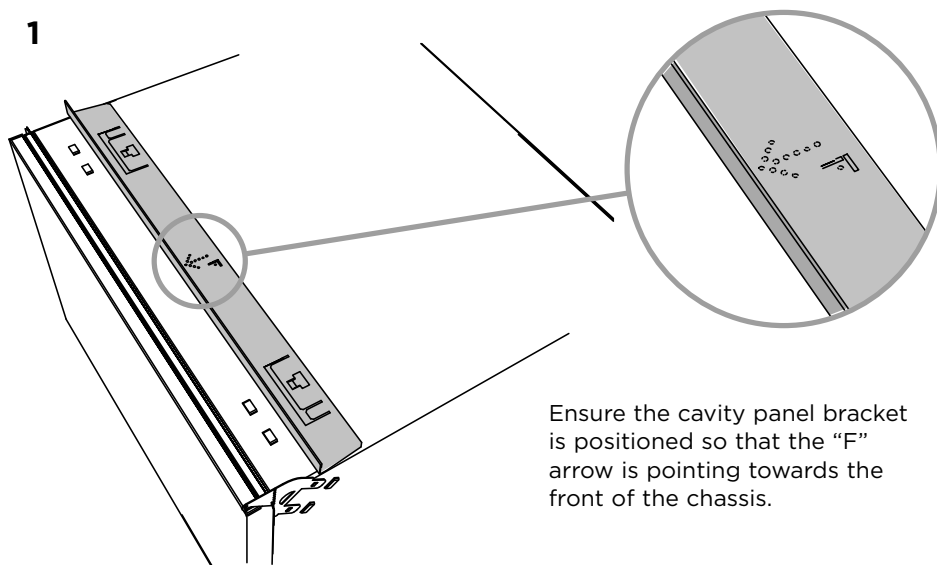

2

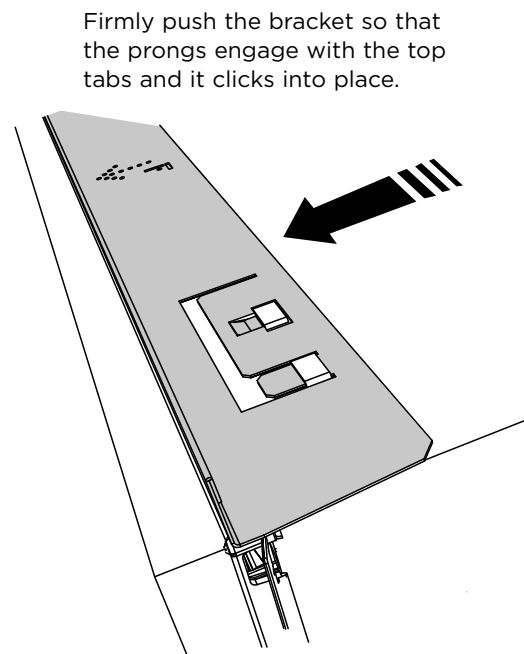

IMPORTANT!

Ensure the prongs have not been driven down into the chassis as this will damage the lid below.

Ensure the top trim seal is facing forward after attaching the bracket.

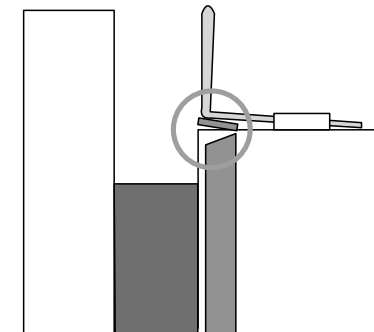

**NOW CHOOSE WHICH INSTALLATION METHOD (A) OR (B)
IS MORE SUITABLE FOR YOUR CABINETRY...**

11 RECOMMENDED METHOD (A) - SECURE WITHOUT DRAWER REMOVAL (FRAMELESS CABINETRY ONLY)

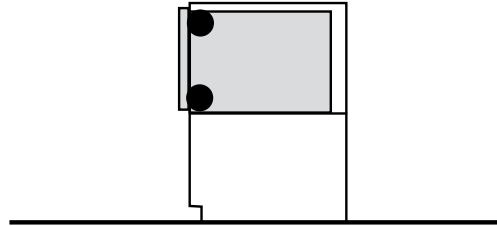

11-(A) ATTACH SIDE MOUNTING BRACKETS

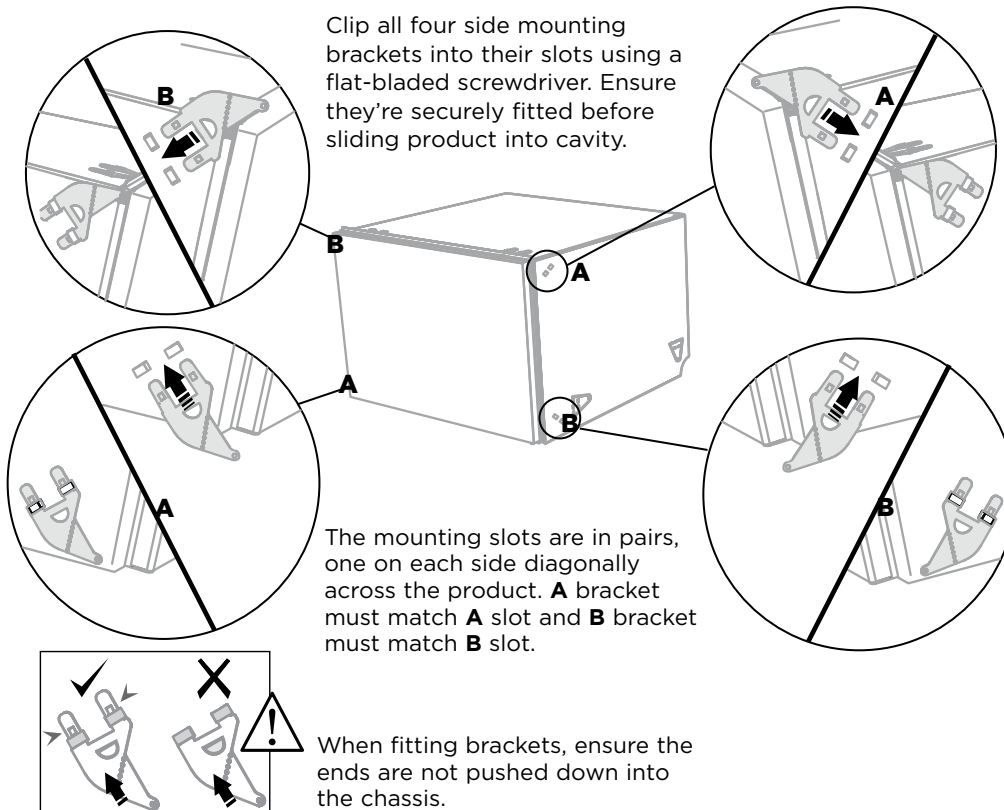

12-(A) ATTACH VENTING HOSE

Check that the fitted elbow is rotated left or right (depending on the direction of the routing), then ensure the venting hose is securely attached to it.

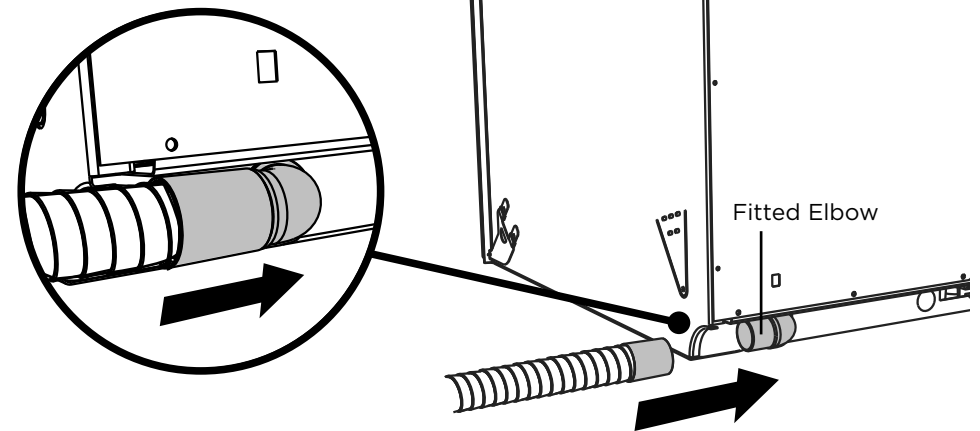

13-A PULL THROUGH HOSES & MOVE INTO THE CAVITY

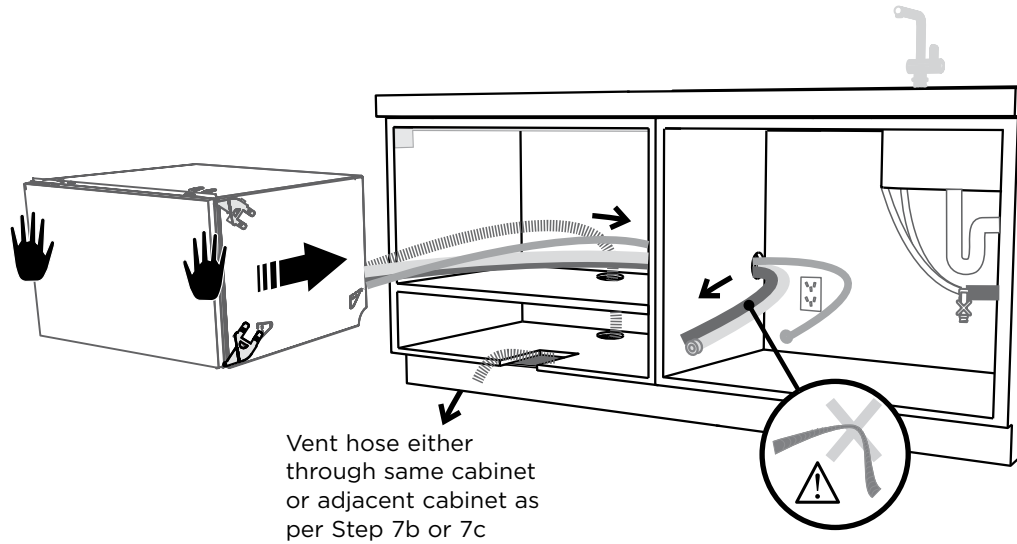

As you push product in, pull through hoses and cord, ensuring they don't get kinked or twisted.

IMPORTANT!

If product cannot be pushed in far enough, pull out again and rearrange hoses and cord. Do not use excessive force, as doing so may squash the hoses and lead to incorrect operation.

14-A SECURE TO THE CABINETRY ON THE SIDES

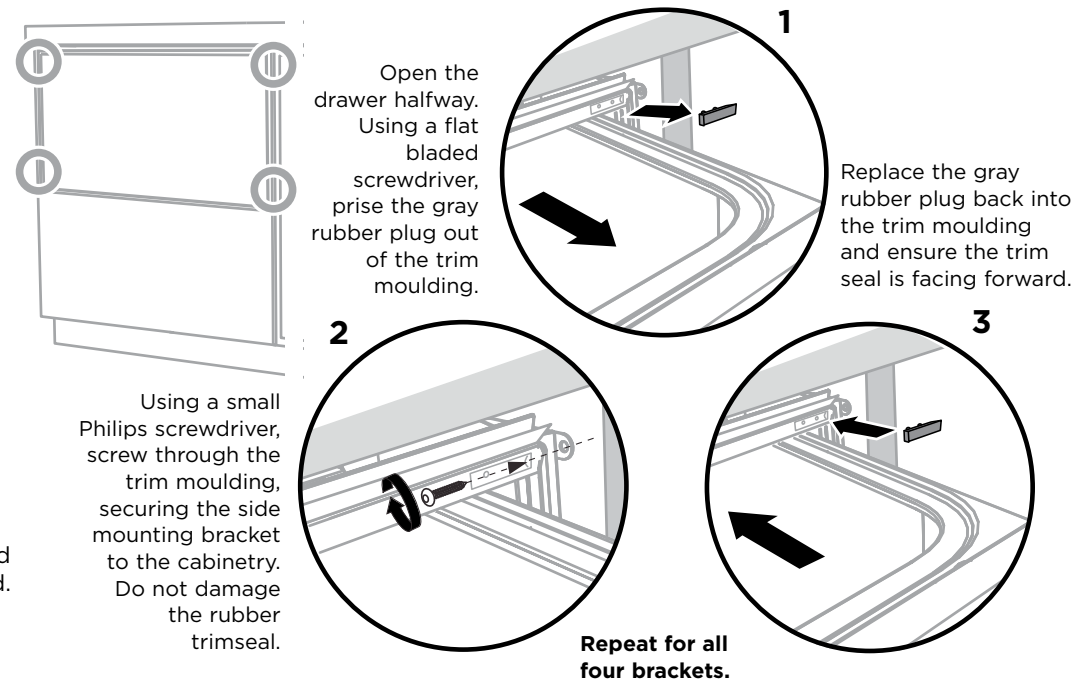

15-A SECURE THE EXTERNAL VENT

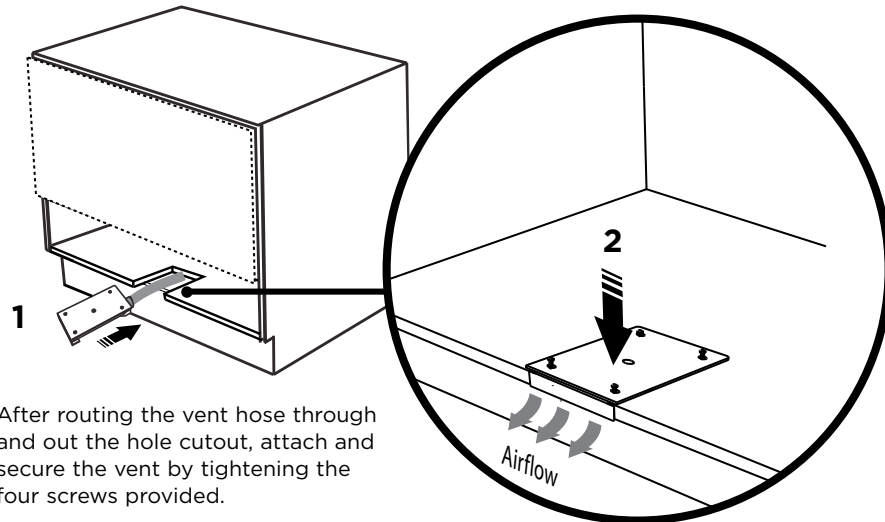

After routing the vent hose through and out the hole cutout, attach and secure the vent by tightening the four screws provided.

11 ALTERNATIVE METHOD (B) - SECURE BY DRAWER REMOVAL

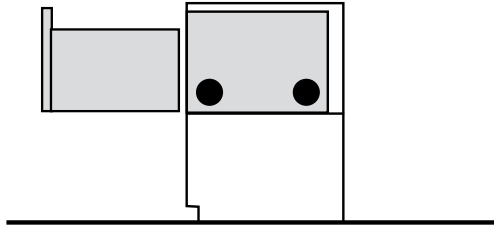

11-A ATTACH VENTING HOSE

Check that the fitted elbow is rotated left or right (depending on the direction of the routing), then ensure the venting hose is securely attached to it.

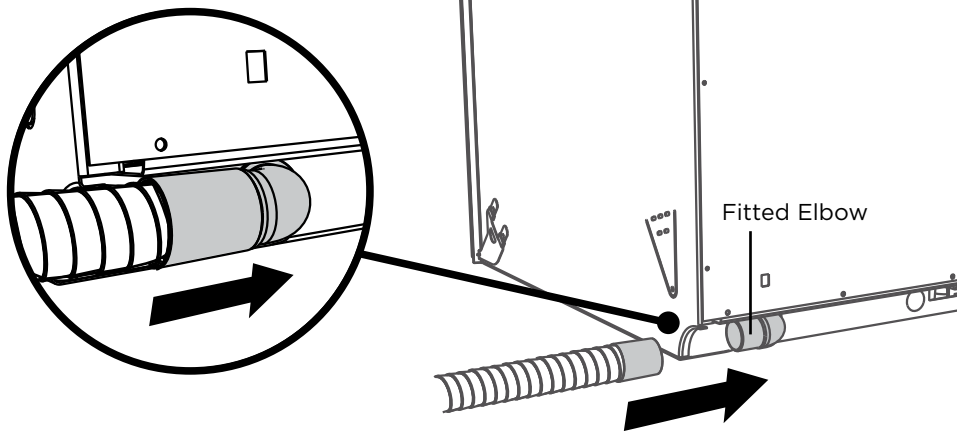

12-A PULL THROUGH HOSES & MOVE INTO THE CAVITY

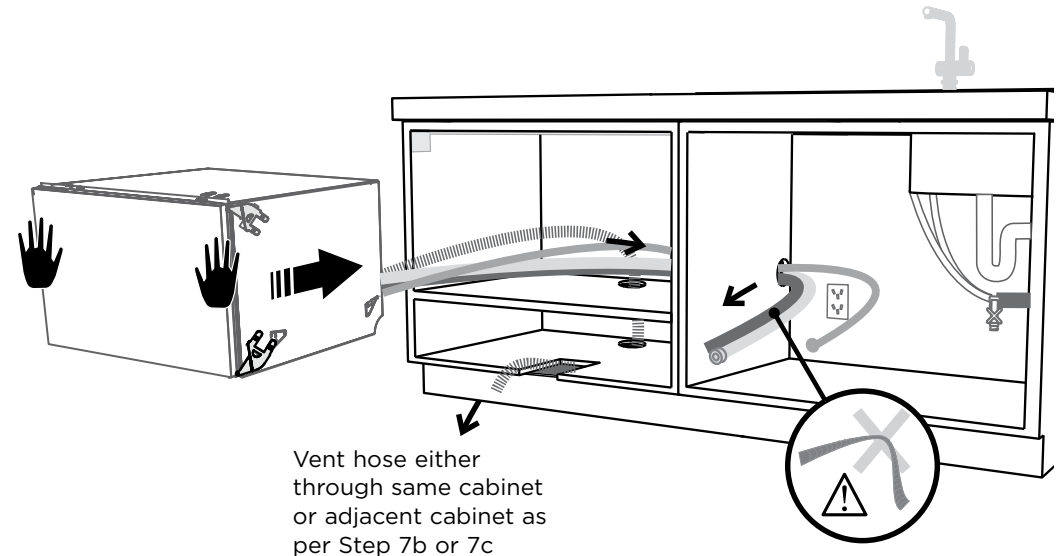

Vent hose either through same cabinet or adjacent cabinet as per Step 7b or 7c

As you push product in, pull through hoses and cord, ensuring they don't get kinked or twisted.

IMPORTANT!

If product cannot be pushed in far enough, pull out again and rearrange hoses and cord. Do not use excessive force, as doing so may squash the hoses and lead to incorrect operation.

To prevent kinked hoses

Either sit the drawer down on the left hand side (recommended) or rotate the drawer clockwise, resting it on its side after removal.

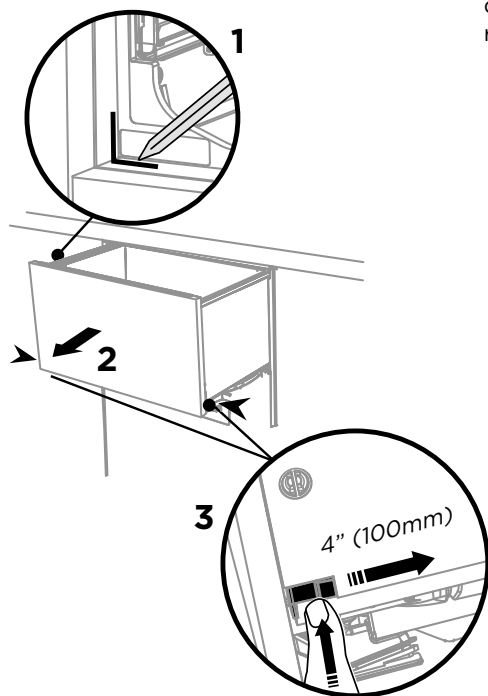

Press the release tabs in on either side and push back to release drawer from runners. Lift drawer off runners.

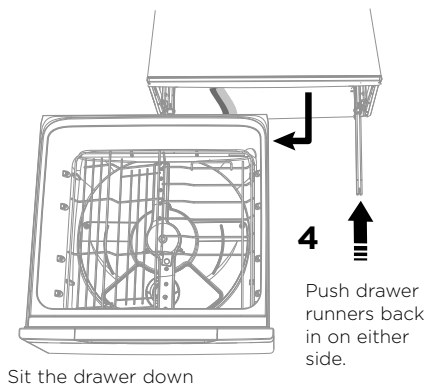

Sit the drawer down

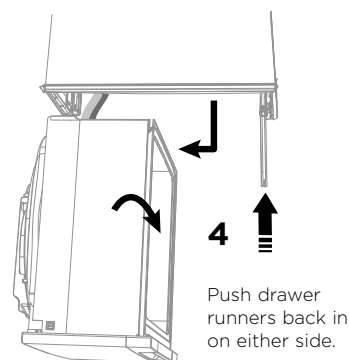

Rotate the drawer clockwise (max. 90°) and rest on side.

The product has three pairs of fixing points:

Ensure the sound insulation is repositioned correctly.

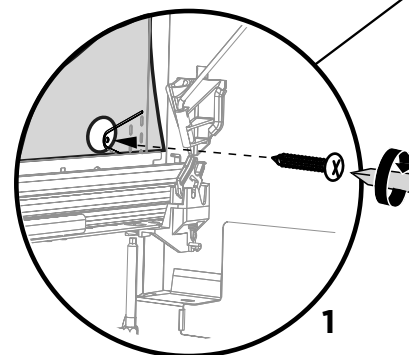

two pairs of formed brackets on either side of the chassis (use 5/8" (16mm) screws))

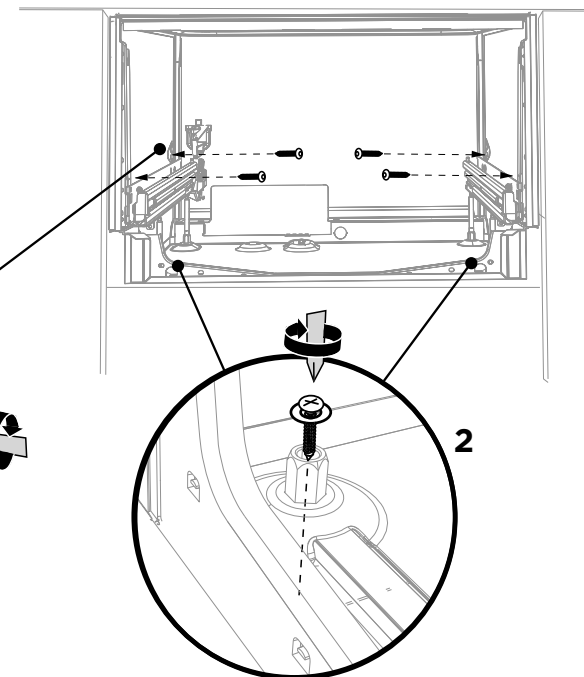

a pair of fixing holes either side on the bottom (use 1 1/2" (38mm) fixing screws & washers)

15-B REFIT THE DRAWER ONTO THE RUNNERS

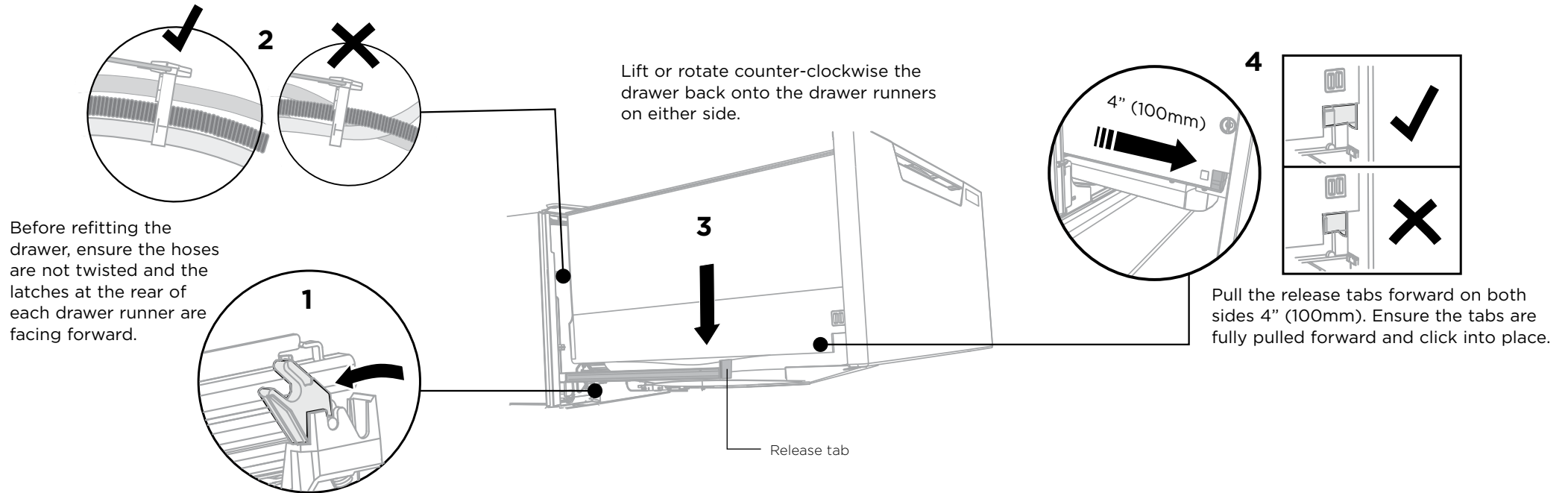

16-B SECURE THE EXTERNAL VENT

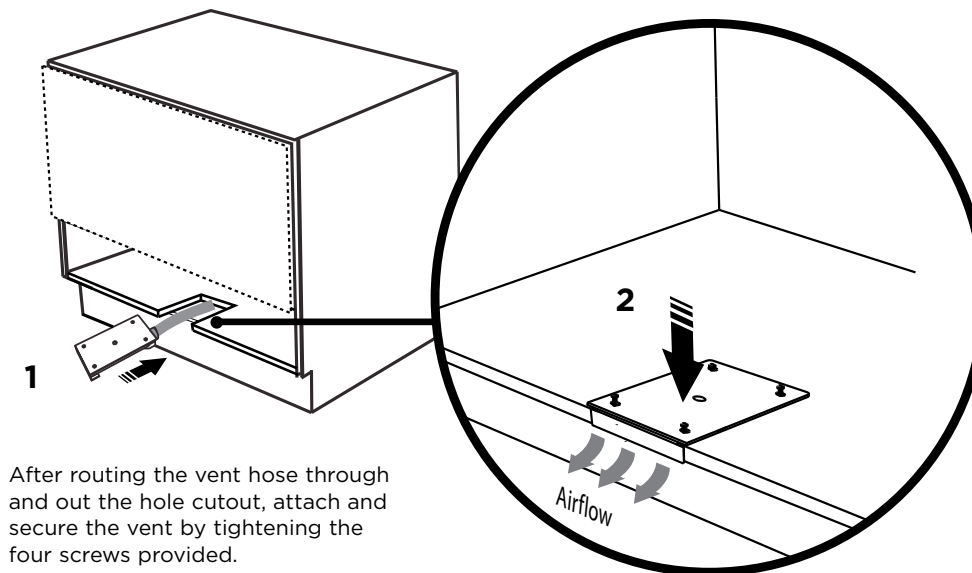

17-A

REMOVE PANEL BRACKET FROM PRODUCT

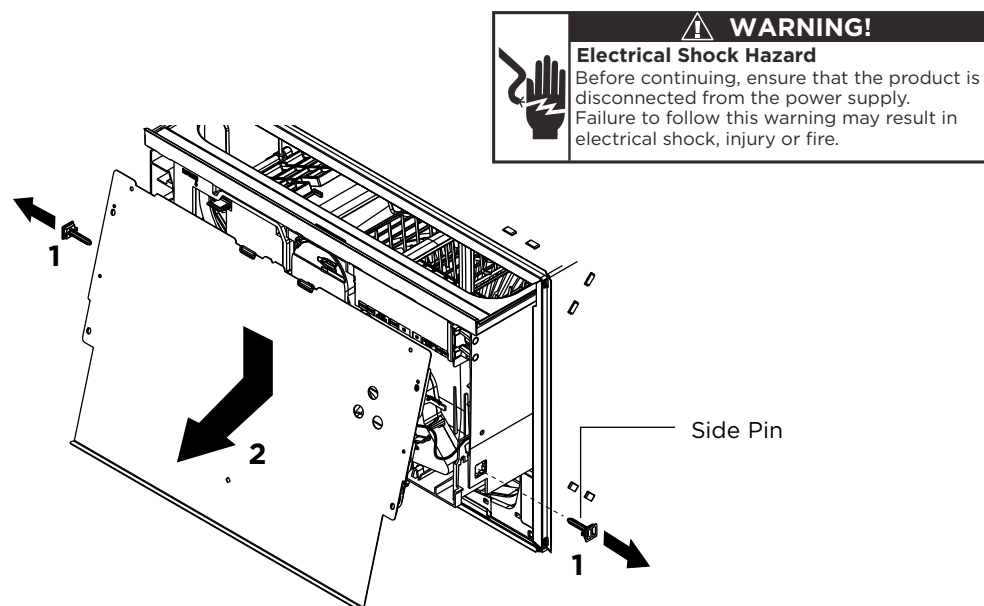

Remove side pins and gently pull off the panel bracket slightly.

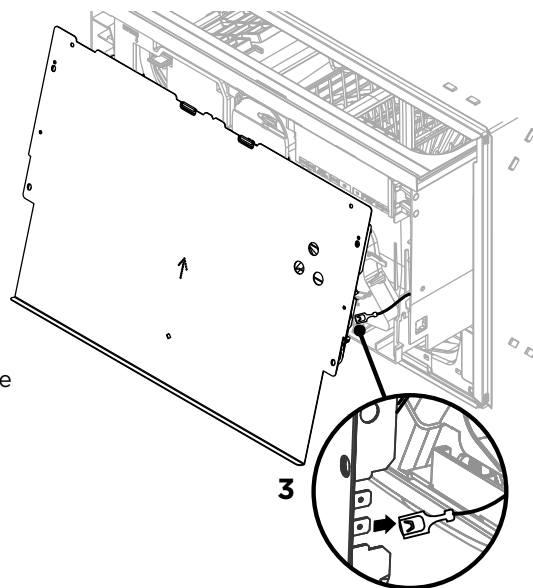

- ① Disconnect the Earth Wire from the bracket
- ② Unplug the knock sensor from the controller.

17-B

REMOVE THE KNOCK-TO-PAUSE MODULE

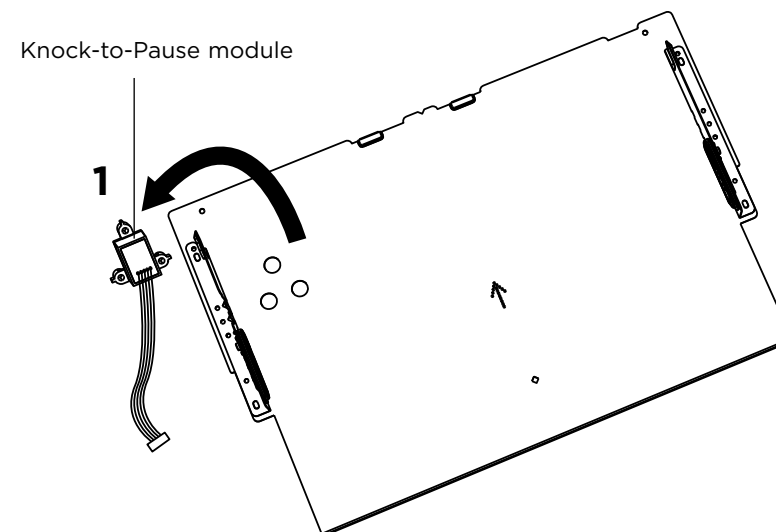

Remove the Knock-to-Pause module from the back of the bracket.

17 INSTALLING CUSTOM FRONT DRAWER PANELS

17-C ATTACH CUSTOM PANELS TO PANEL BRACKETS

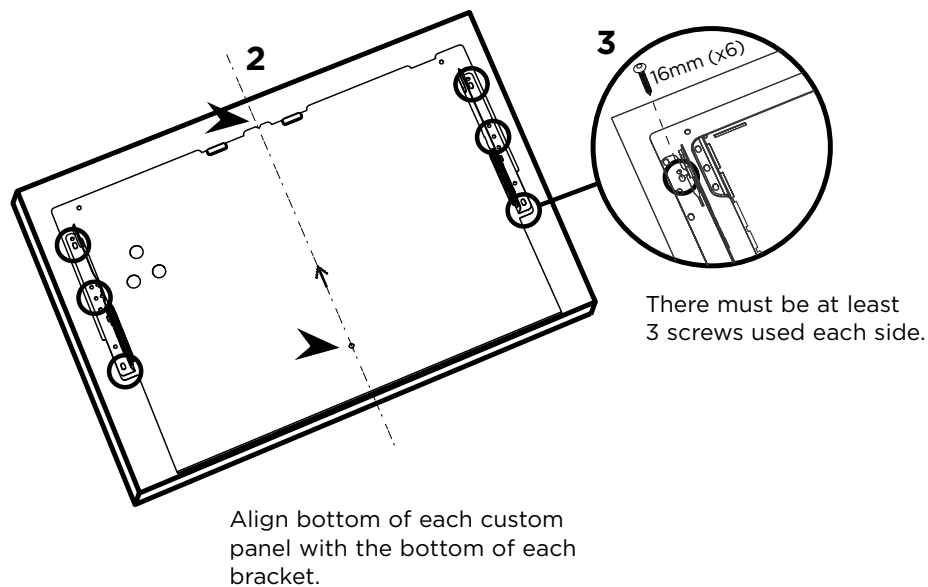

17-D ATTACH KNOCK-TO-PAUSE MODULE TO CUSTOM PANEL

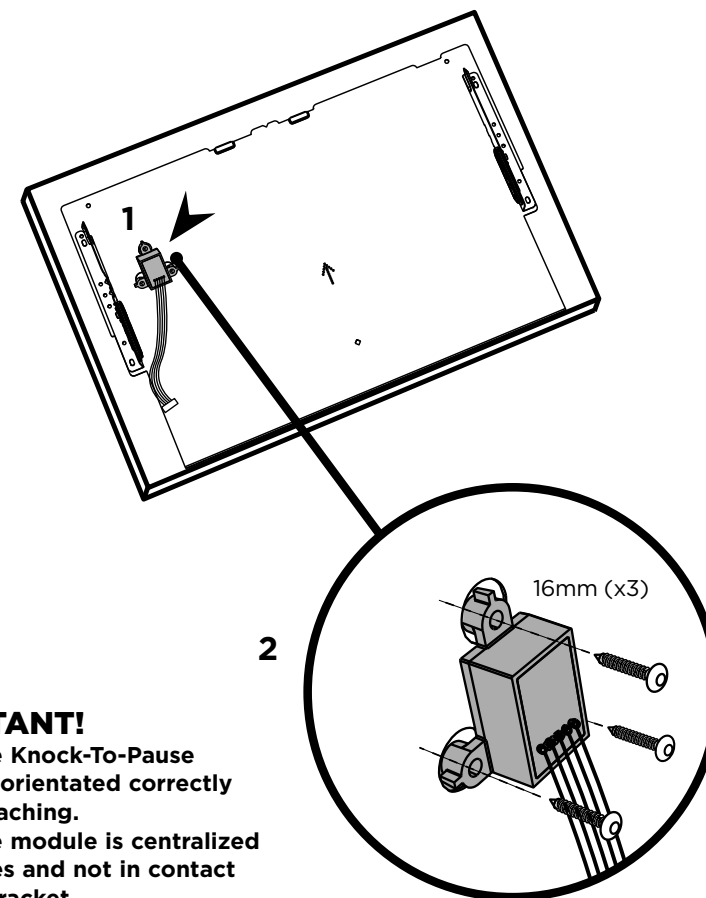

IMPORTANT!

- Ensure the Knock-To-Pause module is orientated correctly before attaching.
- Ensure the module is centralized in the holes and not in contact with the bracket.

Attach the Knock-To-Pause module to the back of the custom panel through the 3 holes cut into the panel bracket as shown.

Use all 3 screws provided.

17 INSTALLING CUSTOM FRONT DRAWER PANELS

17-E CONNECT THE KNOCK-TO-PAUSE MODULE TO THE CONTROLLER

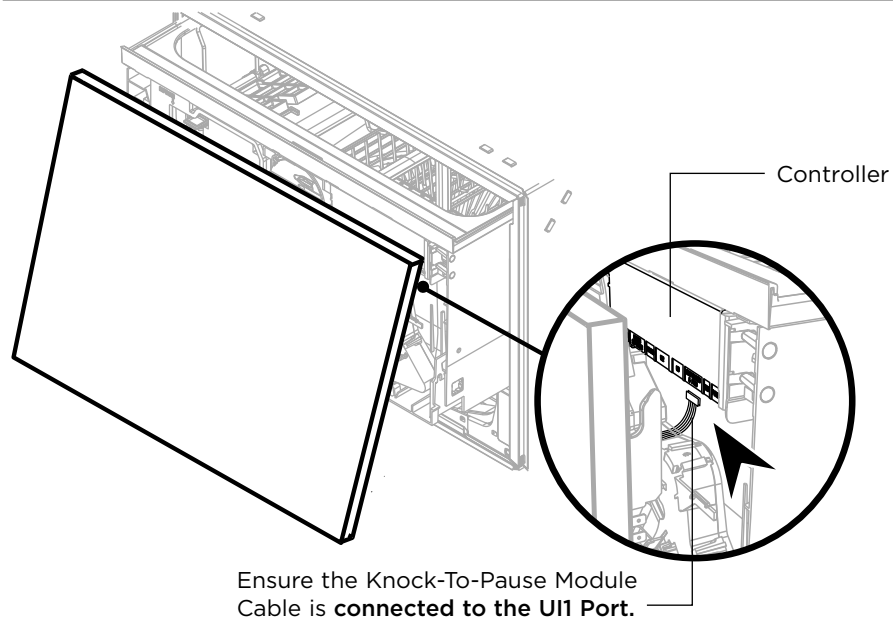

17-F RECONNECT THE GROUND WIRE TO THE PANEL BRACKET

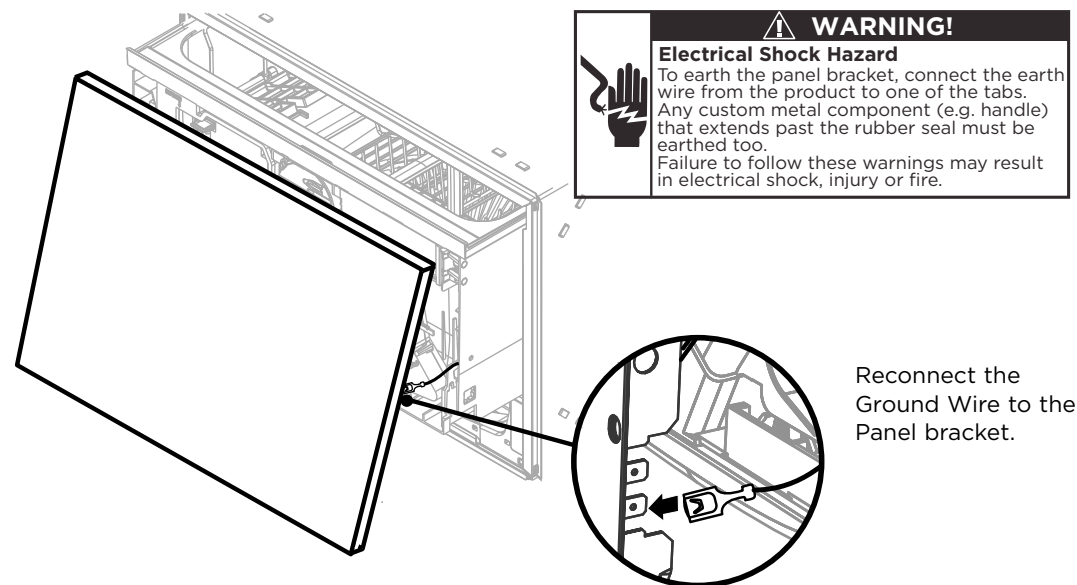

17-G ATTACH CUSTOM PANEL TO PRODUCT

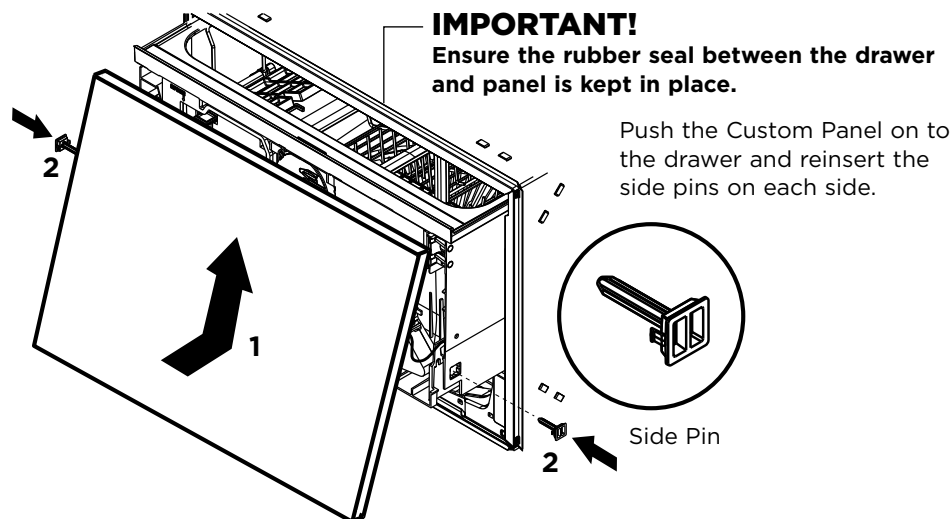

17-H ADJUST CUSTOM PANEL HEIGHT TO ALIGN CABINETRY GAPS

With the front panels fitted, insert an appropriately sized Philips screwdriver into the hole above the side pin and rotate the panels up or down to align the gaps in your cabinetry.

Repeat on the other side if necessary.

Each panel has a maximum travel of 1/16" (2mm) up or down.

IMPORTANT!
Ensure that you maintain a minimum of 1/16" (2mm) ventilation gap below the panel.

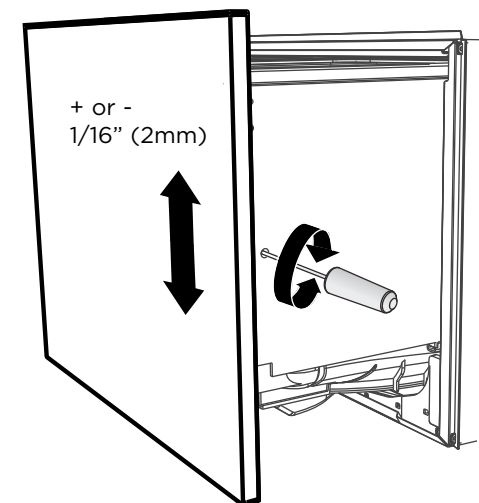

DRAINAGE OPTION 1 Dishwasher and Ø 1 1/2" (38 mm) Standpipe

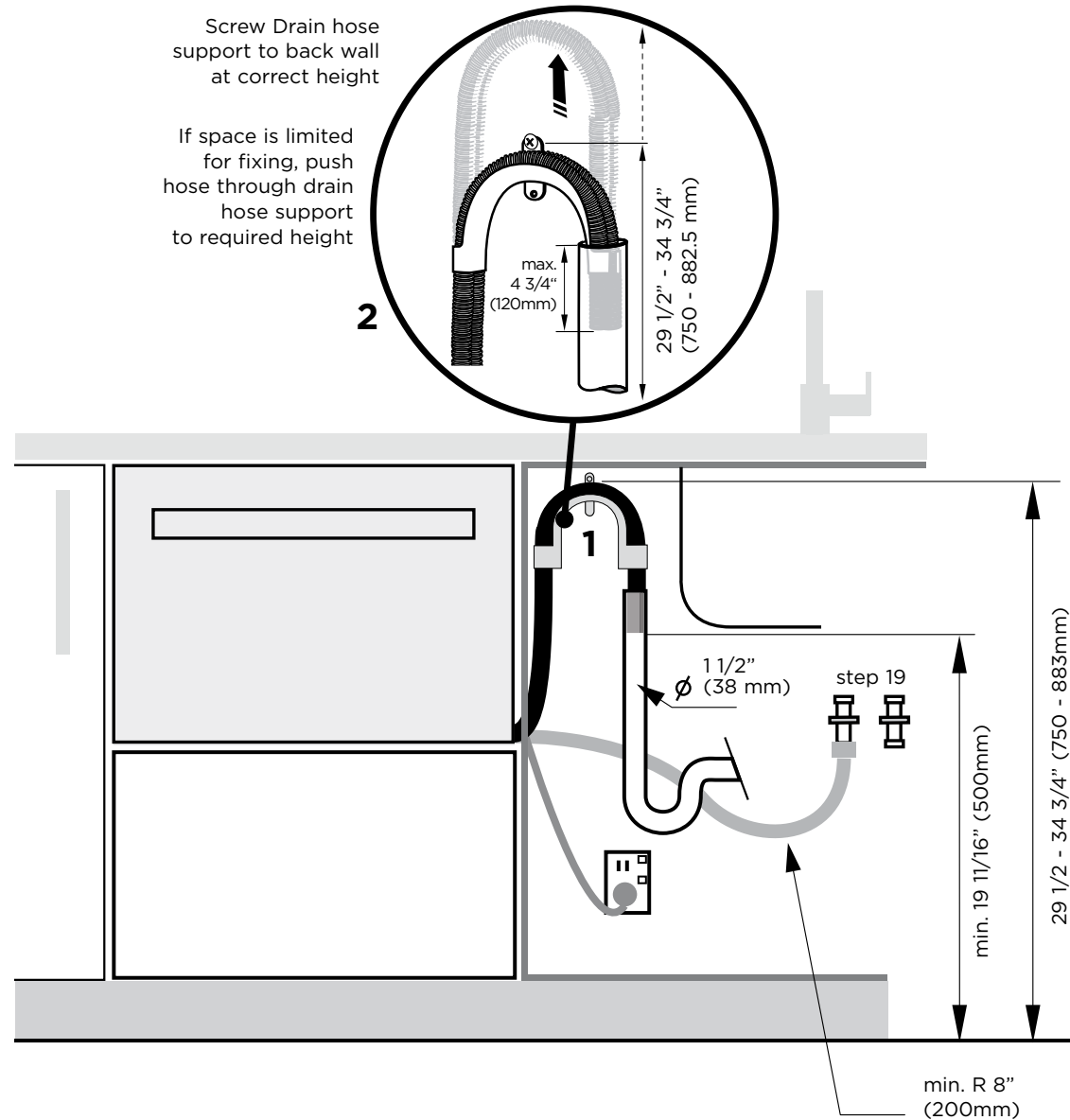

IMPORTANT!
Ensure that drain connection will comply with local plumbing regulations.

DRAINAGE OPTION 2
Dishwasher using Air Break with Drain Hose Joiner

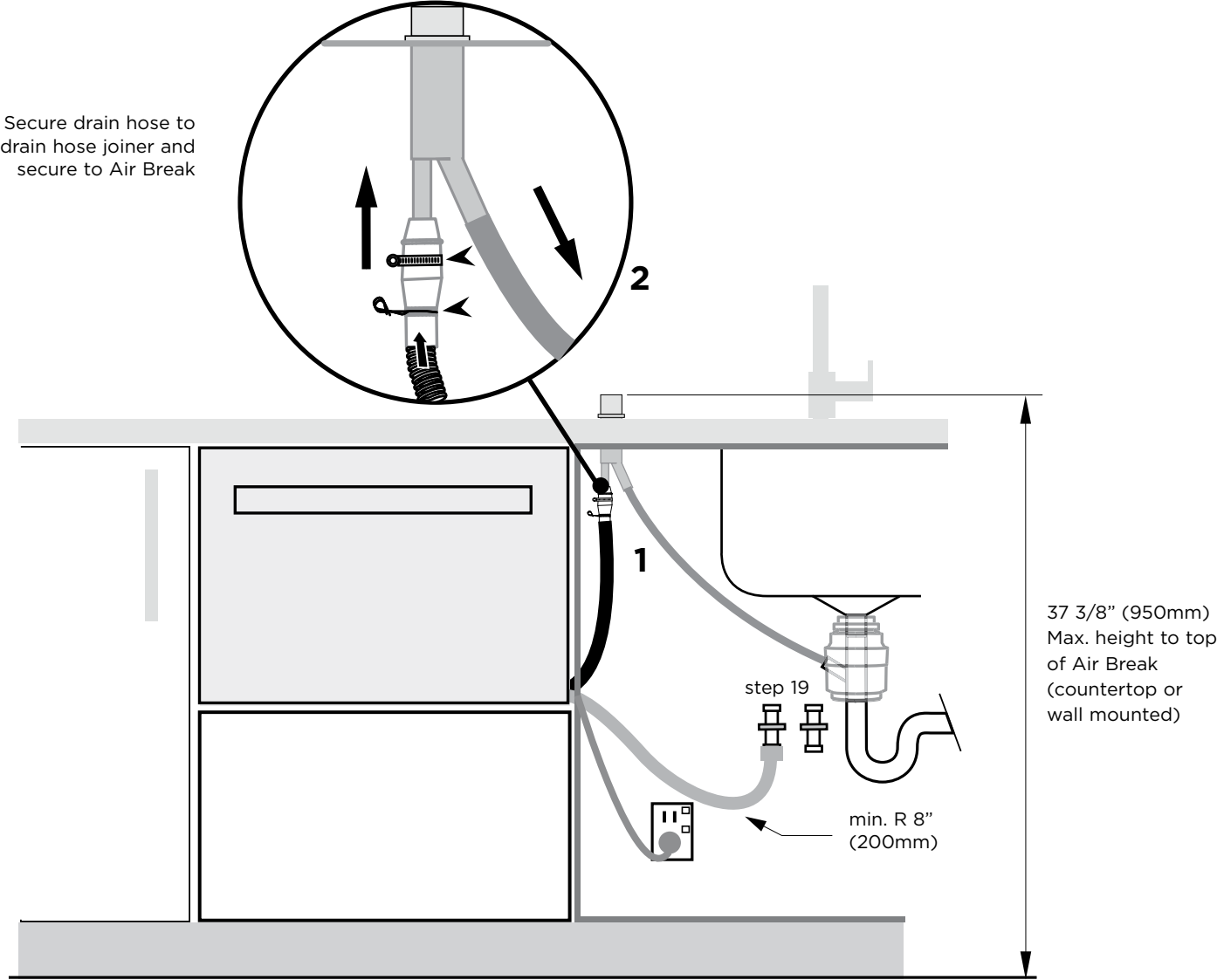

DRAINAGE OPTION 3 Dishwasher using drain hose joiner onto sink trap/waste tee

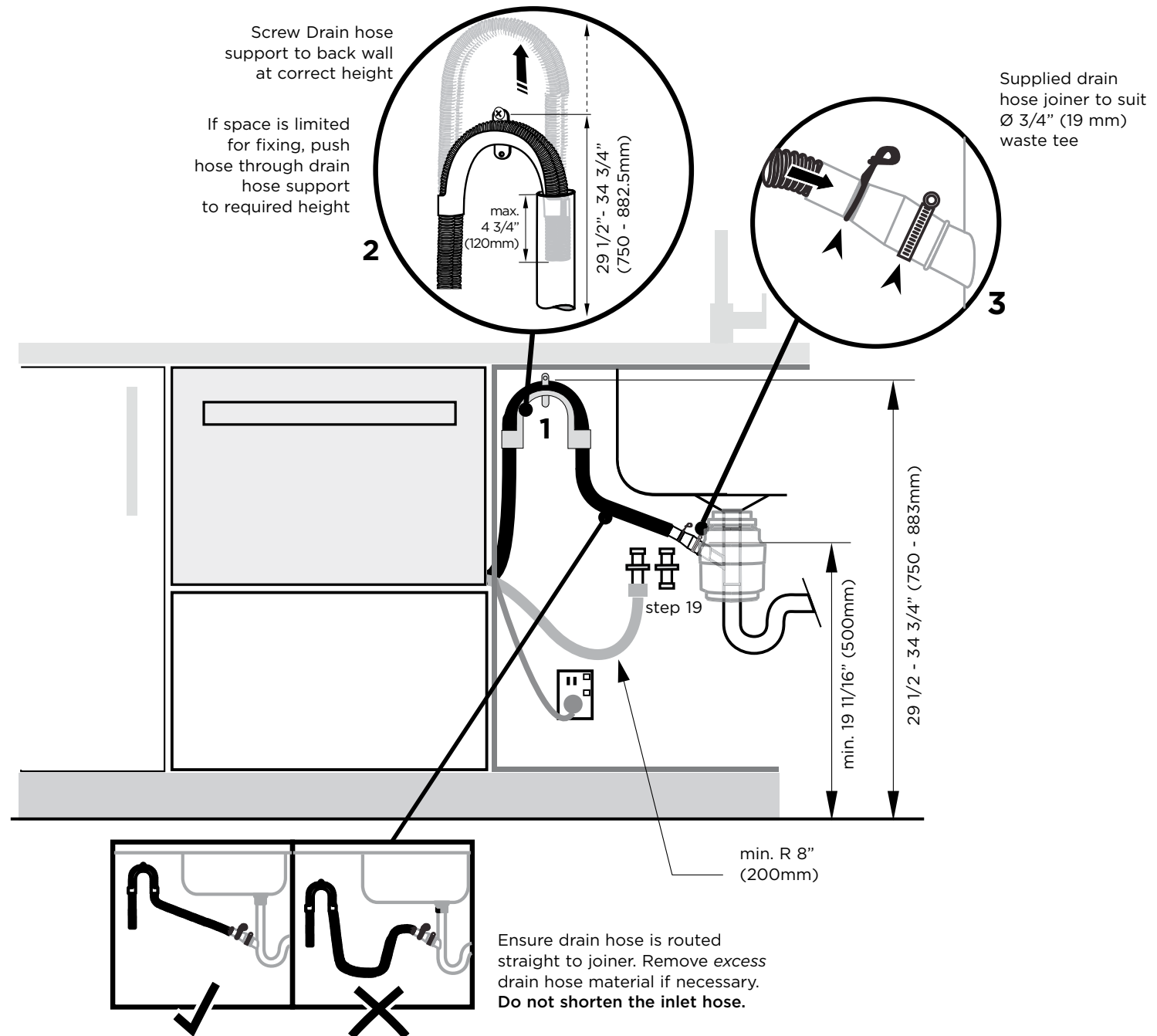

19 **CONNECT INLET HOSE TO HOT WATER**

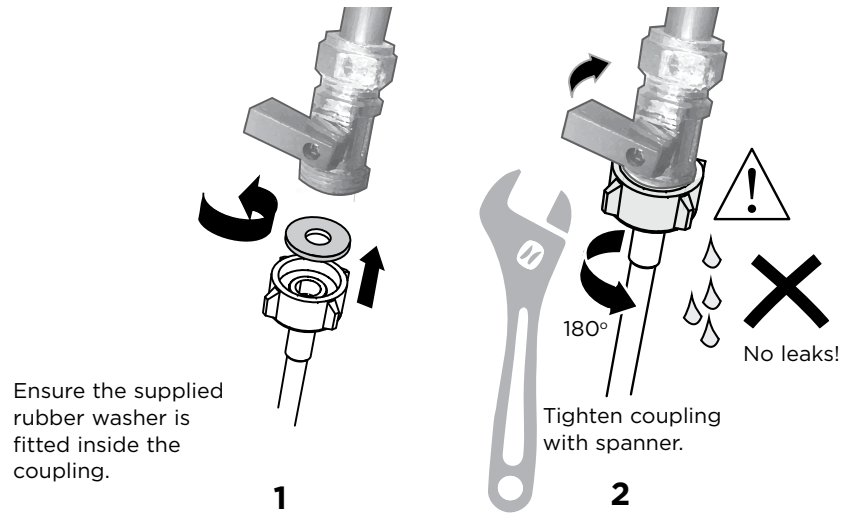

20 **SWITCH PRODUCT ON**

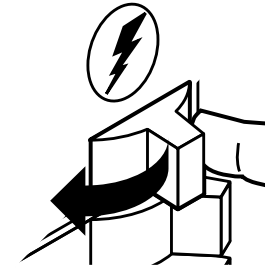

- **Excessive water remaining above the filter plate, after the rinse cycle. (This is displayed as an A3 fault. See user guide 'How to attend to a fault')**
Check for a kinked drain hose, blocked or incorrectly drilled out waste connection, highloop not properly installed, drain hose not routed correctly or spray arm not in place.
- **No water supply. (This is displayed as an A1 fault. See user guide 'How to attend to a fault')**
Check water is connected and turned on.
- **The dishwasher is beeping continuously**
There is a fault. See section 'How to attend to a fault' in the User guide for further information and instructions.
- **No program indicator lights up when the drawer is opened**
Ensure power is connected and is switched on. If it is and still no indicator lights up, see the 'Preference options' section of the 'Quick start guide'. An option called 'Open drawer auto power-on' may need to be turned on.
- **Water around water supply and drainage connections**
Check connections, existing plumbing and hoses for leaks. Check rubber washer and hose clamp are correctly fitted.
- **If product is tipping**
Ensure the product is secured to the cabinetry.
- **Drawer doesn't close properly**
Ensure nothing is obstructing the drawer from closing properly eg hoses or drawer latches.
- If a problem occurs, consult the 'Troubleshooting' section of the User guide.
- If after checking these points you still need assistance, please refer to the Service & Warranty book for warranty details and your nearest Authorised Service Centre, or contact us through our website, listed below.



TO BE COMPLETED BY THE INSTALLER

- ☐ Check all parts are installed.
- ☐ Ensure that all panels and parts thereof are secure and final electrical tests have been conducted in accordance with local electrical regulations.
- ☐ Ensure product is level, securely fastened to the cabinetry and opens and closes freely. The drawers must be free to fully close with no resistance from the cabinetry.
- ☐ Ensure inlet hose to water supply has supplied rubber washer fitted, and that it's tightened a further half turn after seal contact.
- ☐ Ensure any knockouts or plugs in drain connection have been drilled out and drain connection has been made.
- ☐ The drain hose joiner must not support the weight of excess hose material. Keep drain hose as fully extended as possible to prevent sagging. Any excess length of drain hose should be kept on the dishwasher side of the highloop.
- ☐ If connecting the drain hose to the sink trap, ensure the Highloop is a minimum 5 7/8" (150mm) higher than the drain hose joiner.
- ☐ Ensure any packaging or tape securing the racks is removed from the drawers.
- ☐ Water softener models only: adjust the water softener setting from the default setting to suit the water hardness of the area. See the Quick start guide and section 'Water softener' in the User guide.

- ☐ Turn on the power and water supplies, then open the drawer. You should hear a beep and see a program indicator light up on the control panel.
- ☐ Check the spray arms are in place, mounted correctly and free to rotate, by physically rotating by hand.

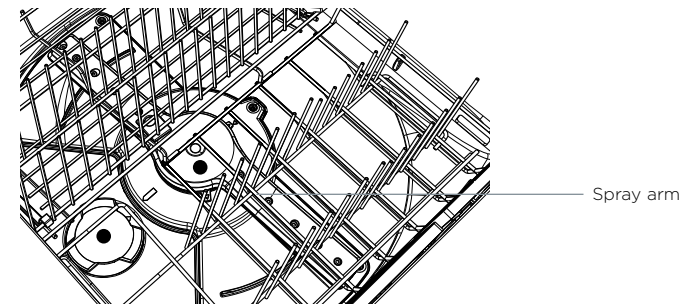

- ☐ Add three cups of water into the drawer. Press >> until the indicator of the 'Rinse' program lights up. Close the drawer and press ▶|| to start the program.
- ☐ When the test cycle is in process check the knock sensor is working by knocking twice on the door to pause the wash program.
- ☐ After the Rinse program has finished, ensure the dishwasher has run and drained correctly.
- ☐ Check the water supply has correctly shut off and drainage connection for leakage.

Complete and keep for safe reference:

Model _____

Serial No. _____

Purchase Date _____

Purchaser _____

Dealer Address _____

Installer's Name _____

Installer's Signature _____

Installation Company _____

Installation Date _____

FISHERPAYKEL.COM

Copyright © Fisher & Paykel Appliances 2017. All rights reserved.
The product specifications in this booklet apply to the specific products and models described at the date of issue. Under our policy of continuous product improvement, these specifications may change at any time. You should therefore check with your Dealer to ensure this booklet correctly describes the product currently available.

DISHDRAWER™ DISHWASHER

NZ AU US CA GB IE

Keep this document handy for easy reference.

- For detailed information on the features of your dishwasher, see your 'User guide'.
- Before using your dishwasher, make sure you read the full 'User guide', with special attention to the 'Safety and warnings' section.
- For contact information or if you require service, assistance or replacement parts, see the end of this document or your 'Service & warranty' booklet.

YOUR MODEL

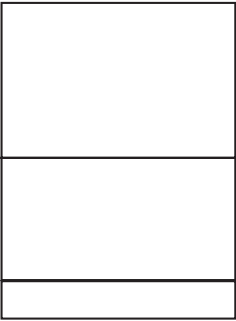

Double models
DD60DI9
DD60DHI9
DD24DI9
DD24DTI9
DD24DHTI9

Note: each drawer can run independently of the other drawer.



Single models
DD60SI9
DD60STI9
DD60SLI9
DD60SHI9
DD60SHTI9
DD24SI9
DD24STI9
DD24SHTI9

OPERATING INSTRUCTIONS - STARTING A WASH

1

Discard scraps

Scrape large food particles off (e.g. bones, fruit stones) and remove any foreign objects (e.g. toothpicks, strings, paper).

2

Load dishes carefully

To help with wash performance, arrange dishes so they are evenly spaced and not nesting.

IMPORTANT!
Accommodates plates up to a max height of 280mm (11") for standard tubs or 310mm (12 1/4") for tall tubs.

3

Check spray arm(s) are mounted correctly and can rotate fully around

Check the spray arm is mounted correctly by physically rotating it around with your hand.

Before a wash, ensure there are no items blocking the spray arm(s) from rotating.

Rotating Spray arm

4

Add detergent

Fill the detergent dispenser (A) with powdered detergent and close the dispenser door.

IMPORTANT!
Do not place liquid detergent or tablets in the detergent dispenser.

If using a tablet or gel pouch, place it in the cutlery basket (B) or at the edge of the base rack (see user guide for details).

5

Select wash

Press >> to select a wash program.

6

Start wash or set Delay start

To start wash:
Press ► and close the drawer.

To set delay start:
Press and hold ► to set the delay start time, then close the drawer.
Note: Each tone indicates a 1h delay.

7

Cancel wash/delay start

Press and hold ► .

- If there is any water in the drawer, it will automatically drain before the dishwasher turns off.

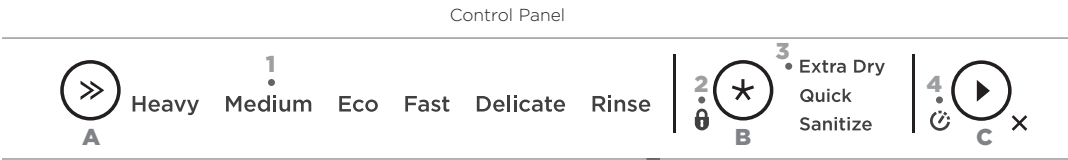

Indicators Description

- Off/On**
Opening the drawer will automatically turn the dishwasher on.
If the dishwasher is in an idle state, touch any button to reactivate it.
- 1 Wash program indicators**
If lit:
The wash program has been selected.

2 Lock indicator
If lit:
Keylock or childlock is activated.
- 3 Wash modifier indicators**
If lit:
The wash modifier has been selected. The wash program length and temperature will be modified accordingly.

4 Delay start indicator
If lit:
Delay start is set. The wash program will start after the selected time delay (1-12h)

Controls Description

- A WASH PROGRAM SELECTOR**
Press >> to scroll through the wash program options.

See opposite table for program descriptions.

- B WASH MODIFIER SELECTOR**
Press ★ to scroll through the wash modifier options.
Note: Not all modifiers are available for all wash programs.

Keylock
Disables all the buttons (helpful when cleaning the dishwasher).

To activate:
Press and hold ★ until you hear a tone. The lock indicator will light up.

Childlock
Disables all the buttons and locks the drawer closed (preventing unauthorised use by children).

To activate:
Press and hold ★ until you hear two tones. The lock indicator will light up.

To cancel keylock/childlock:
If the drawer is open
Press and hold ★ until you hear a tone. The lock indicator will go out.

If the drawer is closed
Knock three times on the door.

WASH PROGRAM	DESCRIPTION
Heavy	Heavily soiled pots, pans and dishes.
Medium	Dishes that are quite heavily soiled or food soils that have been left to dry overnight.
Eco (default setting)	Normally soiled dishes for optimum water and energy usage. The US/Canada Energy Guide is based on this program.
Fast	Lightly soiled dishes.
Delicate	Lightly soiled and heat sensitive crockery.
Rinse	Prevents odours and soils from drying on dishes.

- C START SELECTOR (either on door or inner control panel)**
To start wash:
Press ► to start the wash.

To Pause:
Knock twice on the door of the dishwasher.

- Wait for three short and one long tone before opening the drawer.
- Forcing it open mid cycle may cause damage or injury.**
- If the drawer is not restarted within seven minutes it will sound intermittently until it is restarted.

Delay start
Press and hold ► to set the delay start time. Each tone indicates a 1h delay (up to 12h). The delay start indicator will light up.

- If you scroll past 12h the dishwasher will exit delay start. To re-enter delay start follow step 1 above.
- The wash will start when the delay time is over, provided the drawer is closed.

DD24 models only (USCA)
If drawer is not closed within 4 seconds of setting delay start, OR If the drawer is opened after delay start has been set (for example, to load more dishes), delay start will be suspended.

To resume:
Press ► and close the drawer .

Cancel wash/delay start ✕
Press and hold ► .

- If there is any water in the drawer, it will automatically drain before the dishwasher turns off.

DURING AND AFTER THE WASH

During the wash the button on the dishwasher door will be illuminated.
At the end of the wash the dishwasher will beep six times and the button will stop being illuminated.



- You may notice the following noises at the end of the wash. These are all part of normal operation:
- Both drawers may be draining simultaneously.
 - The drying fan may continue to run after a wash program has finished for a set time or until the drawer is opened. The fan assists with drying and uses negligible amounts of energy.

For best drying results, we recommend unloading the dishes within a few hours after a wash program has finished.

DOS AND DON'TS OF LOADING

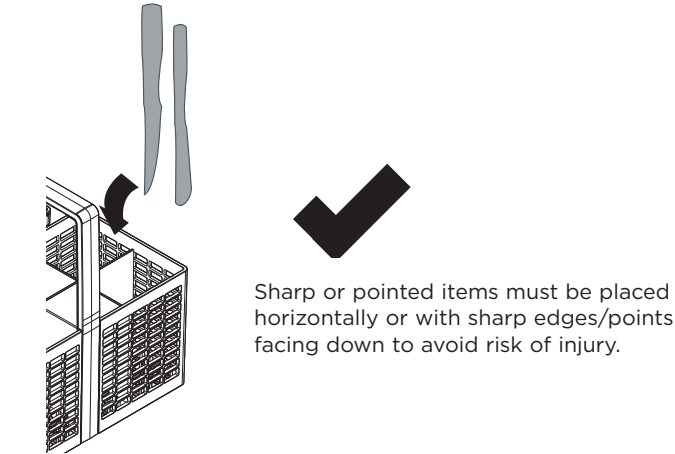

Sharp or pointed items must be placed horizontally or with sharp edges/points facing down to avoid risk of injury.

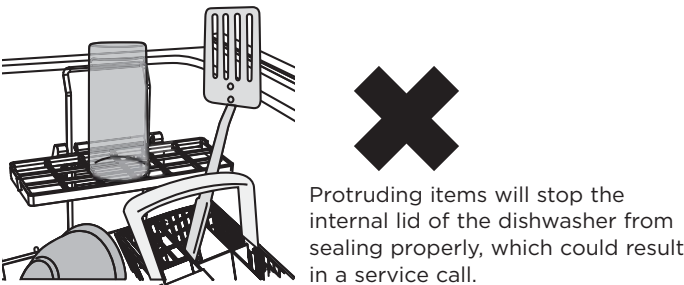

Protruding items will stop the internal lid of the dishwasher from sealing properly, which could result in a service call.



A neatly arranged load with evenly spaced dishes helps wash performance.

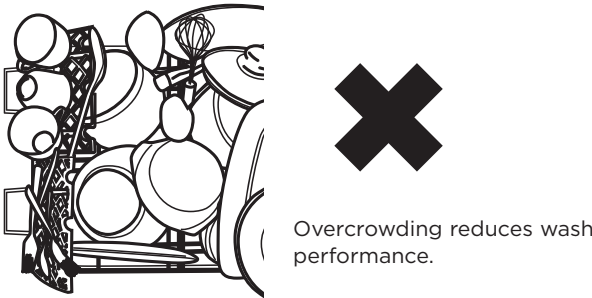

Overcrowding reduces wash performance.

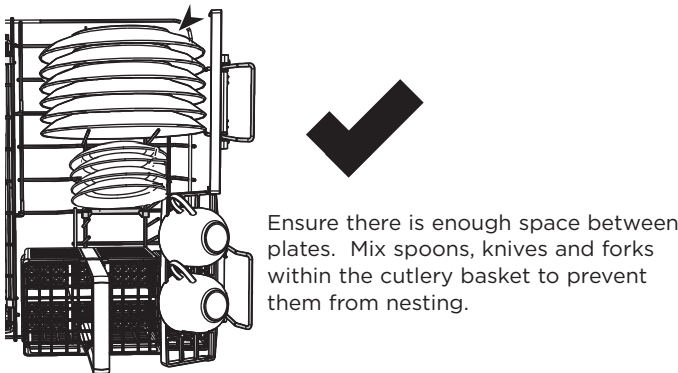

Ensure there is enough space between plates. Mix spoons, knives and forks within the cutlery basket to prevent them from nesting.

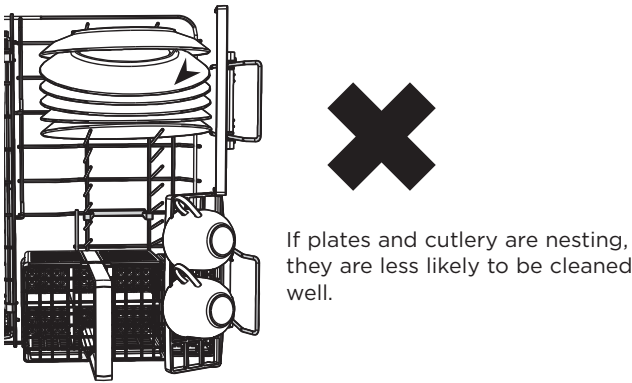

If plates and cutlery are nesting, they are less likely to be cleaned well.

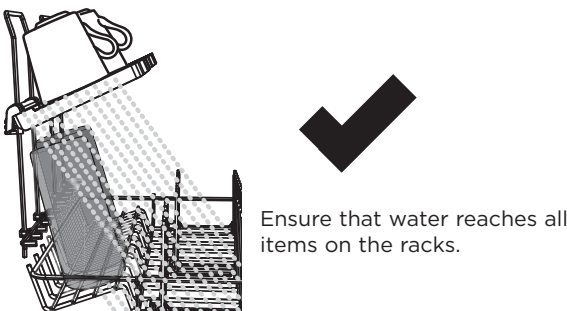

Ensure that water reaches all items on the racks.

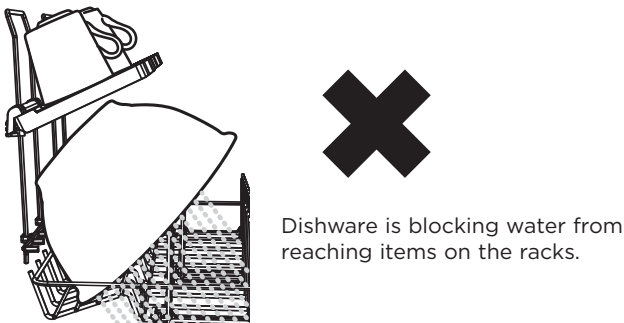

Dishware is blocking water from reaching items on the racks.

PREFERENCE OPTIONS

You can change the setting of these options to suit your preferences or circumstances. We recommend selecting the most suitable settings before you start using your dishwasher.

OPTION	RINSE AID	WATER SOFTENER (SOME MODELS ONLY)	OPEN DRAWER AUTO POWER-ON (SUITABLE AS A SABBATH OPTION)	TURN TONES OFF	CLOSED DRAWER AUTOLOCK
What does it do?	Regulates the amount of rinse aid dispensed. Reduce this setting if there is excess foam after a wash. Increase this setting if dishes are wet or streaky after a wash.	Refer to the 'Water softener' section of the 'User guide' for details.	Your dishwasher is factory-set to automatically power on for 30 seconds whenever you open the drawer. You can turn this setting off.	This turns all tones off except for fault alerts.	When this setting is on, the drawer will automatically lock 30 seconds after it's closed. It can then be unlocked by knocking once on the dishwasher door. Useful in boats or motor homes.

How to change the setting of an option

- CHECK
Check that there is no wash underway, then open the drawer.
- ENTER MENU
To enter the menu: Press and hold the **>>** and **★** together for four seconds.
 - You are now in the Rinse aid option of the preference options menu.
 - To change the Rinse aid setting, go to step 4 now.
- SCROLL TO OPTION
Press **★** to scroll to the next option. The wash modifier indicators will display which option is selected (see table below). When you have scrolled to the end of the sequence, the menu will start again with Rinse aid.
- CHANGE SETTING
Press **>>** to change the setting within an option. The wash program indicators will display which setting is selected (see table below).
- SAVE SETTING & QUIT MENU
Press **▶** to save the new setting and quit the preference options menu.

Double models only:
You can use either drawer to change the settings. Changing the settings in one tub will set your preferences for the whole dishwasher.

OPTION	RINSE AID	WATER SOFTENER (SOME MODELS ONLY)	OPEN DRAWER AUTO POWER-ON (SUITABLE AS A SABBATH OPTION)	TONES AT END OF WASH	CLOSED DRAWER AUTOLOCK
Which option am I in?	↗ Extra Dry Quick Sanitize	Extra Dry ↗ Quick Sanitize	Extra Dry Quick ↗ Sanitize	↗ Extra Dry ↗ Quick Sanitize	↗ Extra Dry Quick ↗ Sanitize
Possible settings	0 to 5 (max)	0 to 5 (max)	On or Off	On or Off	On or Off
Example	4 indicators lit = setting 4 ↗ Heavy ↗ Medium ↗ Eco ↗ Fast Delicate Rinse 1 indicator lit = setting 1 ↗ Heavy Medium Eco Fast Delicate Rinse			On ↗ Heavy Medium Eco Fast Delicate Rinse Off Heavy Medium Eco Fast Delicate Rinse	

FOR MORE INFORMATION

- For detailed information on the features of your dishwasher

>

see your 'User guide'
- For warranty information

>

see your 'Service and warranty' booklet
- If you...
 - have any questions or comments
 - need a Fisher & Paykel authorized technician to service your product
 - need replacement parts or accessories
 - want to register your product

>

see your 'Service and warranty' booklet or contact us via our website:

www.fisherpaykel.com



DD24SI9_N

Single DishDrawer™ Dishwasher, 7 Place Settings, Panel Ready

Integrated

This Fisher & Paykel Single DishDrawer™ Dishwasher is integrated into your kitchen for a seamless look.

Integrated

Dimensions

Depth	22 1/2"
Height	16 1/8"
Width	23 9/16"

Features & Benefits

Ease of use

DishDrawer™ Dishwashers are as easy to open and close as kitchen drawers and can be conveniently positioned at bench height for ease of loading and minimal bending. Flexible racking allows you to make adjustments to fit in a variety of dishes.

Quick, Sanitize and Extra Dry options

The Quick wash modifier delivers a faster wash while maintaining performance. The Sanitize option provides extra protection killing 99.9% of bacteria in the final rinse. The Extra Dry setting is perfect for plastic dishes.

Knock to pause

Instead of needing a remote control, these DishDrawer™ Dishwashers have a knock to pause function. A knock on the front panel will pause the dishwasher which can be re-started again by using the start/play button.

Quiet performer

Running at a very low decibel rate, these DishDrawer™ Dishwashers do their job without making a fuss. The combination of intelligent technology and simple mechanics means greater reliability and excellent wash performance.

Specifications

Accessories

Cutlery basket	•
Knife clip & Multipurpose clip	•
Optional handle	513545 D3 front mount fitting kit
Optional stainless steel door kit	81262 Door DD24S

Capacity and loading

Accommodates plates up to	11"
Adjustable height, foldable cupracks	•
Fold down tines	•
Pitch adjustable tines	•
Place settings	7

Control

Child lock	•
Electronic fault/Diagnostic indicator	•
End of cycle beeps	•
Energy saving delay start option up to 12 hrs	•
Internal wash selector	•
Knock to pause	•
Rinse aid indicator light	•



A PEACE OF MIND SALE
24 Hours 7 Days a Week Customer Support
T 1.888.936.7872 W www.fisherpaykel.com

Features	
Fan assisted drying	•
Flow through detergent dispenser	•
Quiet operation	•
SmartDrive™ technology	•

Performance	
Energy star	•
Energy usage	144 kWh/year
Noise (dBa) on delicate cycle top drawer	44
Water usage	1.64 gal/cycle

Power requirements	
AMP draw	5 A
Rated current	15 A
Supply frequency	60 Hz
Supply voltage	120 V
Wire	3

Style And Series	
Product Style	Integrated

Warranty	
Warranty	Limited 2 Year Parts & Labor

Wash programs	
Delicate	•
Eco	•
Extra Dry	•
Fast	•
Heavy	•
Medium	•
Quick	•
Rinse	•
Sanitize	•
Wash modifiers	3
Wash programs	15

Water connection	
Supplied hose to suit 9mm male compression fitting	•
Water connection	Max 140°F
Water pressure	0.03 Mpa - 1 Mpa (4.3-145 psi)

SKU	81221
-----	-------

The product dimensions and specifications in this page apply to the specific product and model. Under our policy of continuous improvement, these dimensions and specifications may change at any time. You should therefore check with Fisher & Paykel's Customer Care Centre to ensure this page correctly describes the model currently available. © Fisher & Paykel Appliances Ltd 2019

Other product downloads available at fisherpaykel.com
www.fisherpaykel.com