

CUT PATTERN	
BACK FRAME NO.	
BASE FRAME NO.	
WOOD PATTERN	

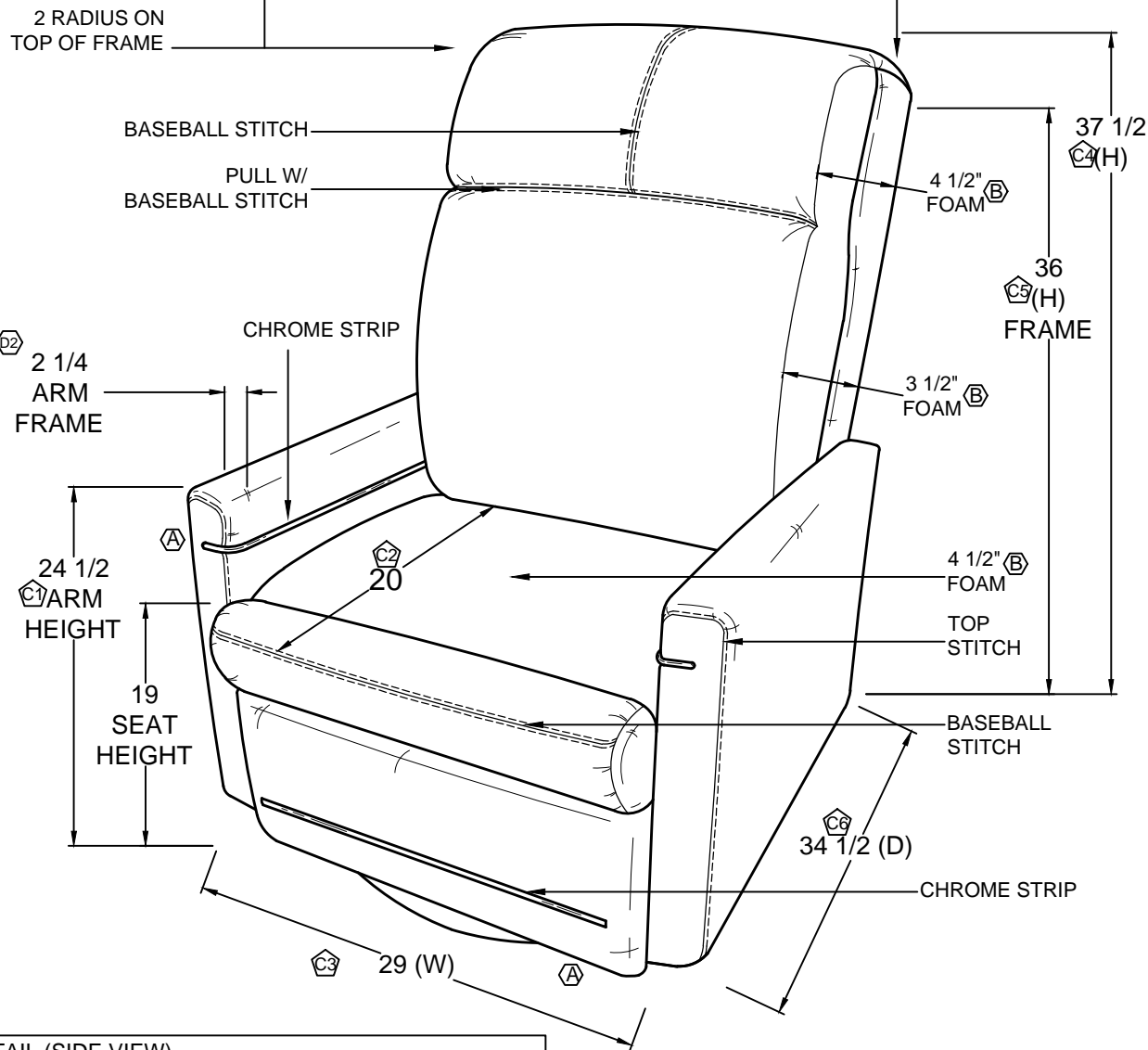

D1

*ARM FRAME DETAIL (SIDE VIEW)

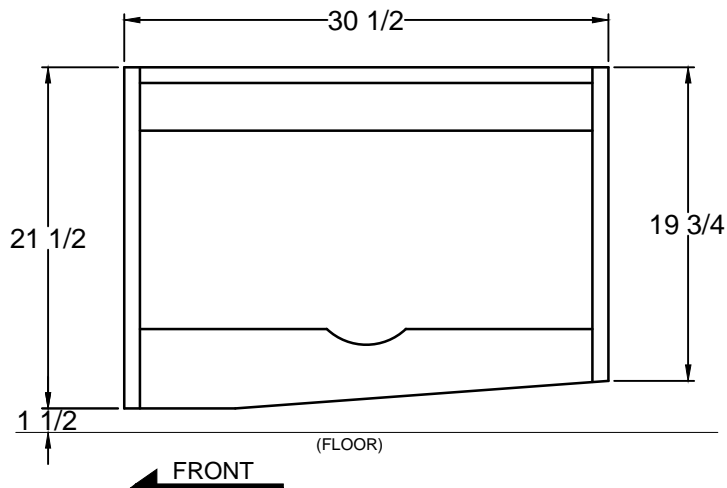

JA	D	PRODUCTION UPDATE: [1] ADD ARM FRAME DETAIL. [2] CHANGE ARM FRAME WIDTH TO 2-1/4"; WAS 2".	01.29.19
FP	C	PER RL: [1] ADJUSTED ARM HEIGHT TO 24 1/2" WAS 21"; [2] ADDED DIMENSION OF 20"; [3] ADJUSTED WIDTH TO 28 1/2" WAS 29"; [4] ADJUSTED G.A. HEIGHT TO 37 1/2" WAS 40 1/2"; [5] ADJUSTED FRAME HEIGHT TO 36" WAS 38"; [6] ADJUSTED DEPTH TO 34 1/2" WAS 36 1/2"	01.02.19
AC	B	PRODUCTION UPDATE: ADDED FOAM INFORMATION.	03.27.18
JA	A	PER RL, CHROME STRIP ADJUSTMENTS.	03.21.18

REVISIONS