

CUT PATTERN	
BACK FRAME NO.	
BASE FRAME NO.	
WOOD PATTERN	

2 RADIUS ON
TOP OF
FRAME

PULL

2 1/4
ARM
FRAME

24 1/2
ARM
HEIGHT

19
SEAT
HEIGHT

20
SEAT
DEPTH

4 1/2
FOAM

4 1/2"
FOAM
(UPPER BACK)

TOP
STITCH

3 1/2"
FOAM
(LOWER BACK)

EXPOSED
STITCH
CHANNELS

BASEBALL
STITCH

EXPOSED
STITCH
CHANNELS

37 1/2
(H)

36
FRAME
(H)

34 1/2
(D)

29 (W)

*ARM FRAME DETAIL (SIDE VIEW)

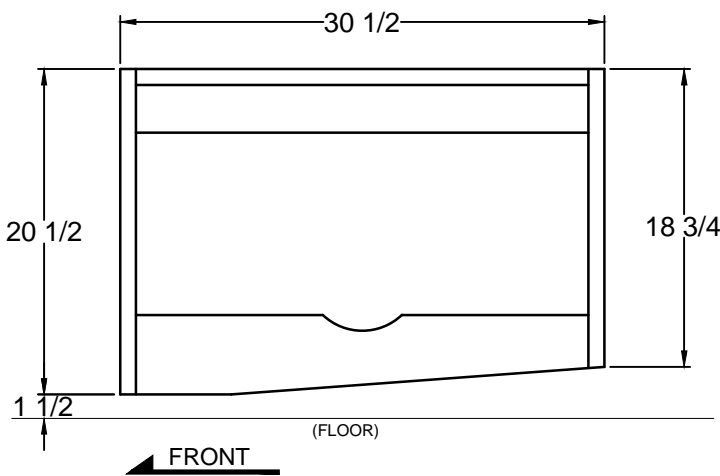

VILLA
INTERNATIONAL
13760 Midway St.
Cerritos, CA 90703
Tel 562-404-8111
Fax 562-404-7781

TITLE
2019 LONDON AIRE
3-PHASE ROCKER / RECLINER
W/ HOOP BASE

DWG. NO.
VI5000162
REV. C
DATE 03.07.18
JANCHETA

APV
JH
03.15.18

SCALE 1:1
DO NOT SCALE
DRAWING.
UNLESS OTHERWISE
SPECIFIED DIMENSIONS
ARE IN INCHES.

JA	C	[1] ADD SPRING CLIPS TO SEAT SPRINGS. [2] ADD 8x24 802 SPRINGS x4. [3] ADD 4-1/2" FOAM TO UPPER BACK & 3-1/2" FOAM TO LOWER BACK. (REF. ECO #029-2019). [4] MECHANISM LEG A410812333S 23" WIDE MECH W/ SWIVEL 4108-2. (REF. ECO #036-2019)	06.10.19
JA	B	PRODUCTION UPDATE: [1] ADD ARM FRAME DETAIL. [2] CHANGE ARM FRAME WIDTH TO 2-1/4"; WAS 2". [3] CHANGE ARM HEIGHT TO 24-1/2"; WAS 27". [4] CHANGE WIDTH TO 29"; WAS 28-1/2". [5] CHANGE DEPTH TO 34-1/2"; WAS 36-1/2". [6] CHANGE FRAME HEIGHT TO 36"; WAS 35-1/2". [7] CHANGE O.A. HEIGHT TO 37-1/2"; WAS 38". [8] ADD 20" SEAT DEPTH. [9] ADD 4-1/2" SEAT FOAM	01.28.19
JA	A	PER RL, O.A. HEIGHT IS 38"; WAS 40-1/2".	11.08.18

REVISIONS