

2 RADIUS ON
TOP OF
FRAME

PULL

2 1/4
ARM
FRAME

24 1/2
ARM
HEIGHT

19
SEAT
HEIGHT

20
SEAT
DEPTH

4 1/2
FOAM

4 1/2"
FOAM
(UPPER BACK)

TOP
STITCH

3 1/2"
FOAM
(LOWER BACK)

EXPOSED
STITCH
CHANNELS

BASEBALL
STITCH

EXPOSED
STITCH
CHANNELS

34 1/2
(D)

29 (W)

37 1/2
(H)

36
FRAME
(H)

CUT PATTERN	
BACK FRAME NO.	
BASE FRAME NO.	
WOOD PATTERN	

*ARM FRAME DETAIL (SIDE VIEW)

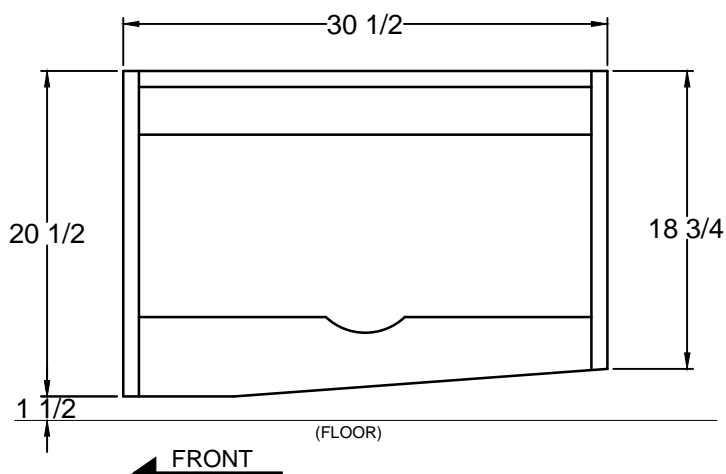

*NOTE:

- CONNECT SEAT WRAP TO FOOTREST PANEL.
(REF. ECO #059-2019)
- ADD BLACK DECKING SKIRT INSIDE FOOTREST.

JA	D	ADD NOTES TO CONNECT WRAP TO FOOTREST PANEL, AND ADD BLACK DECKING SKIRT TO INSIDE FOOTREST. (REF. ECO #059-2019)	02.24.2020
JA	C	[1] ADD SPRING CLIPS TO SEAT SPRINGS, [2] ADD 8x24 602 SPRINGS x4, [3] ADD 4-1/2" FOAM TO UPPER BACK & 3-1/2" FOAM TO LOWER BACK, (REF. ECO #029-2019), [4] MECHANISM LEG A410812333S 23" WIDE MECH W/SWIVEL 4108-2, (REF. ECO #059-2019)	06.10.19
JA	B	PRODUCTION UPDATE: [1] ADD ARM FRAME DETAIL, [2] CHANGE ARM FRAME WIDTH TO 2-1/4", WAS 2", [3] CHANGE ARM HEIGHT TO 24-1/2", WAS 27", [4] CHANGE WIDTH TO 29", WAS 28-1/2", [5] CHANGE DEPTH TO 34-1/2", WAS 36-1/2", [6] CHANGE FRAME HEIGHT TO 36", WAS 35-1/2", [7] CHANGE O.A. HEIGHT TO 37-1/2", WAS 38", [8] ADD 20" SEAT DEPTH, [9] ADD 4-1/2" SEAT FOAM	01.28.19
JA	A	PER RL, O.A. HEIGHT IS 38", WAS 40-1/2".	11.08.18