

<i>ITEM #</i>	<i>QTY</i>	<i>NEWMAR #</i>	<i>DESCRIPTION</i>
1	1	158211	TANK FRESH, 150 GAL

## TOP VIEW

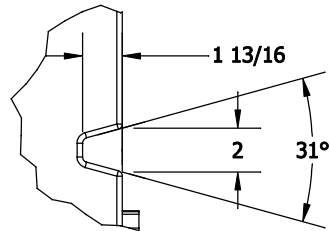

## DETAIL A

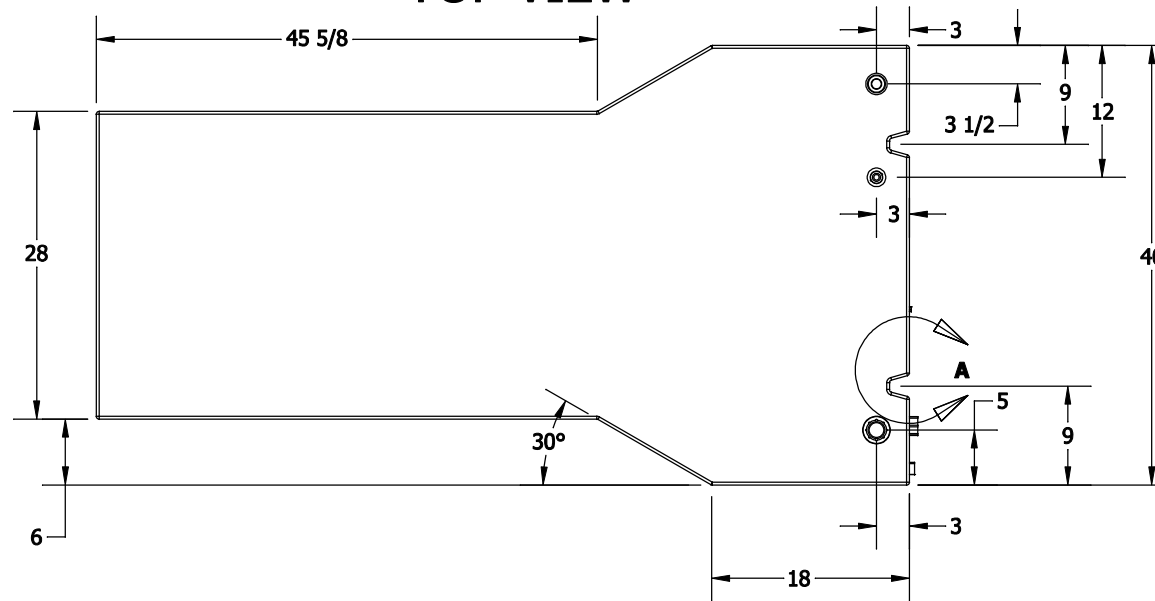
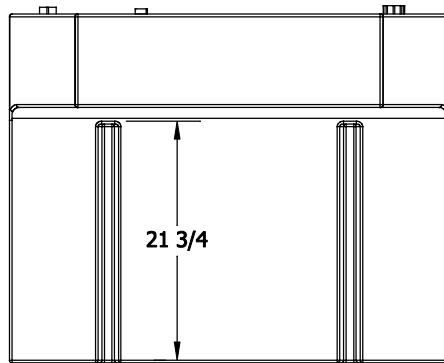

## REAR VIEW

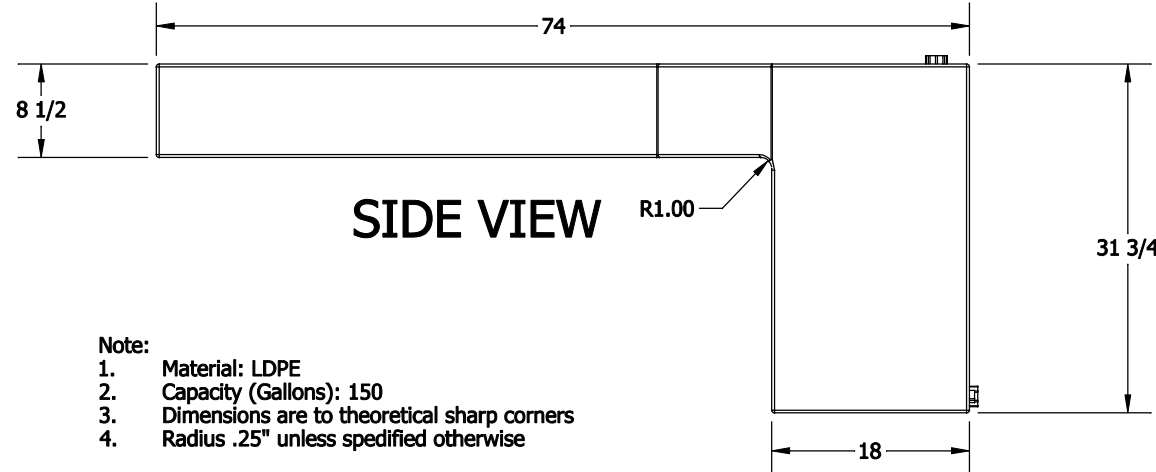

## SIDE VIEW

**Note:**

- 1. Material: LDPE**
- 2. Capacity (Gallons): 150**
- 3. Dimensions are to theoretical sharp corners**
- 4. Radius .25" unless specified otherwise**

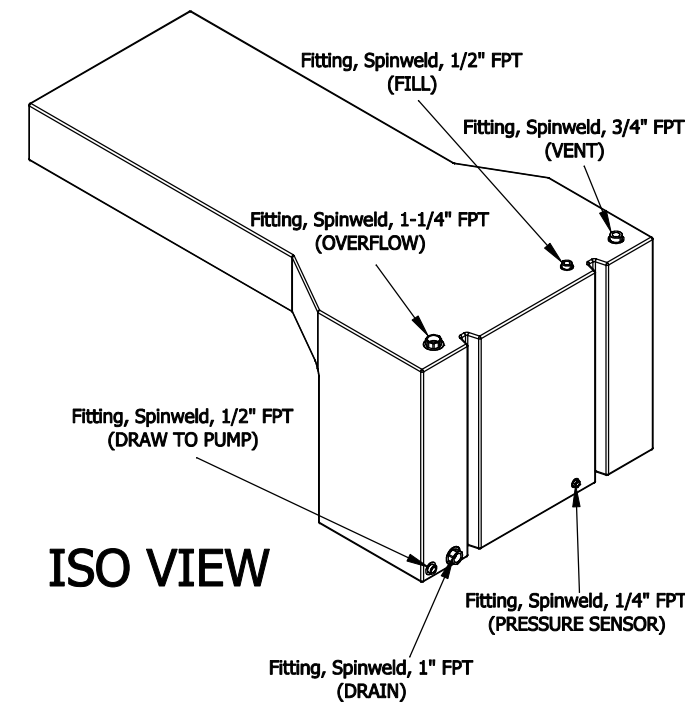

## ISO VIEW

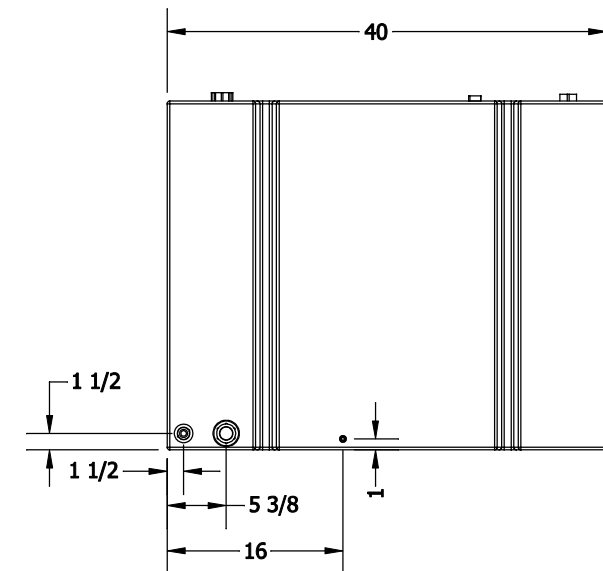

### FRONT VIEW

NOTE:  
PRESSURE SENSOR AND FITTING TO BE INSTALLED BY NEWMAR

<b>NEWMAR CORP</b> <b>P.O. Box 30,</b> <b>Nappanee, IN. 46550</b>  UNITS: INCHES TITLE BLOCK: 80D	Model:	Sheet	Drawn by:	Checked by:	Revision: Added location and detail for the pressure sensor and fitting;	By: R. W.
	SACC/SSCC (SEE INDEX)	1 OF 1	M. R.	M. N.	Added note stating pressure sensor and fitting to be installed by Newmar (PCR #221643)	Date: MN 1/31/22
	Title:	I.D. # 2022\CC\TANKS	Date:	Date:	Revision: ADDED A 1/2" FPT TO THE TOP OF THE FRESH TANK, AND ADDED NOTES	By: M. R.
	FRESH TANK	MISC6001	6/14/21	6/15/21	DESCRIBING WHAT EACH FITTING IS FOR (PCR #221299)	Date: MN 9/13/21