

ITEM #	OPTION	NEWMAR #	DESCRIPTION
5	STD.	159437	PASSI-FM-----ASBS23412
6	STD.	159438	PASSI-FM-----ASBS23422
7	STD.	159439	PASSI-FM-----ASBS23432
8	STD.	154077	RISER 10.0 PASS SEAT PED
9	STD.	155260	TABLET HOLDER
10	STD.	162428	INTEGRT SEAT BELT PED ST PLATE

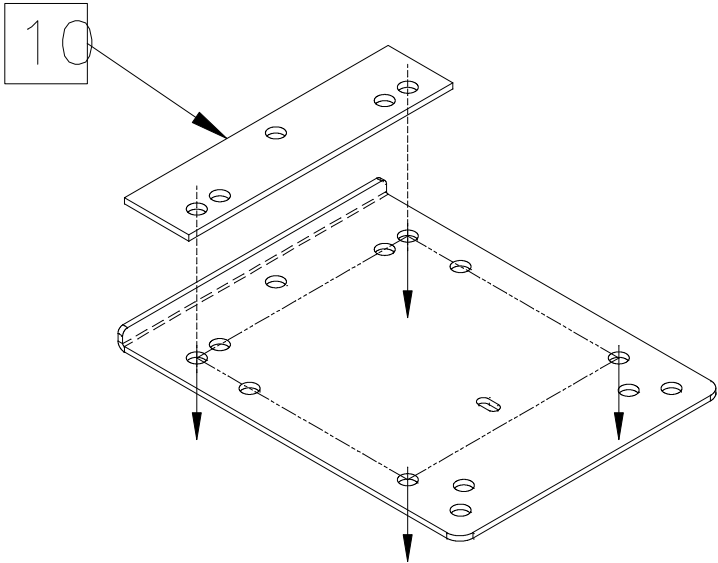

PEDESTAL TO BE MOUNTED TO FLOOR
USING THE REARWARD MOST SET OF
MOUNTING HOLES THEREBY LOCATING THE
SEAT AS FAR FORWARD AS POSSIBLE

PEDESTAL DETAIL

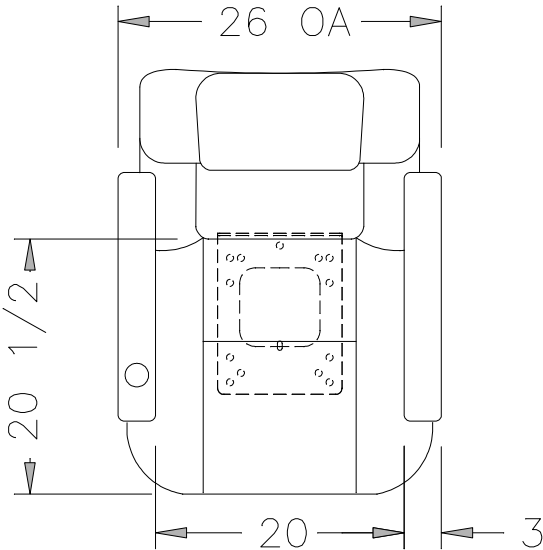

TOP VIEW

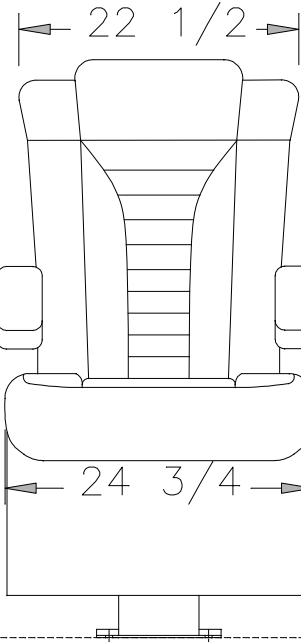

FRONT VIEW

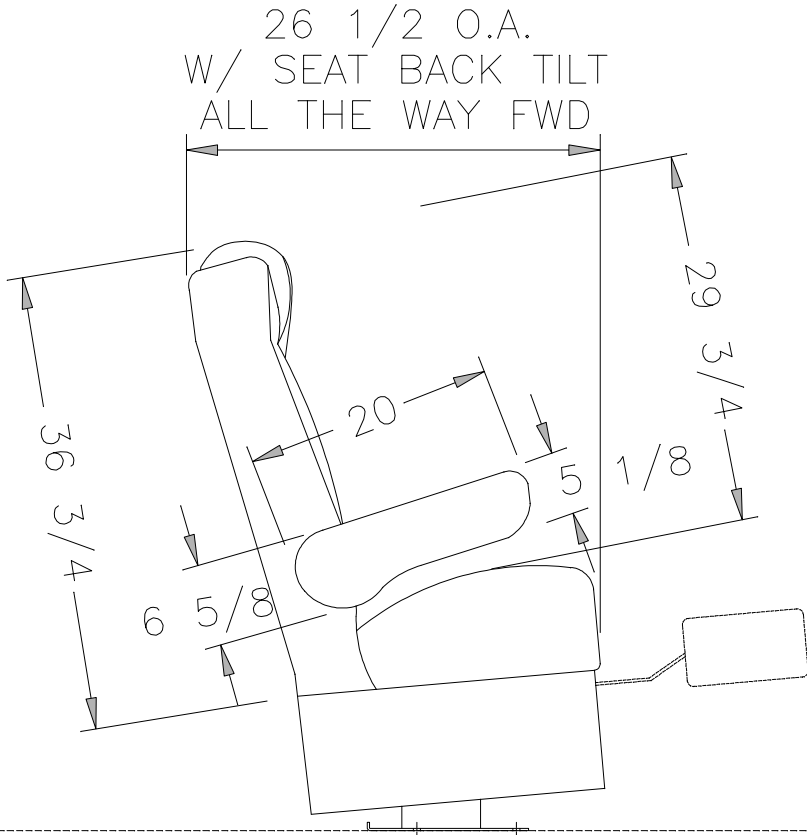

SIDE VIEW

NEWMAR CORP P.O. Box 30, Nappanee, IN. 46550 UNITS: INCHES TITLE BLOCK: 1TB	Model:	Sheet	Drawn by:	Checked by:	Revision: UPDATED ARROWS AND REF LINES TO CORRECTLY DEPICT WHERE BOLTS	By: M. G.
	BSCA (SEE INDEX)	2 OF 2	M. G.	D. E.	GO INTO THE FLOOR AND THROUGH PEDESTAL. (PCR #231573)	Date:DE 4/6/22
	Title:	I.D. # 2023\	Date:	Date:	Revision: ADDED PASSENGER SIDE STIFFENER PLATE, PART #162428 AND UPDATED	By: M. G.
	PASSENGER SEAT	FURN\WILLIAMSBURG\BSCA\COCKPIT_SEATS	11/4/21	12/2/21	ISO VIEW. (PCR #230981)	Date:DE 2/7/22