

23' CENTER BATH TANDEM

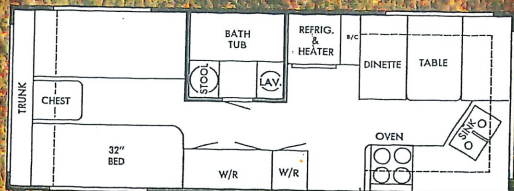

22' F.K. SIDE BATH

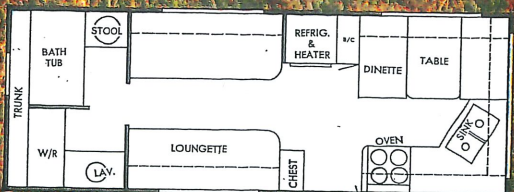

22' F.K. REAR BATH

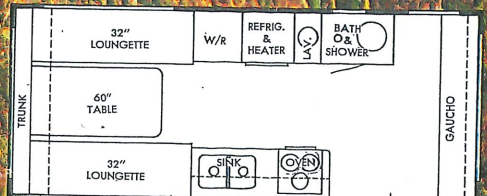

21' TWIN LOUNGE TANDEM

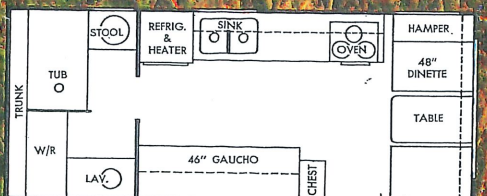

21' REAR BATH TANDEM

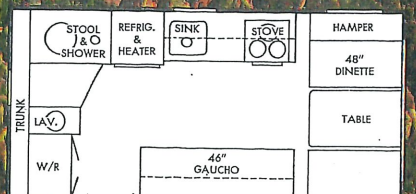

19' REAR BATH



17' REAR BATH

Also available 17' thru 27' models



NEWMAR INDUSTRIES

POST OFFICE BOX 42
NAPPANEE, INDIANA 46550
TELEPHONE (219) 773-7791

Prices and Specifications subject to change without notice
Printed in U.S.A.

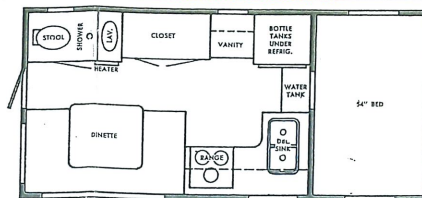

11' MODEL

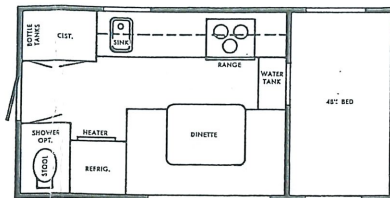

10'6" MODEL

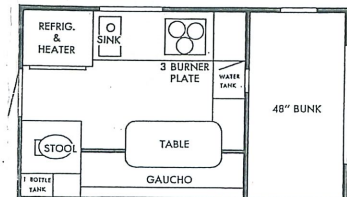

9' MODEL

GENERAL SPECIFICATIONS

Vinyl covered ceiling and floor • Aluminum exterior 2 colors • All safety glass windows • Full radius corners and cap • 24" door with full length screen door • 1½" of Fiber-glass side walls and roof • Foam core insulated ceiling and floor • Vapor barrier insulation throughout • 2-12 volt/110 volt combination lights • 4 - 12 volt lights • 2-110 volt receptacles • 25 foot 110 volt power supply cord • ICC lights with back-up light • 40" Dinette, 5" polyfoam cushions or 46 x 74 gauchos • Extra large cab-over sleeping area with 4" mattress • Pedestal revolving table • Decorator designed draperies • 2-Roof vents—1-lite aire • 2-gas bottles with regulator • 3-burner range with oven w/hood and power vent • M-28 Dometic gas refrigerator • 10,000 BTU furnace • Gas light • 20-gallon pressure water system with gage • Thetford marine stool and holding tank • 3-camper lifts • Wire mesh disappearing rear safety step.

Standard Extras on 11' Model

Shower • water heater • lavatory in bath • 30-gallon water tank • double sink • outdoor-indoor carpet • air compressor • 54" bed • wall thermostat for heater • M-40 Dometic refrigerator.

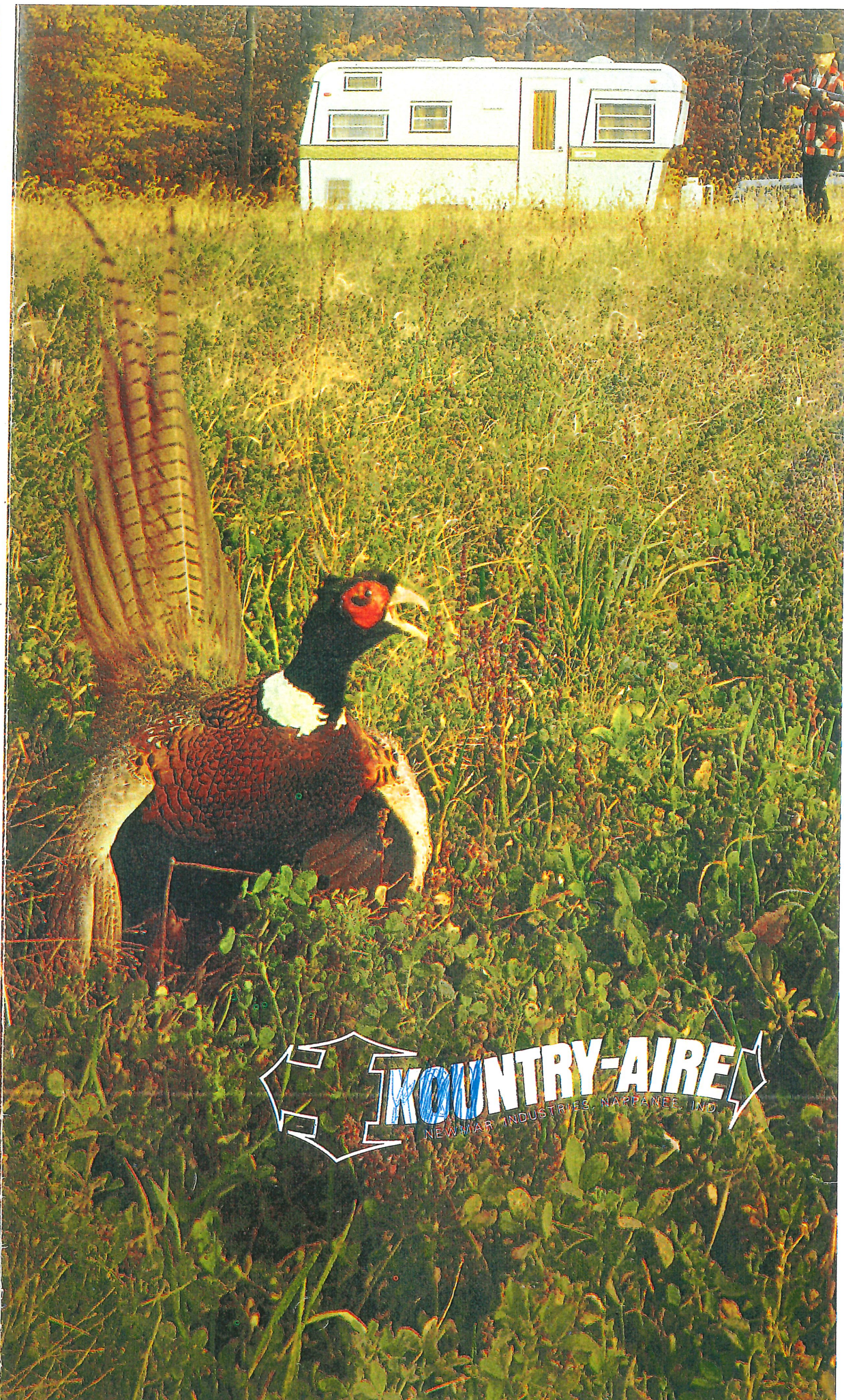

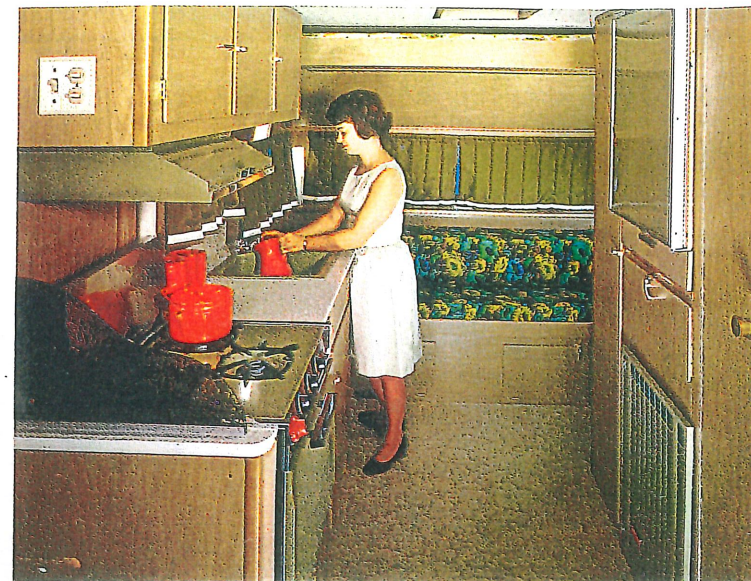
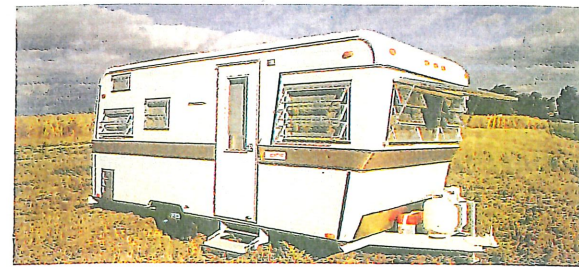

The "going" will be great
in a Travel Trailer or
Truck Camper by

KOUNTRY-AIRE
NEWMAR INDUSTRIES, NAPPANEE, IND.

Let's face it,
more than half the
fun of your vacation is getting
there . . . So, why not travel in the
luxury and comfort of one of
KOUNTRY-AIRE'S many beautiful
models. Twentieth century living
comforts and requirements have been
made an integral part of
KOUNTRY-AIRE'S Travel Trailers
and Truck Campers. Among the
luxuries and comforts **KOUNTRY-
AIRE** Travel Trailers and Truck
Campers have to offer are, vinyl covered ceilings, 2 color aluminum exteriors, safety glass
windows, 5" polyfoam cushion and gauchio, decorator designed draperies and
name brand appliances. All interior upholsteries are decorator designed in exquisite
multicolored patterns and fabrics. **NEWMAR** Industries has gone overboard in
helping you to bring all the comforts of your own home along
on your vacation . . . What a way to go!

19' SIDE BATH

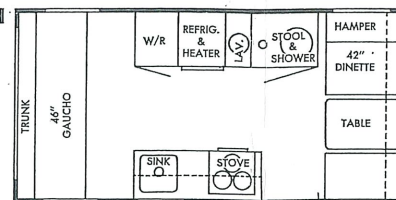

Campers have to offer are, vinyl covered ceilings, 2 color aluminum exteriors, safety glass
windows, 5" polyfoam cushion and gauchio, decorator designed draperies and
name brand appliances. All interior upholsteries are decorator designed in exquisite
multicolored patterns and fabrics. **NEWMAR** Industries has gone overboard in
helping you to bring all the comforts of your own home along
on your vacation . . . What a way to go!

GENERAL SPECIFICATIONS FOR ALL TRAVEL TRAILERS

Vinyl covered ceiling • Aluminum exterior, 2 colors • All safety glass windows • Full radius
corners and caps • 24" door with full length screen doors • 1 1/2" of Fiberglass



23' REAR BATH TANDEM

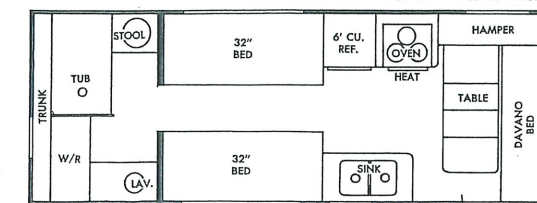

sidewalls and roof and floor • Foam
core insulated ceiling • Vapor barrier
insulation throughout • Metal
underbelly • 12 volt & 110 volt
combination lights • 12 volt lights •
110 volt receptacles • 25 ft. 110 volt
power supply cord • ICC lights
with back-up lights • 5" Polyfoam
cushion and gauchio • Decorator designed
draperies • Roof vents with lite
aire • 2 gas bottles rack and regulation • Power stove canopy • Gas light • 30-gal. water
tank • Gas water heater, shower or tub • Thetford marine stool • Built-in lavatory • Air
compressor • Battery and case • 12" brakes • 8-ply rated tires • Safety track axle design
• Shock absorbers • Convex trussed rafters.