

1974

Kountry Aire[®]

RECREATIONAL VEHICLES

WHERE THE GOING IS GREAT!

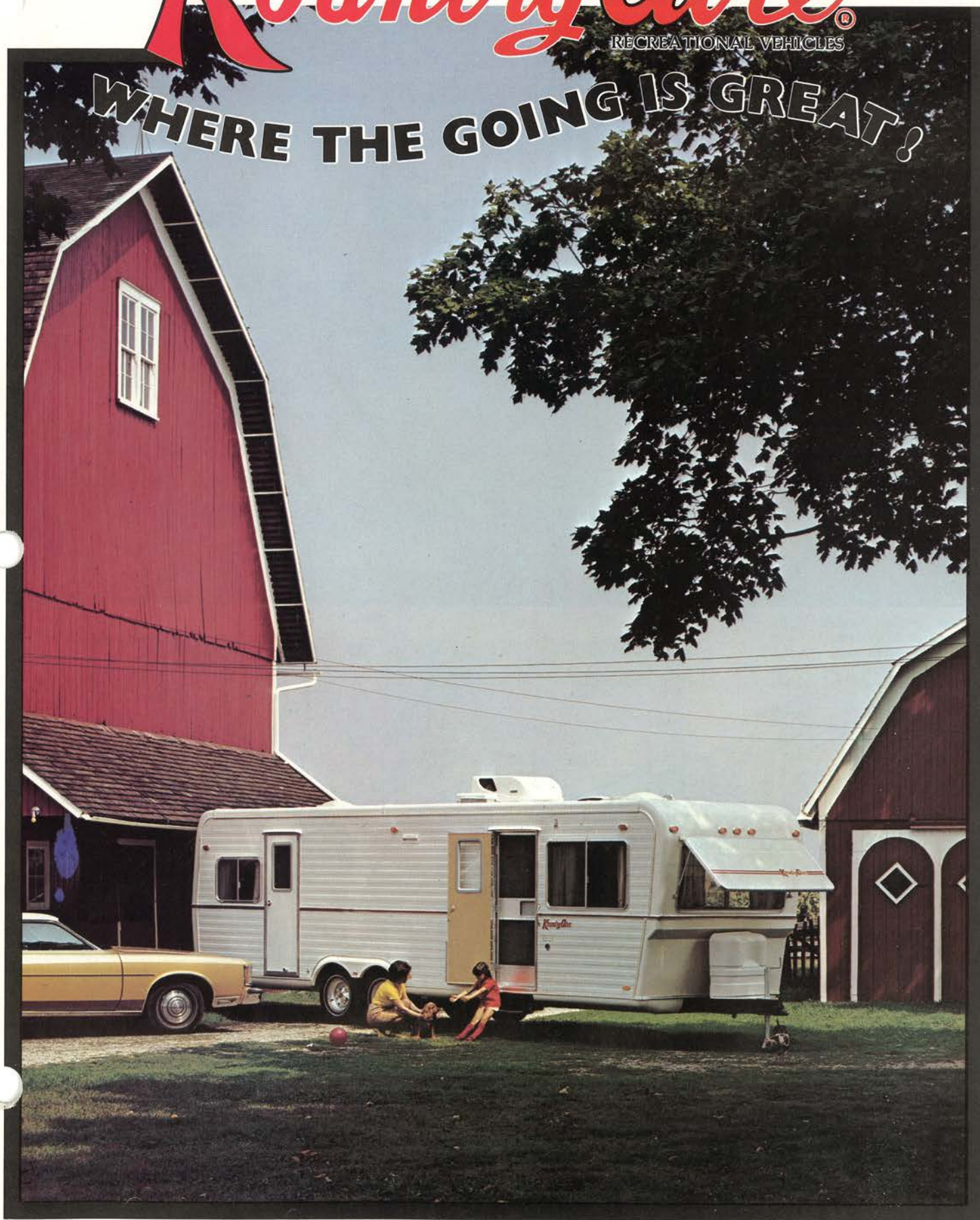

The 29' Kountry Aire Executive

Kountry Aire® travel trailers... just natural in the outdoors.

Kountry Aire travel trailers are engineered and styled to make your going in the outdoors great.

Venture out with a Kountry Aire. There's no need to stick to main roads and crowded campsites. All Kountry Aire travelers are totally self-contained for your convenience.

Relax in a Kountry Aire. Enjoy the comforts you're accustomed to: carpeting, fully equipped kitchens, ample living and storage room.

Personalize your Kountry Aire. Choose from four decorator color schemes: blue, gold, avocado or red. Select either Dusk Elm or Blond Elm wood paneling. With 13 models to choose from, there's certain to be a Kountry Aire to perfectly match your tastes and needs.

Enjoy living and traveling in a Kountry Aire. Whether it's a cross-country vacation or just a weekend trip, when you go in a Kountry Aire, you're going in a travel trailer with the best features for your comfort, convenience and safety. That's great going!

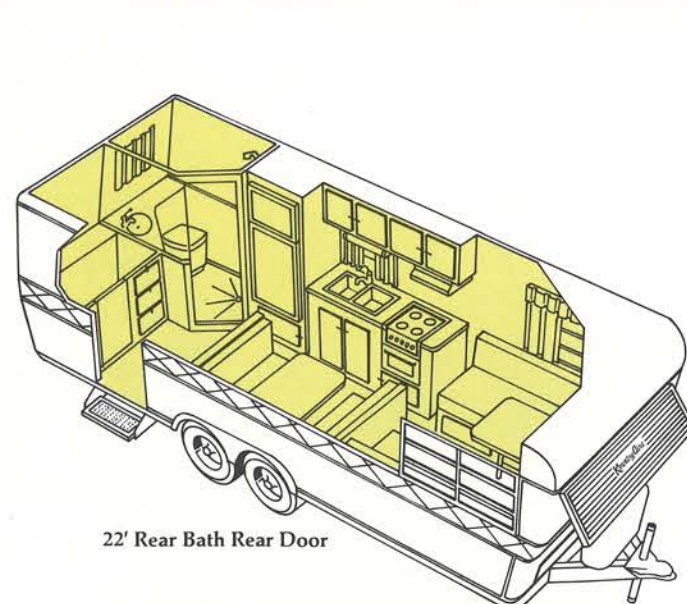

22' Rear Bath Rear Door

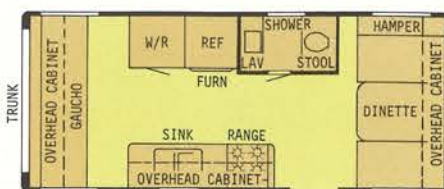

22' Side Bath

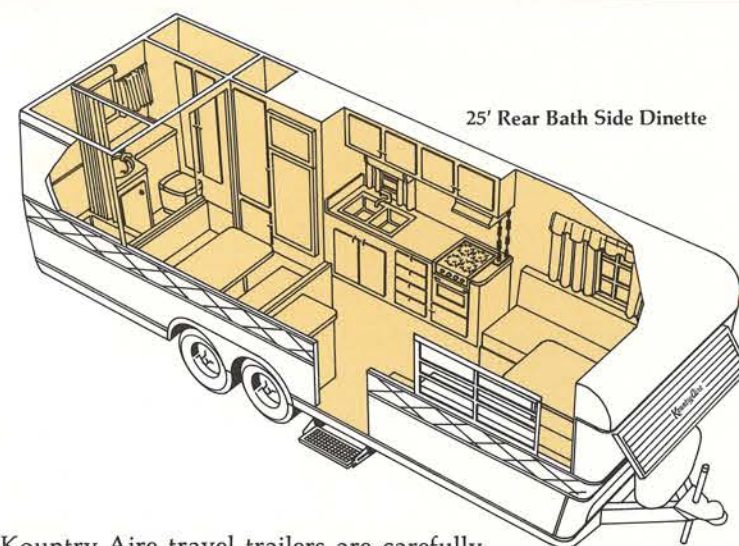

25' Rear Bath Side Dinette

Kountry Aire travel trailers are carefully designed to provide maximum living space while fully utilizing all possible storage areas. In the living areas, all Kountry Aires feature high quality carpeting, durable and stylish fabrics, and vinyl-finished wood paneling for easy maintenance.

COVER: The Kountry Aire Executive is available in most lengths. It has attractive and durable fiberglass front, back and roof. Large, slider windows complete the Executive's new look.

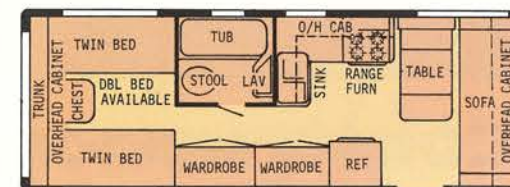

25' Center Bath

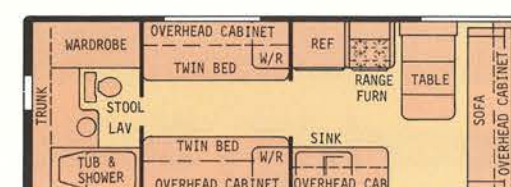

25' Rear Bath

LEFT: Indirect lighting adds a touch of intimacy to the attractive Kountry Aire living room. Draperies, furnishings and carpeting are all color coordinated.

ABOVE: Rich wood paneling, quality appliances and efficient floor plans combine to make work in the Kountry Aire kitchen enjoyable and easy.

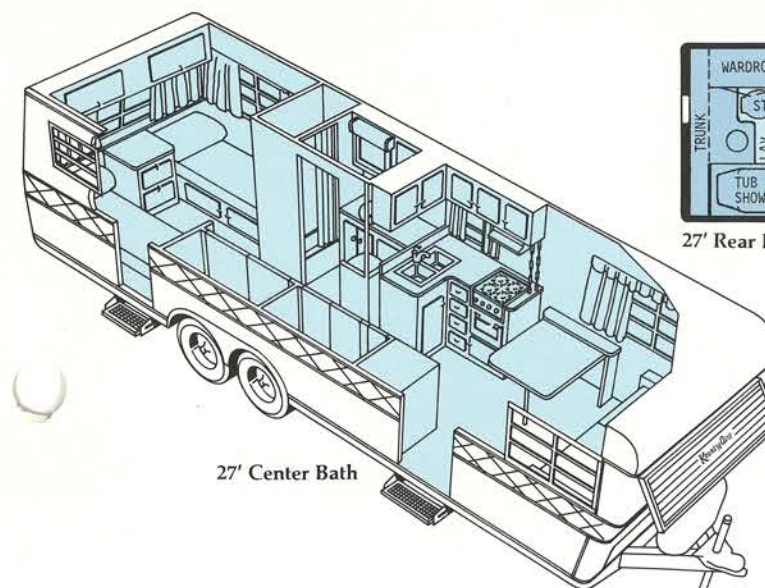

27' Center Bath

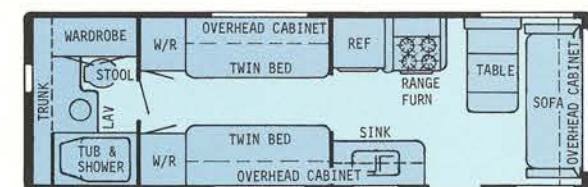

27' Rear Bath

Six cubic foot gas-electric refrigerators are standard in Kountry Aires. The kitchens also feature a 4-burner range with a bi-fold stainless steel cover, a see-through glass oven door and a double stainless steel sink. When lowered, the folding cover on the range top provides extra counter space.

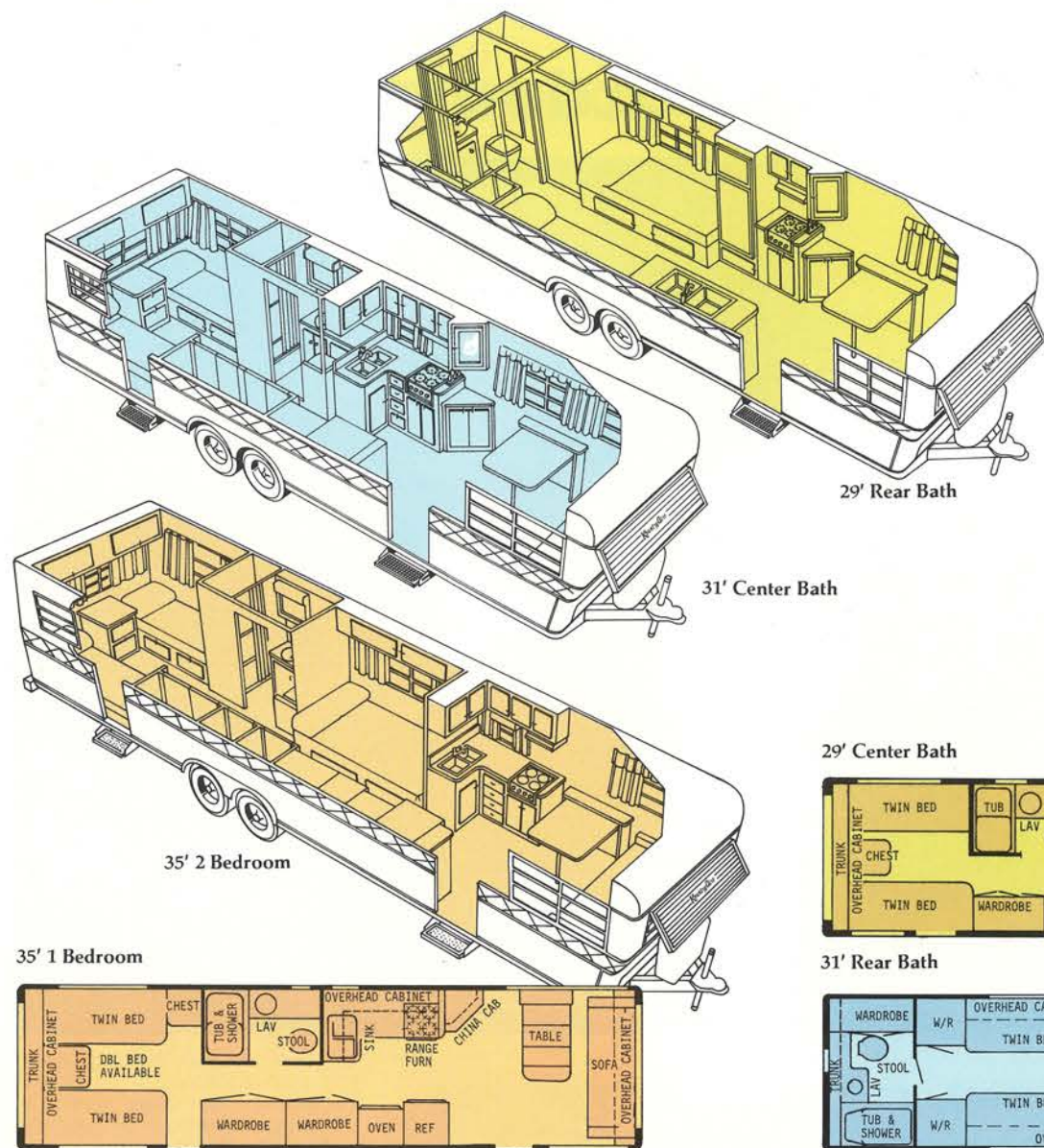

Bathrooms in the Kountry Aire travel trailers all feature a shower, lavatory and a marine-type stool with holding tank. A medicine cabinet with mirror is one of the many extras found throughout Kountry Aires.

Kountry Aires have 30-gallon water tanks with air compressors to assure you of an ample water supply. For power, the units utilize an 80 amp battery and a 12 volt converter. Gas is supplied from two 30 lb. bottles with automatic changeover.

For your traveling safety, Kountry Aire travel trailers feature 8 ply, rated tires, tandem axles, 12" brakes and shock absorbers on all wheels.

29' Center Bath

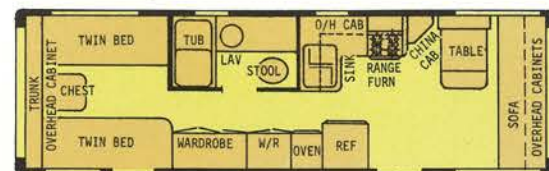

31' Rear Bath

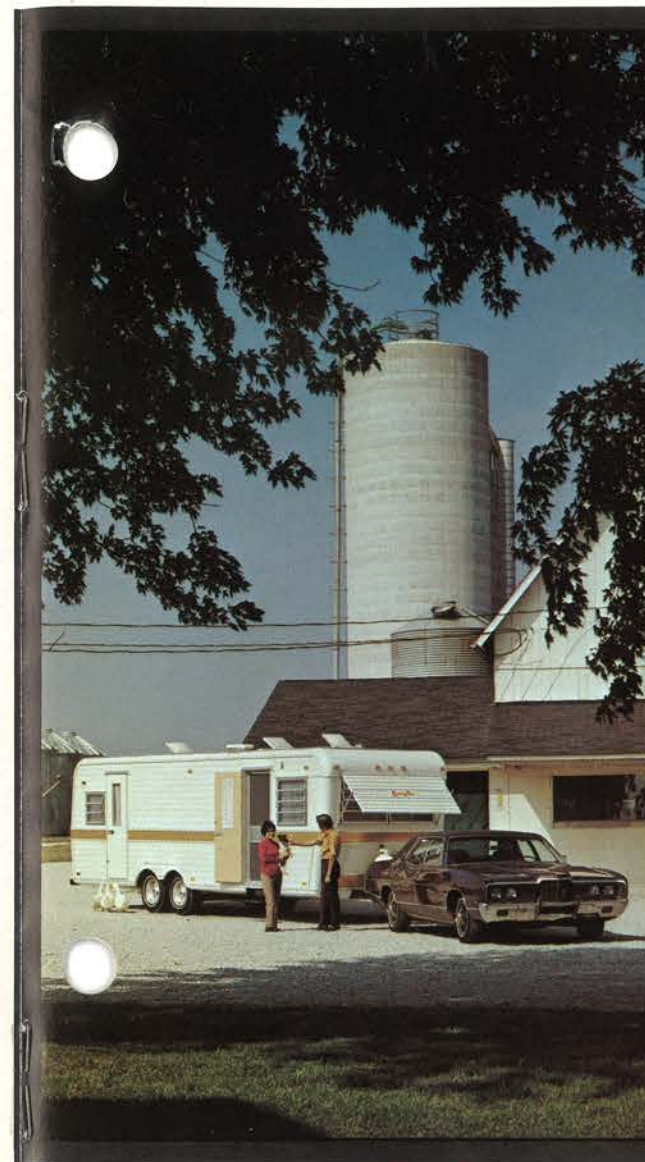
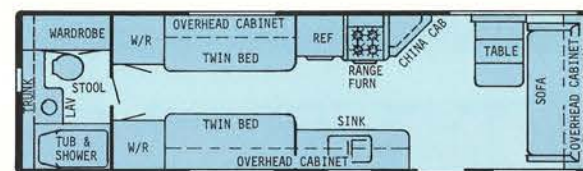

LEFT: Kountry Aire travel trailers are as attractive on the exterior as they are functional on the inside. The exterior is .030 prefinished aluminum with a gold anodized insert. The front decorative awning protects the windows during travel. The model shown is the 27' center bath.

ABOVE LEFT: Kountry Aire floor plans offer either side or rear baths. The side bath shown here has a molded fiberglass tub with sliding door. Storage space is provided in overhead cabinets and under the sink.

ABOVE RIGHT: The rear bath on this Kountry Aire features a large closet for storage of linens, clothes and other items. The sink is stainless steel with a contemporary mixing faucet.

Sound Engineering, Solid Construction in every *Kountry Aire* RV on the road.

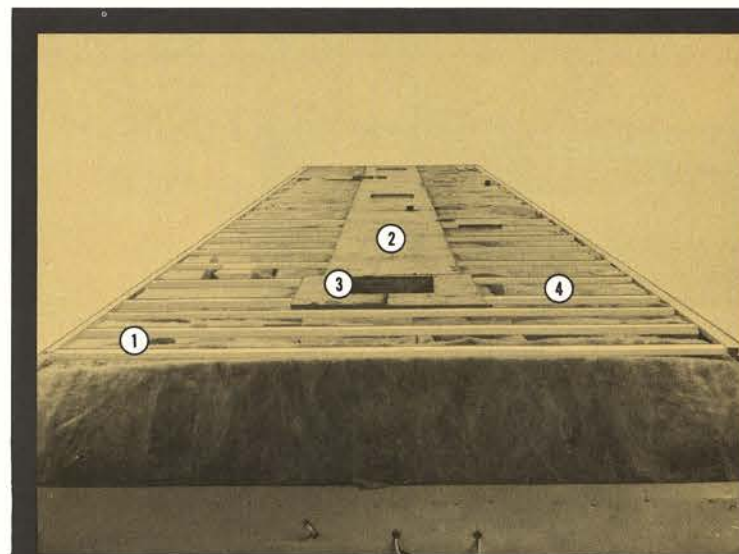

ROOF. Heavily Insulated.
(1) 2" x 4" rafters every 16". (2) 5/8" center construction. (3) Reinforced openings. (4) 3" fiberglass insulation.

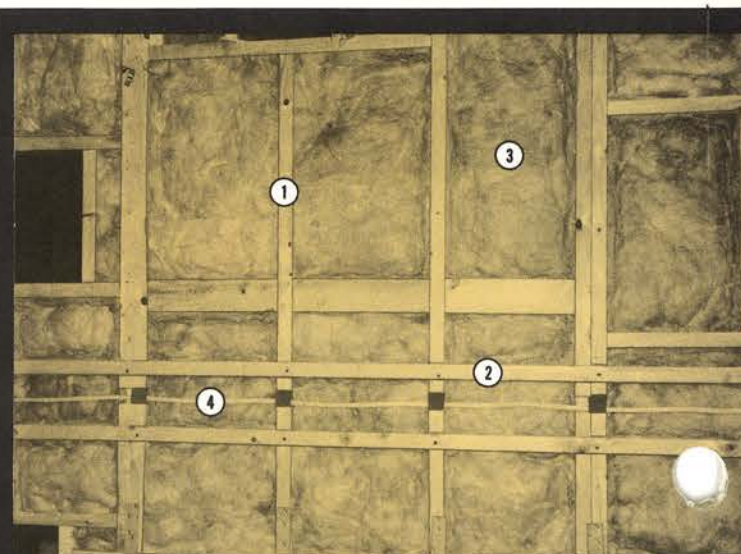

SIDEWALLS. Formed in single unit.
(1) 2" x 2" construction on 16" centers. (2) Reinforced, screwed belt rails. (3) 1-1/2" fiberglass insulation. (4) Heavy-duty wiring.

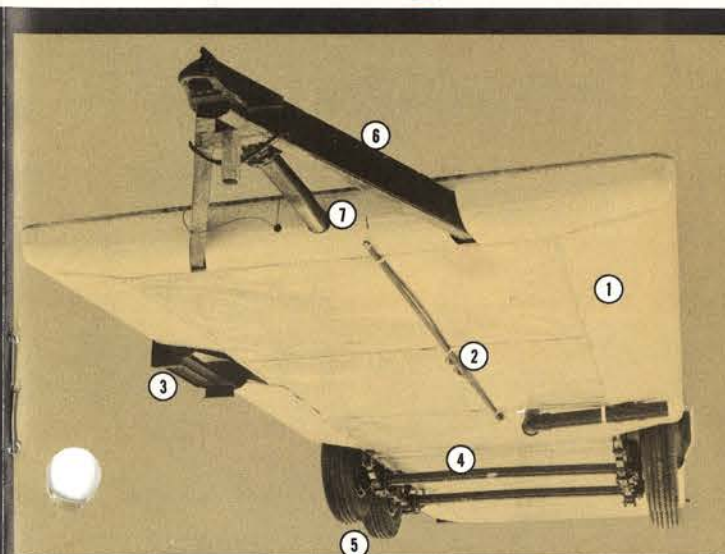

ALUMINUM UNDERSIDE
(1) .030 prefinished aluminum. (2) 1/2" gas line. (3) Foldaway step. (4) Tandem axle. Leaf spring suspension. (5) Heavy duty wheels with shocks and 12" electric brakes. (6) Seamless tubular frame. (7) 3-member A-frame.

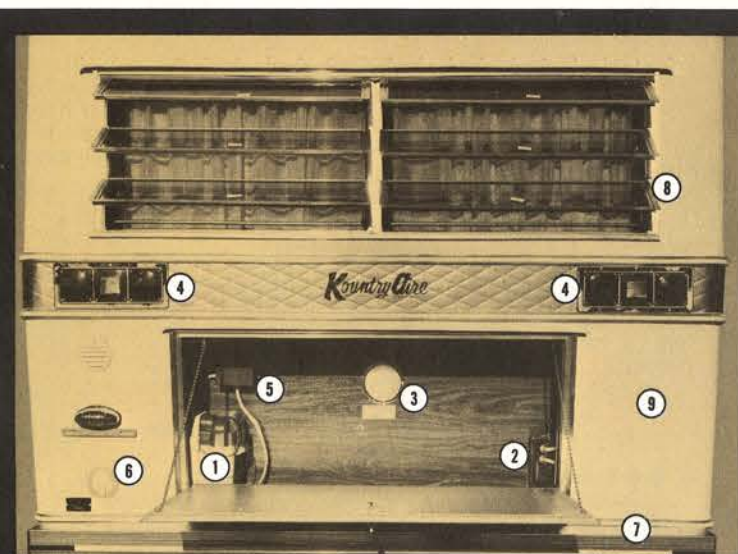

REAR EQUIPMENT
(1) 80 amp. Battery; (2) 30 amp. Converter; (3) 12v. Light; (4) Backup Lights; (5) Breaker-Box; (6) Lead-in Cord; (7) Combination Chrome Rear Bumper & Hose Carrier; (8) Safety-glass awning windows; (9) .030 Prefinished Aluminum Exterior.

All about the *Kountry Aire* GENERAL SPECIFICATIONS AND FEATURES

Exterior

.030 prefinished aluminum with gold anodized insert. Engineer-designed caps and radius corners. Fully covered heavy aluminum under chassis (trailers only). Fully coated roof seams. Insulated wheelwells. Storage trunk with light. Some models pre-wired for air conditioning. Fold-away steel door steps. Wheel covers. Awning rail. Safety glass. Snap-in exterior trim. ICC cluster and side running lights. Four large tail lights. Two stop lights. Two back-up lights.

Interior

Easy-care vinyl finished paneling. Telephone-type shower with shutoff. Ample wardrobe and drawer storage. Overhead cabinets with shelves. Heavy-duty folding doors. Folding chairs (in 27 ft. through 35 ft. models). Kitchen mirror. Molded fiberglass tub or shower. Medicine cabinet with mirror. Stainless steel bath lavatory. Built-in hamper (some models). Full length screen doors. Forced air heating system. Indirect lighting in living room. Removable window screens. 6 cu. ft. gas and electric refrigerator with freezer compartment (7-1/2 cu. ft. model optional). Double stainless steel sink. 4-burner range with folding cover and oven. Eye-level oven in 29 ft. and larger trailers. Wall-mounted oven standard in some fifth wheel models. Twin or double innerspring mattress.

Chassis and Running Gear

6" welded, seamless tubular frame. Reinforced third member A-frame. Heavy duty 2-5/16 coupler and jack. Chrome rear bumper and hose carrier. Leaf springs suspension with center load equalizer. Tandem axle (all models). 5000 pound hub group per axle. Heavy duty 15" wheels. High capacity shocks on all wheels. 12" electric brake systems. 700 x 15, 8-ply rated tires.

Body Construction

2 x 2 walls and floors on 16" centers with reinforced belt rails. 2 x 4 rafters with 5/8" plywood center. 1-1/2" fiberglass floor and wall insulation. 3" fiberglass ceiling insulation. Vinyl finished plywood. All-weather roof and floor board. Floor and sidewalls glued at all points.

Electrical, Plumbing and Heating

110 volt and 12 volt lighting system with converter. Heavy duty battery with locking case. Accessible power breaker panel. Television lead-in jack. All grounded outlets and switches. 25 ft., 110 volt power supply cord. 12 volt power fan (except 22' models).

Two 30 pound L.P. gas tanks and automatic changeover regulator. Forced air heating with blower and above-floor ducting system. 22,000 BTU furnace in 22', 25', 27'. 32,000 BTU furnace in 29', 31', 35'. 30 gallon water pressure system with air compressor. 8 gallon gas and electric water heater (27 ft. through 35 ft. models). 6 gallon water heater (22 ft. models). Inside copper lines on hot and cold water system. Non-corrosive plastic drain and sewage plumbing. Trapped and ventilated plumbing system. Marine gravity-type toilet with holding tank. Two exterior electrical outlets.

OPTIONS

(All options not available on all models.)

Fiberglass front, back and rear; Slider windows; Executive models only. Swing bunk. Raised roof for swing bunk. 7-1/2 cu. ft. refrigerator in lieu of 6 cu. ft. 10,000 BTU Coleman Mach I air conditioner. 12,000 BTU Coleman Mach II air conditioner. 13,500 BTU Coleman Mach III air conditioner. Storm windows. Rear travel awning. Divider folding door. Power fan in roof vent. Extra roof vent. Eye-level oven. Battery clock. Bedspreads. Spare tire (8-ply rated) and wheel. Spare tire carrier. AM-FM stereo, antenna and speakers. Roof-mount TV antenna. Extra overhead. Wire for stereo. Kitchen carpet. Extra holding tank. Additional 110-volt and 12-volt outlets and TV jacks. MOR/ryde suspension.

Customer check. Install fifth wheel. Gas bottle covers. Spare tire covers. Water purifier. Aluminum gas bottles. Tip-out room for 35 ft. model. Luggage rack and ladder. B.A.L. jacks. Door bell. 14" color TV. Two 32 x 72 mats with bolster and bookcase in lieu of sofa. 80" hide-a-sofa. 50" hide-a-sofa.

Note: Fifth wheel brackets are included in the price of all fifth wheel trailers. However, they are for Chevrolet and Ford pickups. All other brackets must be specially ordered.

Prices and specifications subject to change without notice. All prices F.O.B. Nappanee, Indiana.

For families desiring more room in their recreational vehicle, the 35 ft. Kountry Aire travel trailer can be ordered with a tip-out. Available in the one bedroom model only, tip-outs are an ideal way to gain additional living and sleeping space to make your going with Kountry Aire even greater.



You're riding on our reputation and you can bank on it.

Kountry Aire

NEWMAR INDUSTRIES, INC.

P.O. Box 30, Nappanee, Ind. 46550

(DEALERS: Phone (219) 773-7791 for franchise)

