

Kountry Aire MINI MOTOR HOME

WHERE THE GOING IS GREAT

The Kountry Aire Mini, in 4 inviting 23' models, is now proving to be one of the best in the U.S. It is designed

to look good, planned for comfort and storage, and built to go great for many thousands of joyous miles.

Some of the attractions include:

AUTOMOTIVE: Power steering • 4 wheel power brakes • Automatic transmission • Dual rear wheels • Tinted safety glass • Bucket type driver & passenger seats • **INTERIOR:** 6 cu. ft. gas/elect. Refrigerator • 4-burner oven range • Double stainless steel sink • Complete bath with tub and/or shower • Carpeted

throughout • Choice of 3 colorful decors • Power roof vents • Sleeps up to 6 depending on model • **EXTERIOR:** Radius corner, sliding safety glass windows • Lockable exterior storage compartment • Double fold-away steps • **CONVENIENCE FEATURES:** 12V/110V electrical systems • 22,000 BTU furnace with thermostat • Ducted, forced air heat • Marine type toilet • Pressure water system • Water heater • 2 holding tanks • **OPTIONS:** Choice of radios • TV antenna • Air conditioning • Cruise control • 4000 watt generator • Customer check •

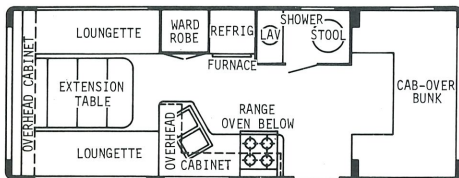

23 FBTL

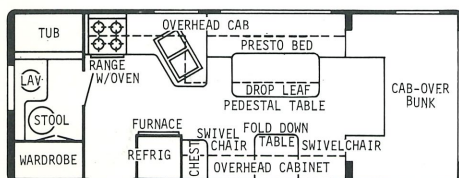

23 RB

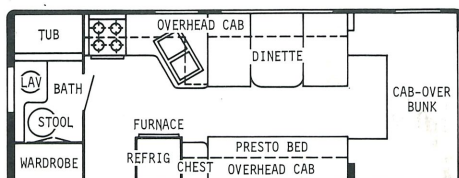

23RBSD

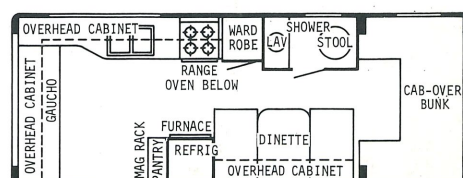

23 FBRG

Equipment and specifications are subject to change without notice.



NEWMAR INDUSTRIES, INC. • P.O. Box 30 • Nappanee, Indiana 46550 • Phone (219) 773-7791