



77

# ARABIAN

RECREATIONAL VEHICLES

FILLED WITH GOOD, NEW IDEAS FOR GOING STEADY





# ARABIAN

Filled with good ideas for looks  
and good ideas for safety.

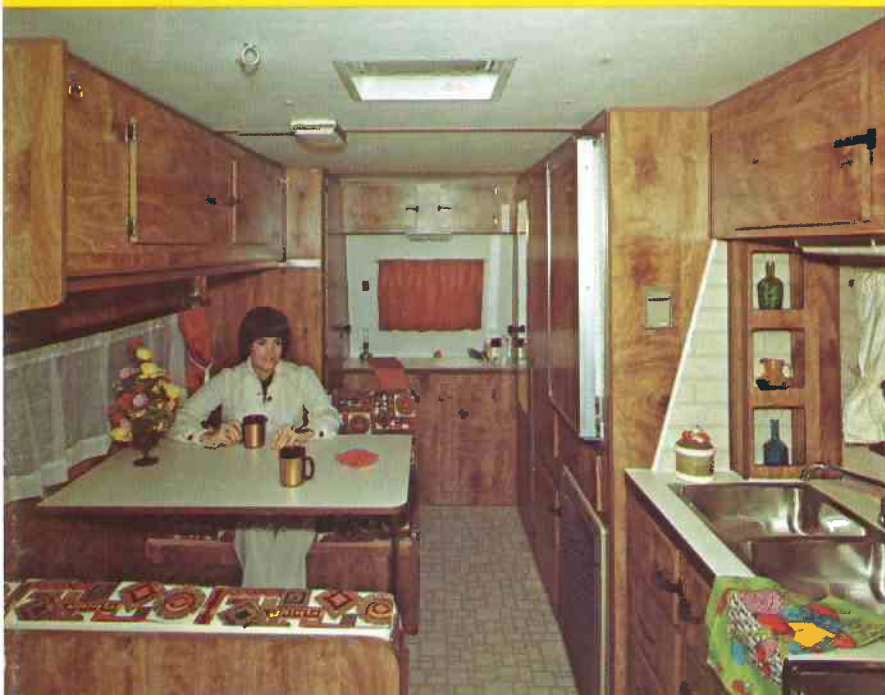

A spacious rear vanity with storage above and below is the prime attraction in the 22', 5th Wheel. Behind the mirrored door is the stool, and enclosed on the opposite wall is the large shower. The convenient dinette-kitchen arrangement with storage areas above are obviously attractive and very livable.

The 5th Wheel 22' Rear Vanity model has a carpeted "second story" bedroom with twin beds, overhead cabinets and plenty of head room. A large chest is built in on one side of the carpeted steps and a wardrobe is on the other side.

Getting the 22' 5th Wheel ready to go is as much fun as going. This popular model has radius corners all around and an enclosed gas bottle storage to enhance its sharp appearance. Tandem wheels make it tow easy and the raised roof makes living extra enjoyable.

New radius corners all around; red and gold accent striping; radius corner front awning; all these striking features add up to handsome looking recreational vehicles that maintain the same sharp appearance for years of RV enjoyment.

Full attention is given to forever important safety features. These include good basic construction; safety glass in the windows; tandem axles with electric brakes on all 4 wheels (except 18' trailer and 19' 5th wheel); exterior road safety lighting system; break-a-way switch; heavy duty coupler and more features that are listed in the specifications.

An Arabian is hard to beat in looks and safety—in fact, in its price range, its practically unbeatable.

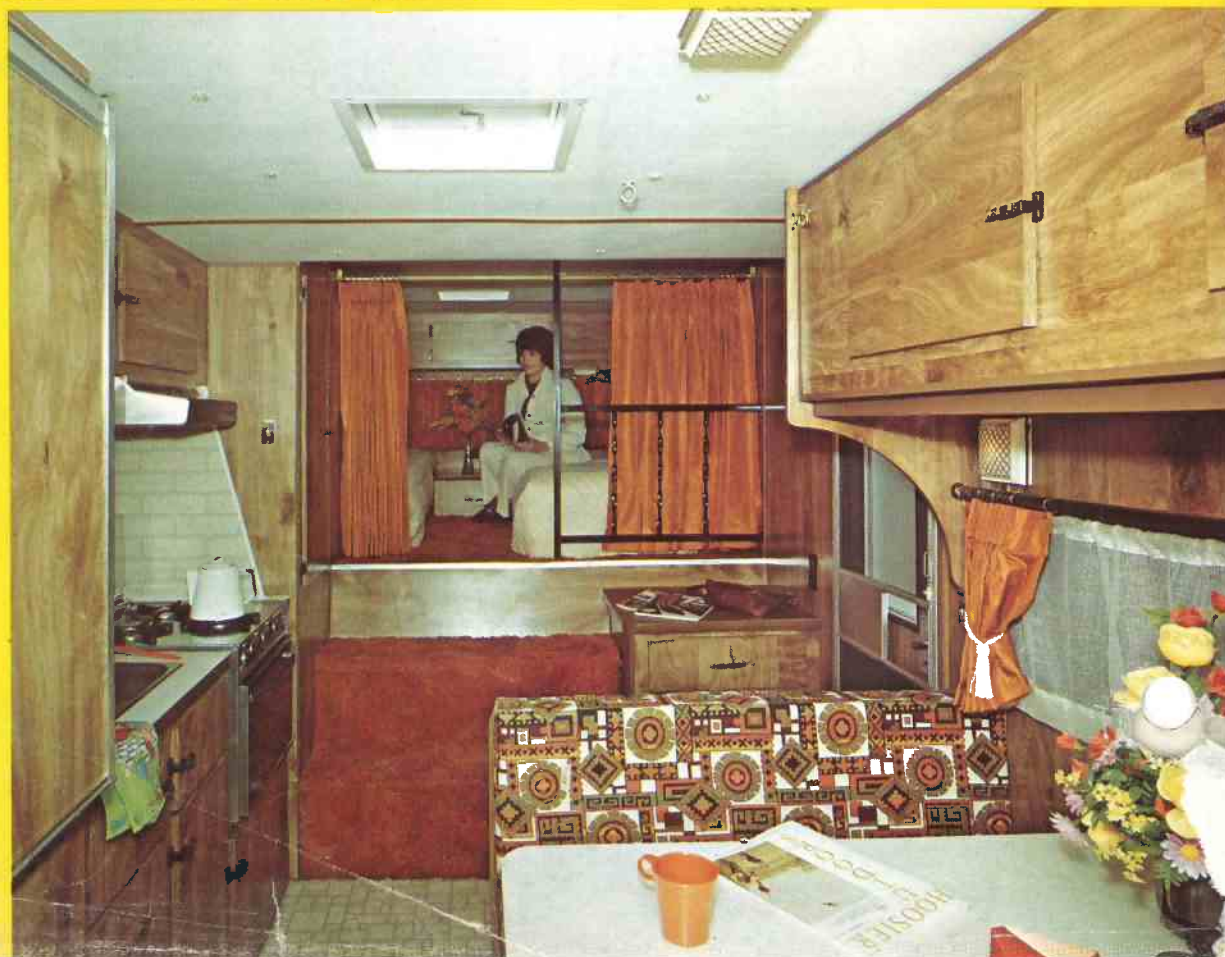

Floor Plans • Travel Trailers • 5th Wheels



The 28' Center Bath travel trailer features an extendable table that drops down when not needed. The large sofa bed sleeps 2. This Arabian living area is fully carpeted (optional) and has a large awning type windows.

# ARABIAN

Filled with good ideas for comfort  
and good ideas for convenience.

Comfort! A requirement almost universally wanted by today's RV people. Comfort in Arabian means thermostatically controlled heat; heavy foam cushions; large sleeping and storage areas for 4 or more; complete baths in every model (except the 18' travel trailer) and cozy, color decorator schemes.

In convenience, the Arabian has it all together. Self-containment in electrical, plumbing and pressure water systems; medicine cabinet and mirror; front travel awning; exterior storage access doors; well arranged interiors that are filled with convenience ideas from one end to the other.



Attractive vinyl coated paneling is used throughout all Arabian travel trailers. The 28' Center Bath kitchen can have the optional china cabinet in addition to its other storage areas. Besides the 4 burner oven-range and double stainless steel sink, this kitchen has knick-knack shelves, mirror and a fold-down extension to the cabinet top beside the sink. There are twin beds in the back bedroom behind the center bath that features a tub and shower. The 3-drawer chest beside the door and the bedroom carpeting are optional.

1977



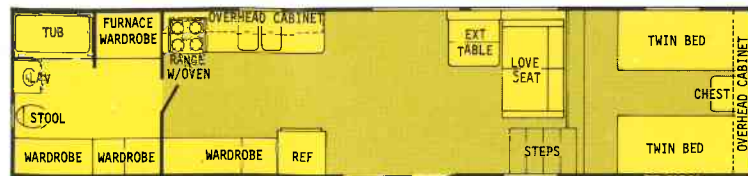

35 Ft. REAR BATH

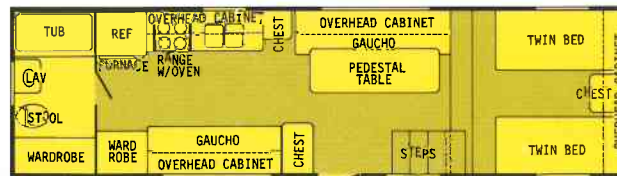

30 Ft. REAR BATH

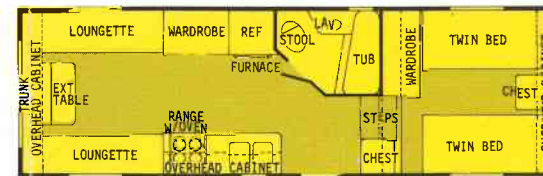

26 Ft. FRONT BATH

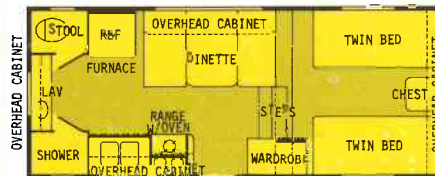

19 Ft. REAR VANITY

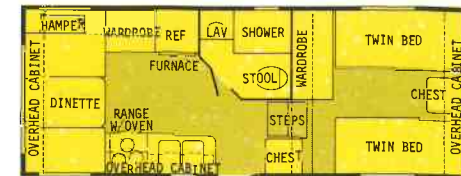

22 Ft. FRONT BATH

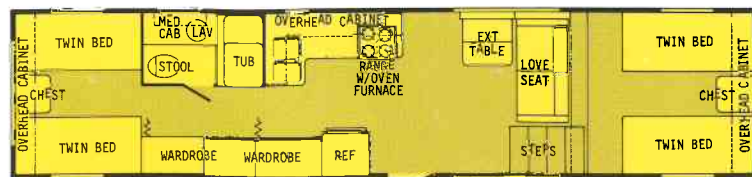

35 Ft. CENTER BATH 2 BEDROOMS

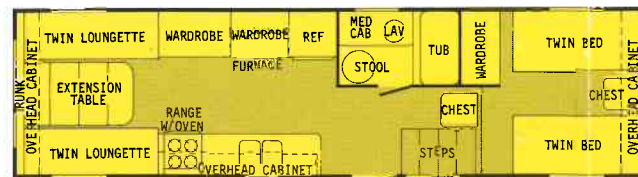

30 Ft. FRONT BATH

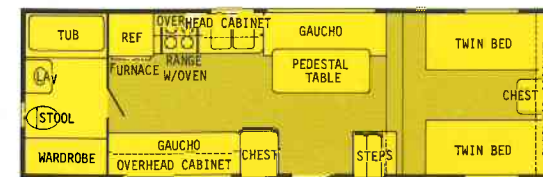

26 Ft. REAR BATH

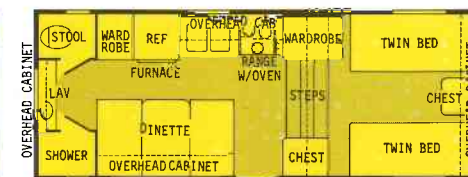

22 Ft. REAR VANITY



The 28' has both front and rear doors. The rear door, a convenience and a safety feature is an option. It tows easily on tandem wheels and underneath its good looks are hidden dozens of structural and safety features. These assure a long life that will make going steady a carefree experience for many years.

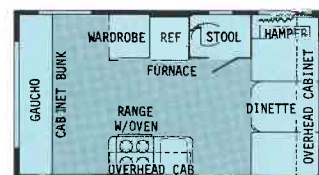

18 Ft. REAR GAUCHO

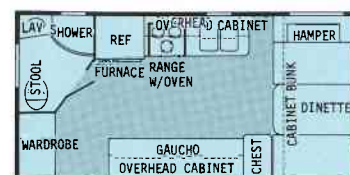

19 Ft. REAR BATH REAR DOOR

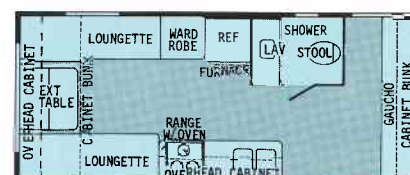

22 Ft. TWIN LOUNGETTE

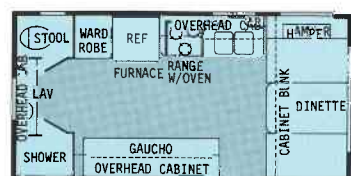

19 Ft. REAR VANITY

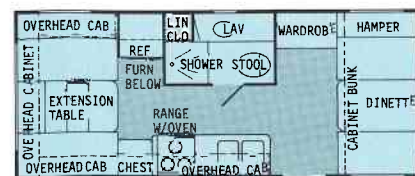

22 Ft. CENTER BATH

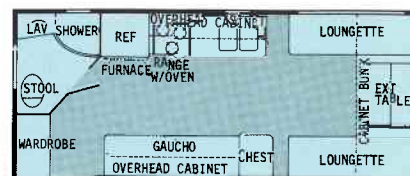

22 Ft. REAR BATH REAR DOOR

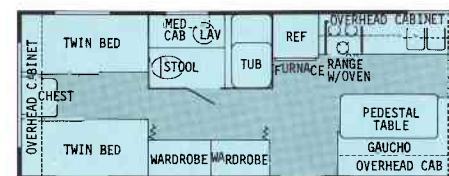

24 Ft. CENTER BATH

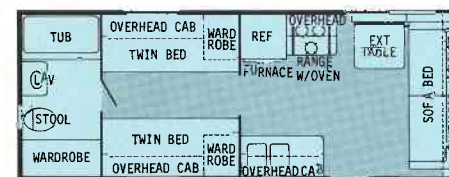

24 Ft. REAR BATH

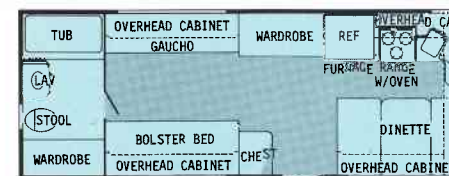

24 Ft. FRONT KITCHEN

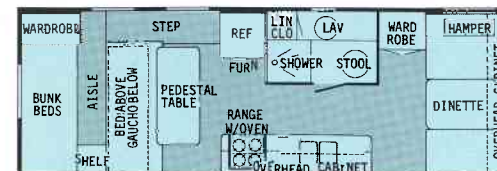

26 Ft. ESTATE



26 Ft. CENTER BATH

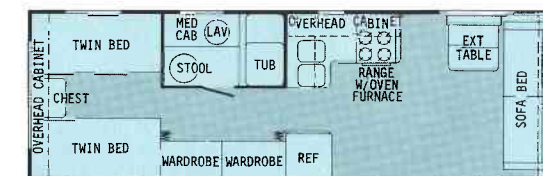

28 Ft. CENTER BATH

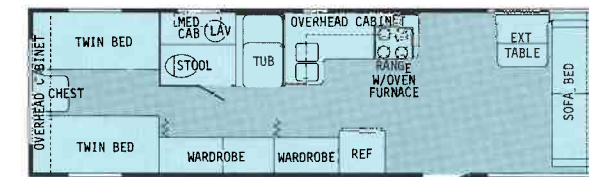

30 Ft. CENTER BATH

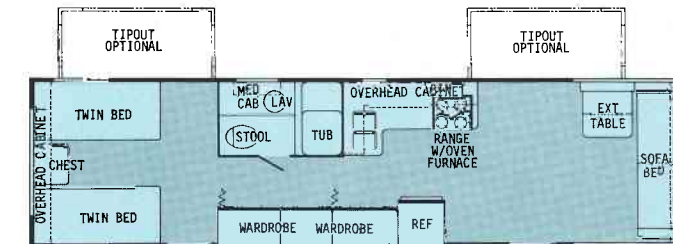

35 Ft. CENTER BATH  
(AVAILABLE AS PARK MODEL AND WITH OPTIONAL TIP-OUTS)

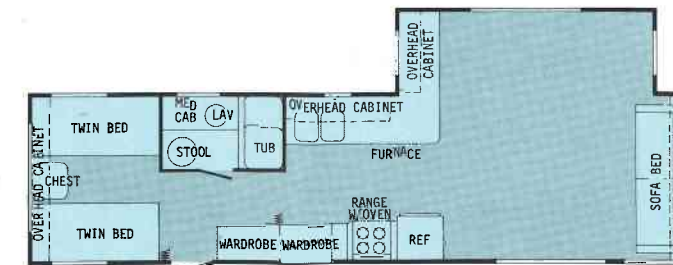

35 Ft. CENTER BATH • PARK MODEL WITH 12 Ft. TIP-OUT





# ARABIAN FEATURES, SPECIFICATIONS AND OPTIONS

Good ideas for a long lifetime of service.

## EXTERIOR

Heavy gauge prefinished aluminum with gold anodized insert  
• Radius corners • Fully coated roof seams • Roof vents • All models pre-wired for air conditioning • Fold-away steel steps • Wheel covers • Awning rail • Safety glass • Vinyl Screw cover • ICC cluster and side running lights • Two tail and stop lights • Break-a-way switch with battery • Two back-up lights • Porch light • Front travel awning • Enclosed gas bottles on fifth wheel models • Storage access doors on most models.

## INTERIOR

Easy-care vinyl-finished paneling • Telephone-type shower with shut-off • Ample wardrobe and drawer storage • Overhead cabinets • Cabinet bunks in models 18' — 22' trailers • Heavy duty folding doors • Kitchen mirror in some models • Molded tub or shower • Medicine cabinet with mirror • Built-in hamper (some models) • Full length screen doors • 6 cu. ft. gas and electric refrigerator with freezer compartment — in 24' and larger models • Double stainless steel sink in all models except 18' trailer • 3 burner range with bi-fold cover and oven in models 18' thru 24' • 4 burner range with bi-fold cover and oven in models 26' thru 35' • 5" cushions • Positive catches on all cabinet doors.

## CHASSIS & RUNNING GEAR

Steel frame • Reinforced third member A-frame • Heavy-duty 2-5/16" coupler and jack • Rear bumper and hose carrier • Multi-leaf springs with center load equalizer (tandem) • Tandem axles (all models except 18' travel trailer and 19' fifth wheel) • 3500 pound hub group per axle • 15" wheels • 10" electric brakes on all wheels • Load Range C rated tires.

## BODY CONSTRUCTION

Floors 2 x 2's on 16" center with 5/8" decking • 2 x 2 sidewall studs on 16" centers • Reinforced with belt rail • Vinyl finished plywood • All-weather roof and floor board • 2 x 4 Roof rafters on 16" centers • 1-1/2" insulation throughout.

### New Enclosed Gas Bottle Storage

1. 20 lb. gas bottles
2. Regulator
3. Battery
4. Aluminum Exterior
5. Heavy Duty 5th Wheel Jacks

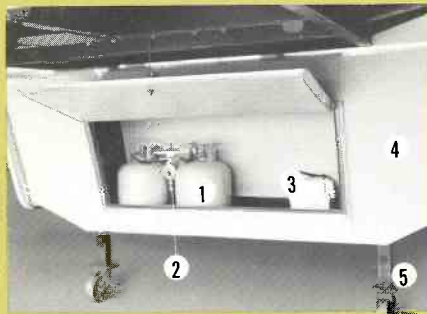

### Electrical and Other Features

1. 30 amp. converter/charger
2. Breaker Box
3. Pressure Water Tank
4. Access Door for under bed storage (most models)
5. Floor completely tiled.

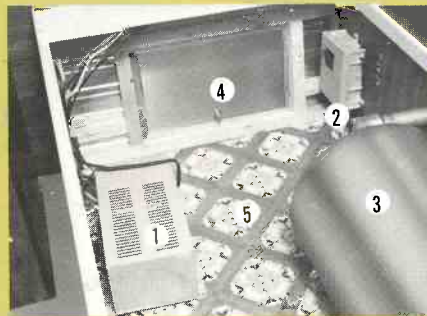

## ELECTRICAL, PLUMBING, HEATING

110 and 12 volt lighting system with converter • Heavy duty battery with locking case • All grounded receptacles air switches • Breaker panel with 25 ft. 110 volt power supply cord • Two 20 lb. LP gas bottles with regulator • 15,000 BTU heaters with wall thermostat 18' — 22' models • 22,000 BTU above floor ducted heat with wall thermostat 24' and 26' models • 32,000 BTU above floor ducted heat with wall thermostat 30' and 35' models • 20 gallon pressure water system in 18', 19' model (trailers) and 19' and 22' models (fifth wheels) • 30 gallon pressure water system in 22', 24', 26', 30' and 35' models (trailers) • 26', 30' and 35' models (fifth wheels) • Air compressor • 6 gallon gas water heater (optional on 18' model) • Copper lines on hot and cold water system • Non-corrosive plastic drain and sewage plumbing • Trapped and ventilated plumbing system • Marine gravity-type toilet • GFI bath and exterior receptacles • Dual holding tanks • Power vent in bath in 24' and larger models.

## OPTIONAL EQUIPMENT

Raised roof for bunk • Cabinet bunk • Solid bunk with 2 pane windows • Refrigerators in larger sizes • 10,000, 12,000 or 13,500 BTU air conditioners • Storm windows • Travel awning (rear) • Power fan in roof vent • Extra roof vent • Spare tire and wheel • Spare tire carrier • AM-FM stereo and 4 speakers • Roof mount TV antenna • Extra TV Jack • Extra inside 110 or 12 volt outlet • 12 volt 22,000 BTU ducted heat in lieu of 15,000 • Extra overhead cabinet • 30 lb. gas bottles • Automatic changeover regulators • Stabilizing jacks, set of 4 • Carpet per running foot • Clock • 12 volt blower for 15,000 BTU heater • Divider folding door • Eye-level oven combination • Customer check • Install fifth wheel • 30 gallon water tank, when possible • Glass sliding door in lieu of standard door (35' Center Bath Park Models ONLY) • Tip-out roof (35' Center Bath Park Models ONLY) • Hurricane Straps.

### Sidewall Construction

1. 2" x 2" construction
2. Belt Rail Reinforcement
3. Fully Insulated
4. Code Approved Wiring, 110V & 12V.
5. Steel Wiring Sleeves
6. Reinforcement straps tie studs to foundation
7. Code approved plumbing

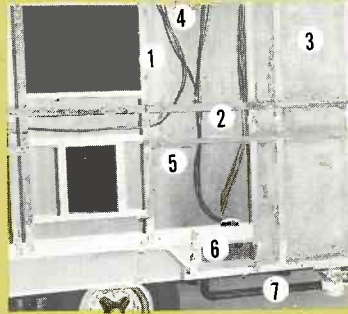

### Heating and Water Systems

1. Above floor ducted heat (24' to 35' models)
2. Furnace
3. Pressure Water Tank
4. Air Compressor
5. Gas Water Heater
6. Copper — hot and cold water lines

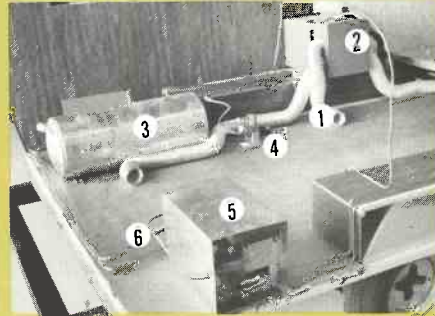

# ARABIAN

NEWMAR INDUSTRIES, INC., P.O. Box 30, Nappanee, Indiana 46550

Prices and specifications are subject to change without notice.  
All prices are F.O.B. Nappanee, IN.