



London Aire

Limited
Edition

The king, of the
royal family of
motorized
vehicles,
invites you to
enjoy imperial
accommodations
anywhere.



The London Aire Limited Edition has unlimited benefits from an array of elegant appointments.

The London Aire designers have created an aerodynamically efficient motorhome with functional living areas. Each area has numerous attractions that allow unlimited advantages for living comfortably. In addition, London Aire drives as smoothly as anyone could expect, which is a good testimony for the overall design of this remarkable Class A motorhome.

The EXTERIOR - Dove gray aluminum on sides and underside - All-aluminum roof - Automotive chrome bumpers - Road styled mirrors - Quad headlights - Chrome styled wheels - Tinted slider safety glass windows - 20 ft. Zip-Dee awning - Automatic power exterior door step - Porch light - Exterior storage - Slide-out gas grill - Black insert with red accent striping - Power TV antenna.

The INTERIOR - Digital clock - AM-FM cassette stereo radio with 6 speakers - Cushioned vinyl

LEFT: The kitchen dinette area is efficient in its arrangement and is beautiful in appearance.

COVER: The 33' London Aire Limited Edition with aerodynamic design, front wheel drive, and 220" wheel base.

ceiling - Tailormade Tweed 1/4" vinyl board sidewalls - Indirect fluorescent lighting - Deluxe carpet with pad in all areas - Seven attractive decor selections.

The COMFORT SYSTEMS - 30,000 BTU electronic ignition furnace - Underfloor ducted heat to all areas - 6 gallon quick recovery water heater - 50 amp electrical service - 6.5 generator with remote start - 2, 11,000 BTU air conditioners with electric heat - Demand water system - 80 gallon fresh water tank - 40 gallon sewage tank - 40 gallon grey water tank - Monitor system - Barometer, humidity and temperature gauges - 65 lb. L.P. tank.

The DRIVER'S AREA - 2, swivel, deluxe, high-back captain's seats - Carpeted, sound-proofed engine cover - Tinted windshield - Overhead storage compartment - Deluxe, padded dash board - Specially designed instrument panel.

The LIVING AREA - 60 in. sofa bed - Comfortable cushioned chair - TV cabinet with storage under - 2 large tinted windows with wood woven shades - Overhead storage above sofa.

The KITCHEN - Oak kitchen cabinets with wicker door inserts - Double sink with single handle swivel faucet - 4-burner stove with lighted and vented range hood - Microwave oven - Large refrigerator with overhead freezer - Cushioned oak booth dinette with pedestal table converts to bed - Large tinted window over dinette and sink with wood woven shades - Overhead storage over dinette - Wardrobe with micro-switch lighting.

The BATH - Large 36" x 40" tub and shower - 2 wardrobes with micro-switch lighting - Drawer storage below largest wardrobe - Oak bath vanity with 3-mirrored medicine cabinet and 4-bulb light bar - 2 sliding doors for complete privacy - Stool with padded seat.

The BEDROOM - 54 in. double bed - 2-drawer bedside chest - Overhead cabinet above head of bed - 9 in. built-in color TV - 3 large tinted windows with wood woven shades.

The OPTIONS - Automatic leveling A & E jacks - Citizen Band radio - 12 in. AC/DC color TV for living area - Diesel engine (spring 1983).

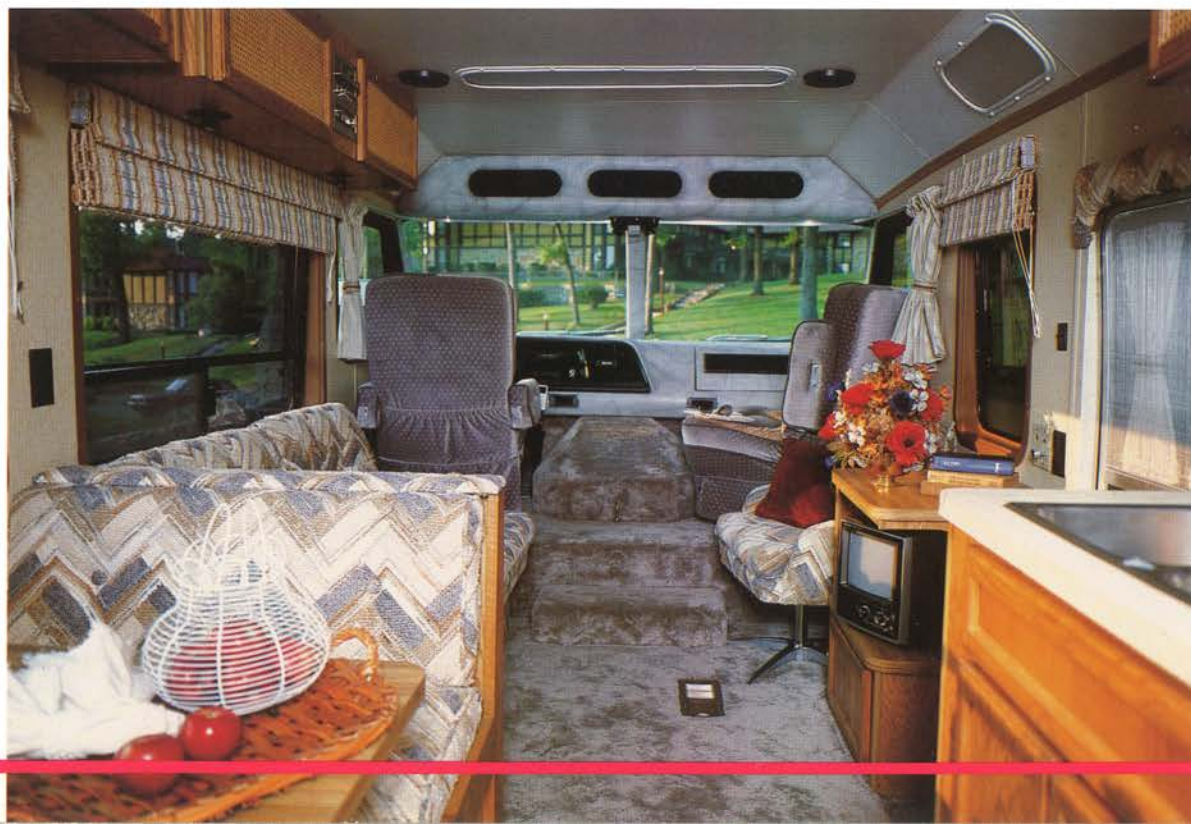

RIGHT: Looking forward into the comfortable living area that joins the driver's cab. The two combine to make driving or living a pleasant experience.

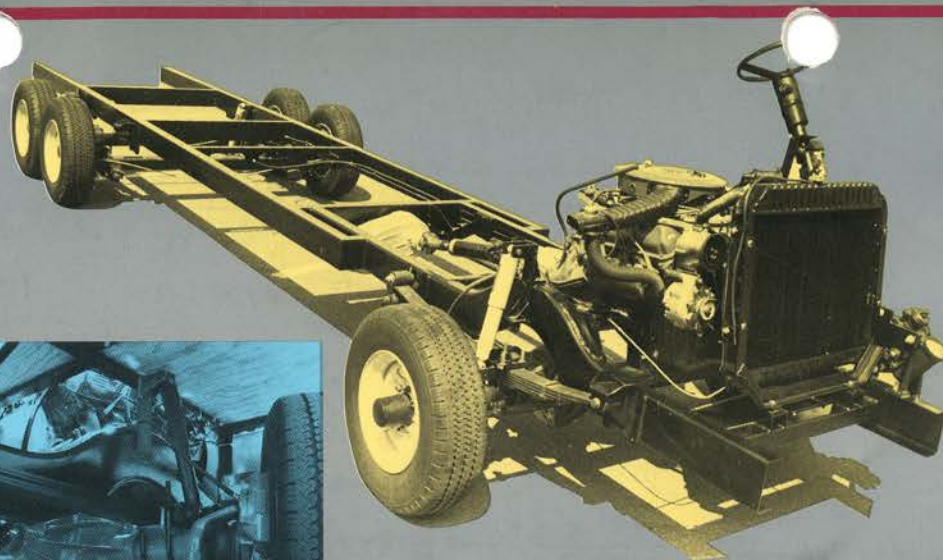

WOLVERINE FRONT WHEEL DRIVE CHASSIS WITH REAR WALKING BEAM TANDEM SUSPENSION

The Wolverine Front Wheel Drive Chassis is based on a decade of design, development, and manufacturing experience in front wheel drive motorhomes and commercial vehicle chassis. Its rugged dependability is the result of emphasis on simplicity of design and quality of construction. Featuring a low 22" frame height and an extra wide 52" frame, the chassis is custom tailored to London Aire's specifications. The 6000 lb. Dana steer-drive axle incorporates Con-Vel constant velocity, wheel ends, for smooth steering and power transmission. The 81" wide track assures maximum stability.

The RV-100 Henderson Walking Beam, tandem, rear suspension in conjunction with the Wolverine A-5500 drop axles has proven reliable in over 30 million miles of operation.

Power is supplied by your choice of a Ford 460 CID gasoline engine or the 6.9 liter Ford Diesel engine (Spring 1983)



The London Aire has a low profile which improves its aerodynamics and aids the sleek appearance.

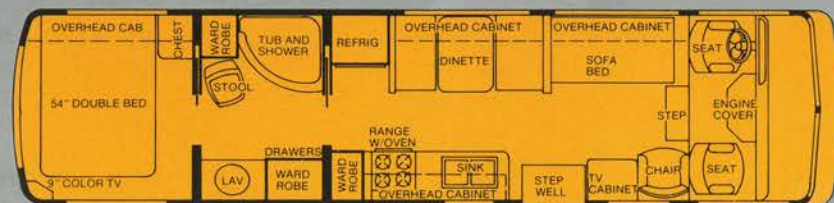

The 33' London Aire Class A - Dry Wt, 12,400 lbs. - Overall length 33'6" - Wheel base 220"

TRUSS-TYPE CONSTRUCTION

The London Aire walls and roof feature a completely welded, truss-type aluminum superstructure. A heavy .030, baked-on enamel, aluminum exterior is riveted to the superstructure. Every exterior surface is fully insulated with R-7 fiberglass in the walls and floor, and R-14 in the ceiling. The unit's exterior has large, smooth, radius corners to give a handsome appearance and sound aerodynamic design.

Photographic location courtesy Castle Point Apartments, Cleveland Road, South Bend, Indiana



London Aire
Newmar Industries, Inc.
P.O. Box 30
Nappanee, Indiana 46550-0030

All London Aire features and options are not included. Your dealer has a complete list.

Each London Aire meets all requirements of the RVIA, Recreational Vehicle Industry Association, the ANSI, American National Standards Institute and state and federal codes.

Some features shown in photographs are optional. Features and specifications are subject to change without prior notice.