



“Coast to Coast with no RESERVATIONS!”



*Newmar Corporation:
A sound company backed by
21 years of experience.*

BY





Fifth Wheel Living Area



Fifth Wheel Galley/Dining Area

Standard Decorative
Tile In Sink Cover



Fifth Wheel Bedroom



Bath

"Coast to Coast with no RESERVATIONS!"

Hey America, what are you waiting for? Your ship just rolled in at your nearest American Star dealership departing from any port in the U.S.A., Coast to Coast with No Reservations! See all the great sights in a quality RV everyone can afford, an American Star recreational vehicle.

Newmar Corporation designed this line with everyone in mind. Here's an affordable coach that will allow American families everywhere the chance to enjoy the first, or many times to come in security, comfort and freedom. No reservations are necessary when you take along the only accommodations you'll need, and in a style that's comparable to any RV on the road today, inside and out.

As an up and coming Star to the many varieties and price ranges of the Newmar family of products, **American Star** offers so many conveniences as standard, you'll expect to pay a lot more than the modest price on the sticker. We don't consider American Star as an economy line other than the price, and here are just a few sound reasons that will benefit you as a happy owner.

The first and most obvious is that **American Star** is backed by 21 years of experience in the designing and manufacturing of RVs by **Newmar Corporation**.

Then, just take one look at the professionally designed interiors and exteriors, and these tastefully color-coordinated fabrics and hardware that give the look of the 80's. Don't forget the **solid oak doors and drawers with a myriad of intimate details** that set your Star apart from all the rest.

A wide variety of sizes and floor plans in three choices of vehicle styles will leave you with no reservations about which brand to buy this year, just which model to select. After you reserve your order for the **American Star of your choice**, **American Star** invites you to see it all . . . Coast to Coast with No Reservations!



Quality is NO.1 at Newmar Corporation, and our "Personal Touch" inspection of all products will insure you of that high quality before any RV ever leaves our plant!

TRAVEL TRAILER
Specifications & Floor Plans



Dimensions	Gross Dry Weight	GVWR	Dry Hitch Weight	Dry Axle Weight	Height with A/C	Length/Width	Options
18 RBD	3,900	5,900	500	3,400	115"	17' 9"/95"	
20 RBD	4,100	5,900	500	3,600	115"	21' 5"/95"	F
23 CBD	4,800	7,200	500	4,300	118"	23' 5"/95"	
25 FKD	4,800	7,200	600	4,200	118"	25' 8"/95"	A, H
26 CBD	5,100	7,200	500	4,600	118"	26' 8"/95"	B, H, K
29 CBD	5,625	7,800	600	5,025	118"	29' 8"/95"	B, D, K
29 FKD	5,625	7,800	700	4,925	118"	29' 8"/95"	B, H
31 CBD	5,875	7,800	700	5,175	118"	31' 4"/95"	B, E, I, J, K
31 FKD	5,900	7,800	775	5,125	118"	31' 4"/95"	B, H
33 CBD	6,125	7,800	725	5,400	118"	33' 2"/95"	B, E, I, J, K
33 FKB	6,150	7,800	800	5,350	118"	34' 2"/95"	H
33 FKD	6,150	7,800	800	5,350	118"	33' 2"/95"	C, H
35 CBD	6,750	9,000	800	5,950	118"	34' 8"/95"	C, E, I, J, K
35 DB	6,750	9,000	800	5,950	118"	34' 8"/95"	G

FIFTH WHEEL • Specifications & Floor Plans



Dimensions	Gross Dry Weight	GVWR	Dry Hitch Weight	Dry Axle Weight	Height with A/C	Length/Width	Options
20 FSB	4,100	5,900	700	3,800	125"	21' 0"/95"	
24 RK	5,200	7,500	800	4,400	125"	25' 9"/95"	F
24 WD	5,200	7,500	1,000	4,200	125"	25' 9"/95"	L
26 RBD	5,610	8,000	750	4,860	125"	26' 5"/95"	A
26 SB	5,600	8,000	1,200	4,400	125"	27' 9"/95"	
26 W	5,450	8,000	1,150	4,300	125"	26' 5"/95"	A
29 WD	5,750	8,000	1,150	4,600	130"	29' 11"/95"	A, K, L
29 WRKD	5,850	8,000	1,250	4,600	130"	29' 11"/95"	A, B, F, K
32 FL	7,700	10,000	1,500	6,200	136"	32' 5"/95"	F, J, L
32 WD	6,940	8,500	1,400	5,540	130"	32' 9"/95"	A, B, H, K, L, M
32 WRKD	6,900	8,500	1,300	5,600	130"	32' 9"/95"	A, C, D, F, I, K
36 FL	8,550	11,000	1,500	7,050	136"	37' 3"/95"	F, G, L, J, N
36 WD	8,150	11,000	1,450	6,700	130"	37' 3"/95"	A, C, D, F, G, K, L, M
36 WRKD	8,100	11,000	1,400	6,700	130"	37' 3"/95"	A, E, F, G, K, L, M
40 WCB	8,400	12,000	1,500	6,900	130"	39' 10"/95"	A, B, F, I, K, N, J
40 WD	8,400	12,000	1,500	6,900	130"	39' 10"/95"	A, C, D, F, K, L, M

Approximate Weights. GVWR = Gross Vehicle Weight Rating. Charts are Based on Standard Units.

MINI HOME
Specifications & Floor Plans

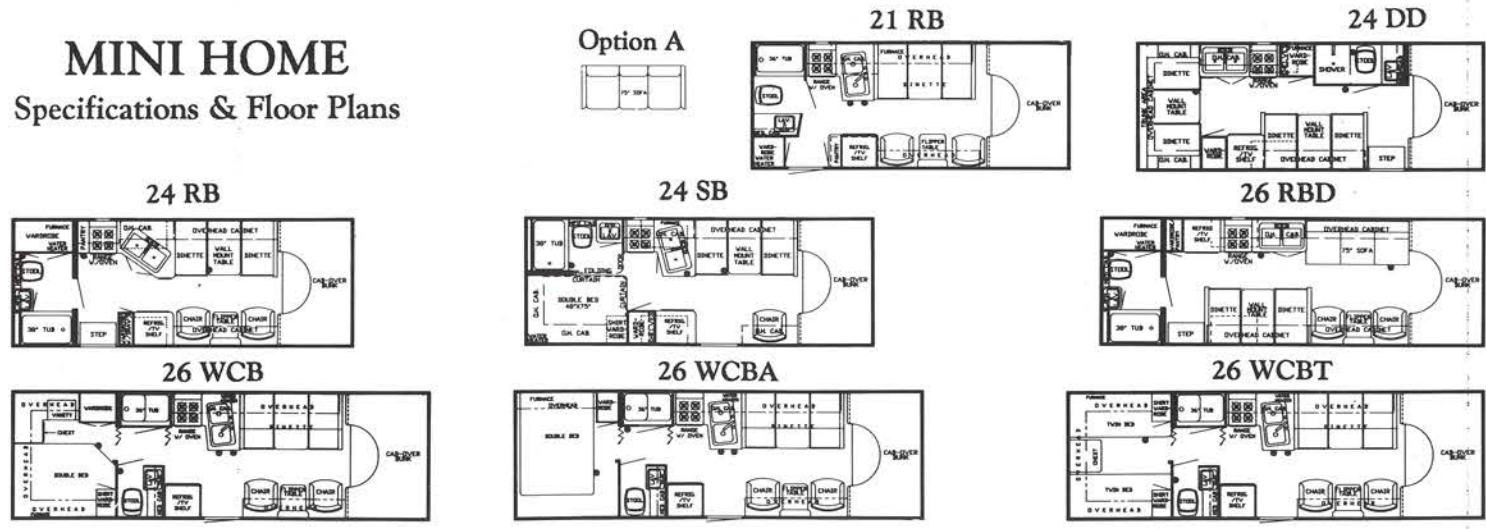

Dimensions	Gross Dry Weight	GVWR	Front Axle	Rear Axle	Height with A/C	Length/Width	Options
21 RB	8,550	10,500	3,000	5,550	127"	21' 10"/95"	
24 DD	8,700	10,500	2,900	5,800	127"	24' 6"/95"	
24 RB	8,700	10,500	3,000	5,700	127"	24' 1"/95"	A
24 SB	8,700	10,500	3,000	5,700	127"	24' 7"/95"	A
26 RBD	9,075	10,500	3,375	5,700	127"	26' 5"/95"	
26 WCB	9,300	11,000	3,200	6,100	127"	27' 10"/95"	A
26 WCB	9,300	11,000	3,200	6,100	127"	27' 10"/95"	A
26 WCB	9,300	11,000	3,200	6,100	127"	27' 10"/95"	A

Approximate Weights. GVWR = Gross Vehicle Weight Rating. Charts are Based on Standard Units.

AMERICAN STAR Towable and Motorized Standards and Options

TT	FW	MI	Retail Cost	
O	O	O	\$649	AIR COND. Coleman 11.0 BTU (ea.)
O	O	O	\$691	Air Cond. Coleman 13.5 BTU (ea.)
S	S	S		Air Cond. Prep (w/Wiring)
O	NA	NA	\$35	Cover for LP Gas Bottles - ABS
S	S	NA		Furnace 17M Pilot Ign. Non Duct (18' & 20' only)
S	S	S		Furnace 20M Electronic Ignition (21'-26') (Excalibur)
S	S	NA		Furnace 25M Electronic Ignition (27'-35') (Excalibur)
NA	S	NA		Furnace 31M Electronic Ignition (Excalibur) (36' & up)
O	O	O	\$70	Furnace 35M Electronic Ignition ILO Std. (Excalibur)
O	O	O	\$49	Heat Strip for Air Cond.
S	S	NA		LP Gas Bottles 2-20# Steel w/Auto. Reg.
O	O	NA	\$40	LP Gas Bottles 2-30# Steel ILO 20# Steel
O	NA	NA	\$73	LP Gas Bottles 2-40# Steel ILO 20# Steel
NA	O	NA	\$73	LP Gas Bottles 2-40# Steel ILO 20# Steel (29' & up)
NA	NA	S		LP Gas Tank 15 Gal.
O	O	O	\$21	APPLIANCES & ACCESSORIES
S	S	S		Bath Acc. (towel bar, soap dish, tis. hldr. & towel ring)
S	S	S		Decorative Tile Recessed in Sink Cover
S	S	S		Faucet for Lavatory Dbl. Handle Mixing
S	S	S		Faucet for Shower Dbl. Handle Mixing w/Spigot
S	S	S		Faucet for Sink Dbl. Handle
O	O	O	\$499	Microwave Oven Conv. 22" (Sharp) w/4-Burner Hot Plate (21' & up)
O	O	O	\$625	Microwave Oven Conv. 22" (Sharp)
O	O	O	\$415	Microwave Oven (Sharp Carousel)
S	S	S		Microwave Prep 22 1/4"W x 15"H
S	S	NA		Range 3-Burner Brushed Chrome (18' & 20' only)
S	S	S		Range 4-Burner Porcelain w/Pilot Top & Oven (21' & up)
O	O	NA	\$138	Range 4-Burner Porcelain w/Pilot Top & Oven (18' & 20' only)
O	O	O	\$35	Range Larger 4-Burner Porcelain, Blk. Glass Door w/Pilot Top & Oven (21' & up)
O	O	O	\$35	Range Cover Bi-Fold Deluxe
S	S	S		Range Hood w/Light & Fan
O	O	O	\$294	Refr. Dometic 2601 2-Way ILO 452 (21' & up)
O	O	O	\$392	Refr. Norcold Flushmount 683 3-Way ILO 452 (21' & up) (where applic.)
S	S	NA		Refr. Norcold Flushmount 442 2-Way (18' & 20' only)
S	S	S		Refr. Norcold Flushmount 452 2-Way (21' & up)
O	O	NA	\$70	Refr. Norcold Flushmount 452 ILO 442 (18' & 20' only)
O	O	O	\$210	Refr. Norcold Flushmount 462 ILO 452 (21' & up)
S	S	S		Sink Cover Laminated - 1
S	S	S		Sink Deep Dbl. Porcelain
S	S	S		Sink Lavatory Rectangular (BONE)
S	S	S		Stool Aqua Magic IV
O	O	O	\$34	Stool Aqua Magic Starlite
NA	O	NA	\$90	Tub 40" ABS ILO 54" w/Remainder Wardrobe ILO Std. (where applic.)
O	O	O	\$339	Tub Fiberglass w/Enclosure Door ILO ABS (where applic.) (except 18' & 20')
S	S	S		Tub or Shower ABS w/Curtain
O	O	O	\$128	Tub Surround ABS
O	O	O	\$146	Tub/Shower Enclosure Door
NA	O	NA	\$1,033	Washer & Dryer Sears 2-piece (See Floor Plans)
NA	O	NA	\$200	Washer & Dryer Prep Sears 2-piece Plumbing, Recept. & Shelf (certain models)
O	O	O	\$46	Water Heater Bypass Kit
S	S	S		Water Heater Gas 6 Gal.
O	O	O	\$186	Water Heater Gas 6 Gal. w/Elect. Ign.
O	O	NA	\$156	Water Heater Gas/Elec. 10 Gal. ILO 6 Gal. Gas (29' & up)
O	O	NA	\$74	Water Heater Reignor 12V
O	O	NA	\$54	CABINETS & FURNITURE
S	S	S		Bar (Table Height) ILO Dinette
O	O	NA	\$63	Bed Double (See Floor Plan)
O	O	NA	\$116	Bed Queen (60" x 75") (where applic.)
NA	NA	S		Bed Twin (32" x 75") ILO Double
O	O	NA	\$270	Bed Twin (32" x 75") (See Floor Plan)
O	O	NA		Bunk Cabinet Combination 32" w/3" Foam Matt. & 8x14 Window (where applic.)
O	O	NA	\$104	Bunk Matt. w/Window (18' & 20' only)
O	O	NA	\$246	Bunk Stationary 32" w/3" Foam Matt. & 15x42 Window (where applic.)
NA	S	NA		Cabinet China w/Decorative Glass Door(s) (See Floor Plan)
S	S	S		Cabinet Medicine w/Mirror Doors
NA	O	NA	\$193	Cabinet Mini Hutch w/Lights (where applic. w/slide out)
S	S	S		Cabinet Night Stand(s) (See Floor Plan)
O	O	NA	\$154	Cabinet Overhead Extra in B/R (ea.) (where applic.)
S	S	S		Cabinetry Oak w/Hard Wood Frame Doors
O	O	NA	\$227	Chair Free Stding. Pedestal (where applic.)
O	O	NA	\$293	Chair Swivel Rocker (free standing)
NA	O	NA	\$323	Chairs Free Stding. Incliner w/End Table & Light in 91" Sl. Out ILO Sofa
NA	NA	S		Chair(s) Barrel (where applic.)
O	O	O	\$42	Counter Top Extension (where applic.)
NA	O	NA	\$234	Deluxe Honeymoon Suite Bedroom w/Robe & Chest (Must Add SS Option) (29' & up - Excl. FL)
O	O	NA	\$76	Dinette Free Standing w/2 Chairs ILO Built-in
NA	NA	O		Dinette ILO Sofa
S	S	S		Dinette w/Flex-a-lator & Fabric Covered Ends (See Floor Plan)
O	O	O	\$68	Doors Oak Cabinet over Decorative Shelves
S	S	S		Door(s) under Dinette for Easy Access
S	S	S		Drawers Wood w/Roller Guides
O	O	NA	\$243	Entertainment Center Base Only (where applic.)
S	S	NA		Gaucho Built-In (18' & 20' only)
S	S	S		Headboards Decorative (where applic.)
NA	NA	S		Seat Driver/Passenger Swivel
NA	NA	O	\$67	Seat Driver/Passenger Swivel & Recliner
NA	NA	O	\$50	Snack Tray on Engine Cover w/Cassette Holder
S	S	S		Sofa Bed Built-In (where applic.)
S	S	NA		Sofa Bed Free Standing (where applic.)
O	O	NA	\$113	Sofa 75" w/Tables ILO 84" Sofa
NA	NA	O	\$244	Sofa ILO Dinette
O	NA	NA	\$168	Sofa ILO Gaucho (18' & 20' only)
S	S	S		Spice Rack (Hand Crafted)
O	O	NA	\$259	Table Dropleaf high-low for (coffee or din.)

TT	FW	MI	Retail Cost	
NA	NA	S		CABINETS & FURNITURE - Continued
NA	O	NA	\$126	Table/Chest w/Cup Holder Between Chairs (where applic.)
NA	O	NA		Wardrobe/Delete & Add Front Entrance Door 26" (where applic.)
NA	NA	S		CHASSIS FEATURES
NA	NA	S		Brakes Power
NA	NA	S		Chassis - Chevy (350 CID Engine) w/35 Gal. Tank w/Polyester Tires
NA	NA	O	\$1,213	Chassis - Ford (460 CID) w/Radial Tires w/42 Gal. Tank
NA	NA	S		Cruise Control
NA	NA	S		Heater/Air Conditioner High Output Automotive
NA	NA	S		Power Steering
NA	NA	S		Steering Wheel Tilt
NA	NA	S		Transmission Automatic
NA	NA	S		Windshield Tinted
S	S	NA		ELECTRICAL & LIGHTING EQUIPMENT
S	S	S		Battery 80 Amp (18' & 20' only)
O	O	O	\$27	Battery 115 Amp Sears Die Hard (1) (21' & up)
NA	NA	S		Battery 115 Amp Sears Die Hard Deep Cycle ILO Std. (21' & up)
NA	NA	S		Battery Automotive
NA	NA	S		Battery Isolator
NA	NA	O	\$260	Battery Rack w/Case & Wiring
S	S	NA		CB Radio w/Antenna
S	S	S		Converter 30 Amp (18' & 20' only)
S	S	S		Converter 40 Amp w/Charger (except 18' & 20')
S	S	S		Electrical Service 30 Amp
O	O	NA	\$200	Electrical Service 50 Amp ILO 30
NA	O	NA	\$106	Fan Ceiling (where applic.)
NA	NA	O	\$2,507	Gen. 4.0kw Onan w/1 Remote Switch
NA	O	NA	\$2,618	Gen. 4.0kw Onan w/1 Remote Switch & Gas Tank (29' & up)
NA	O	NA	\$3,736	Gen. 6.5kw Onan w/1 Remote Switch & Gas Tank (29' & up)
NA	O	S	\$119	Gen. Prep (110 V/wire, remote start wire & door)
S	S	S		Light Exterior Patio w/Inside Switch
S	NA	NA		Light for Hookup Convenience
O	O	O	\$43	Lighting Fluorescent Dbl. Surface Mount (ea.) (Choose Location)
NA	NA	S		Lights Backup
O	O	O	\$36	Lights Exterior Security (ea.)
NA	NA	O	\$109	Lights Fog
O	O	O	\$166	Monitor Panel
O	O	S	\$283	Radio/Ant., AM/FM Stereo Cass., Clock & 4 Spkr. (CB Models 6 Spkr.)
S	S	S		Recept. 110V GF (interior & exterior)
O	O	NA	\$88	Stereo Prep (antenna & 4 speakers)
S	S	NA		Stereo Prep (wire only)
O	O	O	\$28	Telephone Jack Extra Interior (Choose Location)
O	O	O	\$113	Telephone Jack & Cable TV Hook up (Choose Location)
S	S	S		TV Antenna Prep (Wire & 1 Jack only)
O	O	O	\$186	TV Antenna w/Power Booster
O	O	O	\$35	TV Jack Exterior on Door Side
O	O	O	\$28	TV Jack Interior Extra (by recept)
O	O	O	\$70	TV Shelf, Jack & Recept. (Choose Location)
O	O	O	\$40	TV Cable Hook Up
O	O	O	\$74	VCR Prep (where applic.)
O	O	O	\$3,185	TV Satellite Dish 6' A&E (where applic.)
O	O	O	\$35	EXTERIOR ACCESSORIES
NA	NA	S		Bumper Cover Aluminum
S	S	S		Bumper Front Auto. Style w/Chrome Grill
NA	NA	O	\$266	Bumper w/Sewer Hose Storage
O	O	O	\$41	Exterior Front & Rear Gelcoated Fiberglass
O	O	O	\$173	Exterior Sides Gelcoated Fiberglass (per ft.)
O	O	O	\$200	Ladder & Roof Rack
S	S	S		Roof Rubber
NA	NA	O	\$121	Roof One Piece Aluminum
O	O	NA	\$2,640	Running Boards Aluminum
O	O	NA		Slide Out 65" & 76" w/Lights (Choose Cbnt. & Furn. Selection) (where applic.)
NA	O	NA	\$2,786	Slide Out 91" & 101" w/Lights (Choose Cbnt. & Furn. Selection) (where applic.)
O	O	O	\$24	Step Double Manual ILO Single
NA	O	NA	\$92	Step Triple Manual ILO Single
NA	O	O	\$89	Step Fold Down in Front Bumper
NA	NA	O	\$319	Step Double 12 Volt Auto. ILO Std.
S	S	S		Step Single Manual w/Non Skid Surface
S	S	S		Storage Exterior Compartment(s)
NA	O	NA	\$1,397	Super Storage w/Enclosed Underbelly 29' - 32'
NA	O	NA	\$1,629	Super Storage w/Enclosed Underbelly 36' - 40'
NA	S	NA		SS 5200# Axles w/8.55x15 Tires (Except 40')
NA	S	NA		SS 75" Entrance Door
NA	O	NA	\$140	SS Carpeting in Storage Compartments
NA	S	NA		SS Enclosed Underbelly
O	O	O	\$84	INTERIOR FEATURES
O	O	NA	\$91	Bedsprad(s) Quilted w/Matching Shams & Accent Pillow Dbl.
O	O	O	\$148	Bedsprad(s) Quilted w/Matching Shams & Accent Pillow Queen
S	S	NA		Bedsprad(s) Quilted w/Matching Shams & Accent Pillow Twin
S	S	S		Cabinet Doors w/Decorative Etched Glass
O	O	O	\$73	Ceiling Decorative Vinyl Clad
S	S	NA		Decor Package KS9-53 & KS9-54 ILO Std.
S	S	NA		Floor Covering, Carpet w/Pad Bedroom & Living Room
S	S	NA		Floor Covering, Carpet w/Pad Throughout
S	S	NA		Floor Covering, Vinyl (except bedrm./living rm.)
S	S	NA		Floor Covering, Vinyl Thru-out (18' & 20' only)
O	O	NA	\$27	Floor Covering, Carpet w/Pad ILO Vinyl (Per Ft.)
S	S	S		Mirror(s) Etched w/Decorative Wood Frame
S	S	S		Mirror(s) w/Decorative Wood Frame
S	S	S		Paneling Decorative Vinyl in Bath Area
S	S	S		Paneling Textured Light Color Exterior Walls
NA	NA	S		Privacy Drapes (fabric lined) for Windshield
NA	S	NA		Stand Up Bedroom Area (29' & up)
O	O	O	\$112	Window Treatmt. Mini Blinds ILO Std. Living/Din. Area
S	S	S		Window Treatmt. Mini Blinds (kitchen only)
S	S	S		Window Treatmt. Roller Shade to Match Wall (bath only)

TT	FW	MI	Retail Cost	
S	S	S		INTERIOR FEATURES - Continued
O	O	NA	\$998	Window Treatmt. Textured Roller Shades w/Tie Back Drapes/Val.
NA	NA	O	\$1,264	XL Package Interior & Exterior
S	S	S		XL Package Interior & Exterior
S	S	S		XL Bath Acc. (Brass towel bar, soap dish, tis. hldr. & towel ring)
S	S	S		XL Bath Lav. & Tub Faucet Deluxe Brass
S	S	S		XL Bedsprad(s) Quilted w/Matching Shams
S	S	S		XL Bi-Fold Range Cover
S	S	S		XL Black Glass Door & Larger Oven
S	S	S		XL Black Glass Door on Refer
S	S	S		XL Bumper Cover (Alum.)
S	S	S		XL Ceiling Beams ILO Std. Trim
S	S	NA		XL Chrome Lug Nuts
S	S	S		XL Deluxe Brass Complexion Light in Bathroom w/Wall Switch
S	S	S		XL Deluxe Din. Light w/Wall Switch
S	S	S		XL Deluxe Oak/Gold Trim Around Ceiling Lights w/Wall Switches
S	S	S		XL Deluxe Oak/Gold Trim on Cornice Boards, Living Area
S	S	S		XL Deluxe Raised Panel Doors ILO Std.
S	S	S		XL Locks Dead Bolt(s)
S	S	NA		XL LP Gas Bottles Steel 30# ILO 20#
NA	NA	S		XL Mud Flaps
NA	NA	S		XL Snack Tray on Engine Cover
S	S	S		XL Sofa Throw Pillows
S	S	S		XL Spring Lifts for Convenient Storage Under Fixed Beds
NA	NA	S		XL Step Double Manual ILO Single
S	S	S		XL Step Double 12 Volt Auto. ILO Std.
S	S	S		XL Stool Aqua Magic Starlite
S	S	S		PLUMBING SYSTEMS
NA	NA	O	\$259	Hook-Up for City Water
S	NA	NA		Insulated Holding Tanks
S	NA	NA		Tank Gray Water 18 Gal. (18' & 20' only) (Approx.)
NA	NA	S		Tank Gray Water 25 Gal. (Approx.)
S	S	NA		Tank Gray Water 42 Gal. (Approx.) (23' & up)
S	NA	NA		Tank Sewage Holding 18 Gal. (18' & 20' only) (Approx.)
NA	NA	S		Tank Sewage Holding 25 Gal. (Approx.)
S	S	NA		Tank Sewage Holding 42 Gal. (Approx.)
S	S	S		Water Capacity 42 Gal. (Approx.)
S	S	S		Water System Demand w/12V Pump & 5/8" Polybutylene Lines
S	NA	NA		RUNNING GEAR & CONSTRUCTION
NA	NA	NA		Axle 4" Drop w/10" Brakes
S	NA	NA		Axle 4" Drop w/10" Brakes 2700# (18' & 20' only)
NA	S	NA		Axle Straight w/10" Brakes (Except 36' & Certain SS Models 12" Brakes)
S	S	S		Floor 2x2 Frame w/5/8" Plywood
S	S	NA		Frame Size 4" Tube (18' & 20' only)
S	S	NA		Frame Size 5" Tube (23'-29')
S	S	NA		Frame Size 6" Tube (31' & up)
NA	NA	O	\$300	Hitch for Towing Car w/Wire Connector
NA	O	NA	\$309	Hitch Plate & Bracket Center Mount 12,000 lb. (except 37' & up)
NA	O	NA	\$348	Hitch Plate & Bracket Center Mount 15,000 lb. (37' & up)
O	O	O	\$219	Insulation 1/4" Fome-Cor Complete Exterior (w/Metal only)
O	O	O	\$126	Insulation 1/4" Fome-Cor Floor, Roof & Ends
O	O	O	\$168	Insulation Polar Pak (R7 Sidewalls & Floor, R10 Roof)
S	S	S		Insulation R5 Fiberglass in Sidewalls, Roof & Floor
S	NA	NA		Jack for Hitch (2,000 lb.)
NA	NA	O	\$1,988	Jacks Elec. Leveling A&E
NA	O	NA	\$126	Jacks Stabilizer (set of 2)
O	NA	NA	\$251	Jacks Stabilizer (set of 4)
O	O	NA	\$239	Jack(s) for Hitch 12V Power
NA	NA	O	\$50	Mud Flaps (Front & Rear)

FLOOR PLANS	LEGEND	SPECIFICATIONS
CBD — Center Bath/Dinette	DD — Double Dinette	CA — Class A
FKD — Front Kitchen/Dinette	SBD — Side Bath/Dinette	Dbl. — Double
RB — Rear Bath	CB — Center Bath	Ex CAL — Except California
RBD — Rear Bath/Dinette	FKB — Front Kitchen Bunk	FW — Fifth Wheel
SB — Side Bath	FL — Front Lounge	ILO — In Lieu Of
WCB — Walk-Thru Center Bath	RK — Rear Kitchen	Lam. — Laminated
WCBD — Walk-Thru Center Bath/Dinette		MI — Mini Home
WD — Walk-Thru Bath/Dinette		NA — Not Available
WRKD — Walk-Thru Rear Kitchen/Dinette		O — Option
CBB — Center Bath Bunk		S — Standard
FSB — Front Side Bath		TT — Travel Trailer
W — Walk-Thru		V — Volt
		W/W — White Wall

Valued suppliers of Newmar Corporation.



RECREATIONAL VEHICLE PRODUCTS



TT	FW	MI	Retail Cost	
O	O	NA	\$84	Shock Absorbers
NA	O	NA	\$126	Shock Absorbers (4)
O	O	NA	\$13	Shock Absorbers (6)
NA	NA	S		Skid Bars for Rear Bottom Protection
O	O	O	\$84	Spare Tire Carrier
O	O	NA	\$154	Spare Tire Cover Deluxe (21' & up)
O	O	NA	\$244	Spare Tire & Carrier (15')
NA	NA	O	\$223	Spare Tire & Carrier (16')
NA	NA	S		Spare Tire & Deluxe Cover (Chevy)
S	S	S		Spare Tire (Ford)
S	S	NA		Structure Conventional
S	S	NA		Tires B78 13" C (18' & 20' only)
S	S	NA		Tires 7.75x15ST W/W (8.55x15 - 36' & Certain SS



Optional XL Package



Standard Etched Glass In Overhead

[Newmar Kountry Klub]

"Don't forget to check out the Klub... the Newmar Kountry Klub that is. All you need to be eligible is to be the proud owner of any one of the fine Newmar products!"



Super Storage Model

Your nearest American Star dealer:



Newmar Corporation, 355 North Delaware
Nappanee, IN 46550-0030, (219) 773-7791

Scheduled plant tours Monday-Friday

Prices and specs are subject to change without written notice at Newmar's discretion with no obligation.