



WHEN YOU KNOW THE DIFFERENCE™



MOUNTAIN
AIRE



2008 MOUNTAIN AIRE

WELCOME TO A *Poetic Life*

Every aspect of the new 2008 Mountain Aire is expressive and lyrical. In a word, poetic. From its sleek lines to its smallest contemporary details, Mountain Aire is a profound composition about a life fully lived.





THE NEW *Classic*

Mountain Aire's interior theme suggests a shift in luxury coach design. Free from ostentation or showy extravagance, this coach is classically beautiful and perfectly modern. It's composed of the latest fabrics, ambient lighting and clever touches, in addition to Villa™ furniture, porcelain floors and a 32" Sony® LCD TV with Surround Sound.

4521 floorplan with Tussah Décor and Carmel Glazed Cherry Hardwood Cabinetry

CONCISE STRUCTURE AND *Form*

Mountain Aire is a well-crafted machine. Can you see its precision? The sculpted exterior with Full-Paint Masterpiece™ Finish is glazed with a Super Clear Coat Finish and Diamond Shield protection for sheen and resilience. The front cap is tall and handsome, and flanking lustrous chrome mirrors have remote control, defrost and turn signal indicators.

You'll appreciate Mountain Aire's thoughtful details throughout, like the double steps that draw you inside when you open the entrance door and the newly designed headlights with diamond-like brilliance for the road ahead.





A CADENCE OF *Sounds*

Step into Mountain Aire's kitchen and listen. The swish of water running. The whistle of the tea kettle. The playful bubbling of soapsuds. Your state-of-the-art kitchen sounds and operates like that of a gourmet restaurant, with a 30" convection microwave oven with two-burner recessed gas cooktop, spacious sink with water filter and Delta® faucet, and optional in-drawer dishwasher.

Meticulously handcrafted hardwood cabinets and stainless appliances fill the kitchen and dining area. The rich wood, delicate detailing and silver hardware exemplify Newmar's renowned craftsmanship.





A Riveting EXPERIENCE

Settle into the plush Ultraleather driver's seat and experience Mountain Aire's strength. Vigorous and alert, isn't it? Beneath this coach is an impressive 450-hp Cummins® engine, built on top of a brawny Spartan® K2 chassis.

The real thrill of Mountain Aire is in the drive. Thanks to exclusive Comfort Drive™ Steering, you'll glide smoothly down the road. This cutting-edge technology makes turning, backing up and changing lanes nearly effortless. And unlike other coaches, there's little correction involved. Comfort Drive brings the steering wheel intuitively back to the center and helps you maintain a steadfast course.



THE LINES GO ON *Forever*

From the handcrafted woodwork to the stylish comforter, bedskirt and accent pillows, heaven-bound lines give your master bedroom a voluminous feel. And the fragrant cedar-lined closet, overhead cabinets and underbed storage offer space to comfortably house your latest fashions and accessories.

Your bedroom's positive energy will have you longing to spend time behind the decorative pocket door, curled up on your king-size bed atop a luxurious pillowtop mattress. It's a tranquil place to enjoy your 23" Sony® LCD TV and call it a day.



STANDARD & OPTIONAL FEATURES

STANDARD FEATURES

CHASSIS FEATURES

- Spartan® K2 Chassis with IFS
- Cummins® ISM 450 hp
- Two-Stage Engine Compression Brake
- Adjustable Pedals
- Tag Axles
- Coated Aluminum Wheels
- HWH® Four-Point Hydraulic Leveling Jacks with Automatic Control
- Comfort Drive™ Steering
- Cruise Control
- Power Tilt and Telescope Steering
- Recessed Fuel Fills with Crossover to Fill from Either Side
- Back-Up Alarm
- Anti-Lock Braking System
- Electronic Chassis Information Display in Dash

AIR CONDITIONING & HEATING

- Two 15M Penguin™ Heat Pump Central Air Conditioners (41' Floorplans)
- Three 15M Penguin™ Heat Pump Central Air Conditioners (45' Floorplans)
- Hydronic Zone Heating System
- Air Conditioning Condensation Lines through Rear Cap of Coach
- Dash Heater and High-Output Air Conditioner
- Propane Leak Detector
- Wall-Mounted Sensors for Heating and Air Conditioning

APPLIANCES & ACCESSORIES

- 30" GE® Convection Stainless Steel Microwave Oven
- Two-Burner Recessed Cooktop
- Polished Corian® Range Cover
- Norcold® 17 Cu.Ft. Refrigerator with Auto Defrost, Icemaker and Water Dispenser
- One-Piece Washer/Dryer Prep*
- Sony® 32" LCD TV in Living Area
- Sony® 22" LCD TV in Bedroom
- AM/FM Dash Radio with 6-Disc CD Player
- Rearview Color Monitor System
- Surround Sound System with AM/FM Radio, CD Player and DVD Player
- Cable TV Connection with Rg6 Coax
- TV Antenna with Power Booster with One Exterior Jack and Two Interior Jacks

- Audio/Video Switch System with Remote
- TV Antenna Is Up™ Warning Light
- Satellite Prep—Phone, TV Jack and Receptacle
- Telephone Connection with Phone Jacks in Living and Dash Areas
- High Definition Component Wiring and HD-ready Video Switching System
- Safe
- Roof-Mounted Air Horns
- 10 Bc Fire Extinguisher, and Carbon Monoxide and Smoke Detectors

CABINETS & FURNITURE

- Summer Maple Hardwood Unitized Cabinets with Full Overlay Doors
- Villa™ Furniture
- Residential Style Full Extension Ball Bearing Drawer Guides
- Dinette Table with Corian® Insert Top and Four Chairs (Two Fixed, Two Folding)*
- Concealed Hinges on Cabinet Doors
- Polished Corian® Countertop in Kitchen with Undermounted Solid Surface Sink and Flush Sink Covers
- Polished Corian® Countertop with Integrated Bowl in Bathroom
- Polished Corian® Tops on Bedroom Nightstands and Furniture Tops
- Pullout Pantry Shelves*
- Kitchen Countertop Extension*
- Ultra-leather Heated Driver/Passenger Seats with Eight-Way Power and Power Lumbar, with Power Footrest on Oversized Passenger Seat
- Lifts on Bed Top to Access Storage Area
- Cedar Paneling in Bedroom Wardrobe
- Carpet on Wardrobe Bottoms with Pearl Cream Headliner on Shelves and Overhead Cabinets
- Storage Shelves Recessed into Rear Cap of Rear Wardrobe Floorplans
- Luxurious Pillowtop Mattress with Quilted Bedspread, Reverse Shams, Matching Bed Skirt and Accent Pillows or King Bed*

ELECTRICAL FEATURES

- 10.0-kW Cummins Onan® Quiet Series Diesel Generator on Hydraulic Slideout with Auto Changeover and Energy Management System

- 50-Amp Electrical Service with Flexible Cord on Power Cord Rewind Reel
- Four 6-Volt House Batteries on Pullout Tray
- Battery Disconnect Switch
- 110-Volt Exterior Receptacle
- 5-Watt Solar Panel
- 2800-Watt Pure Sine-Wave Inverter with Automatic Generator Start
- Emergency Start Switch
- Exterior Security Light on Each Side
- Midship Side Turn Signals
- Recessed Docking Lights
- Switched Receptacle for Engine Block Heater
- Halogen Lights in Ceiling and Overhead Cabinets
- Lighted Wardrobe
- Slideout Information Voice Module
- Manually Operated Hold-to-Run Slideout Switch
- ICC Light Switch
- Two 12-Volt Auxiliary Receptacles on Dashboard
- Exterior TV Jack
- Interior Courtesy Lights
- Mood Lighting in Window Treatments, Kitchen and Bed Base
- Solar Prep
- Daylight Headlight System
- Map Lights

EXTERIOR FEATURES

- Full-Paint Masterpiece Finish™ with Super Clear Coat and Diamond Shield Front Protective Film
- Large Chrome Convex Exterior Mirrors with Remote Control, Defrost and Turn Signal Indicators
- One-Piece Bonded Windshield
- Entrance Door with Automatic Double Step
- Power Flush Stepwell Cover
- Lighted Exterior Storage Compartments with Cargo Liner Controlled by Interior Master Switch
- 15,000 lb. Towing Hitch with Two Extra 14-Gauge Wires
- Lighted Acrylic Assist Handle at Entrance Door
- Rear Protective Tow Guard with Stainless Steel Newmar Name Cutout
- Rear Ladder
- Squeeze-in Exterior Compartment
- Undercoating
- Mud Flaps

INTERIOR FEATURES

- Padded Vinyl Ceiling
- Lined Day/Night Pleated Window Shades and Lambrequins
- Mini Blinds in Bath Area
- Hardwood Fascia on Living Area Slideouts
- Hardwood Window Sill
- Polished Ceramic Floor Tile in Kitchen, Bathroom and Entrance Areas
- Polished Ceramic Backsplash with Listel Ceramic Tile Inlay
- Deluxe Carpeting with High-Density Padding in Living and Bedroom Areas
- Hardwood Raised-Panel Interior Passage Doors
- Recessed Ceiling Area with Mood Lighting and Hidden Vents
- Interior Assist Handle at Main Entrance Door
- Power Driver- and Passenger-Side Sun Shades
- Power-Activated Sun Visors
- Vertical Drop Windshield Area Privacy Shade
- Kitchen Wastebasket

PLUMBING & BATH FEATURES

- Demand Water System with AquaJet™ "ES" Pump
- Sewage Holding-Tank Rinse
- Thatford™ Aria Sculptured China Stool (Thatford™ Vacuum Flush Stool in Rear Bath Floorplans)
- Towel Bar, Tissue Holder, Towel Ring and Robe Hook
- Exterior Convenience Wash Station—Hot/Cold Water, Soap and Towel Dispenser
- Fiberglass Tub/Shower with Assist Handle and Glass Shower Door
- Monoplex Water-Pump Switches Located in Bathroom, Kitchen and Exterior Near Gate Valves
- Water Filter for Entire Unit
- Water Filter with Drink Dispenser at Kitchen Sink
- Automatic Rewind Water-Hose Reel
- Monitor Panel
- Designer Faucets in Kitchen and Bathroom

CONSTRUCTION FEATURES

- One-Piece Molded Fiberglass Roof with 9mm Decking
- Gelcoated Fiberglass Exterior Sides
- Gelcoated Fiberglass Front and Rear Caps
- Aluminum-Frame Sidewalls and Roof Construction, 16" on Center

- Power Lock Arms on All Slideout Rooms
- Roof R-Value Rating: 16
- Sidewall R-Value Rating: 11
- Floor R-Value Rating: 16
- Basement R-Value Rating: 4 (Included in Floor R-Value)

WINDOWS, AWNINGS & VENTS

- Flush Mounted, Double-Pane, Tinted Safety-Glass Windows
- Fan-Tastic® Vent with Rain Sensor in Kitchen and Bathroom Areas
- Skylight in Bathroom
- Keyless Entry
- Driver's-side Power Window
- Cockpit Overhead Ventilation System
- A & E® 9000 Bedroom and Slideout Window Awnings
- A & E® Oasis Power Front Entrance Door Awning
- Power Driver- and Passenger-Side Sun Shades
- A & E® Slideout Awning Covers

OPTIONAL FEATURES

APPLIANCES & ACCESSORIES

- 30" GE Profile™ Advantium™ Microwave/Convection Oven with Award-Winning Speedcook Technology
- Frigidaire® 23 Cu.Ft. Four-Door Refrigerator with Icemaker and Water Dispenser
- One-Piece Washer/Dryer
- Two-Piece Washer/Dryer
- Dishwasher in Drawer Below Two-Burner Cooktop
- All-Electric Unit with Hydronic Zone Heat, 2800-Watt Inverter, Four Extra Batteries and Frigidaire® Refrigerator
- Sony® 32" LCD TV in Front Overhead Cabinet
- SIRIUS® Satellite Radio Capability (Does Not Include Monthly Subscription)
- Bose Wave® Radio with CD Player and Alarm Clock in Bedroom
- External Entertainment Center with 26" LCD TV, AM/FM Radio and CD Player
- In-Motion High Definition Satellite with Receivers in Living and Bedroom Areas
- In-Motion Satellite without Receiver
- TripTek™ Electronic Travel Information (Displayed on Rearview Monitor)
- Sideview Cameras

- CB Radio with Antenna
- CB Antenna
- Wireless Internet Connection

CABINETS & FURNITURE

- Coastal Cherry Hardwood Cabinets
- Legacy Maple Hardwood Cabinets
- Carmel Glazed Cherry Hardwood Cabinets
- Ultra-leather Sofa*
- Ultra-leather U-dinette*
- Ultra-leather Combination U-Dinette and L-lounge*
- Ultra-leather Hide-a-Bed Sofa with Air Mattress*
- Combination Desk/Dinette Table with Two Fixed and Two Folding Chairs

ELECTRICAL FEATURES

- Pre-Wire for Freezer
- Energy Management System
- Roof-Mounted Spot Light
- Four AGM House Batteries
- Eight AGM Batteries (Available for All-Electric Unit Option)

EXTERIOR FEATURES

- Large Storage Tray with Access from One Side or Either Side
- Small Storage Tray
- Power Sliding Storage Tray
- Power Baggage Door Locks

INTERIOR FEATURES

- Polished Porcelain Floor Tile in Bath, Kitchen and throughout the Main Living Area with Custom Area Rug

PLUMBING & BATH FEATURES

- Corian® Shower Walls
- Fold-Down Shower Seat
- 110-Volt Heat Pads for Holding Tanks

WINDOWS, AWNINGS & VENTS

- Girard® Power Side Awning with Wind Sensor and Remote Control
- Drop-down Shade on Standard Weather Pro Side Awning

*Check with dealership on floorplan availability

FABRICS & CABINETS



Carmel Glazed Cherry



Coastal Cherry



Summer Maple



Legacy Maple



Eclipse



Pomegranate



Tussah



Vienna Black

EXTERIOR PAINTS



FLOORPLANS

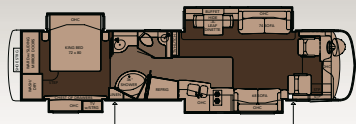

2008 Mountain Aire Diesel Pusher 4121

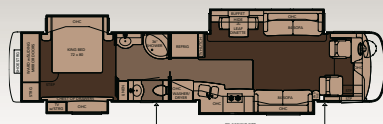

2008 Mountain Aire Diesel Pusher 4521

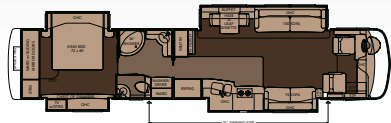

2008 Mountain Aire Diesel Pusher 4523



2008 Mountain Aire Diesel Pusher 4528

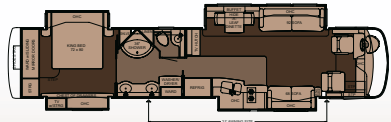

2008 Mountain Aire Diesel Pusher 4529

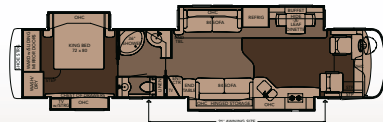

2008 Mountain Aire Diesel Pusher 4530

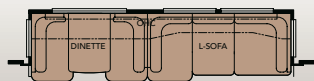

K800 Combination Dinette and L-Sofa
MADP 4521, 4523,
4528, 4529

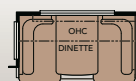

K422 Dinette
MADP 4121, 4521,
4523, 4528, 4529, 4530

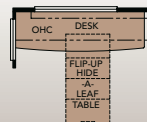

K122 Dinette-Computer
Station Combination
MADP 4121, 4521, 4523,
4528, 4529, 4530

SPECIFICATIONS

FLOORPLAN

FLOORPLAN	APP. OVERALL LENGTH	WIDTH	APP. OVERALL HEIGHT	INTERIOR WIDTH	INTERIOR HEIGHT	GREY	SEWAGE	WATER	LP	FURNACE
2008MADP4121	40' 11"	101.5"	12' 8"	95.5"	84"	65 gal.	45 gal.	105 gal.	32 gal.	50,000 Btu
2008MADP4521	44' 11"	101.5"	12' 8"	95.5"	84"	65 gal.	45 gal.	105 gal.	32 gal.	50,000 Btu
2008MADP4523	44' 11"	101.5"	12' 8"	95.5"	84"	65 gal.	45 gal.	105 gal.	32 gal.	50,000 Btu
2008MADP4528	44' 11"	101.5"	12' 8"	95.5"	84"	65 gal.	45 gal.	105 gal.	32 gal.	50,000 Btu
2008MADP4529	44' 11"	101.5"	12' 8"	95.5"	84"	65 gal.	45 gal.	105 gal.	32 gal.	50,000 Btu
2008MADP4530	44' 11"	101.5"	12' 8"	95.5"	84"	65 gal.	45 gal.	105 gal.	32 gal.	50,000 Btu

SPARTAN® CHASSIS

FLOORPLAN	ENGINE HP	AXLE RATIO	FUEL CAP.	WHEEL-BASE	FRONT GAWR*	REAR GAWR*	TAG GAWR*	GVWR*	GCWR*	APP. UVW	APP. NCC
2008MADP4121	450	4.33	150 gal.	246"+TAG	16,000 lb.	20,000 lb.	10,000 lb.	46,000 lb.	61,000 lb.	36,234 lb.	9,766 lb.
2008MADP4521	450	4.33	150 gal.	294"+TAG	16,000 lb.	20,000 lb.	10,000 lb.	46,000 lb.	61,000 lb.	37,684 lb.	8,316 lb.
2008MADP4523	450	4.33	150 gal.	294"+TAG	16,000 lb.	20,000 lb.	10,000 lb.	46,000 lb.	61,000 lb.	37,984 lb.	8,016 lb.
2008MADP4528	450	4.33	150 gal.	294"+TAG	16,000 lb.	20,000 lb.	10,000 lb.	46,000 lb.	61,000 lb.	37,784 lb.	8,216 lb.
2008MADP4529	450	4.33	150 gal.	294"+TAG	16,000 lb.	20,000 lb.	10,000 lb.	46,000 lb.	61,000 lb.	37,950 lb.	8,050 lb.
2008MADP4530	450	4.33	150 gal.	294"+TAG	16,000 lb.	20,000 lb.	10,000 lb.	46,000 lb.	61,000 lb.	37,800 lb.	8,200 lb.

Lengths, heights, widths and dry weights are approximate. Weight will vary based on optional equipment added to the above base weight.

GAWR: Gross Axle Weight Rating is the maximum permissible weight for an axle.

GVWR: Gross Vehicle Weight Rating is the maximum permissible weight for a fully loaded motor coach.

GCWR: Gross Combination Weight Rating is the value specified by the manufacturer of the vehicle as the maximum allowable loaded weight of this motor coach and any towed trailer or towed vehicle.

UVW: Unloaded Vehicle Weight is the weight of this motor coach as built at the factory with full fuel, engine oil and coolants. The UVW does not include cargo, fresh water, LP gas or dealer-installed accessories.

NCC: Net Carrying Capacity is the maximum weight of all occupants, including the driver, personal belongings, food, fresh water, waste water, LP gas, tools, tongue weight of towed vehicle, dealer-installed accessories, etc., that can be carried by the motor coach.

*Specifications supplied by the chassis manufacturer.

SPARTAN® K2 CHASSIS

SPARTAN



The K2 chassis has set the standard in the marketplace for its strength and power. It is equipped with a powerful Cummins® 450 horsepower ISM engine, plus a brawny 16,000 lb. IFS (Independent Front Suspension). The K2 chassis allows you to pass other drivers on a steep incline with

ease. And the K2 will allow you to maneuver the motor coach like a pro. Handle tight turns with perfect precision. Nothing can get in your way when you are equipped with a Spartan K2 under your coach. For peace of mind, there is a roadside assistance program for its entire warranty period.

CONSTRUCTION

Mountain Aire is a showcase for Newmar's exacting standards, meticulous detailing and legendary craftsmanship. The sturdy coach boasts a one-piece molded fiberglass roof and 16' on-center framing like that of a fine, site-built home.

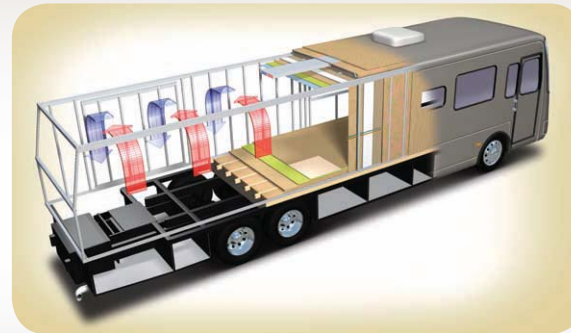

NEWMAR CENTRAL AIR CONDITIONING
Newmar's exceptional Total Comfort central air conditioning is standard on every Mountain Aire. The system consists of two separate fully ducted systems—one to distribute incoming cool air, the other to quickly and effectively remove warm air from your living area.



NEWMAR EXPRESS LIMITED WARRANTY™
Every Mountain Aire Diesel Pusher is backed by Newmar's two-year limited warranty/unlimited miles. Ask your Newmar dealer for details.

Roof R-Value = 16
One-Piece Molded Fiberglass Roof
9mm Wood Decking
Aluminum Rafter Framing
Fiberglass Batten Insulation
Sikaflex
A/C Ducting
Aluminum Stringer Framing
Kraft Paper Vapor Barrier
5/8" Bead Foam
3/16" Panel
Padded Vinyl Overlay



Sidewall R-Value = 11
Composite One-Piece Gelcoat
Exterior Sidewall
3/16" Plywood Exterior Wall
Fiberglass Batten Insulation
Sikaflex
5/8" Bead Foam
3/16" Plywood Interior Wall
Kraft Paper Vapor Barrier
Aluminum Framing with
3 1/2" Header Above



Floor R-Value = 16
Carpet/Tile
Carpet Padding
5/8" Floor Decking
2" x 3" Wood Framing
Fiberglass Batten Insulation
Polyethylene Moisture Barrier

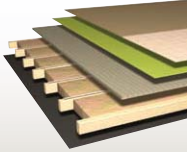

Basement R-Value = 4
Cargo Liner
3/8" Floor Decking
3/16" Luan Panel
1 1/2" Bead Foam
Aluminum Sheeting with
Steel Support Rails to
Prevent Bowing and Flexing

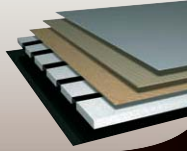



SEE MORE OF MOUNTAIN AIRE'S POETIC FEATURES AT
www.newmarcorp.com/mountainaire

OR VISIT YOUR LOCAL NEWMAR DEALER:



(Please affix dealer stamp in this area.)

MOUNTAIN AIRE



NEWMAR CORPORATION • 355 N DELAWARE ST • PO BOX 30 • NAPPANEE IN 46550-0030
574-773-7791 Fax 574-773-2895 • www.newmarcorp.com/mountaineire

