



WHEN YOU KNOW THE DIFFERENCE<sup>SM</sup>

2013  
Bay Star Sport  
Bay Star  
*Gas Motor Coach*

# 2013 BAY STAR

## *Gas Motor Coach*

Richness beyond what you'll invest to own it.  
And a sense that you're one smart shopper.  
From chassis to decor, everything in the Bay Star  
has been considered for pure livability. Ready?



### FEATURES AT A GLANCE

- New designer mitered door glazed cabinetry
- Cruise control
- Flexsteel® UltraLux Leather captain/passenger chairs and furniture\*
- Full-Paint Masterpiece Finish™ with front protective film
- Lighted exterior storage compartments with cargo liner

### Get into a Newmar. For a song.

This Bay Star coach apologizes for nothing. From its gleaming, car-like exterior to its surprisingly opulent cabin. Look closely. The fit and finish that you'd expect from Newmar is built right in.



*Bay Star Exterior*  
*Aztec Bronze Designer Style*



\*Check floorplan availability



# Bay Star

## This is living!

You'll realize you're finding excuses just to spend a little more time inside your new Bay Star. Maybe it's the soft, inviting Flexsteel® Ultralux leather couch. Maybe it's the way its designer cabinetry's glazed finish is so easy on the eyes. Or maybe you just feel like luxuriating. Whatever your reason, there's no arguing with the 2013 Bay Star's soothing comforts. Like its optional Sony® Surround Sound System with AM/FM radio and sub-woofer – or its stylishly roomy dinette. Gloating allowed.



\*Optional

### Every detail has been considered.

With a kitchen like this, dinner may linger into the wee hours. This Bay Star shines from the pure artistry of its newly glazed mitered cabinetry doors to its stunning designer stainless steel sink and faucet. And you'll enjoy appliances just like home, of course.



#### FEATURES AT A GLANCE

- Flexsteel® Ultralux leather furniture\*
- Sony® 32" or 40" LCD TV in the living area\*
- Solid surface kitchen backsplash with glass inserts
- Designer glazed mitered door cabinetry
- Designer vinyl tile floor in main living area



### Bay Star

*Aztec Bronze Decor Scheme with Sienna Maple  
Glazed Cabinetry in Floorplan # 3209*





# A Cozy Haven

When you want to chill, this is the place. Designer linens in soothingly rich tones create the mood; you choose the reason. Every pampering note has been included. From its cushy, suede-like headboard and overhead lighting to its richly carved bed surround, a restful atmosphere beckons. This ergonomically slanted 32” Sony® LCD TV is built in with a perfect view from your the bed. Its stepped dresser with black glass CD cabinet and mirrors gives you both full and short wardrobe space, in Bay Star’s rich finish. Let the pampering begin.

## Far From Everyday Life

Retire from the everyday to a completely relaxed zone. This is the R & R area. Newmar built this new Bay Star’s bed and bath amenities for comfort and ease. As always.



## Sleek Privacy Awaits

Bay Star’s bathroom boasts a spacious shower and dramatic new glazed, mitered door cabinets. Its designer vinyl tile floor and classic modern details add to its spa-like atmosphere.

## EXTERIORS



AZTEC BRONZE

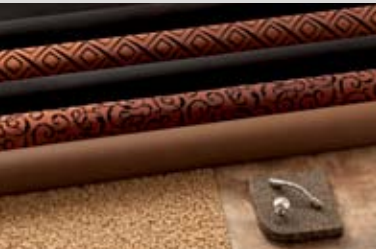

MACADAMIA



## WOOD OPTIONS



EMPIRE GLAZED MAPLE  
WITH DESIGNER MITERED DOORS



SIENNA GLAZED MAPLE  
WITH DESIGNER MITERED DOORS



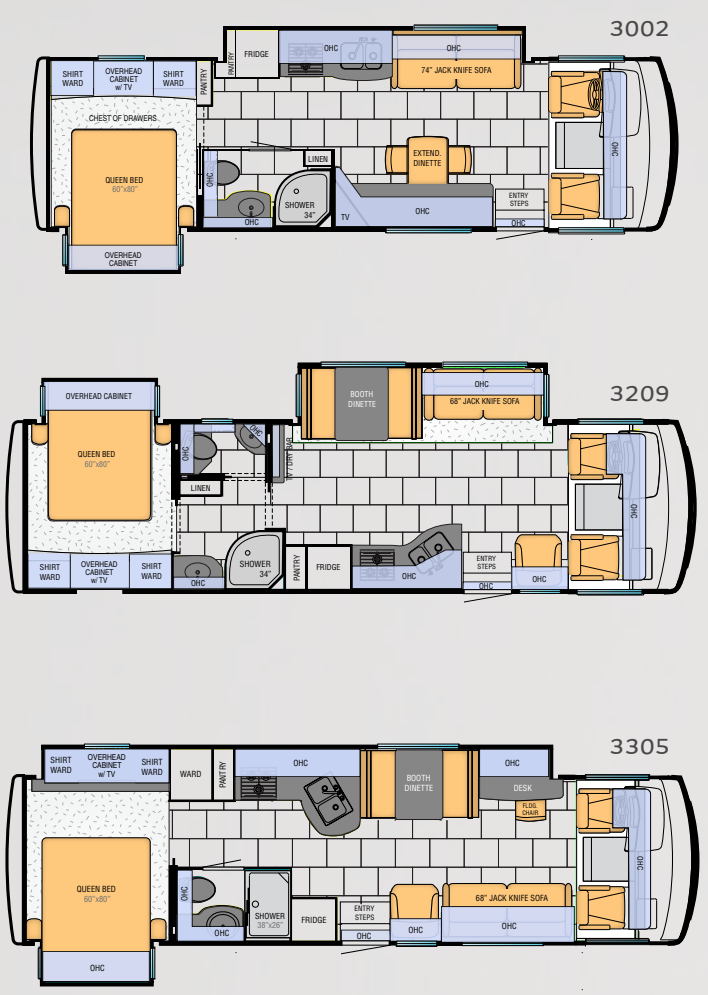
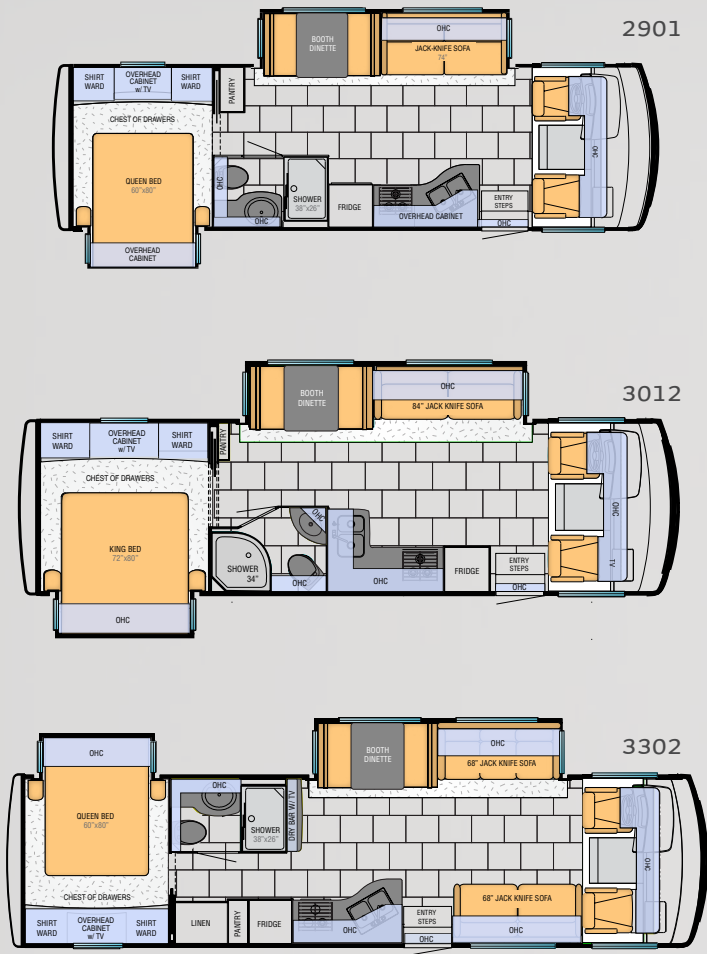

BAY STAR FLOORPLAN SPECIFICATIONS

Floorplan	App. Overall Length	Width	App. Overall Height	Interior Width	Interior Height	Grey	Sewage	Water	Propane	Furnace
2901	29' 10"	101.5"	12' 4"	95.5"	80"	60 gal.	40 gal.	75 gal.	25 gal.	40,000 btu
3002	30' 9"	101.5"	12' 4"	95.5"	80"	60 gal.	40 gal.	75 gal.	25 gal.	40,000 btu
3012	30' 11"	101.5"	12' 4"	95.5"	80"	60 gal.	40 gal.	75 gal.	25 gal.	40,000 btu
3209	32' 11"	101.5"	12' 4"	95.5"	80"	60 gal.	40 gal.	75 gal.	25 gal.	40,000 btu
3302	33' 11"	101.5"	12' 4"	95.5"	80"	60 gal.	40 gal.	75 gal.	25 gal.	40,000 btu
3305	33' 11"	101.5"	12' 4"	95.5"	80"	60 gal.	40 gal.	75 gal.	25 gal.	40,000 btu

CHASSIS FEATURES

- Ford® F-53 20,500Lb. Chassis
- Cruise Control
- Tilt Steering Wheel
- Stainless Steel Wheel Simulators

APPLIANCES & ACCESSORIES

- Three-Burner Range with Metal Oven Door and Ignition
- Bi-Fold Range Cover
- Norcold® 8-Cu.Ft. Refrigerator with Black Front Panel
- Spacesaver 30" Microwave Oven
- 6-Gal. Gas/Electric Water Heater with Electronic Ignition
- Sony® 32" or 40" LCD TV in Living Area\*
- Sony® DVD Players in Living Area and Bedroom
- Sony® 32" LCD TV in Bedroom
- AM/FM Dash Radio with MP3 Adapter and CD Player
- Rear View Color Monitor System with Audio
- TV Antenna with Power Booster with Two Interior Jacks
- Satellite Prep
- Cable TV Connection
- 10-Bc Fire Extinguisher, Smoke Detector and Carbon Monoxide Detector

AIR CONDITIONING & HEATING

- 13.5M Brisk® Central Air Conditioner
- Driver/Passenger Overhead Dash Fans
- Dash Heater and Air Conditioner
- Propane Leak Detector

CABINETS & FURNITURE

- Empire Maple Glazed Mitered Overhead Cabinet Doors
- Booth Dinette\*
- Laminate Kitchen Countertop with Bullnose Edge
- Laminate Countertop on Bedroom Nightstands and Chests
- Stainless Steel Kitchen Sink with Sink Covers
- Laminate Countertop with Bullnose Edge and Acrylic Bowl in Bathroom
- Residential Style Full-Extension Ball Bearing Drawer Guides

- Pull Out Pantry\*
- Lifts on Bed Top
- Flexsteel® Ultralux Leather Sofa
- Smooth Top Mattress with Quilted Bedspread and Accent Pillow

ELECTRICAL FEATURES

- 4.0-kW Cummins Onan® Generator with Remote Switch and Automatic Changeover
- 30-Amp Electrical Service with Flexible Cord
- Two 12-Volt House Batteries
- Battery Disconnect Switch
- 110-Volt Exterior Receptacle
- 12-Volt Auxiliary Receptacle on Dashboard
- 5-Watt Solar Panel
- 45-Amp Converter
- Daytime Running Lights
- Emergency Start Switch
- Fluorescent Ceiling Lights Throughout
- Lighted Wardrobe
- Manually Operated Hold-To-Run Slideout Switch
- Exterior TV Jack

PLUMBING & BATH FEATURES

- Demand Water System with SHURflo® Pump
- Sewage Holding Tank Rinse
- Water Heater Bypass System
- Thetford™ Aqua Magic Stool with Spray Attachment
- ABS Shower with Glass Enclosure
- Exterior Shower
- Monitor Panel

WINDOWS, AWNINGS & VENTS

- Tinted Safety Glass Windows
- Power Vent with Wall Switch in Bathroom and Kitchen
- Skylight in Bathroom\*
- Dometic® A & E 8500 Side Awning with Weather Shield
- Slideout Covers

INTERIOR FEATURES

- Padded Vinyl Ceiling
- Day/Night Pleated Window Shades and Valances
- Mini Blinds in Bathroom
- Vinyl Floor in Kitchen, Living Area and Bathroom
- Carpeting in Bedroom
- Interior Assist Handle at Main Entrance Door
- Shoe Storage Located in Entrance Step Compartment\*
- Wraparound Windshield Privacy Shade

EXTERIOR FEATURES

- Full-Paint Masterpiece Finish™ with Front Protective Film
- One-Piece Windshield
- Convex Exterior Mirrors with Defrost
- Entrance Door with Automatic Double Step
- Lighted Exterior Storage Compartments with Cargo Liner
- Rear Hitch for Towing Car with Two Extra 14- Gauge Wires
- Assist Handle at Entrance Door
- Undercoating
- Mud Flaps

CONSTRUCTION FEATURES

- BriteTEK™ Roof with 9mm Decking
- Gel Coated Fiberglass Exterior Sides
- Gel Coated Fiberglass Front and Rear Caps
- Aluminum Frame Sidewalls and Roof on 16" Centers
- 5/8" Bead Foam Insulation Laminated in Sidewalls & Ceiling

OPTIONS

OPTIONS PACKAGE

- Extra 13.5M Brisk® Central Air Conditioner, 5.5 Cummins Onan® Marquis Generator and 50-Amp Service with Energy Management System (30' – 33' floorplans)

AIR CONDITIONING AND HEATING

- 15.0M Penguin™ Heat Pump Central Air Conditioner
- Auxiliary Heater in Bedroom

APPLIANCES & ACCESSORIES

- 30" Convectional Microwave with 3-Burner Cooktop
- 10-Cu Ft. Frigidaire® Residential Refrigerator
- Sony® Surround Sound System with AM/FM Radio and Sub-woofer
- Sony® 22" LCD TV Located at Dry Bar Cabinet\*
- Sony® 32" LCD TV in Front Overhead
- Sirius® Satellite Radio Capability (does not include monthly subscription)
- Automatic Satellite Dish (does not include receiver)
- CB Antenna
- High Definition Wiring
- Side View Cameras

CABINETS & FURNITURE

- Sienna Maple Cabinets
- Driver's Seat with 6-Way Power
- Combination Desk/Dinette with Cantilevered Table and 4 Chairs (2 Fixed, 2 Folding)
- Hidden-Leaf Dinette Table with 4 Chairs (2 Fixed, 2 Folding)\*
- Hide-A-Bed Sofa on Off Door Side

ELECTRICAL FEATURES

- 600-Watt Inverters for Living Area and Bedroom TVs
- Halogen Ceiling Lights in place of Fluorescent Lights with 80-amp Converter
- Solar Prep for House Batteries

EXTERIOR FEATURES

- Convex Exterior Mirrors with Defrost and Remote Control
- Rear Ladder

INTERIOR FEATURES

- Vinyl Tile in Kitchen, Foyer and Bathroom
- Solid Surface Kitchen Countertop

PLUMBING & BATH FEATURES

- 110-Volt Heatpads for Holding Tanks

WINDOWS, AWNINGS, & VENTS

- Double-Pane Tinted Safety Glass Windows
- Rear Window
- Kitchen Window
- Bunk Windows\*
- Dometic® Power Side Awning

CONSTRUCTION FEATURES

- Polar Pak R19 Insulation in Roof

\*Check with dealership on floorplan availability and complete listing of features.

CONSTRUCTION & SPECIFICATIONS

Bay Star coaches feature 20.5 k Ford® F-53 20,500 lb. chassis and include Total Comfort™ Dual In-Roof Ducting Systems and aluminum frame construction.



BAY STAR SPORT CHASSIS SPECIFICATIONS

Floor Plan	Engine HP	Axle Ratio	Fuel Cap.	Wheelbase	Front GAWR*	Rear GAWR*	Tag GAWR*	GVWR*	GCWR*	App. UVW	App. NCC
2702	362	4.88	80 gal.	172"	7,000 lb.	12,000 lb.	0	18,000 lb.	26,000 lb.	15,182 lb.	2,818 lb.
2901	362	4.88	80 gal.	190"	7,000 lb.	12,000 lb.	0	18,000 lb.	26,000 lb.	15,245 lb.	2,755 lb.
3209	362	5.38	80 gal.	208"	7,500 lb.	13,500 lb.	0	20,500 lb.	26,000 lb.	17,188 lb.	3,312 lb.
3310	362	5.38	80 gal.	208"	7,500 lb.	13,500 lb.	0	20,500 lb.	26,000 lb.	16,408 lb.	4,092 lb.

BAY STAR CHASSIS SPECIFICATIONS

Floor Plan	Engine HP	Axle Ratio	Fuel Cap.	Wheelbase	Front GAWR*	Rear GAWR*	Tag GAWR*	GVWR*	GCWR*	App. UVW	App. NCC
2901	362	5.38	80 gal.	190"	7,500 lb.	13,500 lb.	0	20,500 lb.	26,000 lb.	16,083 lb.	4,417 lb.
3002	362	5.38	80 gal.	190"	7,500 lb.	13,500 lb.	0	20,500 lb.	26,000 lb.	16,592 lb.	3,908 lb.
3012	362	5.38	80 gal.	190"	7,500 lb.	13,500 lb.	0	20,500 lb.	26,000 lb.	14,997 lb.	5,503 lb.
3209	362	5.38	80 gal.	200"	7,500 lb.	13,500 lb.	0	20,500 lb.	26,000 lb.	16,815 lb.	3,685 lb.
3302	362	5.38	80 gal.	208"	7,500 lb.	13,500 lb.	0	20,500 lb.	26,000 lb.	17,300 lb.	3,200 lb.
3305	362	5.38	80 gal.	222"	7,500 lb.	13,500 lb.	0	20,500 lb.	26,000 lb.	17,656 lb.	2,844 lb.

CEILING R-VALUE = 16

- a. BriteTEK™ Roof
- b. 9mm Wood Decking
- c. Fiberglass Batten Insulation
- d. Total Comfort™ Ducted A/C
- e. Aluminum Roof Truss
- f. Kraft Paper Vapor Barrier
- g. 5/8" Bead Foam
- h. 3/16" Plywood Ceiling Panel
- i. Padded Vinyl Overlay

WALLS R-VALUE = 11

- j. 16" On-Center Aluminum Framing with 3 1/2" Header
- k. 3/16" Plywood Interior Wall
- l. 5/8" Bead Foam
- m. Kraft Paper Vapor Barrier
- n. Fiberglass Batten Insulation
- o. 3/16" Plywood Exterior Wall
- p. Composite One-Piece Gelcoat Exterior Sidewall

FLOOR R-VALUE = 11

- q. Carpet /Tile
- r. Carpet Padding
- s. 5/8" Floor Decking
- t. Fiberglass Batten Insulation
- u. 2"x 3" Wood Framing
- v. Polyethylene Moisture Barrier
- w. Aluminum Ducting

Lengths, heights, widths and dry weights are approximate. Weight will vary based on optional equipment added to the above base weight.

**GAWR:** Gross Axle Weight Rating is the maximum permissible weight for an axle.

**GVWR:** Gross Vehicle Weight Rating is the maximum permissible weight for a fully loaded motor coach.

**GCWR:** Gross Combination Weight Rating is the value specified by the manufacturer of the vehicle as the maximum allowable loaded weight of this motor coach and any towed trailer or towed vehicle.

**UVW:** Unloaded Vehicle Weight is the weight of this motorcoach as built at the factory with full fuel, engine oil and coolants. The UVW does not include cargo, fresh water, propane gas or dealer-installed accessories.

**NCC:** Net Carrying Capacity is the maximum weight of all occupants, including the driver, personal belongings, food, fresh water, waste water, propane gas, tools, tongue weight of towed vehicle, dealer-installed accessories, etc., that can be carried by the motorcoach.

\*Specifications supplied by the chassis manufacturer.

NEWMAR PARTNERS

Cummins

Onan



CUMMINS ONAN · *Performance You Rely On™*

An innovator in standby and mobile power generation for more than 80 years, Cummins Onan generators are built by Cummins Power Generation, a globally recognized name in the design and manufacture of power generation products and services.

[www.cumminsonan.com](http://www.cumminsonan.com)



Driven By You

FREIGHTLINER CUSTOM CHASSIS · *Driven by You*

A subsidiary of Daimler Trucks North America, Freightliner Custom Chassis Corporation manufactures premium chassis that have become renowned for their exceptional ride and handling characteristics, tight turning radius and extraordinary dependability.

[www.freightlinerchassis.com](http://www.freightlinerchassis.com)



SONY · *make.believe™*

One of the most comprehensive entertainment and technology companies in the world, Sony Corporation is a leading manufacturer of audio, video, communications and information technology products for consumers and professionals alike.

[www.sony.com](http://www.sony.com)



SPARTAN CHASSIS · *The Premier Foundation*

Spartan Chassis is a world class leader in the design, engineering and flexible production of chassis and components that consistently deliver superior performance, exceptional safety ratings and technological innovations.

[www.spartanchassis.com](http://www.spartanchassis.com)

Newmar.

Where the finest names in quality and performance are along for the ride.

To assure that you experience only the best in comfort, control and unsurpassed convenience in our incomparable family of luxury coaches, Newmar partners with the most prestigious names in mobile lifestyle, entertainment and technology. These brands are leaders in their fields —and legends in providing customers with new, unsurpassed levels of quality and reliability.

Best in class performance from names you can trust. At Newmar, that’s our difference. And our promise.





Mahlon Miller,  
Newmar founder,  
and Matthew Miller,  
Newmar president,  
lifelong motor coach  
enthusiasts



# Trust.

## The strongest possible foundation for a motor coach.

According to Newmar president Matthew Miller, "Customers say they're loyal to us because they trust us to stand behind our products, from support, parts and service to paying our warranties. It feels good to own a coach that has all of that behind it."

How do we sustain this high level of service? At Newmar, there's a Miller way of doing things. These principles guide us every day. Courtesy. Integrity. And reliability. So when you buy from Newmar, you know that every single person who touches your coach or talks with you has your back. Period.

## Gather. Where the Newmar owners are.

The Newmar Kountry Klub is an exclusive club for owners of fine Newmar products that offers many advantages and benefits to its members. Learn more at: [www.newmarkountryklub.com](http://www.newmarkountryklub.com).

### NEWMAR EXPRESS LIMITED WARRANTY

Every Bay Star & Bay Star Sport Gas Motorcoach is backed by Newmar's one-year limited warranty/unlimited miles. Ask your Newmar dealer for details.

### LIMITED FIVE-YEAR STRUCTURAL WARRANTY

If any part of your Newmar recreational vehicle superstructure (which is the steel/aluminum structure of the sidewall, roof or frame) fails to perform properly within five years from the date of purchase because of faulty workmanship or material supplied by Newmar, it will be repaired without charge for either parts or labor by Newmar. This structural warranty is available only to the original purchaser and is non-transferable.

Some features in our literature are optional. Colors and finishes are photographic representations. The actual materials may look different. Prices, specifications and floorplans are subject to change at Newmar's discretion, without prior notice or obligation. Please see your dealer for actual samples and specifications.



WHEN YOU KNOW THE DIFFERENCE™

#### NEWMAR CORPORATION

355 N DELAWARE ST  
PO BOX 30  
NAPPANEE IN 46550-0030  
574-773-7791 Fax 574-773-2895

[www.newmarcorp.com](http://www.newmarcorp.com)