

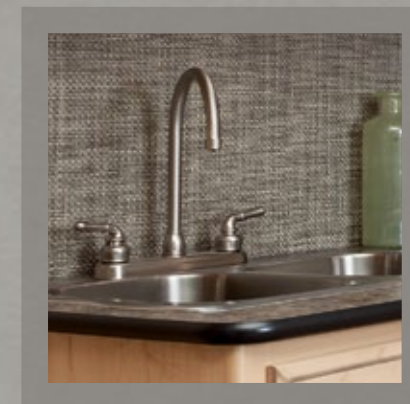

2014
**BAY STAR
 & BAY STAR SPORT**
Gas Motor Coach

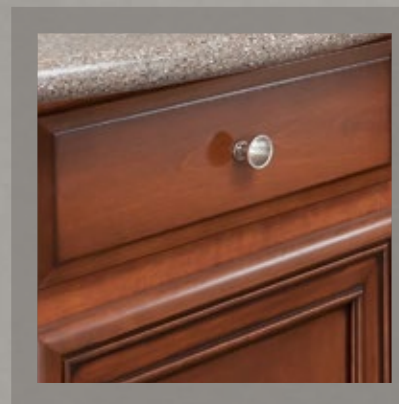
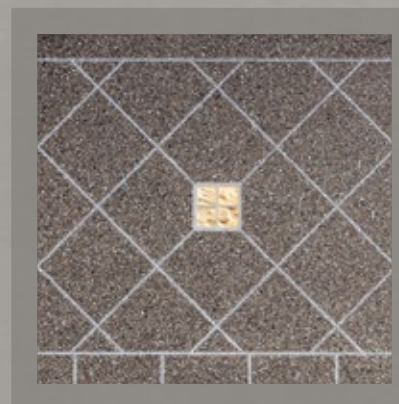

WHEN YOU KNOW THE DIFFERENCE SM

2014 Bay Star Sport



2014 Bay Star Sport Exterior
Floor plan #3220 in Onyx Exterior with Optional Paint



The life you
deserve, at the
price you desire.

The 2014 Bay Star Sport brings all the quality and comfort that you expect from Newmar. Whether you're a motor coach weekender looking to move up to the next level, or you're entirely new to life on the road, the Bay Star Sport will satisfy your wanderlust in style.

Beauty, redefined.

The 2014 Bay Star Sport exterior graphics are all new. The Bay Star Sport offers four distinct exterior décor options and the Newmar commitment to a superior quality finish ensures you won't believe your eyes.



Features at a glance:

- Six-way power driver's seat*
- Lighted exterior storage compartments with cargo liner
- Driver/passenger overhead dash fans with 13.5M Brisk® Central Air Conditioner

*Optional



Bay Star Sport Interior
 Floor plan #3220 with Carbon Décor Style and Bisque
 Maple Cabinetry with Glazed Doors

Splendor from the outside in.

When you step inside the Bay Star Sport, the wonder doesn't end. Every inch of the coach's interior is flawlessly crafted, from the sharp contrasting welt on the plush leather sofa to the new diagonally-laid vinyl flooring to the Flexsteel furnishings. The Bay Star Sport's interior is designed to impress from ceiling to floor.

In the Bay Star Sport, the ambitious cook will have everything necessary to prepare any meal, no matter where you go. Every part is designed to perfectly bond functional craftsmanship with bold style. Spacious countertops, a new "woven grass" backsplash, and intricately constructed cabinetry all set the Bay Star Sport apart.

Features at a glance:

- Three-burner range with metal oven door & Piezo Ignition
- Norcold® 8 cu. ft. refrigerator with black front panel
- 30" Over the range microwave oven (on floor plan #3220)

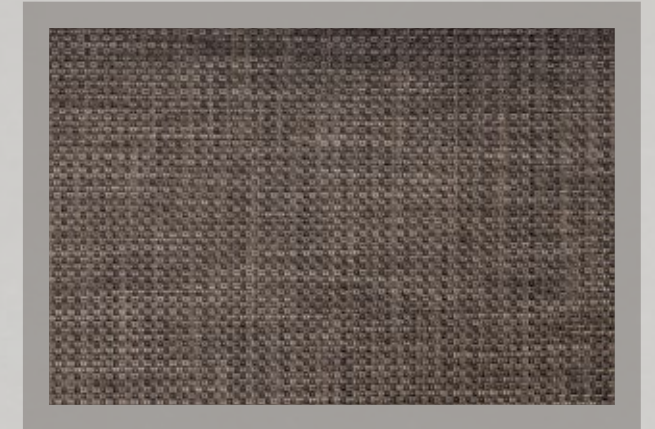

Sleep ensconced in rich comfort.

The attention to detail in décor and design doesn't stop in Bay Star Sport's main cabin. A slew of new amenities make the bedroom something special, whether you're going straight to sleep after a day on the road, or you want to watch a bit of television before drifting off. The scalloped plush headboard with braided cord inlay adds class, and the all-new window treatments feature enhanced styling – along with the new quilted bedspread and dressings.

A pair of full-size mirrors expand the room, and ample storage space means you can bring as much of your wardrobe as you like. From the high quality fabrics to the carefully-designed color palettes, Bay Star Sport's bedroom is built for comfort and style.

Features at a glance:

- Smooth-top mattress with lifts on bed top
- Sony® LED TV and DVD player
- Quilted bedspread with shams, bed scarf, and accent pillow



Refresh yourself at your leisure.

Bay Star Sport's bathroom affords you the space and features you need to keep comfortable on the road, wherever it takes you. Ample storage, as well as a large shower, sink, and countertop all give your family the room it needs while getting ready for your day. Add in the trademark Newmar décor and design, and touches like the natural light from the shower skylight, and the Bay Star Sport bathroom impresses visually and functionally.

BAY STAR SPORT EXTERIOR DÉCOR



Onyx Exterior/Optional Paint



Sahara Exterior/Optional Paint

BAY STAR SPORT INTERIOR DÉCOR

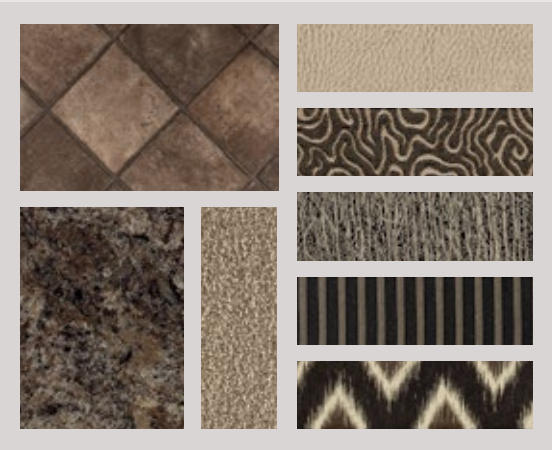

Carbon Interior

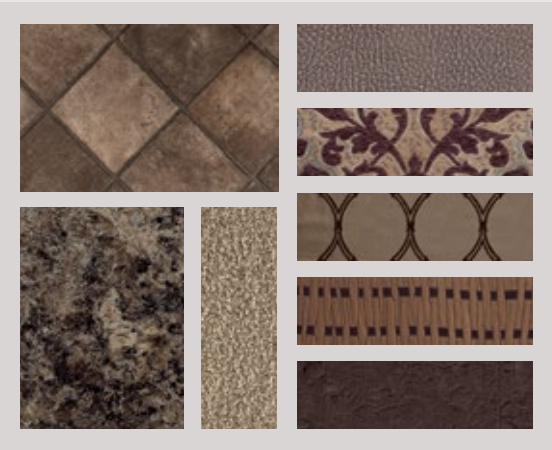

Coffee Interior

WOOD OPTIONS



Bisque Maple with Glazed Doors



Sienna Maple with Glazed Doors



Empire Maple with Glazed Doors

BAY STAR SPORT FLOOR PLANS

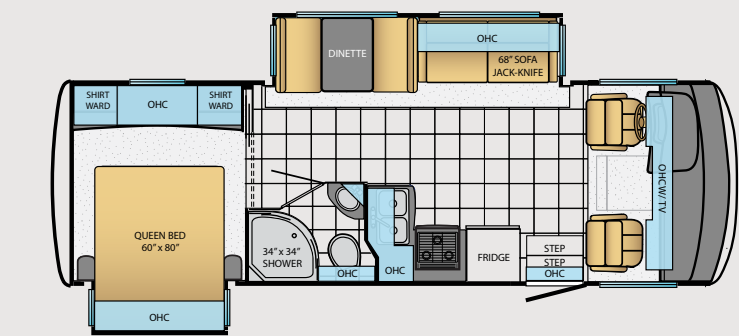

2702

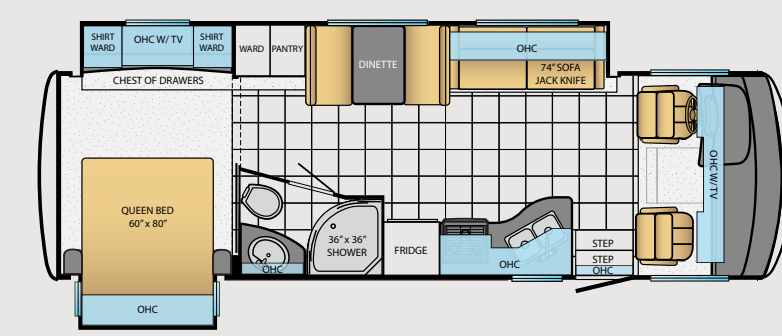

2903

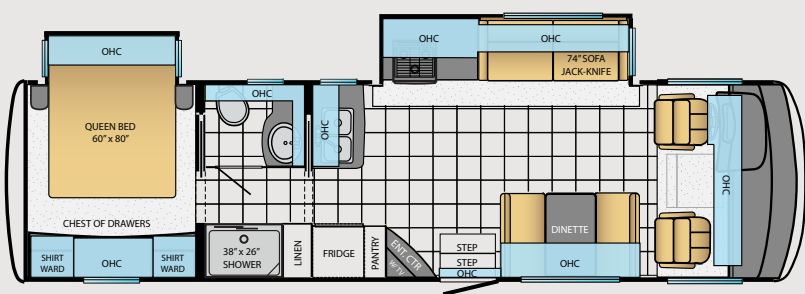

3220

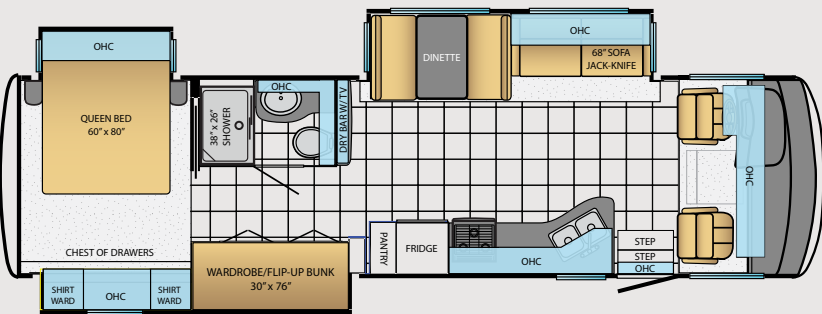

3306

FLOOR PLAN SPECIFICATIONS

Floor Plan	App. Overall Length	Width	App. Overall Height	Interior Width	Interior Height	Grey Tank	Sewage Tank	Water Tank	Propane Tank	Furnace
2702	27' 10"	101.5"	12' 4"	95.5"	80"	60 gal.	40 gal.	75 gal.	25 gal.	30,000 btu
2903	29' 11"	101.5"	12' 4"	95.5"	80"	60 gal.	40 gal.	75 gal.	25 gal.	30,000 btu
3220	32' 11"	101.5"	12' 4"	95.5"	80"	60 gal.	40 gal.	75 gal.	25 gal.	30,000 btu
3306	33' 11"	101.5"	12' 4"	95.5"	80"	60 gal.	40 gal.	75 gal.	25 gal.	30,000 btu

BAY STAR SPORT FEATURES & OPTIONS



Chassis Features

Built specifically for Newmar with the highest quality in handling, safety, performance, and dependability.

Ford F-53 Chassis 18,000 lb. on 2702 floorplan
Ford F-53 Chassis 20,500 lb. on 2903, 3209 & 3310 floorplans
Cruise Control
Tilt Steering Wheel
Stainless Steel Wheel Simulators



Air Conditioning & Heating

Total Comfort Air Conditioning and Heating systems make climate control simple and effective.

13.5M Brisk® Central Air Conditioner
Dash Heater and Air Conditioner
Propane Gas Furnace with Ducted Heat
Propane Leak Detector

OPTIONS
15.0M Penguin™ Heat Pump Central Air Conditioner
Auxiliary Heater in Bedroom
Extra 13.5 Brisk Air Conditioner, 5.5 Onan Generator, 50 Amp Electrical Service with Energy Management System



Appliances & Accessories

All of the amenities of a fine home are integrated in the Newmar design, in both form and capabilities.

Three-Burner Range with Glass Oven Door
Range Hood with Light and Fan
Dometic® 6 Cu. Ft. Refrigerator with Wood Paneling Front
Microwave Oven
Over the Range Microwave Oven on Floor Plan #3220
6 gal. Gas/Electric Water Heater with Direct Spark Ignition



Audio, Video & Accessories

Stay entertained on the road and off, with spectacular visual and sound options from industry leaders.

LED TV in Living Area (TV sizes vary per floorplan)
AM/FM Dash Radio with CD Player and Auxiliary Jack
Rearview Colored Monitor System with Audio
Winegard Digital TV Antenna

OPTIONS
LED TV in Bedroom
DVD Player with Coax Switcher
Satellite Dish Prep on Roof

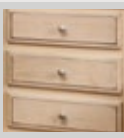

Cabinets & Furniture

Amish craftsmanship and elegance in design meld the wood cabinetry and furniture seamlessly with the Newmar interior.

Sienna Maple Mitered Designer Glazed Cabinet Doors
Empire Maple Mitered Designer Glazed Cabinet Doors
Concealed Hinges on Cabinet Doors
Laminate Kitchen Countertop with Stainless Steel Sink
Laminate Countertop on Bedroom Nightstands and Chests
Laminate Countertop in Bathroom with Acrylic Sink
Residential-Style Full-Extension Ball Bearing Drawer Guides
Flexsteel® Delux Leather Furniture
Lifts on Bed Top
Smooth-Top Mattress

OPTIONS
Bisque Maple Glazed Cabinets
Plush Pillow Top Mattress
Fold & Tumble Sofa with Air Mattress



Electrical Features

A Newmar coach's electrical and lighting system is designed for maximum reliability, functionality, and style.

4.0 kW Cummins Onan® Generator with Remote Switch and Automatic Changeover
30 Amp Electrical Service with Flexible Cord
Two 12 Volt House Batteries
Manual Battery Disconnect Switch
110 Volt Exterior Receptacle
12 Volt Auxiliary Receptacle on Dashboard
45 Amp Converter
Daytime Running Lights
Emergency Start Switch
Incandescent Ceiling Lights Throughout
Manually Operated Hold-To-Run Slideout Switch
Cable TV Connection

OPTIONS
600 Watt Inverter for Living Area and Bedroom TVs



Exterior Features

The Full-Paint Masterpiece Finish is one of the most beautiful and durable in the industry, with the goal of a perfect finish, every time.

Exterior Vinyl Graphics on White Exterior
Lighted Exterior Storage Compartments with Cargo Liner
Automatic Step for Entrance Door
Convex Exterior Mirrors
Lighted Exterior Storage Compartments Finished with Cargo Liner
Rear Hitch for Towing Car
Assist Handle at Entrance Door
Undercoating
Mud Flaps

OPTIONS
Convex Exterior Mirrors with Defrost and Remote Control
Hydraulic Leveling Jacks
Rear Ladder
Diamond Shield Protection on Front Cap
Exterior Painted Skirt and Mask



Interior Features

Flooring – both tile and carpet – is installed with Newmar's own in-house process, ensuring the best in quality and longevity, as well as the finest fit.

Vinyl Ceiling Panels
Pleated Window Shades
Decorative Wall Art
Mini Blinds in Bathroom Window
Vinyl Floor in Kitchen, Living Area and Bathroom
Carpeting on Slideout floors
Interior Assist Handle at Main Entrance Door
Quilted Bedspread with Shams, Bed Scarf & Accent Pillows
Inlayed Six Panel Design Interior Passenger Doors
Auto Motion Power Shade at Windshield & Manual Shades at Driver & Passenger Side Windows
Dash Panel color Coordinated ABS
10 Bc Fire Extinguisher, Smoke Detector and Carbon Monoxide Detector



Windows, Vents & Awnings

Experience as much – or as little – of the outdoors as you want in comfort and style.

One Piece Bonded Tinted Windshield
Single Pane Tinted Safety-Glass Windows
Power Vent in Bathroom
Skylight in Bathroom*
Dometic® 8500 Side Awning

OPTIONS
Two Slideout Covers
Double-Pane Tinted Safety Glass Windows
Dometic® 9100 Side Awning
Rear Window in Bedroom
Power Vent in Kitchen
Bunk Windows*

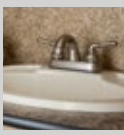

Plumbing & Bath Features

The Demand Water System's residential flow response ensures that the comfort and reliability of home are never far away.

Demand Water System
Sewage Holding-Tank Rinse
Water Heater Bypass System
Dometic® China Bowl Stool
ABS Shower Surround with Shower Door
Monitor Panel

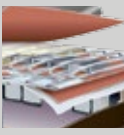

Construction Features

From the chassis on up, Newmar coaches are built to be dependable, durable, comfortable, and beautiful.

BriteTEK™ Roof with Walkable Decking
Gelcoated Fiberglass Exterior Sidewalls, Front & Rear Caps
Aluminum-Frame Sidewalls & Roof on 16" Centers
5/8" Foam Insulation Laminated in Sidewalls & Ceiling

*Check with dealership on floor plan availability and complete listing of features.

BAY STAR SPORT & BAY STAR CONSTRUCTION



The Bay Star coach features a Ford® F-53 chassis and includes Total Comfort™ Dual In-Roof Ducting Systems and aluminum frame construction.

CEILING R-VALUE = 16

- a. BriteTEK™ Roof
- b. 9mm Wood Decking
- c. Fiberglass Batten Insulation
- d. Total Comfort™ Ducted A/C
- e. Aluminum Roof Truss
- f. Kraft Paper Vapor Barrier
- g. 5/8" Bead Foam
- h. 3/16" Plywood Ceiling Panel
- i. Padded Vinyl Overlay

WALLS R-VALUE = 11

- j. 16" On-Center Aluminum Framing with 3 1/2" Header
- k. 3/16" Plywood Interior Wall
- l. 5/8" Bead Foam
- m. Kraft Paper Vapor Barrier
- n. Fiberglass Batten Insulation
- o. 3/16" Plywood Exterior Wall
- p. Composite One-Piece Gelcoat Exterior Sidewall

FLOOR R-VALUE = 11

- q. Carpet /Tile
- r. Carpet Padding
- s. 5/8" Floor Decking
- t. Fiberglass Batten Insulation
- u. 2"x 3" Wood Framing
- v. Polyethylene Moisture Barrier
- w. Aluminum Ducting

BAY STAR SPORT SPECIFICATIONS

Floor Plan	Engine HP	Axle Ratio	Fuel Cap.	Wheel Base	Front GAWR*	Rear GAWR*	Tag GAWR*	GVWR*	GCWR*	App. UVW	App. NCC
2702	362	4.88	80 gal.	172"	7,000 lb.	12,000 lb.	0	18,000 lb.	26,000 lb.	15,100 lb.	2,900 lb.
2903	362	5.38	80 gal.	190"	7,500 lb.	13,500 lb.	0	20,500 lb.	26,000 lb.	15,600 lb.	4,900 lb.
3220	362	5.38	80 gal.	200"	7,500 lb.	13,500 lb.	0	20,500 lb.	26,000 lb.	16,300 lb.	4,200 lb.
3306	362	5.38	80 gal.	208"	7,500 lb.	13,500 lb.	0	20,500 lb.	26,000 lb.	15,800 lb.	4,700 lb.

BAY STAR SPECIFICATIONS

Floor Plan	Engine HP	Axle Ratio	Fuel Cap.	Wheel Base	Front GAWR*	Rear GAWR*	Tag GAWR*	GVWR*	GCWR*	App. UVW	App. NCC
2903	362	5.38	80 gal.	190"	7,500 lb.	13,500 lb.	0	20,500 lb.	26,000 lb.	16,500 lb.	4,000 lb.
3103	362	5.38	80 gal.	200"	7,500 lb.	13,500 lb.	0	20,500 lb.	26,000 lb.	17,100 lb.	3,400 lb.
3124	362	5.38	80 gal.	200"	7,500 lb.	13,500 lb.	0	20,500 lb.	26,000 lb.	17,600 lb.	2,900 lb.
3215	362	5.38	80 gal.	200"	7,500 lb.	13,500 lb.	0	20,500 lb.	26,000 lb.	17,500 lb.	3,000 lb.
3308	362	5.38	80 gal.	208"	7,500 lb.	13,500 lb.	0	20,500 lb.	26,000 lb.	17,800 lb.	2,700 lb.
3309	362	5.38	80 gal.	208"	7,500 lb.	13,500 lb.	0	20,500 lb.	26,000 lb.	17,300 lb.	3,200 lb.

Lengths, heights, widths and dry weights are approximate. Weight will vary based on optional equipment added to the above base weight.

GAWR: Gross Axle Weight Rating is the maximum permissible weight for an axle.

GVWR: Gross Vehicle Weight Rating is the maximum permissible weight for a fully loaded motor coach.

GCWR: Gross Combination Weight Rating is the value specified by the manufacturer of the vehicle as the maximum allowable loaded weight of this motor coach and any towed trailer or towed vehicle.

UVW: Unloaded Vehicle Weight is the weight of this motorcoach as built at the factory with full fuel, engine oil and coolants. The UVW does not include cargo, fresh water, propane gas or dealer-installed accessories.

NCC: Net Carrying Capacity is the maximum weight of all occupants, including the driver, personal belongings, food, fresh water, waste water, propane gas, tools, tongue weight of towed vehicle, dealer installed accessories, etc., that can be carried by the motor coach.

*Specifications supplied by the chassis manufacturer.

Trust.

The strongest possible foundation for a motor coach.

According to Newmar president Matthew Miller, “Customers say they’re loyal to us because they trust us to stand behind our products – from support, parts and service to paying our warranties. It feels good to own a coach that has all of that behind it.”

How do we sustain this high level of service? At Newmar, there’s a Miller way of doing things. These principles guide us every day. Courtesy. Integrity. And reliability. So when you buy from Newmar, you know that every single person who touches your coach or talks with you has your back. Period.



▲ Mahlon Miller, Newmar founder, and Matthew Miller, Newmar president, lifelong motor coach enthusiasts

Our Partners.

Where the finest names in quality and performance are along for the ride.

Newmar strives to offer the best motor coach experience possible, and to that end we partner with the most prestigious names in mobile lifestyle, entertainment, and technology. Depending on the Newmar motor coach you choose, our compliments range from Sony’s comprehensive audio, video, communications and information technology to Freightliner and Spartan’s superior and dependable chassis designs. Newmar only accepts best-in-class performance from the most trusted names in the business. At Newmar, that’s our difference. And our promise.

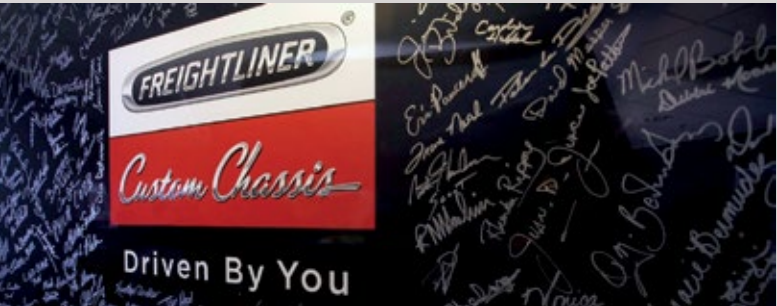

2014 Bay Star & Bay Star Sport

NEWMAR EXPRESS LIMITED WARRANTY

Every Bay Star and Bay Star Sport is backed by Newmar's one-year limited warranty/unlimited miles. Ask your Newmar dealer for details.

LIMITED FIVE-YEAR STRUCTURAL WARRANTY

If any part of your Newmar recreational vehicle superstructure (which is the steel/aluminum structure of the sidewall, roof or frame) fails to perform properly within five years from the date of purchase because of faulty workmanship or material supplied by Newmar, it will be repaired without charge for either parts or labor by Newmar. This structural warranty is available only to the original purchaser and is non-transferable.

Some features in our literature are optional. Colors and finishes are photographic representations. The actual materials may look different. Prices, specifications and floorplans are subject to change at Newmar's discretion, without prior notice or obligation. Please see your dealer for actual samples and specifications.



WHEN YOU KNOW THE DIFFERENCE SM

NEWMAR CORPORATION
355 N DELAWARE ST
PO BOX 30
NAPPANEE IN 46550-0030
574-773-7791 Fax 574-773-2895

www.newmarcorp.com