

ASA
The Mobile Electronics Company
AUDIOVOX SPECIALIZED APPLICATIONS, LLC

GMRS4WM Removal & Re-Installation Instructions

Step 1: Locate and remove the (4) screws from the charging station and carefully remove from the wall.



Step 2: Locate the 2-pin power harness and press the tabs on both sides to disconnect.

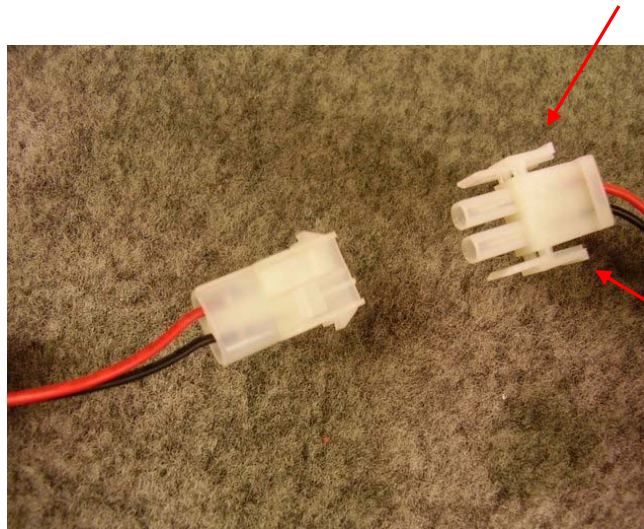

Step 3: After the radios have cooled, open the door and remove all (4) radios.

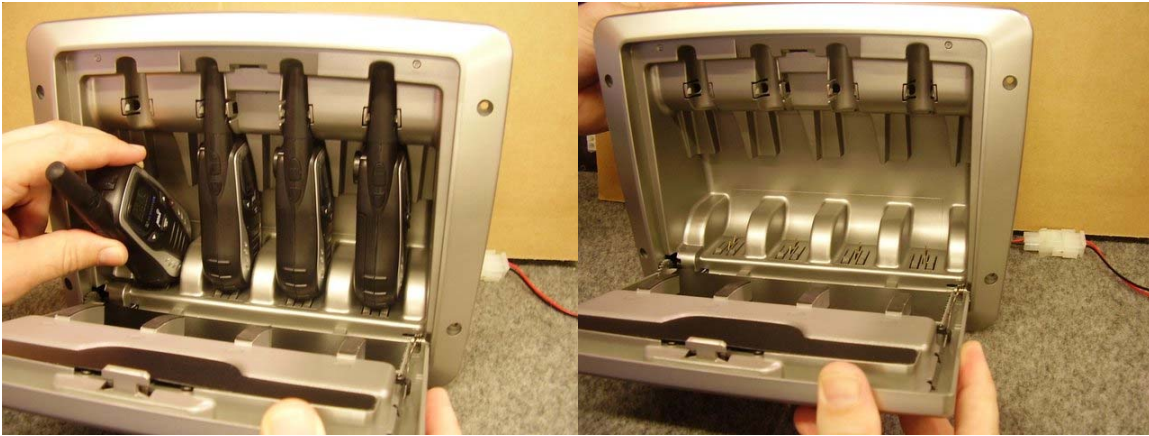

Step 4: To install the new charging station, connect the 2-pin power harness from the charger to the harness connector in the wall cavity.

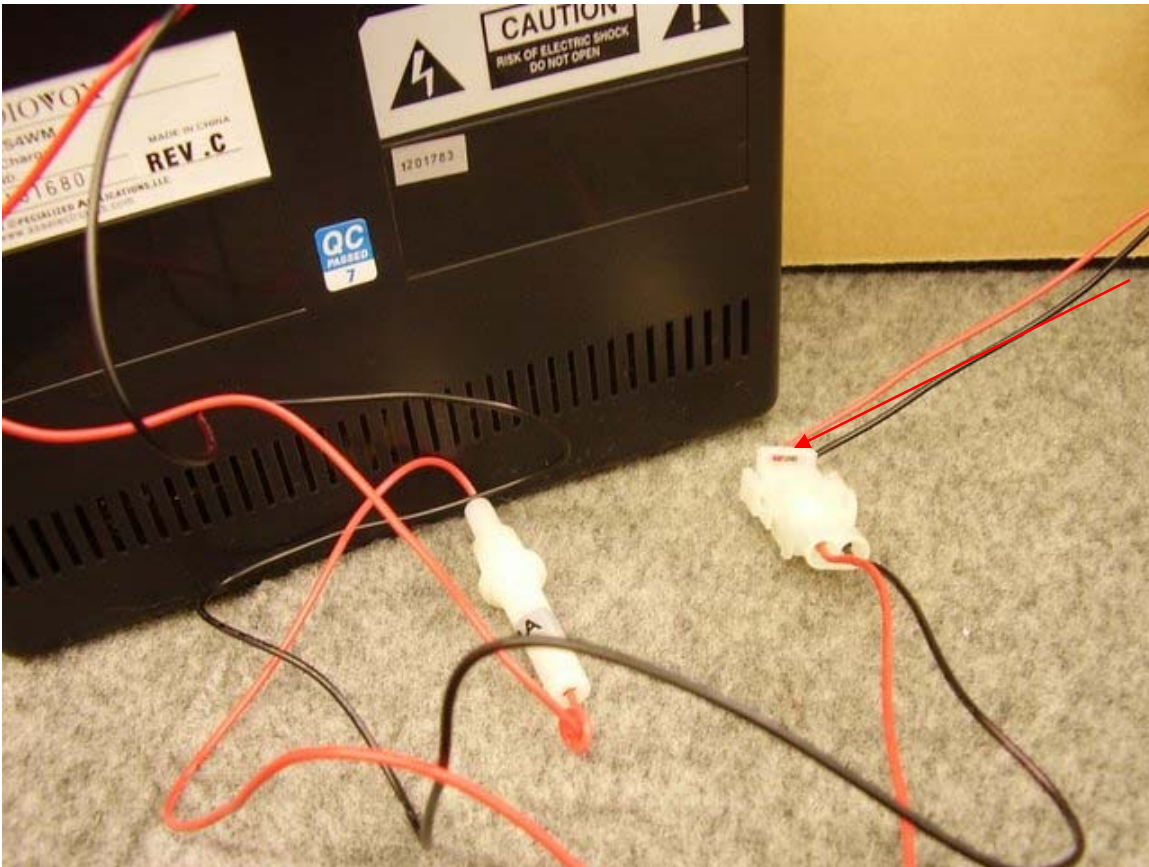

Step 5: Place the charging station and all wiring into the wall cavity, being careful not to pinch any wires. Re-insert all (4) screws to secure the unit to the wall.

