

Model B8100 Create-A-Breeze®

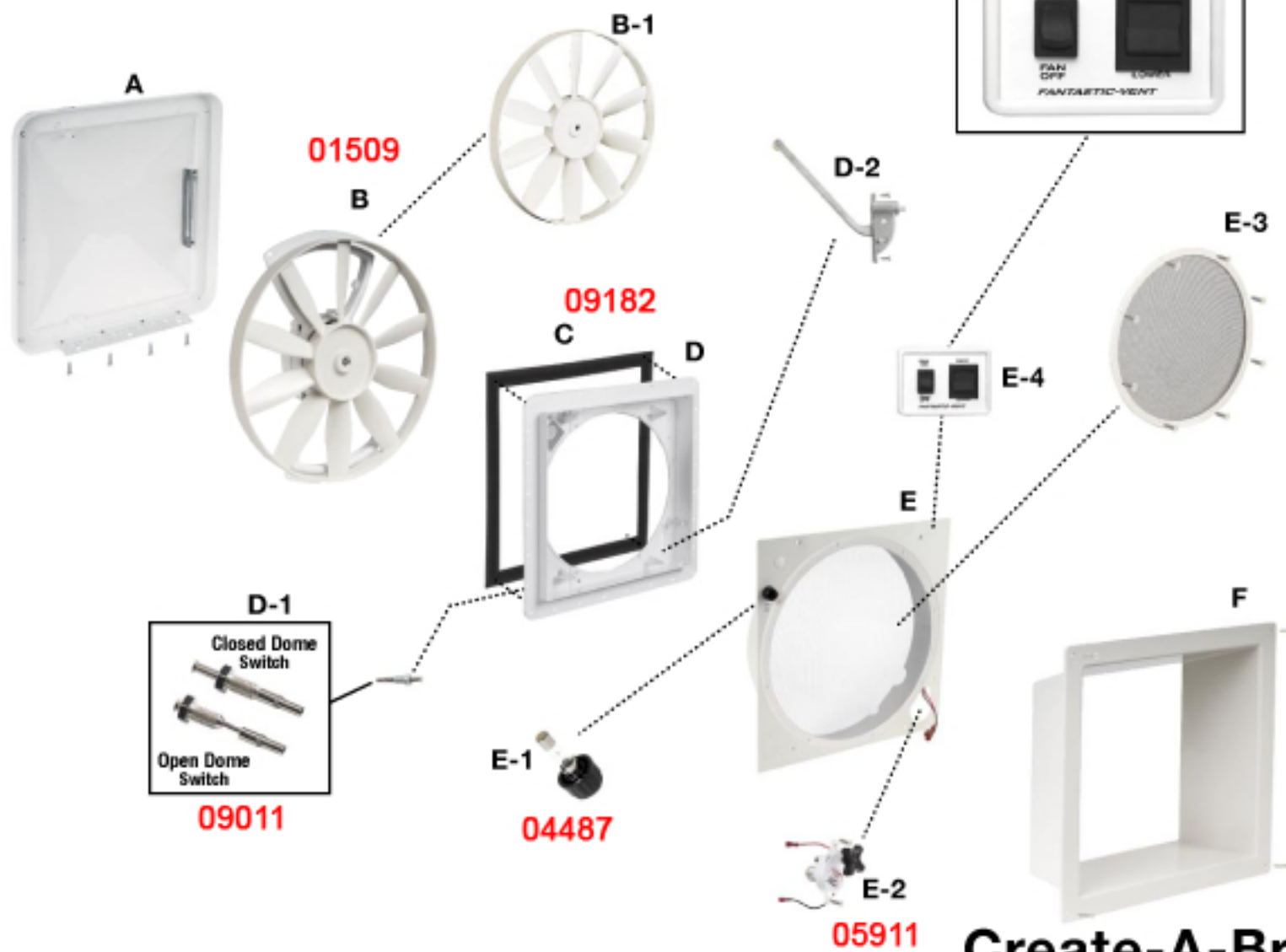

Create-A-Breeze®
by **FAN-TASTIC VENT®**
Model B8100

Model B8100

Create-A-Breeze®

ITEM #	PART #	DESCRIPTION	PRICE
A	K8020-81	Replacement Dome Kit Kit Consists of White (Opaque) ASA Dome, Dome Slide w/ Screws and Hinge w/ Rivets - Attached. Screws for Installation onto Base. (4 - 8 x 1/2" Phillips Pan Head T/S)	\$ 13.80
B	K8017-03 (Pancake Style) K4017-09 (Can Style)	Motor Assembly Kit Kit Consists of 12 Volt DC, Pancake or Can Style Fan Motor (Pancake shown), White Fan Blade (Our Trademark 12" - 10 Blade), White ASA Bowtie Motor Mount. Screws for Installation onto Base. O.E. Wires Shortened w/ Insulated Quick Connects Applied.	\$ 36.98
B-1	8138-81	White (Opaque) ASA Fan Blade (Our Trademark 12" - 10 Blade) "Only," with 3/32" Allen Screw Set, Specify 7 or 8 mm.	\$ 9.92
C	K1144-09	1 - 4 1/2' Length Black EPDM Rubber Seal-Ribbed. 1 - Tube Geocel 1250, (Furnished to Hold Seal to Base).	\$ 6.52
D	K8010-81	High Profile Base Kit Kit Consists of High Profile Main Base (28 Screws), Rubber Dome Seal, Dome Switch (7/16" Nut Microswitch). Screws for Installation onto Coach. (28 - 8 x 1" Phillips Flat Head T/S, White)	\$ 27.38
D-1	1122-05	Dome Switch Only	\$ 3.95
D-2	2011-05	Auto Lift Arm w/ Screws Only	\$ 4.31
E	K8030-81 (B8100-81)	Interior Assembly Kit Interior Screen Assembly, White, Screen Ring w/ Aluminum Screen & Screws, Snap-In Fuse Holder w/ 1/4 Turn Cap & 4 Amp Slow Burn Fuse, 17.1 RPM New AT Lift Motor & Screws, Auto Lift Arm w/ Screws. Completely Prewired w/ Schematic.	\$ 37.50
E-1	K9018-09	Snap-In Fuse Holder with 1/4 Turn Cap & 4 Amp Slow Burn Fuse	\$ 2.92
E-1A	8948-00	4 Amp Slow Burn Fuse Only, Each	\$.19
E-2	K6050-81	17.1 RPM New AT Lift Motor w/ Cap White, Female Connectors and Extension Complete.	\$ 24.00
E-3	K1035-81	Screen Ring White w/ Aluminum Screen & Screws, (8 - 8B x 3/8" Phillips Full Flat Head T/S, White)	\$ 3.99
E-4	K9037-81 (White) K9037-09 (Black)	Wall Controller, Double Switch B2000 or B8100 (White or Black) Horizontal	\$ 8.00
F	K1060-81	6" Interior Garnish White with Screws	\$ 5.90
F-Optional	K2040-81	4 1/2" Interior Garnish White with Screws	\$ 3.70
F-Optional	K1040-81	1 7/8" Interior Garnish White with Screws	\$ 3.16

CREATE-A-BREEZE

by FAN-TASTIC VENT CORPORATION

MODEL B8100, NEW AT (200-0452) LIFT MOTOR, THERMAL PROTECTOR.

EXHAUST ONLY FAN BLADE, BATHROOM VENT, REMOTE UP/DOWN, FAN ON/OFF

FRONT-HINGE SIDE

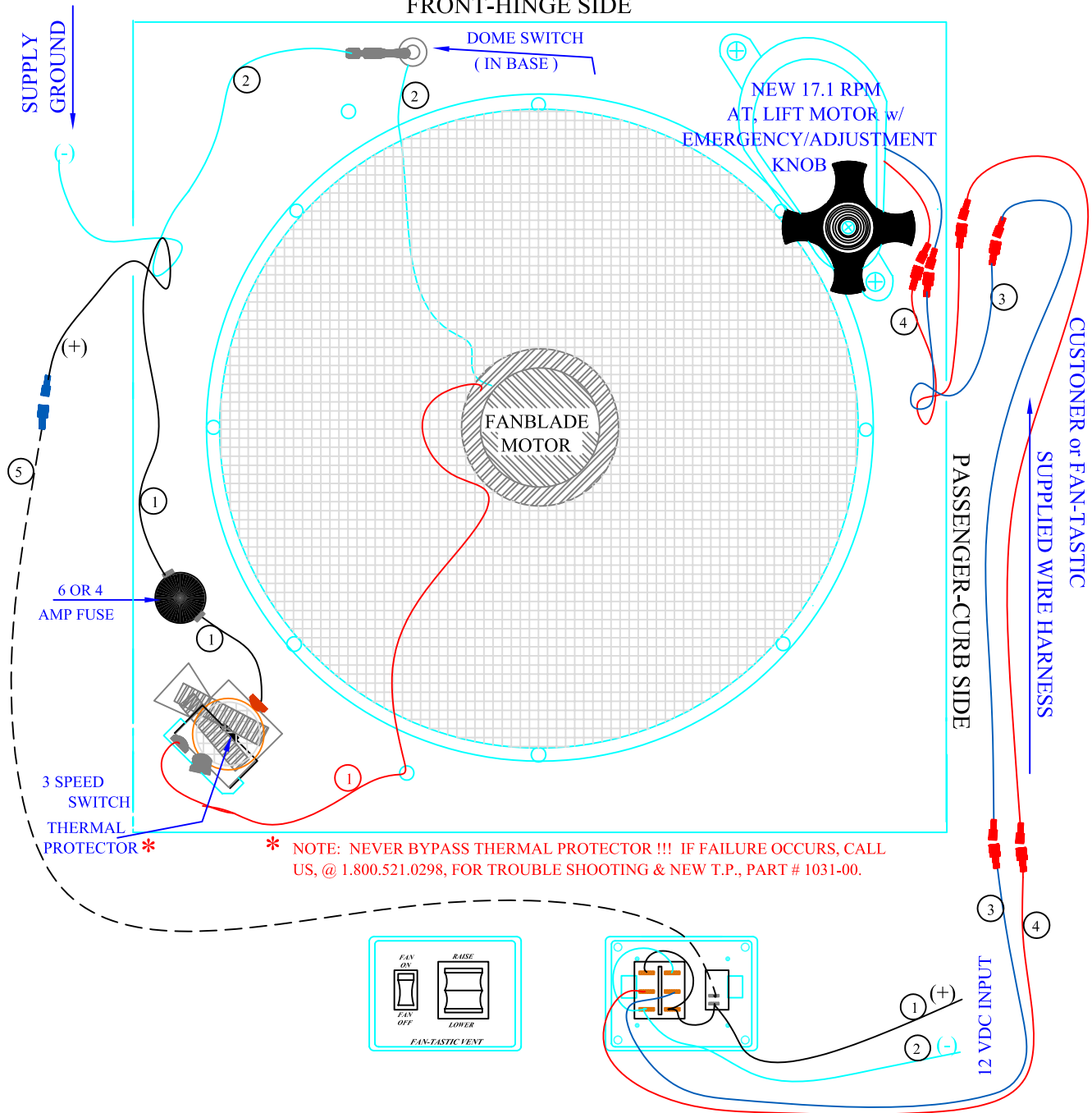

- COLOR KEY;**
- ① — #16 BLACK+POSITIVE SUPPLY+, POSITIVE
 - ② — #16 RED+POSITIVE+, FAN MOTOR
 - ③ — #16 WHITE-SUPPLY GROUND-, GROUND
 - ④ — #18 BLUE WALL CONTROL to NAT LIFT MOTOR
 - ⑤ — #18 RED WALL CONTROL to NAT LIFT MOTOR
 - ⑥ — -- #18 BLACK+POSITIVE+CUSTOMER SUPPLIED LEAD