

# NEWMAR CORPORATION WARRANTY DEPARTMENT

## TECHNICAL SERVICE BULLETIN

DATE ISSUED	MODEL YEAR(S) AFFECTED	TSB #
04/14/2015	2015	TSB 413 Recall 15V-062

### BRAND

Bay Star Sport	<input type="checkbox"/>	Ventana	<input type="checkbox"/>	Essex	<input checked="" type="checkbox"/>
Bay Star	<input type="checkbox"/>	Dutch Star	<input type="checkbox"/>	King Aire	<input type="checkbox"/>
Canyon Star	<input type="checkbox"/>	Mountain Aire	<input type="checkbox"/>	Other	<input type="checkbox"/>
Ventana LE	<input type="checkbox"/>	London Aire	<input type="checkbox"/>		

### DESCRIPTION

Newmar Corporation has decided that a defect which relates to motor vehicle safety exists in certain model year 2015 Essex motor homes equipped with:

Spartan Motors Inc. steering slip shafts used on K3 chassis with IFS2000S2 suspension. The steering column may have inadequate spline engagement at the steering gear. This could lead to wear and potentially result in the steering shaft becoming disconnected or slipping, causing a loss of steering control and increase the risk of a crash causing injury and/or damage to property.

**30 motorhomes built between 3/11/2014 and 11/13/2014.**

**These motor homes require immediate service. Continued use poses a potential safety hazard.**

### RECOMMENDED ACTION

#### DEALER CAMPAIGN RESPONSIBILITY

*Dealers are to provide to all customers/owner vehicles the service of completing this campaign at no charge to the customer/owner regardless of vehicle age, vehicle mileage, or ownership at the time of repair.*

#### REPAIR PROCEDURE

Please reference Spartan Motors Inc. work instructions enclosed. **RSB15-260-001**

**If you should have any questions please contact the Newmar service department at: 1-866-290-5371.**

NHTSA # 15V-062  
CAN Recall # 2015-012

Labor Time : 1.0 hrs  
Flat Rate code : 15V-062

**Please read this bulletin in its entirety prior to beginning any diagnosis or repairs**



# Spartan Motors Chassis, Inc.

## SERVICE BULLETIN

RSB15-260-001

NHTSA Id: 14V-829

1/29/2015

**SUBJECT:** Steering slip shaft

**CONDITION:** Steering slip shaft may be over extended

**APPLIES TO:** This bulletin applies to certain K3 model motor home chassis manufactured between November 22, 2013 and October 28, 2014.

**CORRECTION:** Replace steering slip shaft

**LABOR ALLOCATION:** 1.0 hrs.

**PARTS NEEDED:**

	<u>QTY</u>	<u>Part Number</u>	<u>Description</u>
	1	S-2468-001	Kit-Service, TOC Steering Slip Shaft

**Kit # S-2468-001 Contains:**

	<u>QTY</u>	<u>Part Number</u>	<u>Description</u>
	1	1902-KK1-001	Shaft, Steering Column TRW 418167
	1	07140200H8Z	Bolt 7/16-14X2.00 HEX GR8 ZN
	1	0714LNZ	Nut Lock 7/16-14 Zinc
	1	M10150LN7Z	Nut M10X1.5 10.9 Lock
	1	M10150050H7Z	Bolt M10 1.50X50 Hex 10.9 ZN
	1	S-2471	INSTL-Steering Slip Shaft
	1	RSB15-260-001	Instruction Document

**GENERAL INSTRUCTIONS:**

Please thoroughly review entire work procedure before starting work. If there are questions and/or concerns with steps defined in this procedure, contact Spartan Motors Chassis, Inc. Customer & Product Support Group.

All applicable industry safety standards must be followed when performing work identified in this procedure.



**STEP-BY-STEP INSTRUCTIONS:**

1. Secure vehicle for replacing slip shaft.
2. Center and secure the steering wheel prior to removing the steering slip shaft.

**CAUTION**

This unit is equipped with a clock spring in the steering wheel that can be damaged if the steering wheel is rotated without the slip shaft attached. Failure to follow this step may result in damage to the clock spring.

3. To gain access to the pinch bolt at the top of the slip shaft (circled in green), remove the screws holding the steering column cover (circled in red) and shift cover out of the way. Retain screws for reuse. Refer to FIG. 2-1 & 2-2.

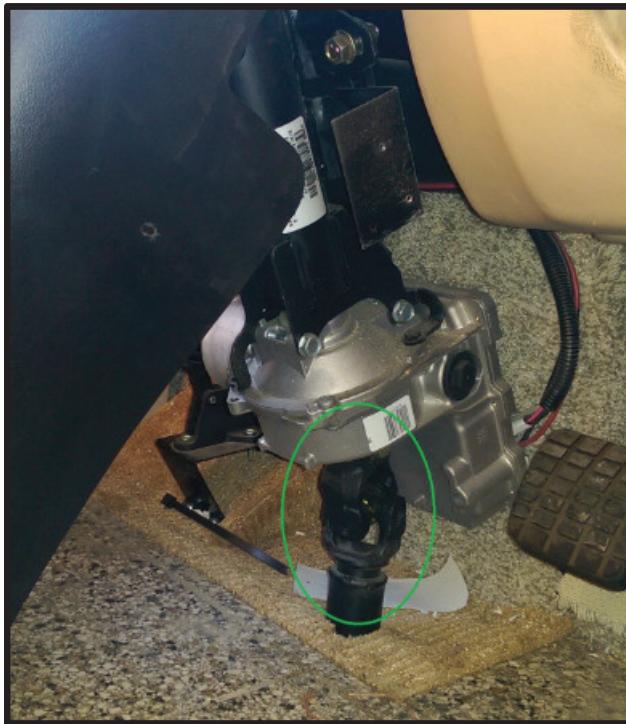

**FIG. 2-1**

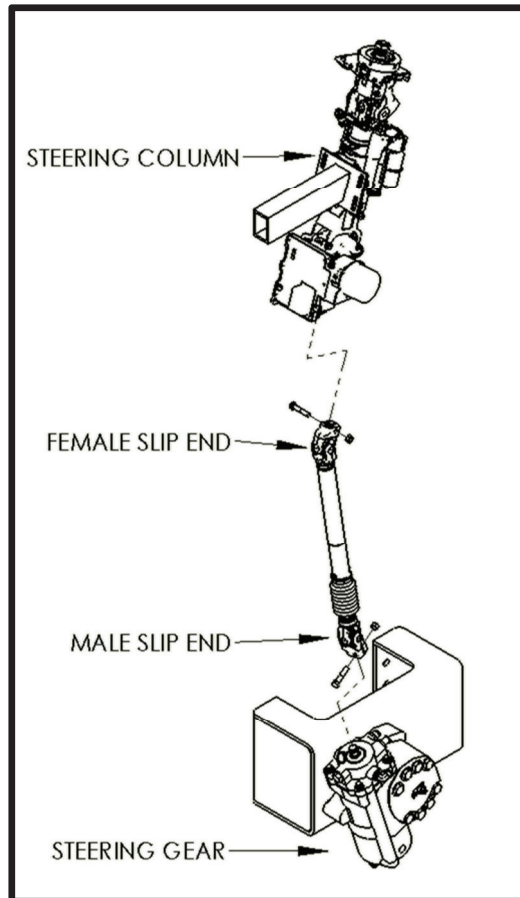

**FIG. 2-2**



4. Remove M10 pinch bolt at steering column end of steering slip shaft. Properly dispose of hardware. Refer to FIG. 3-1.

**FIG. 3-1**



5. Remove 7/16" pinch bolt at gear box end of the steering slip shaft. Properly dispose of hardware.
6. Remove steering slip shaft and return to Spartan Motors Chassis, Inc. using the return material authorization process.
7. Install new slip shaft in reverse order using new hardware. Refer to installation drawing for fastener torque values.
8. Reattach steering column cover.

VIN Number	Prod#	Year	Brand	Type	Floor Plan	Date In Production	Date Off Production
4VZAU1E94EC077979	801061	2014	EX	DP	4544	10/3/2013	10/14/2013
4VZAU1E99EC077363	801039	2014	EX	DP	4553	5/22/2013	6/3/2013
4VZAU1E90EC077896	801054	2014	EX	DP	4544	9/5/2013	9/16/2013
4VZAU1E98EC077502	801045	2014	EX	DP	4554	7/15/2013	7/23/2013
4VZAU1E94EC077402	801041	2014	EX	DP	4553	6/18/2013	6/25/2013
4VZAU1E94EC077965	801056	2014	EX	DP	4544	9/12/2013	9/20/2013
4VZAU1E92EC077978	801067	2014	EX	DP	4553	10/10/2013	10/18/2013
4VZAU1E94EC077450	801040	2014	EX	DP	4553	6/25/2013	7/11/2013
4VZAU1E97EC077703	801049	2014	EX	DP	4553	8/26/2013	9/4/2013
4VZVU1E9XEC077907	530210	2014	KG	DB	4593	9/10/2013	9/19/2013
4VZVU1E9XEC077504	530209	2014	KG	DB	4584	9/3/2013	9/12/2013
4VZVU1E99EC077316	530196	2014	KG	DB	4593	4/18/2013	4/26/2013
4VZVU1E90EC077317	530197	2014	KG	DB	4584	4/12/2013	4/22/2013
4VZVU1E94EC077403	530201	2014	KG	DB	4593	7/17/2013	7/25/2013
4VZVU1E99EC077980	530212	2014	KG	DB	4593	9/26/2013	10/7/2013
4VZVU1E90EC077981	530213	2014	KG	DB	4593	9/30/2013	10/8/2013
4VZVU1E91EC077455	530206	2014	KG	DB	4584	8/6/2013	8/14/2013
4VZVU1E96EC077404	530208	2014	KG	DB	4593	8/22/2013	8/30/2013
4VZVU1E90EC077365	530203	2014	KG	DB	4593	7/9/2013	7/17/2013
4VZVU1E90EC077964	530222	2014	KG	DB	4584	9/24/2013	10/2/2013
4VZVU1E99EC077364	530202	2014	KG	DB	4584	6/5/2013	6/14/2013
4VZVU1E91EC077357	530198	2014	KG	DB	4593	4/23/2013	5/1/2013
4VZVU1E91DC077292	530199	2013	KG	DB	4584	5/7/2013	5/17/2013
4VZVU1E94EC077451	530200	2014	KG	DB	4593	7/29/2013	8/6/2013

#### Canadian Units

VIN Number	Prod#	Year	Brand	Type	Floor Plan	Date In Production	Date Off Production
4VZVU1E90EC077897	530211	2014	KG	DB	4593	9/18/2013	9/26/2013
4VZVU1E93EC077456	530207	2014	KG	DB	4593	8/14/2013	8/22/2013
4VZVU1E96DC077255	530180	2013	KG	DB	4588	5/6/2013	5/15/2013
4VZVU1E96EC077452	530205	2014	KG	DB	4593	8/12/2013	8/20/2013
4VZVU1E98EC077503	530204	2014	KG	DB	4593	7/24/2013	8/1/2013