

| ITEM # | QTY | NEWMAR # | DESCRIPTION |
|--------|-----|----------|--|
| 1 | 1 | 115215 | 27x16 STAINLESS STEEL (1317SSD2717) |
| 2 | 1 | 115816 | 3 BURNER COOKTOP |

PLEASE ACKNOWLEDGE AND DATE THE FOLLOWING ORDER/PRINT FOR APPROVAL TO BUILD, AND FAX TO NEWMAR (AT 574-773-2895) AS SOON AS POSSIBLE
 DATE: _____
 SIGN: _____

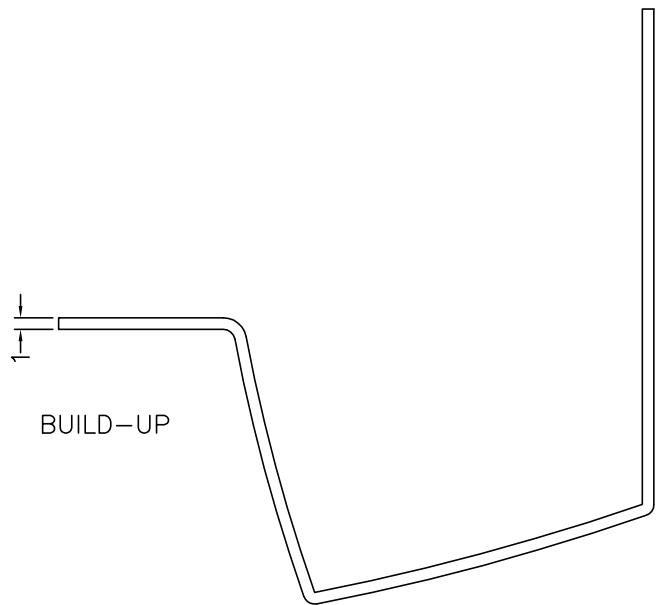
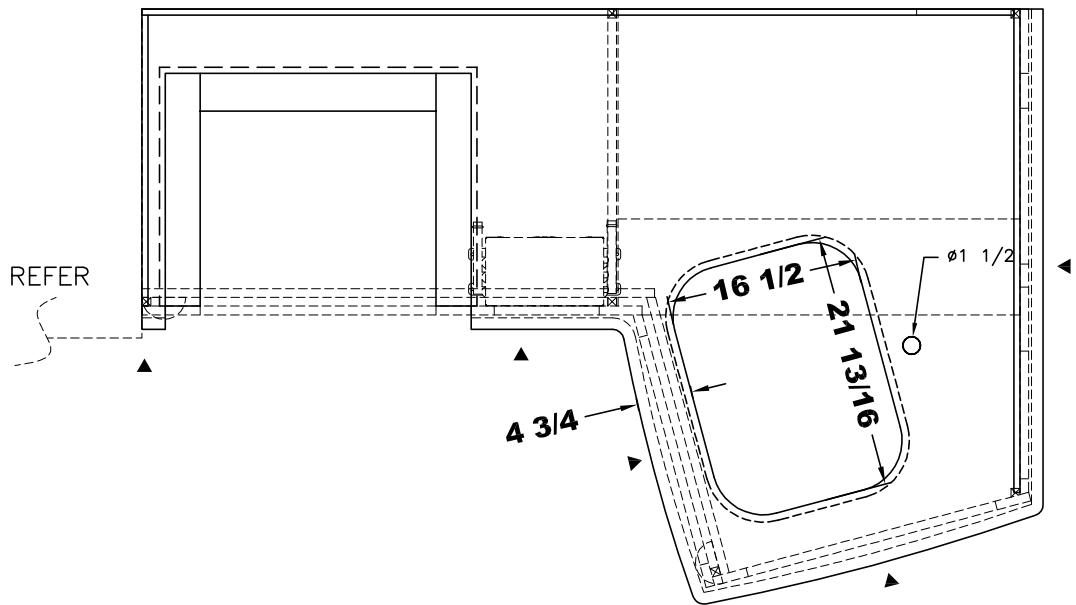

1/2" MATERIAL
SEE TYPICAL PRINT FOR COUNTER TOP APPLICATION

UNIT: # 412564
 DEALER: Tom Lindstrom RV
 SPECIAL: # 1362

| | | | | | | |
|---|-------------------------------|---|--------------------|----------------------|-----------|-------|
| NEWMAR CORP P.O. Box 30, Nappanee, IN. 46550 | Model: VT DP 3436 | Sheet 1 OF 1 | Drawn by: Z. R. | Checked by: A. M. | Revision: | By: |
| | Title: 76 1/8 KIT S-O BASE | I.D. # 2016\ SPECIALS\MOT\ 1362KT | Date: 3/1/16 | Date: 3/2/16 | Revision: | Date: |
| UNITS: INCHES | | | | | | By: |
| TITLE BLOCK--75TB | | | | | | Date: |