

2017 DS DP BACKSPLASH TILE

PLEASE ACKNOWLEDGE AND DATE THE FOLLOWING ORDER/PRINT FOR APPROVAL TO BUILD, AND FAX TO NEWMAR (AT 574-773-2895) AS SOON AS POSSIBLE
DATE: _____
SIGN: _____

SOLID DENOTES 3/8" RECESS FOR TILE INLAY

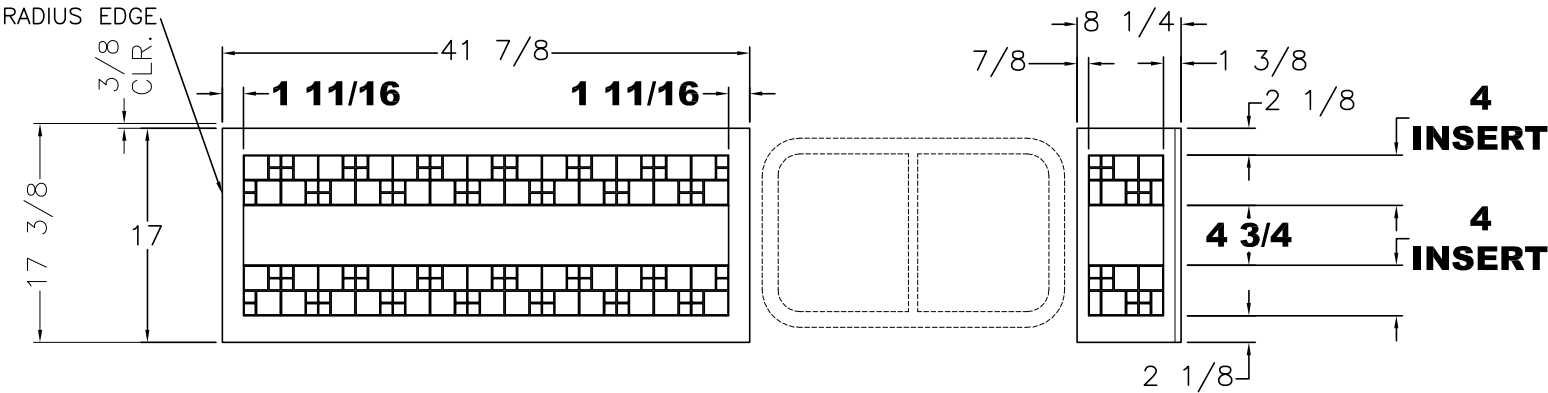

SPLASH-A

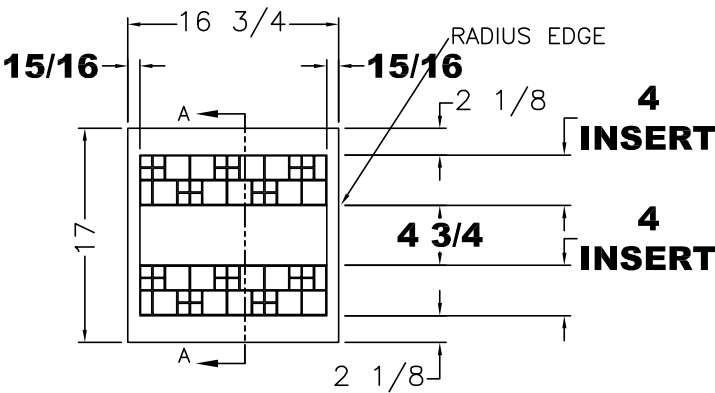

SPLASH-B

UNIT: # 412922
DEALER: Guaranty RV
SPECIAL: # 735

<div>NEWMAR CORP</div> <div>P.O. Box 30,</div> <div>Nappanee, IN. 46550</div> <div>UNITS: INCHES</div> <div>TITLE BLOCK: 75TB</div>	Model:	(T360)	Sheet	Drawn by:	Checked by:	Revision:	By:
		VT DP 3709	1 OF 1	Z. R.	A. M.		Date:
	Title:	I.D. # 2017\	Date:	Date:	Revision:		By:
		76 7/8 KITCHEN CABINETS	8/22/16	8/23/16			Date:

2017 DS DP BACKSPLASH TILE

PLEASE ACKNOWLEDGE AND DATE THE
FOLLOWING ORDER/PRINT FOR APPROVAL
TO BUILD, AND FAX TO NEWMAR (AT
574-773-2895) AS SOON AS POSSIBLE
DATE: _____
SIGN: _____

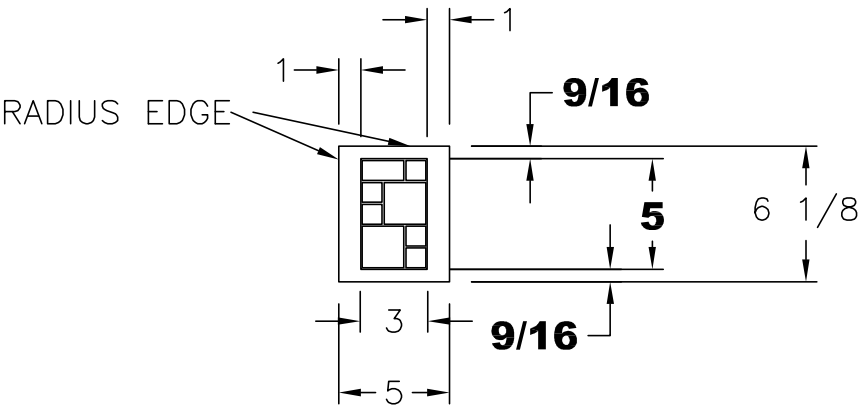

VIEW A

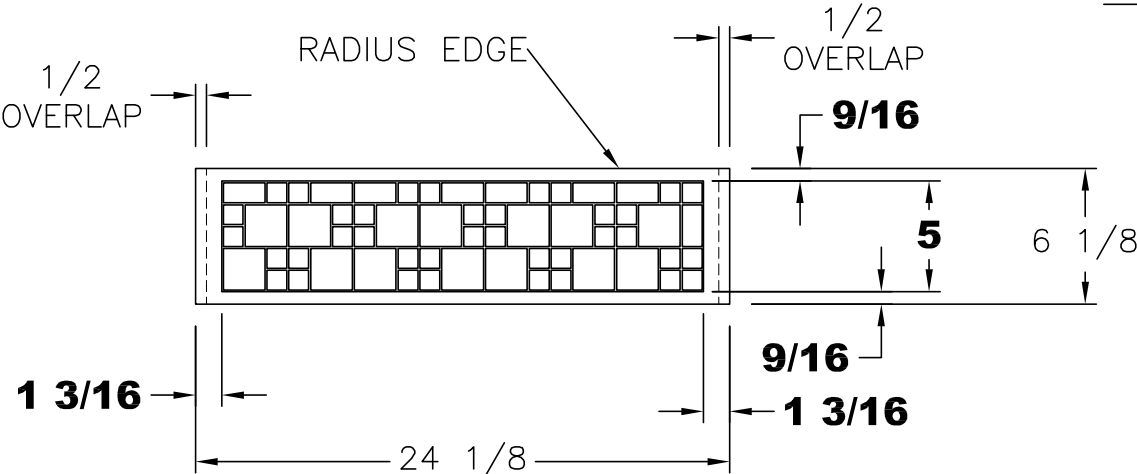

VIEW B

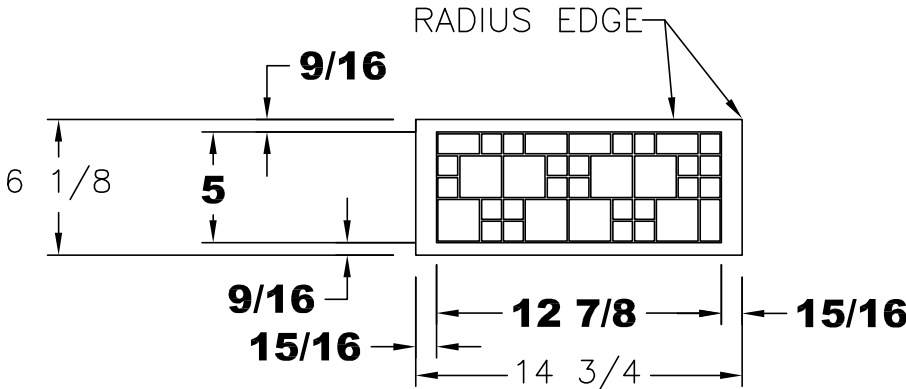

VIEW C

UNIT: # 412922
DEALER: Guaranty RV
SPECIAL: # 735

CORIAN BACKSPLASH
SOLID DENOTES 3/8"
RECESS FOR TILE INLAY

NEWMAR CORP <i>P.O. Box 30, Nappanee, IN. 46550</i>	Model:	Sheet	Drawn by:	Checked by:	Revision:	By:
	VT DP 3709	1 OF 1	Z. R.	A. M.		Date:
	Title:	I.D. # 2017\	Date:	Date:	Revision:	By:
	24 1/8 LAV BASE & TOP	SPECIALS\MOT\735LV	8/22/16	8/23/16		Date:

2017 DS DP BACKSPLASH TILE

PLEASE ACKNOWLEDGE AND DATE THE FOLLOWING ORDER/PRINT FOR APPROVAL TO BUILD, AND FAX TO NEWMAR (AT 574-773-2895) AS SOON AS POSSIBLE
DATE:_____
SIGN:_____

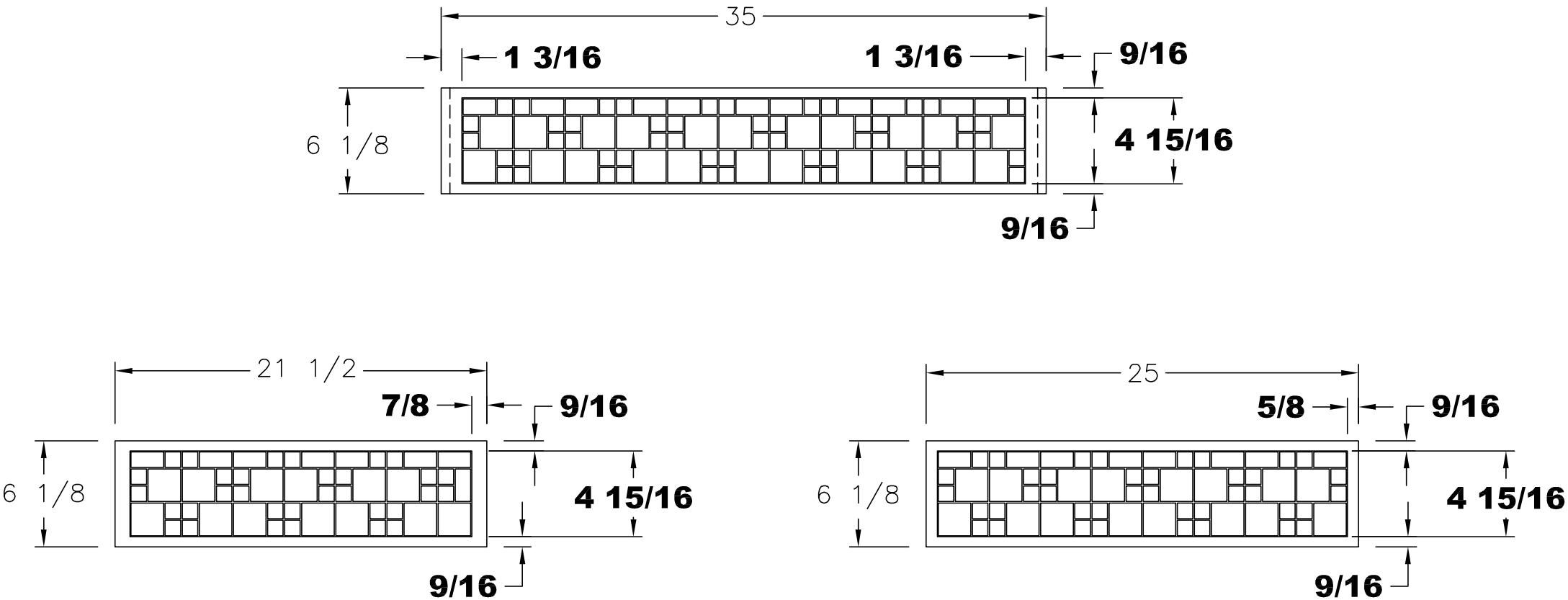

BATH SPLASH
SOLID DENOTES 3/8"
RECESS FOR TILE INLAY

UNIT: # 412922
DEALER: Guaranty RV
SPECIAL: # 735

<div>NEWMAR CORP</div> <div>P.O. Box 30,</div> <div>Nappanee, IN. 46550</div> <div>UNITS: INCHES</div> <div>TITLE BLOCK: 1TB</div>	Model:	Sheet	Drawn by:	Checked by:	Revision:	By:
	VT DP 3709	1 OF 1	Z. R.	A. M.		Date:
	Title:	I.D. # 2017\	Date:	Date:	Revision:	By:
	35 3/4 LAV BASE & TOP	SPECIALS\MOT\735LV1	8/22/16	8/23/16		Date:

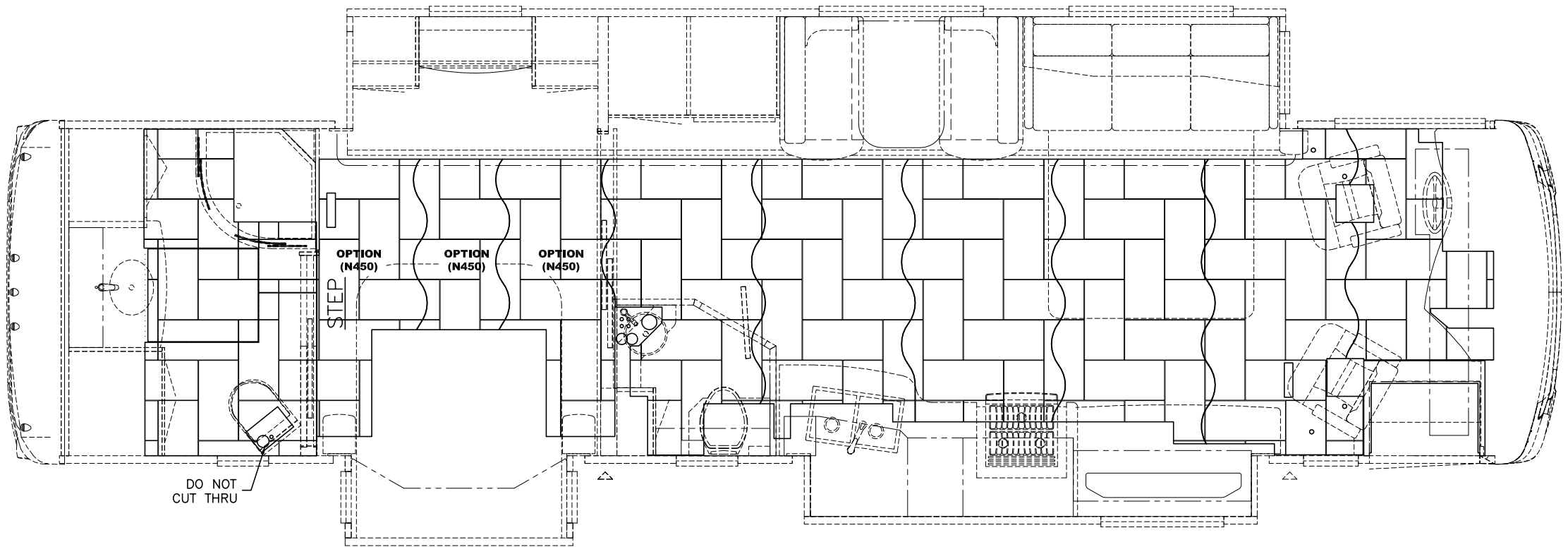

2017 LA DP TILE 11 9/16 x 23 3/8

PLEASE ACKNOWLEDGE AND DATE THE
FOLLOWING ORDER/PRINT FOR APPROVAL
TO BUILD, AND FAX TO NEWMAR (AT
574-773-2895) AS SOON AS POSSIBLE
DATE: _____
SIGN: _____

UNIT: # 412922
DEALER: Guaranty RV
SPECIAL: # 735

NEWMAR CORP <i>P.O. Box 30, Nappanee, IN. 46550</i>	Model:	(N450)	Sheet	Drawn by:	Checked by:	Revision:	By:
	VT DP 3709		1 OF 1	Z. R.	A. M.		Date:
	Title:		I.D. # 2017\	Date:	Date:	Revision:	By:
	FULL TILE LAYOUT		SPECIALS\MOT\	8/22/16	8/23/16		Date:
	UNITS: INCHES		735TILE				
	TITLE BLOCK: 3125TB						