

FABRIC LETTER	DECOR' NUMBER	DESCRIPTION
FABRIC "D"	VT18-330 "D"	WAGATI-FROST
FABRIC "E"	VT18-330 "E"	SANTANA 300-PEARL
FABRIC "F"	VT18-330 "F"	SANTANA 500-PEARL
FRINGE	VT18-330 "FRINGE"	FRB06566-01-A MILKYWAY
CORD	VT18-330 "CORD"	CD06566-01-A MILKYWAY

MAIN FABRIC – 

ACCENT FABRIC – 

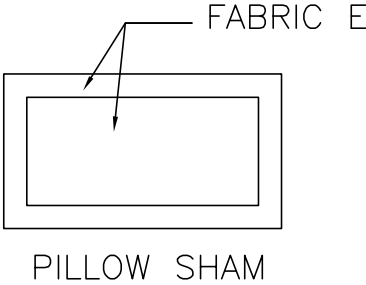

PLEASE ACKNOWLEDGE AND DATE THE FOLLOWING ORDER/PRINT FOR APPROVAL TO BUILD, AND FAX TO NEWMAR (AT 574-773-2895) AS SOON AS POSSIBLE  
DATE: \_\_\_\_\_  
SIGN: \_\_\_\_\_

UNIT: # 413521  
DEALER: Midway RV  
SPECIAL: # 459

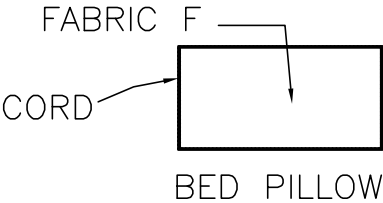
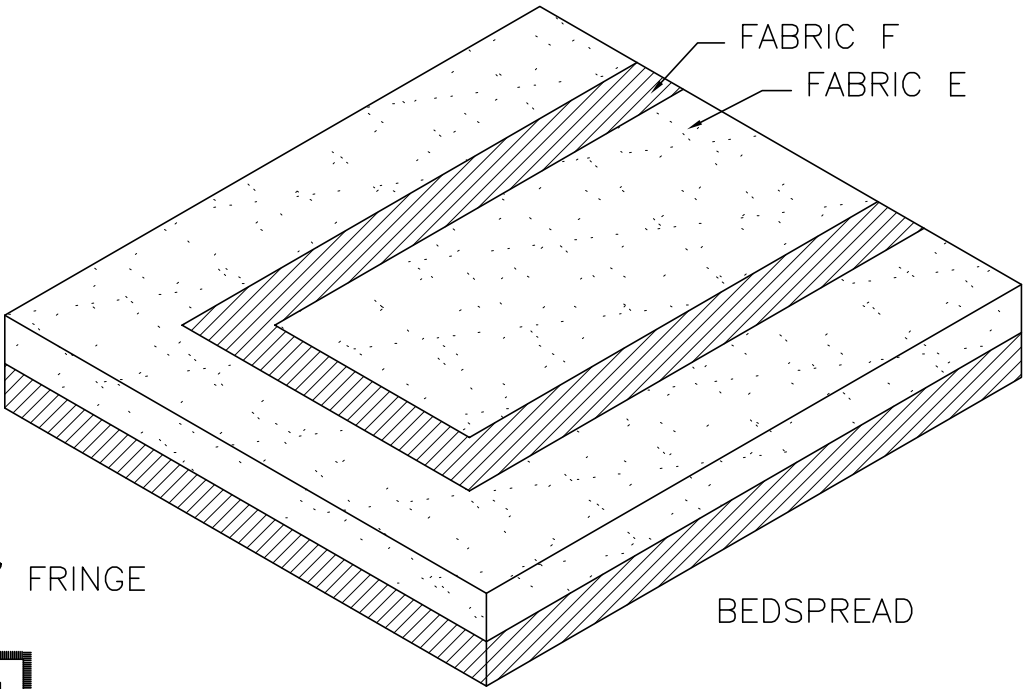
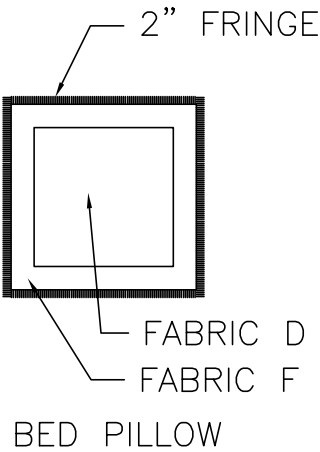

NOTE: GENERAL VISUAL REPRESENTATION OF INTERIOR COMPONENTS. NOT FOR DIMENSIONAL USE.

<b>NEWMAR CORP</b> P.O. Box 30, Nappanee, IN. 46550 UNITS: INCHES TITLE BLOCK: 1-5TB	Model:	Sheet	Drawn by:	Checked by:	Revision:	By:
	VT DP 3412	1 OF 1	Z. R.	A. M.		Date:
	Title: FABRIC CALL OUTS	I.D. # 2018\	Date:	Date:	Revision:	By:
	BEDROOM	SPECIALS\MOT\459FAB	6/22/17	6/22/17		Date:

FABRIC LETTER	DECOR' NUMBER	DESCRIPTION
FABRIC "C"	VT18-330 "C"	TRUBRIDGE-SISAL

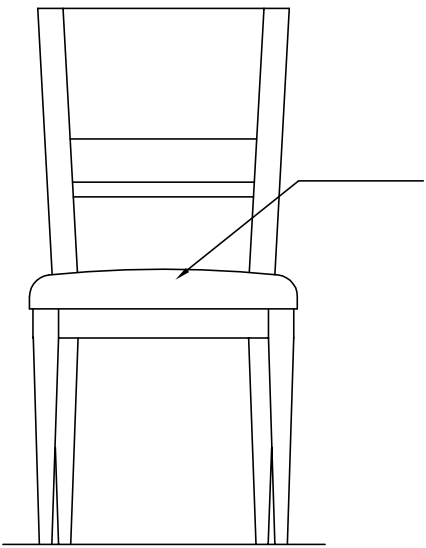

FABRIC C

DINETTE CHAIR

PLEASE ACKNOWLEDGE AND DATE THE FOLLOWING ORDER/PRINT FOR APPROVAL TO BUILD, AND FAX TO NEWMAR (AT 574-773-2895) AS SOON AS POSSIBLE  
 DATE: \_\_\_\_\_  
 SIGN: \_\_\_\_\_

UNIT: # 413521  
 DEALER: Midway RV  
 SPECIAL: # 459

NOTE: GENERAL VISUAL REPRESENTATION OF INTERIOR COMPONENTS. NOT FOR DIMENSIONAL USE.

<b>NEWMAR CORP</b> P.O. Box 30, Nappanee, IN. 46550  UNITS: INCHES TITLE BLOCK: 1-5TB	Model:	Sheet	Drawn by:	Checked by:	Revision:	By:
	VT DP 3412	1 OF 1	Z. R.	A. M.		Date:
	Title: FABRIC CALL OUTS	I.D. # 2018\	Date:	Date:	Revision:	By:
	DINETTE CHAIR	SPECIALS\MOT\459FAB	6/22/17	6/22/17		Date:

FABRIC LETTER	DECOR' NUMBER	DESCRIPTION
FABRIC "A"	<b>VT18-330 "B"</b>	STRADA 703-32382 CACHET CREAM
FABRIC "B"	VT18-330 "B"	STRADA 703-32382 CACHET CREAM

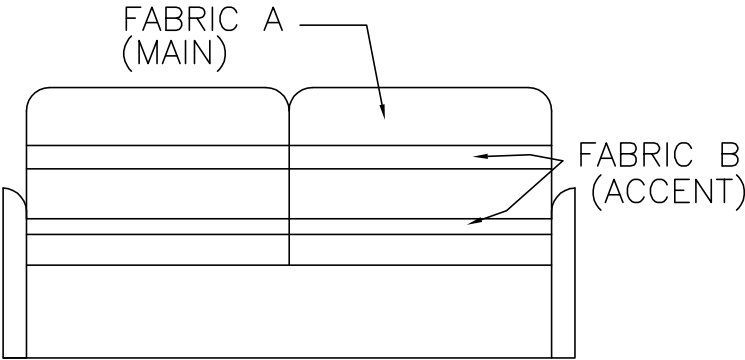

SOFA/FURNITURE

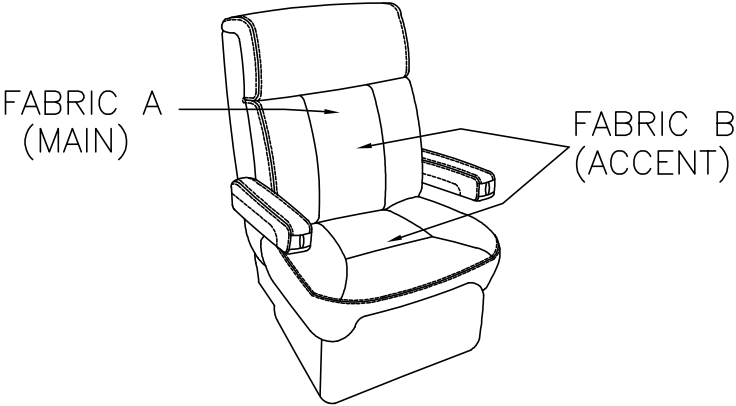

DRIVER/PASSENGER

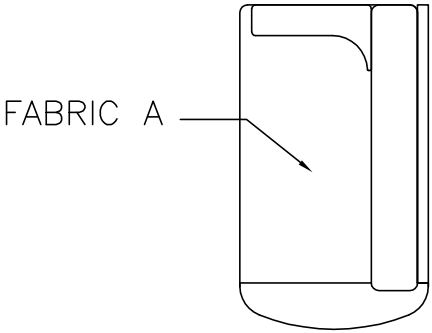

DINETTE

PLEASE ACKNOWLEDGE AND DATE THE FOLLOWING ORDER/PRINT FOR APPROVAL TO BUILD, AND FAX TO NEWMAR (AT 574-773-2895) AS SOON AS POSSIBLE

DATE: \_\_\_\_\_

SIGN: \_\_\_\_\_

UNIT: # 413521

DEALER: Midway RV

SPECIAL: # 459

NOTE: GENERAL VISUAL REPRESENTATION OF INTERIOR COMPONENTS. NOT FOR DIMENSIONAL USE.

<b>NEWMAR CORP</b> P.O. Box 30, Nappanee, IN. 46550	Model:	Sheet	Drawn by:	Checked by:	Revision:	By:
	VT DP 3412	1 OF 1	Z. R.	A. M.		Date:
	Title: FABRIC CALL OUTS	I.D. # 2018\	Date:	Date:	Revision:	By:
	FURNITURE	SPECIALS\MOT\459FAB	6/22/17	6/22/17		Date:

<i>FABRIC LETTER</i>	<i>DECOR' NUMBER</i>	<i>DESCRIPTION</i>
<i>FABRIC "H"</i>	<i>VT18-330 "H"</i>	<i>R-TUMBLER-MINERAL</i>

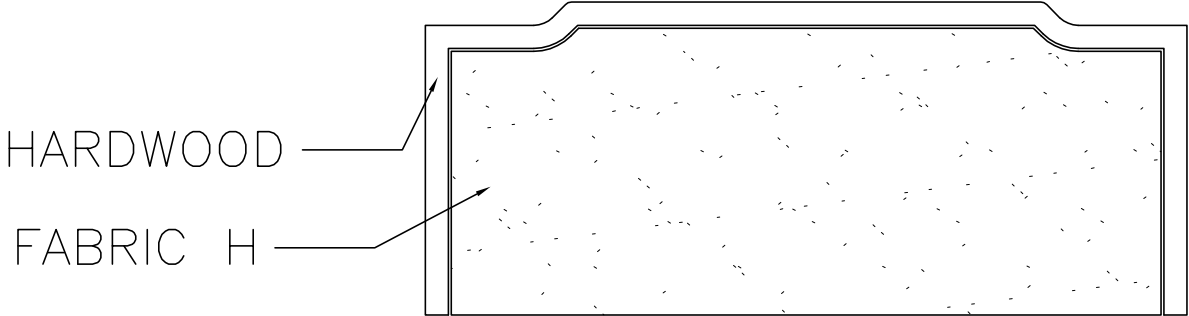

HEADBOARD

PLEASE ACKNOWLEDGE AND DATE THE FOLLOWING ORDER/PRINT FOR APPROVAL TO BUILD, AND FAX TO NEWMAR (AT 574-773-2895) AS SOON AS POSSIBLE  
DATE: \_\_\_\_\_  
SIGN: \_\_\_\_\_

UNIT: # 413521  
DEALER: Midway RV  
SPECIAL: # 459

NOTE: GENERAL VISUAL REPRESENTATION OF INTERIOR COMPONENTS. NOT FOR DIMENSIONAL USE.

<b>NEWMAR CORP</b> P.O. Box 30, Nappanee, IN. 46550	Model:	Sheet	Drawn by:	Checked by:	Revision:	By:
	VT DP 3412	1 OF 1	Z. R.	A. M.		Date:
	Title: FABRIC CALL OUTS	I.D. # 2018\	Date:	Date:	Revision:	By:
	HEADBOARD	SPECIALS\MOT\459FAB	6/22/17	6/22/17		Date:

<i>FABRIC LETTER</i>	<i>DECOR' NUMBER</i>	<i>DESCRIPTION</i>
<i>FABRIC "C"</i>	<i>VT18-330 "C"</i>	<i>TRUBRIDGE-SISAL</i>
<i>FRINGE</i>	<i>VT18-330 "FRINGE"</i>	<i>FRB06566-01-A MILKYWAY</i>

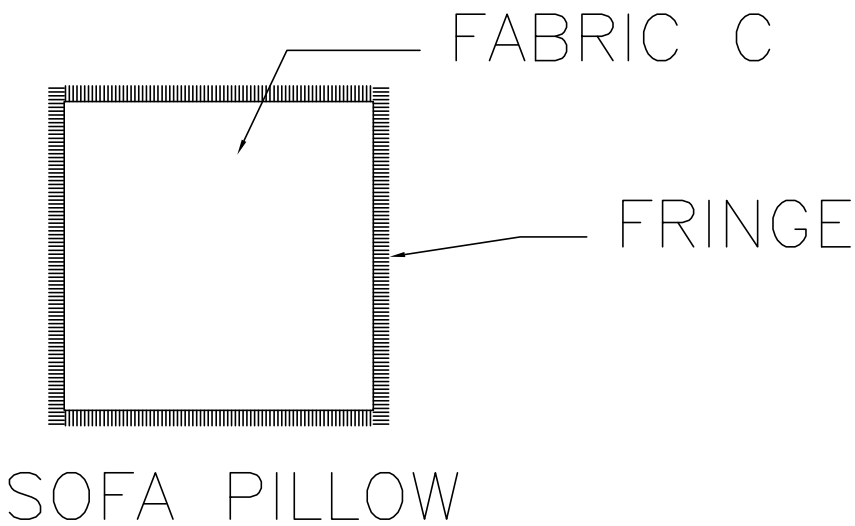

PLEASE ACKNOWLEDGE AND DATE THE FOLLOWING ORDER/PRINT FOR APPROVAL TO BUILD, AND FAX TO NEWMAR (AT 574-773-2895) AS SOON AS POSSIBLE  
 DATE: \_\_\_\_\_  
 SIGN: \_\_\_\_\_

UNIT: # 413521  
 DEALER: Midway RV  
 SPECIAL: # 459

NOTE: GENERAL VISUAL REPRESENTATION OF INTERIOR COMPONENTS. NOT FOR DIMENSIONAL USE.

<b>NEWMAR CORP</b> P.O. Box 30, Nappanee, IN. 46550	Model:	Sheet	Drawn by:	Checked by:	Revision:	By:
	VT DP 3412	1 OF 1	Z. R.	A. M.		Date:
	Title: FABRIC CALL OUTS	I.D. # 2018\	Date:	Date:	Revision:	By:
	SOFA PILLOW	SPECIALS\MOT\459FAB	6/22/17	6/22/17		Date:

FABRIC LETTER	DECOR' NUMBER	DESCRIPTION
FABRIC "D"	VT18-330 "D"	WAGATI-FROST
FABRIC "G"	VT18-330 "G"	HARPER/B-BEIGE

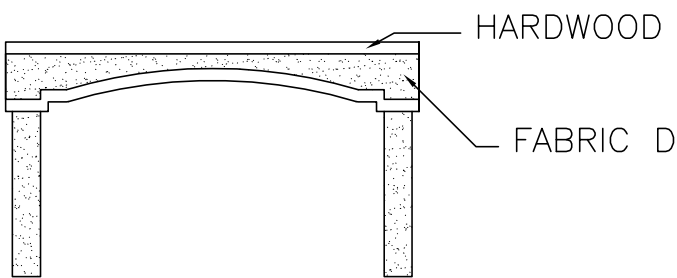

LIVINGROOM/KITCHEN

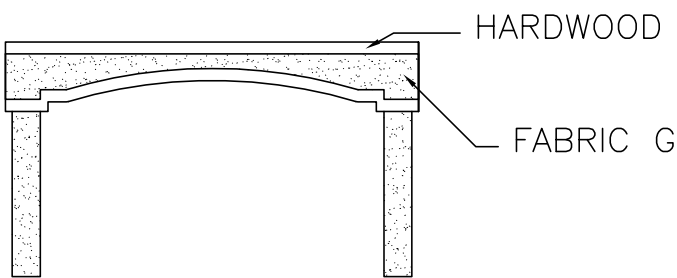

BEDROOM/BATHROOM

CORD USED ON WINDOW TREATMENT

PLEASE ACKNOWLEDGE AND DATE THE FOLLOWING ORDER/PRINT FOR APPROVAL TO BUILD, AND FAX TO NEWMAR (AT 574-773-2895) AS SOON AS POSSIBLE  
 DATE: \_\_\_\_\_  
 SIGN: \_\_\_\_\_

MAIN FABRIC — 

ACCENT FABRIC — 

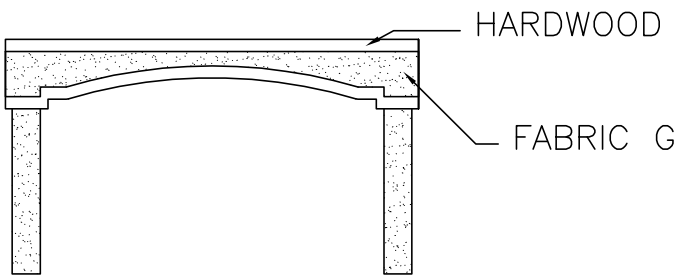

1/2 BATH

UNIT: # 413521  
 DEALER: Midway RV  
 SPECIAL: # 459

NOTE: GENERAL VISUAL REPRESENTATION OF INTERIOR COMPONENTS. NOT FOR DIMENSIONAL USE.

<b>NEWMAR CORP</b> P.O. Box 30, Nappanee, IN. 46550 UNITS: INCHES TITLE BLOCK: 1-5TB	Model:	Sheet	Drawn by:	Checked by:	Revision:	By:
	VT DP 3412	1 OF 1	Z. R.	A. M.		Date:
	Title: FABRIC CALL OUTS	I.D. # 2018\	Date:	Date:	Revision:	By:
	WINDOW TREATMENTS	SPECIALS\MOT\459FAB	6/22/17	6/22/17		Date:

ITEM #	QTY	NEWMAR #	DESCRIPTION
1	1	132649	27x16 STAINLESS STEEL SINK
2	1	124108	COOKTOP TRUE INDUCTION 2 BURNER ELEC

PLEASE ACKNOWLEDGE AND DATE THE FOLLOWING ORDER/PRINT FOR APPROVAL TO BUILD, AND FAX TO NEWMAR (AT 574-773-2895) AS SOON AS POSSIBLE

DATE: \_\_\_\_\_

SIGN: \_\_\_\_\_

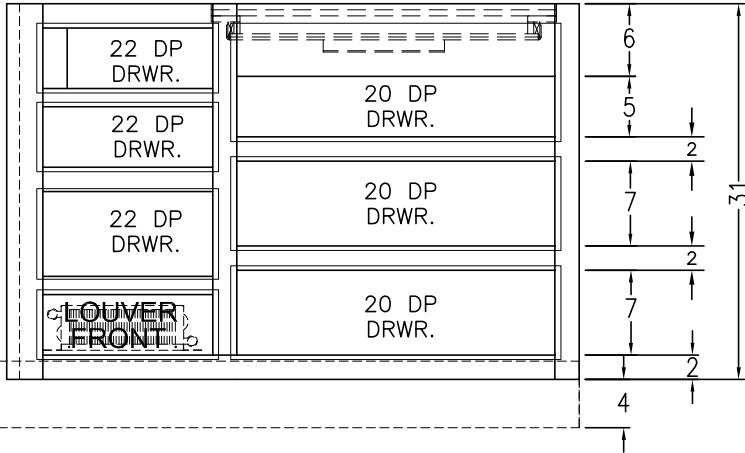
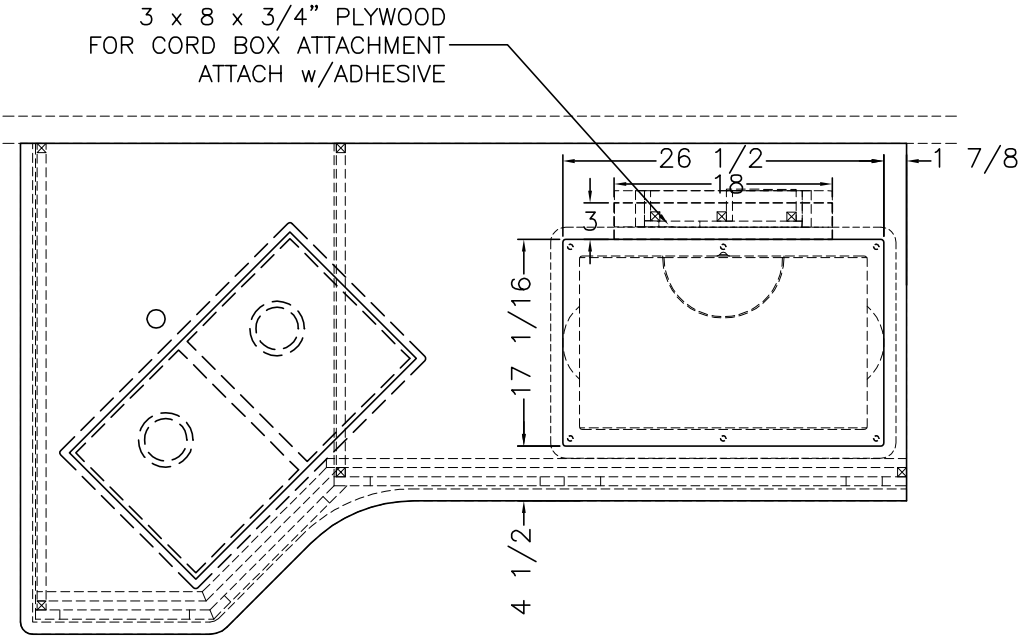

VIEW C

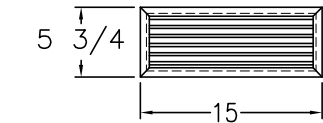

(1) 15 X 5 3/4 LOUVERED VENT  
RA THRU TOE KICK

- (2) 7 3/4x27 1/4 FRONT
- (1) 9 3/4x27 1/4 FRONTS
- (2) 5 3/4x15 FRONTS
- (1) 7 3/4x15 FRONT

EDGE TRIM  
(2) PIECES EACH  
1/2 MATERIAL

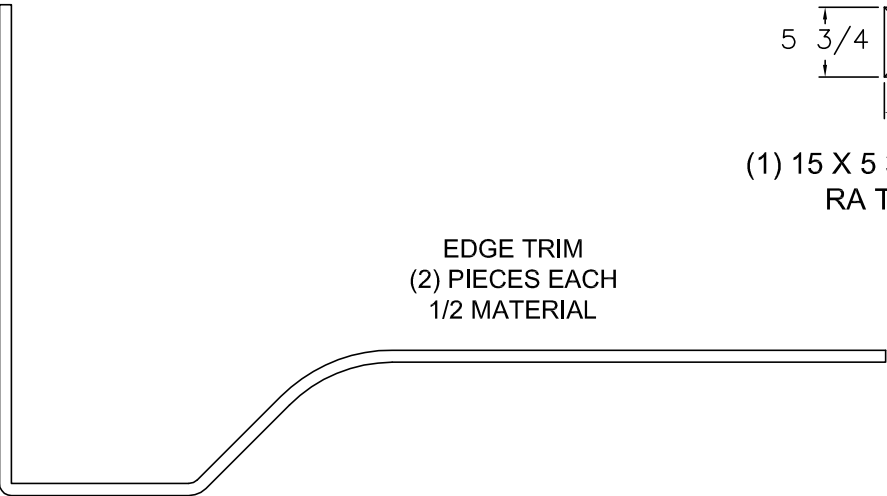

UNIT: # 413521

DEALER: Midway RV Center

SPECIAL: # 459

<div>NEWMAR CORP</div> <div>P.O. Box 30,</div> <div>Nappanee, IN. 46550</div> <div>UNITS: INCHES</div> <div>TITLE BLOCK: 75TB</div>	Model:	Sheet	Drawn by:	Checked by:	Revision:	By:
	VT DP 3412	1 OF 1	Z. R.	A. M.		Date:
	Title:	I.D. # 2018\	Date:	Date:	Revision:	By:
	71 7/8 KITCHEN CABINETS	SPECIALS\MOT\459KT	6/13/17	6/22/17		Date:

PLEASE ACKNOWLEDGE AND DATE THE FOLLOWING ORDER/PRINT FOR APPROVAL TO BUILD, AND FAX TO NEWMAR (AT 574-773-2895) AS SOON AS POSSIBLE  
DATE: \_\_\_\_\_  
SIGN: \_\_\_\_\_

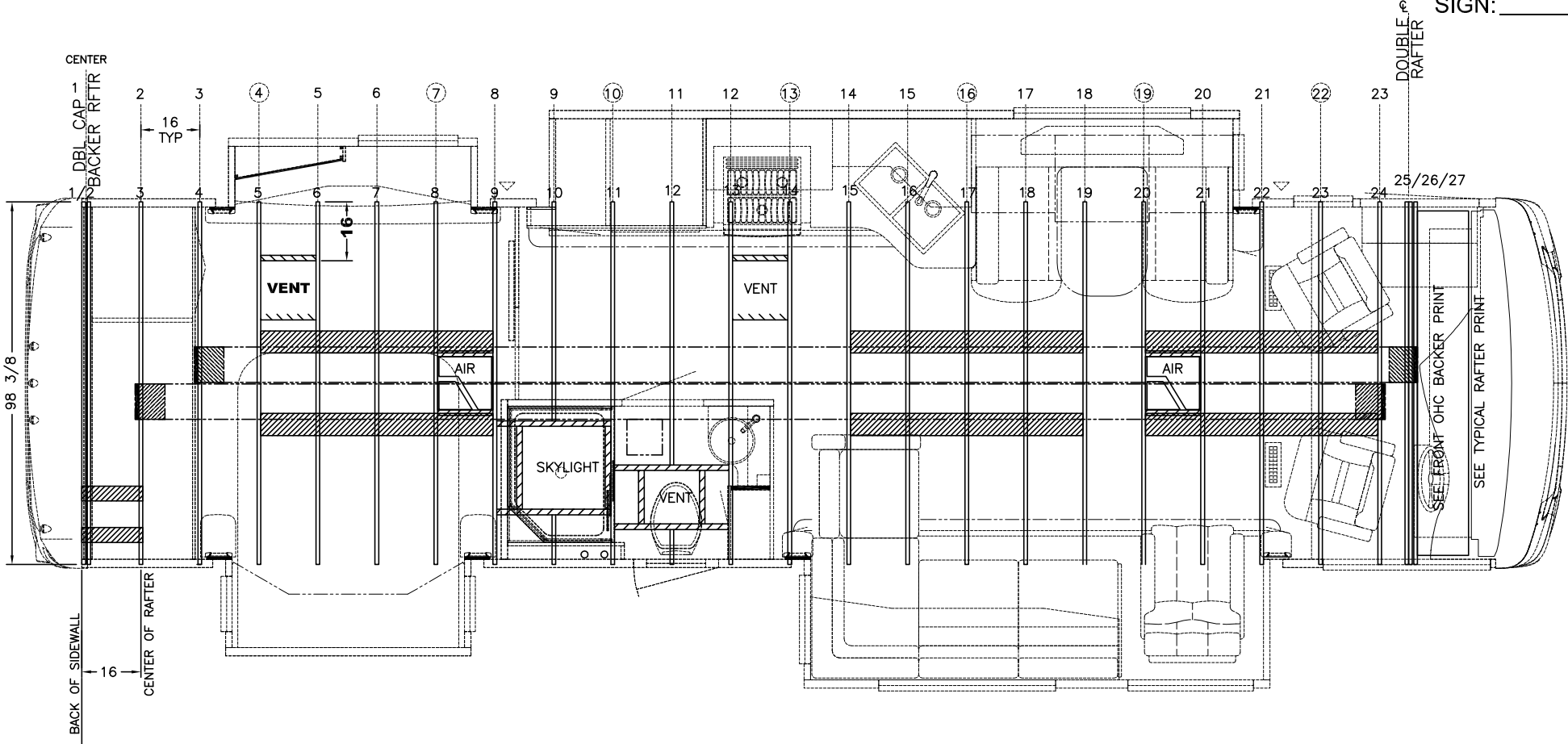

NOTE: ROOF SHOWN IN JIG POSITION

UNIT: # 413521  
DEALER: Midway RV  
SPECIAL: # 459

1) ○ – PANEL SEAM RAFTER

<b>NEWMAR CORP</b> P.O. Box 30, Nappanee, IN. 46550 UNITS: INCHES TITLE BLOCK: 3125TB	Model:	Sheet	Drawn by:	Checked by:	Revision:	By:
	VT DP 3412	1 OF 3	Z. R.	A. M.		Date:
	Title:	I.D. # 2018\	Date:	Date:	Revision:	By:
	ROOF RAFTERS	SPECIALS\MOT\459ROOF	6/22/17	6/22/17		Date:



NOTE:  
FRONT TO BACK DIMENSIONS FROM FRONT OF FRONT RAFTERS.  
SIDE TO SIDE DIMENSIONS FROM EDGE OF CEILING PANEL.

PLEASE ACKNOWLEDGE AND DATE THE  
FOLLOWING ORDER/PRINT FOR APPROVAL  
TO BUILD, AND FAX TO NEWMAR (AT  
574-773-2895) AS SOON AS POSSIBLE  
DATE: \_\_\_\_\_  
SIGN: \_\_\_\_\_

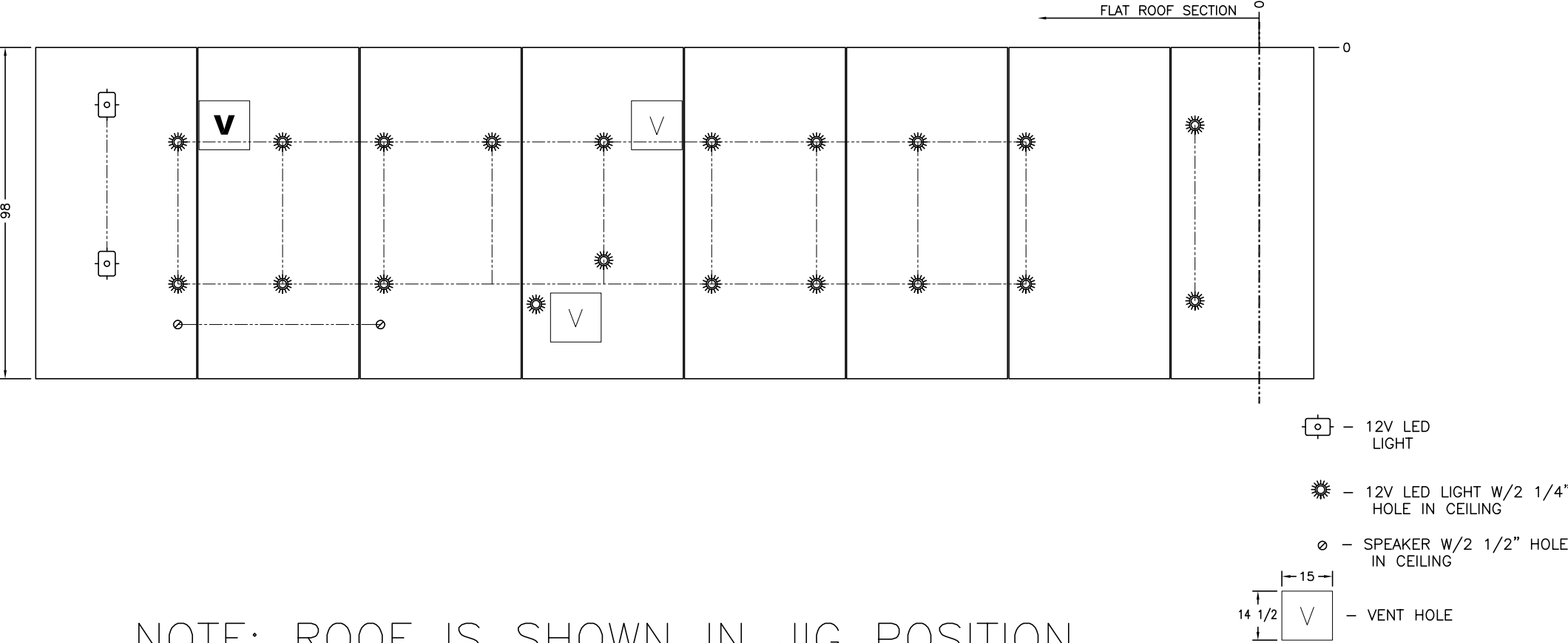

NOTE: ROOF IS SHOWN IN JIG POSITION

UNIT: # 413521  
DEALER: Midway RV  
SPECIAL: # 459

<div>NEWMAR CORP</div> <div>P.O. Box 30,</div> <div>Nappanee, IN. 46550</div> <div>UNITS: INCHES</div> <div>TITLE BLOCK: 3125TB</div>	Model:	Sheet	Drawn by:	Checked by:	Revision:	By:
	VT DP 3412	2 OF 3	Z. R.	A. M.		Date:
	Title:	I.D. # 2018\	Date:	Date:	Revision:	By:
	CEILING LIGHTS	SPECIALS\MOT\	6/22/17	6/22/17		Date:
		459ROOF				

NOTE:  
FRONT TO BACK DIMENSIONS FROM FRONT OF FRONT RAFTERS.  
SIDE TO SIDE DIMENSIONS FROM EDGE OF CEILING PANEL.

PLEASE ACKNOWLEDGE AND DATE THE FOLLOWING ORDER/PRINT FOR APPROVAL TO BUILD, AND FAX TO NEWMAR (AT 574-773-2895) AS SOON AS POSSIBLE  
DATE: \_\_\_\_\_  
SIGN: \_\_\_\_\_

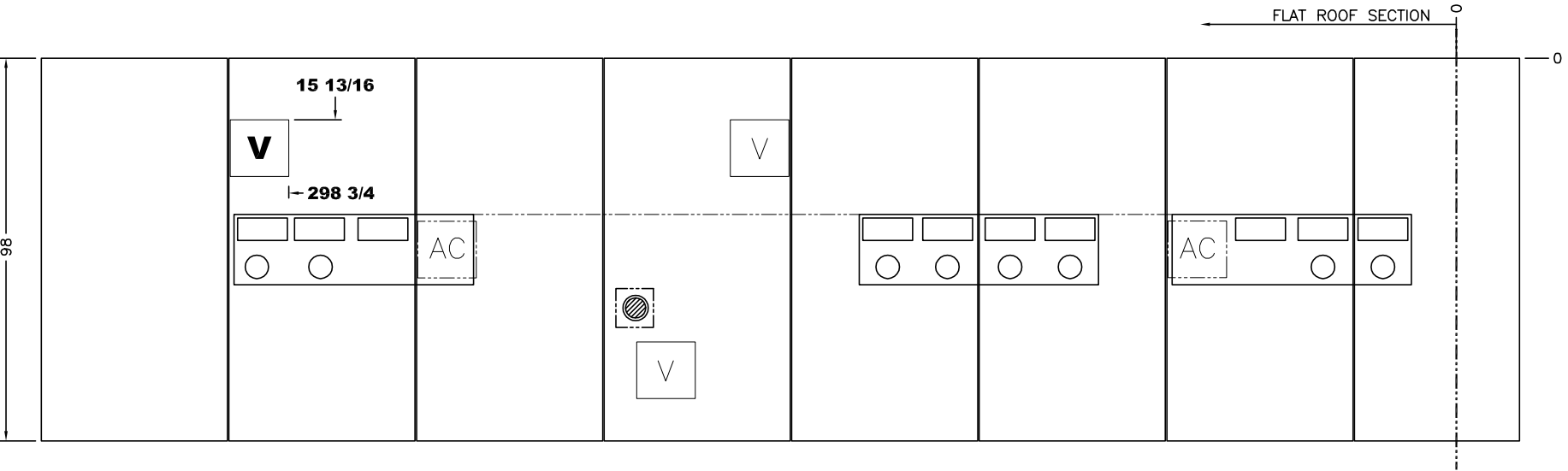

- ⊗ - 6 1/2" RETURN AIR REG.  
(5 1/8 HOLE THRU ROOF)
- - 6 1/2" SUPPLY REG.  
(5 1/8 HOLE THRU ROOF)

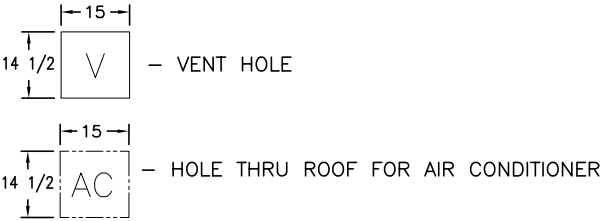

NOTE: ROOF IS SHOWN IN JIG POSITION

UNIT: # 413521  
DEALER: Midway RV  
SPECIAL: # 459

<div>NEWMAR CORP</div> <div>P.O. Box 30,</div> <div>Nappanee, IN. 46550</div> <div>UNITS: INCHES</div> <div>TITLE BLOCK: 3125TB</div>	Model:	Sheet	Drawn by:	Checked by:	Revision:	By:
	VT DP 3412	3 OF 3	Z. R.	A. M.		Date:
	Title:	I.D. # 2018\	Date:	Date:	Revision:	By:
	A/C & VENTS	SPECIALS\MOT\459ROOF	6/22/17	6/22/17		Date:

MA DP SHOWER FIXTURES

PLEASE ACKNOWLEDGE AND DATE THE FOLLOWING ORDER/PRINT FOR APPROVAL TO BUILD, AND FAX TO NEWMAR (AT 574-773-2895) AS SOON AS POSSIBLE  
DATE: \_\_\_\_\_  
SIGN: \_\_\_\_\_

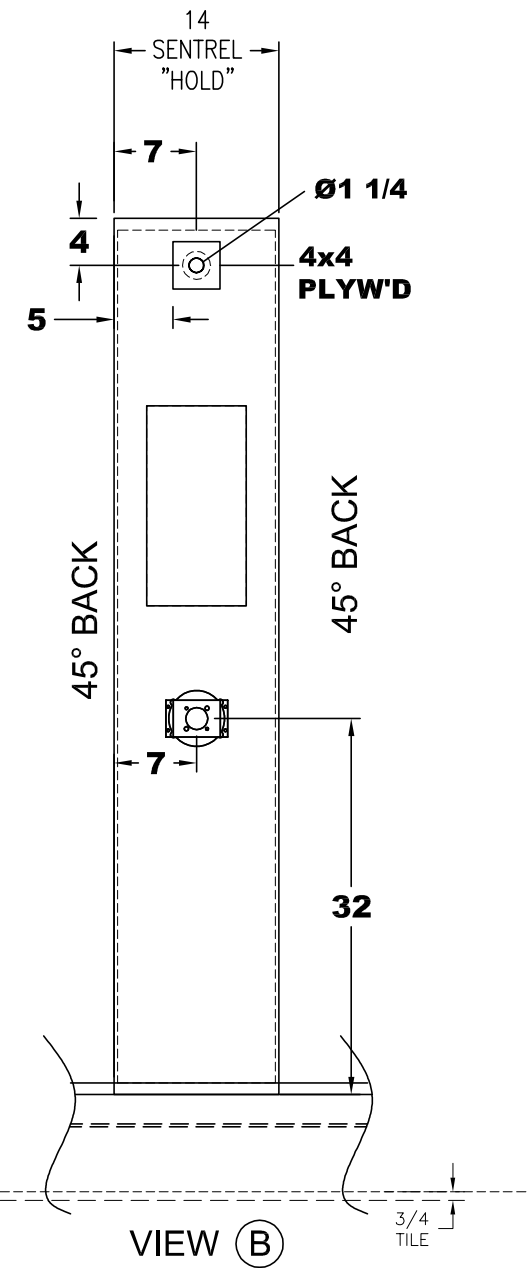

UNIT: # 413521  
DEALER: Midway RV Center  
SPECIAL: # 459

<div>NEWMAR CORP</div> <div>P.O. Box 30,</div> <div>Nappanee, IN. 46550</div> <div>UNITS: INCHES</div> <div>TITLE BLOCK: 75TB</div>	Model:	Sheet	Drawn by:	Checked by:	Revision: Added print to special print pack due to CO #98985	By: Z. R.
	VT DP 3412	1 OF 1	Z. R.	A. M.		Date: 6/26/17
	Title:	I.D. # 2018\	Date:	Date:	Revision:	By:
	38X30 SENTREL	SPECIALS\MOT\	6/26/17	6/28/17		Date:
	SHOWER WALLS	459SHWR				