

PLEASE ACKNOWLEDGE AND DATE THE
FOLLOWING ORDER/PRINT FOR APPROVAL
TO BUILD, AND FAX TO NEWMAR (AT
574-773-2895) AS SOON AS POSSIBLE
DATE: _____
SIGN: _____

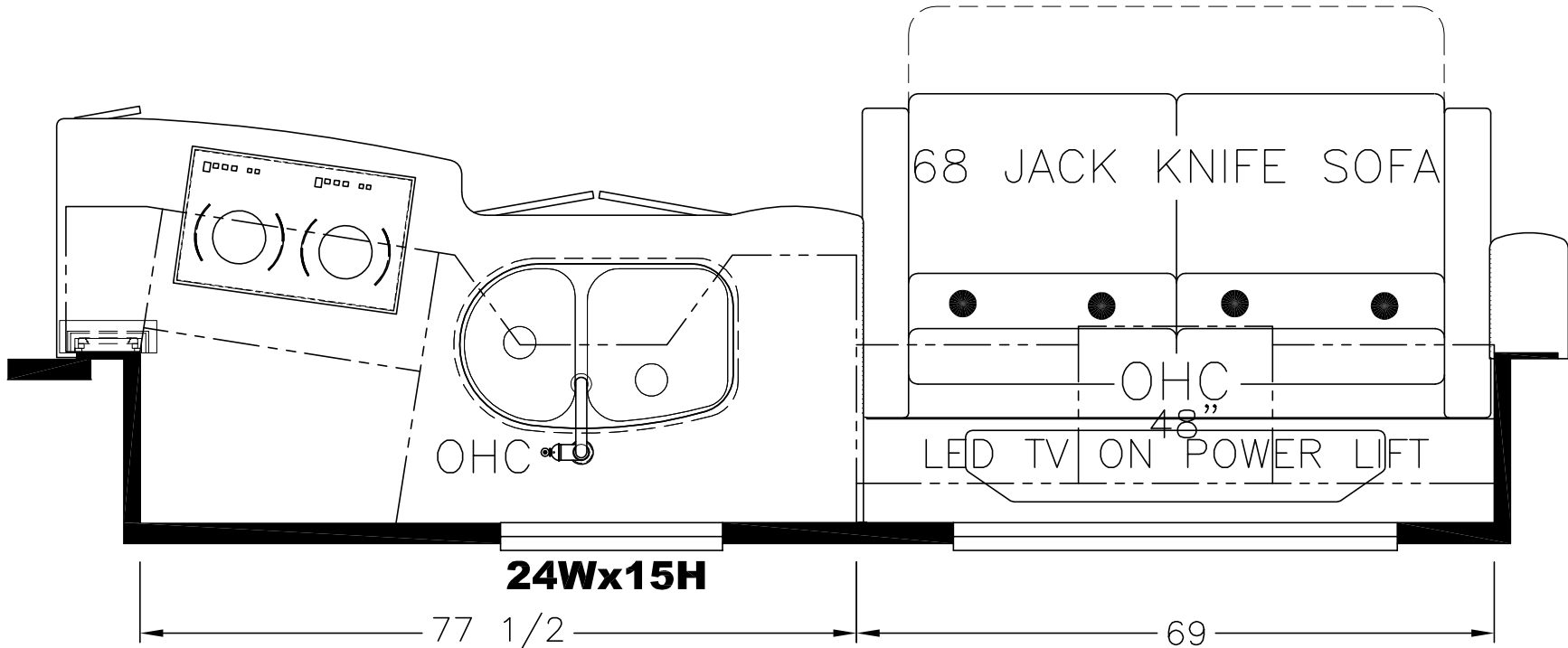

UNIT: # 501273
DEALER: Desert Autoplex
SPECIAL: # 284

<div>NEWMAR CORP</div> <div>P.O. Box 30,</div> <div>Nappanee, IN. 46550</div> <div>Title block--1TB</div>	Model:	(J610)	Sheet	1 OF 1	Drawn by:	Z. R.	Checked by:	A. M.	Revision:	By:
		LA DP 4553								Date:
	Title:	FLOOR PLAN	I.D. # 2016\	SPECIALS\MOT\	Date:	9/11/15	Date:	9/14/15	Revision:	By:
			284FP							Date:

ITEM #	QTY	NEWMAR #	DESCRIPTION
1	1	122283	CAPRAIA SS UNDERMOUNT SINK
2	J610	124108	ALL ELECTRIC INDUCTION COOKTOP (S2F3)

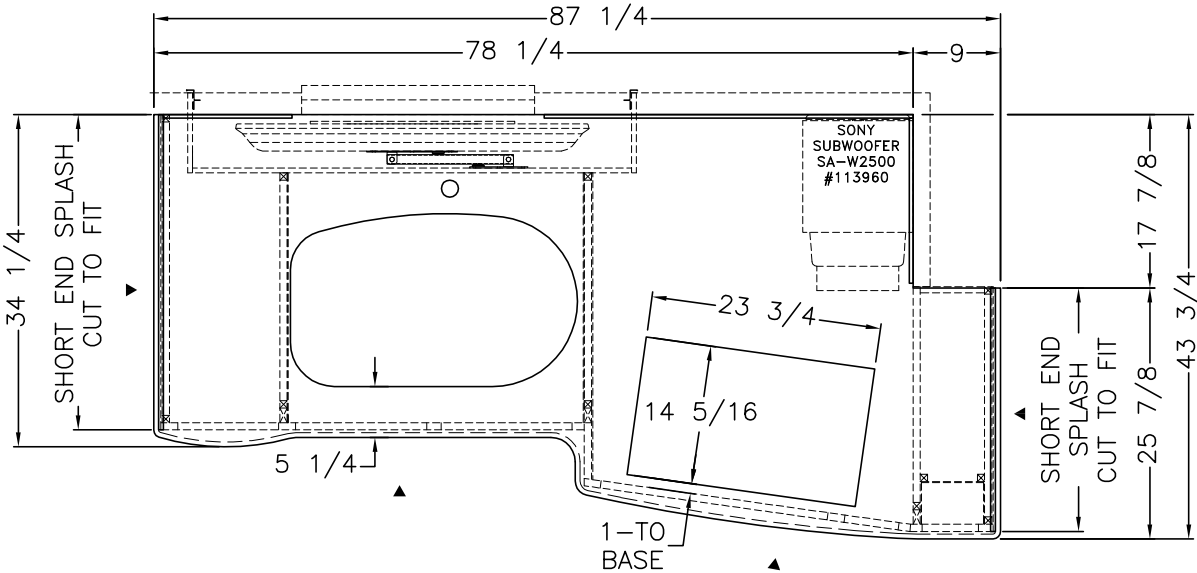

▶ — DENOTES A FINISHED EDGE

1/2" THICKNESS

SEE TYPICAL PRINTS FOR EDGE AND RANGE APPLICATION

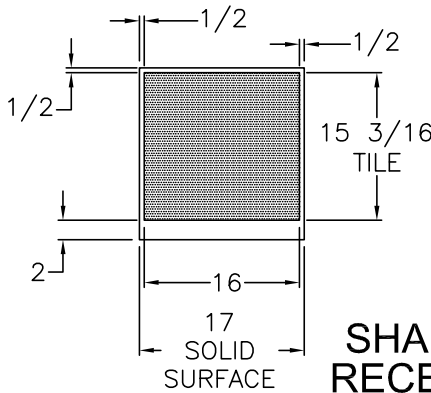
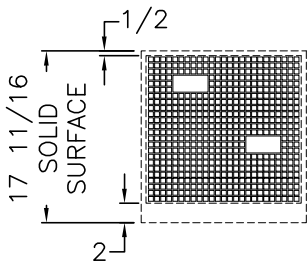

SHADED DENOTES 3/8" RECESS FOR TILE INLAY

PLEASE ACKNOWLEDGE AND DATE THE FOLLOWING ORDER/PRINT FOR APPROVAL TO BUILD, AND FAX TO NEWMAR (AT 574-773-2895) AS SOON AS POSSIBLE
DATE: _____
SIGN: _____

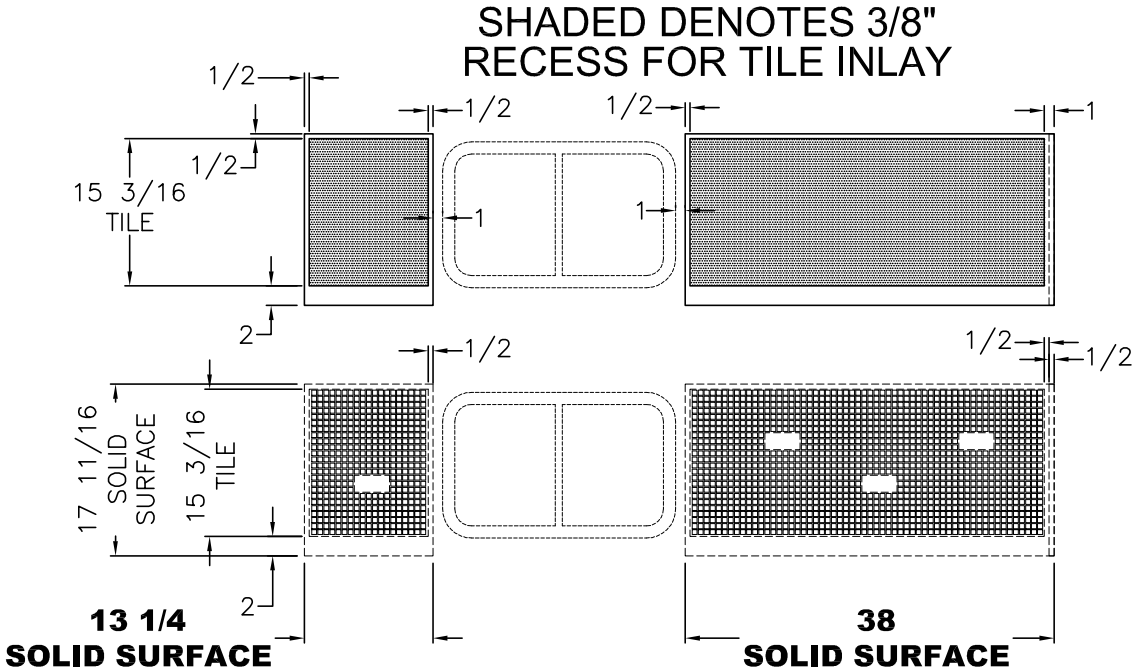

BACK SPLASH

UNIT: # 501273
DEALER: Desert Autoplex
SPECIAL: # 284

NEWMAR CORP P.O. Box 30, Nappanee, IN. 46550 Title block--75TB	Model: (J610)(J528)	Sheet 1 OF 1	Drawn by: Z. R.	Checked by: A. M.	Revision:	By:
	LA DP 4553					Date:
	Title: 77 1/2 KITCHEN	I.D. # 2016\ SPECIALS\MOT\ 284KT	Date: 9/11/15	Date: 9/14/15	Revision:	By:
						Date: