

PLEASE ACKNOWLEDGE AND DATE THE FOLLOWING ORDER/PRINT FOR APPROVAL TO BUILD, AND FAX TO NEWMAR (AT 574-773-2895) AS SOON AS POSSIBLE
DATE: _____
SIGN: _____

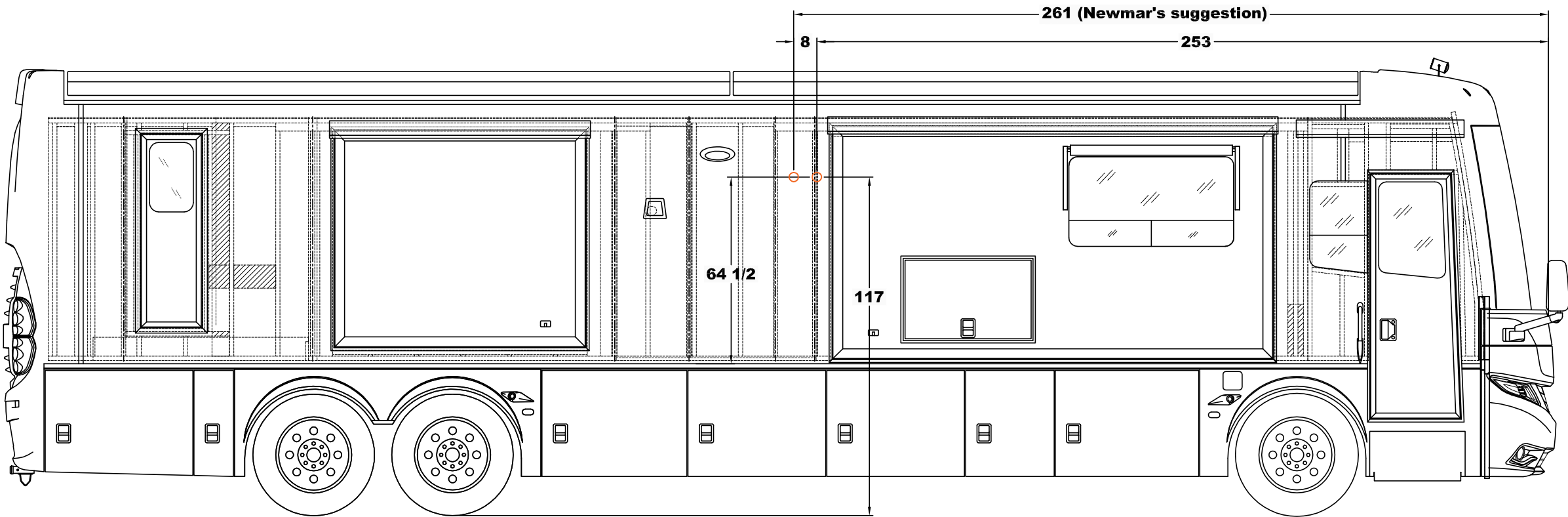

UNIT: # 501458
DEALER: Newmar Corp.
SPECIAL: # 509

NOTE:
SIZES SHOWN ARE FOR SKINS ONLY.
3/8" GAP BETWEEN DOORS TYPICAL

ATTENTION:
THE PURPOSE OF THIS PRINT IS TO PROVIDE A VISUAL REPRESENTATION OF THIS FLOOR PLAN. DUE TO CONSTANT UPDATES TO EXTERIOR FEATURES, DO NOT TAKE DIMENSIONAL REFERENCES FROM THIS DRAWING WITHOUT VERIFYING THEM WITH THE ACTUAL UNIT.

NEWMAR CORP <i>P.O. Box 30, Nappanee, IN. 46550</i>	Model:	(T100)(R030)	Sheet	Drawn by:	Checked by:	Revision:	By:
	LA DP 4539	(J528)(R040)	1 OF 3	Z. R.	A. M.		Date:
	Title:		I.D. # 2017\	Date:	Date:	Revision:	By:
			SPECIALS\MOT\	6/20/16	6/22/16		Date:
	UNITS: INCHES		509CAM360				
	TITLE BLOCK: 3125TB	DS PROFILE					

PLEASE ACKNOWLEDGE AND DATE THE FOLLOWING ORDER/PRINT FOR APPROVAL TO BUILD, AND FAX TO NEWMAR (AT 574-773-2895) AS SOON AS POSSIBLE
DATE: _____
SIGN: _____

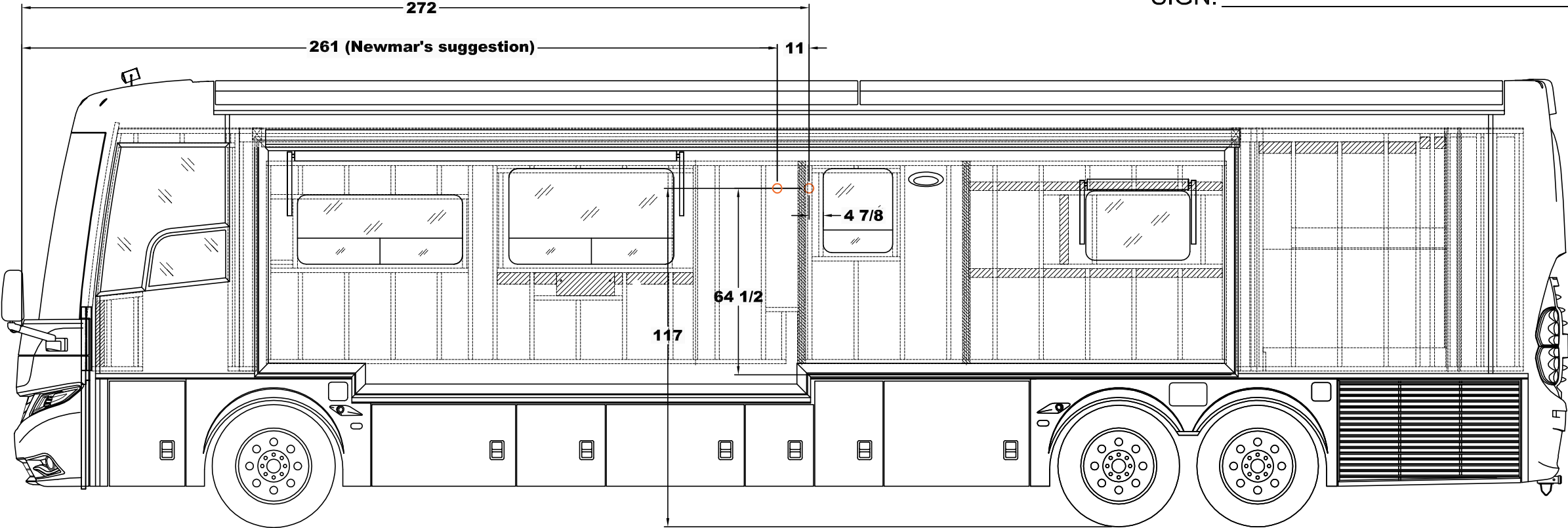

UNIT: # 501458
DEALER: Newmar Corp.
SPECIAL: # 509

NOTE:
SIZES SHOWN ARE FOR SKINS ONLY.
3/8" GAP BETWEEN DOORS TYPICAL

ATTENTION:
THE PURPOSE OF THIS PRINT IS TO PROVIDE A VISUAL REPRESENTATION OF THIS FLOOR PLAN. DUE TO CONSTANT UPDATES TO EXTERIOR FEATURES, DO NOT TAKE DIMENSIONAL REFERENCES FROM THIS DRAWING WITHOUT VERIFYING THEM WITH THE ACTUAL UNIT.

<div>NEWMAR CORP</div> <div>P.O. Box 30,</div> <div>Nappanee, IN. 46550</div> <div>UNITS: INCHES</div> <div>TITLE BLOCK: 3125TB</div>	Model:	(R030)	Sheet	Drawn by:	Checked by:	Revision:	By:
	LA DP 4539		2 OF 3	Z. R.	A. M.		Date:
	Title:		I.D. # 2017\	Date:	Date:	Revision:	By:
	ODS PROFILE		SPECIALS\MOT\	6/20/16	6/22/16		Date:
			509CAM360				

PLEASE ACKNOWLEDGE AND DATE THE FOLLOWING ORDER/PRINT FOR APPROVAL TO BUILD, AND FAX TO NEWMAR (AT 574-773-2895) AS SOON AS POSSIBLE
DATE: _____
SIGN: _____

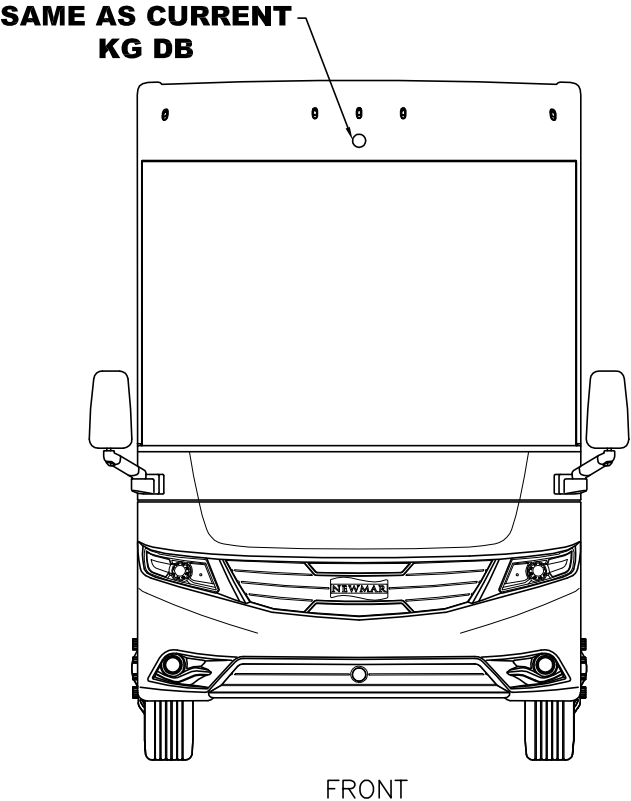
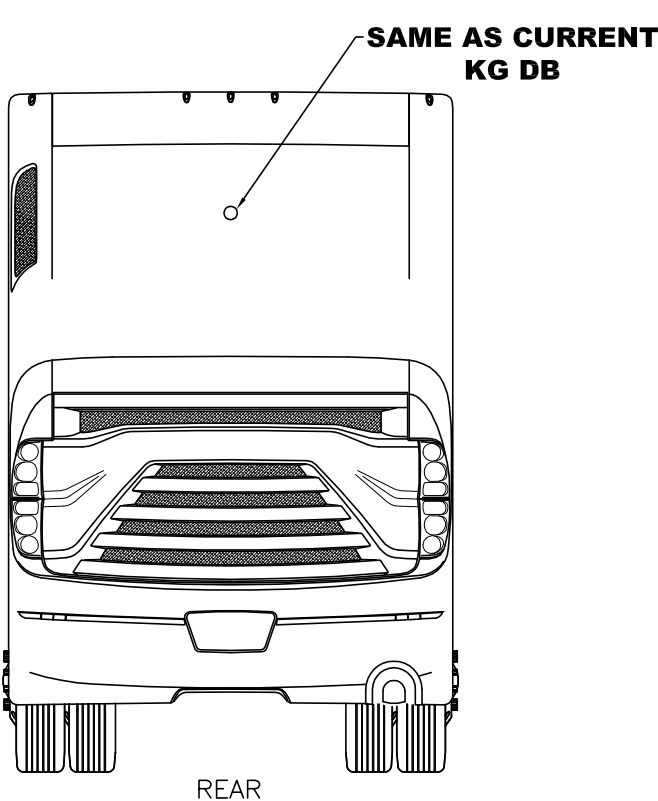

UNIT: # 501458
DEALER: Newmar Corp.
SPECIAL: # 509

NOTE:
SIZES SHOWN ARE FOR SKINS ONLY.
3/8" GAP BETWEEN DOORS TYPICAL

ATTENTION:
THE PURPOSE OF THIS PRINT IS TO PROVIDE A VISUAL REPRESENTATION OF THIS FLOOR PLAN. DUE TO CONSTANT UPDATES TO EXTERIOR FEATURES, DO NOT TAKE DIMENSIONAL REFERENCES FROM THIS DRAWING WITHOUT VERIFYING THEM WITH THE ACTUAL UNIT.

<div>NEWMAR CORP</div> <div>P.O. Box 30,</div> <div>Nappanee, IN. 46550</div> <div>UNITS: INCHES</div> <div>TITLE BLOCK: 3125TB</div>	Model:	(C140)	Sheet	Drawn by:	Checked by:	Revision:	By:
		LA DP 4539	3 OF 3	Z. R.	A. M.		Date:
	Title:	ODS PROFILE	I.D. # 2017\	Date:	Date:	Revision:	By:
			SPECIALS\MOT\	6/20/16	6/22/16		Date:
			509CAM360				

PLEASE ACKNOWLEDGE AND DATE THE FOLLOWING ORDER/PRINT FOR APPROVAL TO BUILD, AND FAX TO NEWMAR (AT 574-773-2895) AS SOON AS POSSIBLE
DATE: _____
SIGN: _____

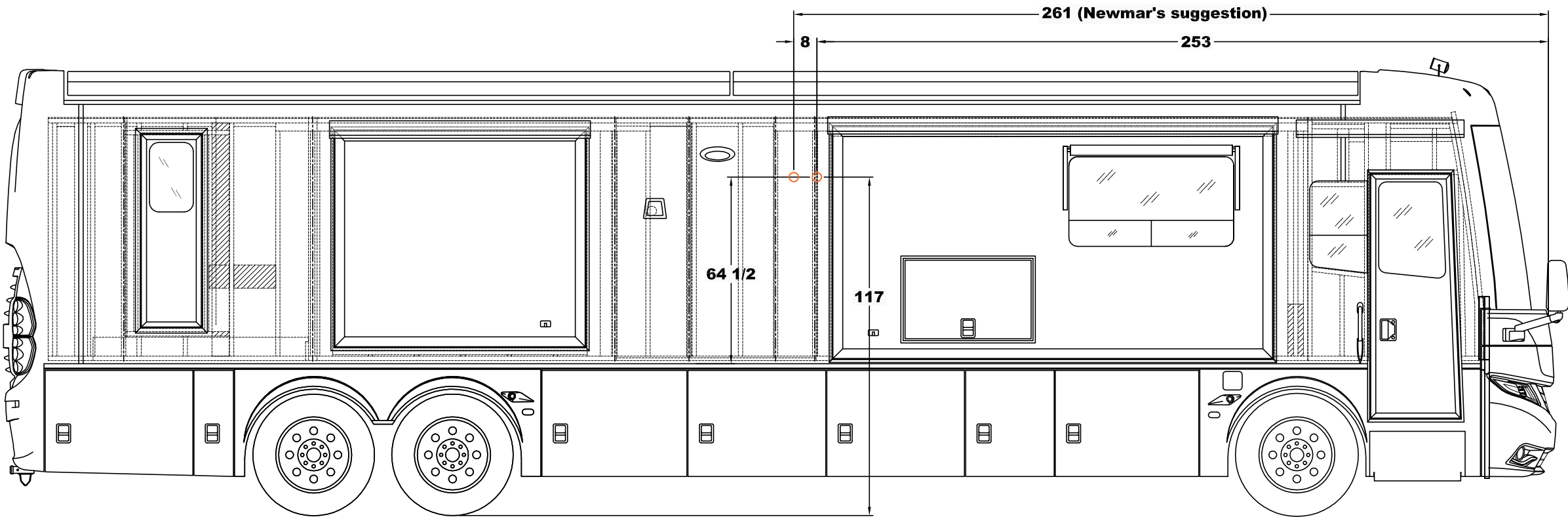

UNIT: # 501458
DEALER: Newmar Corp.
SPECIAL: # 509

NOTE:
SIZES SHOWN ARE FOR SKINS ONLY.
3/8" GAP BETWEEN DOORS TYPICAL

ATTENTION:
THE PURPOSE OF THIS PRINT IS TO PROVIDE A VISUAL REPRESENTATION OF THIS FLOOR PLAN. DUE TO CONSTANT UPDATES TO EXTERIOR FEATURES, DO NOT TAKE DIMENSIONAL REFERENCES FROM THIS DRAWING WITHOUT VERIFYING THEM WITH THE ACTUAL UNIT.

NEWMAR CORP <i>P.O. Box 30, Nappanee, IN. 46550</i>	Model:	(T100)(R030)	Sheet	Drawn by:	Checked by:	Revision:	By:
	LA DP 4539	(J528)(R040)	1 OF 3	Z. R.	A. M.		Date:
	Title:		I.D. # 2017\	Date:	Date:	Revision:	By:
			SPECIALS\MOT\	6/20/16	6/22/16		Date:
	UNITS: INCHES		509CAM360				
	TITLE BLOCK: 3125TB	DS PROFILE					

PLEASE ACKNOWLEDGE AND DATE THE FOLLOWING ORDER/PRINT FOR APPROVAL TO BUILD, AND FAX TO NEWMAR (AT 574-773-2895) AS SOON AS POSSIBLE
DATE: _____
SIGN: _____

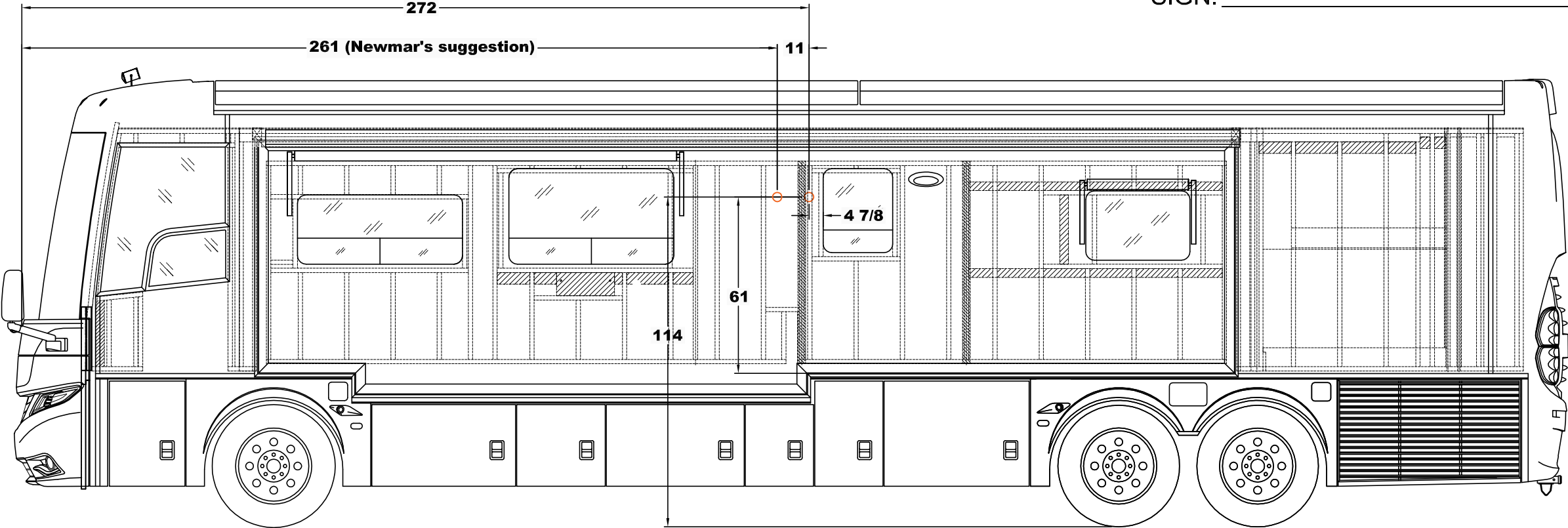

UNIT: # 501458
DEALER: Newmar Corp.
SPECIAL: # 509

NOTE:
SIZES SHOWN ARE FOR SKINS ONLY.
3/8" GAP BETWEEN DOORS TYPICAL

ATTENTION:
THE PURPOSE OF THIS PRINT IS TO PROVIDE A VISUAL REPRESENTATION OF THIS FLOOR PLAN. DUE TO CONSTANT UPDATES TO EXTERIOR FEATURES, DO NOT TAKE DIMENSIONAL REFERENCES FROM THIS DRAWING WITHOUT VERIFYING THEM WITH THE ACTUAL UNIT.

<div>NEWMAR CORP</div> <div>P.O. Box 30,</div> <div>Nappanee, IN. 46550</div> <div>UNITS: INCHES</div> <div>TITLE BLOCK: 3125TB</div>	Model:	(R030)	Sheet	Drawn by:	Checked by:	Revision:	By:
	LA DP 4539		2 OF 3	Z. R.	A. M.		Date:
	Title:		I.D. # 2017\	Date:	Date:	Revision:	By:
	ODS PROFILE		SPECIALS\MOT\	6/20/16	6/22/16		Date:
			509CAM360				

PLEASE ACKNOWLEDGE AND DATE THE FOLLOWING ORDER/PRINT FOR APPROVAL TO BUILD, AND FAX TO NEWMAR (AT 574-773-2895) AS SOON AS POSSIBLE
DATE: _____
SIGN: _____

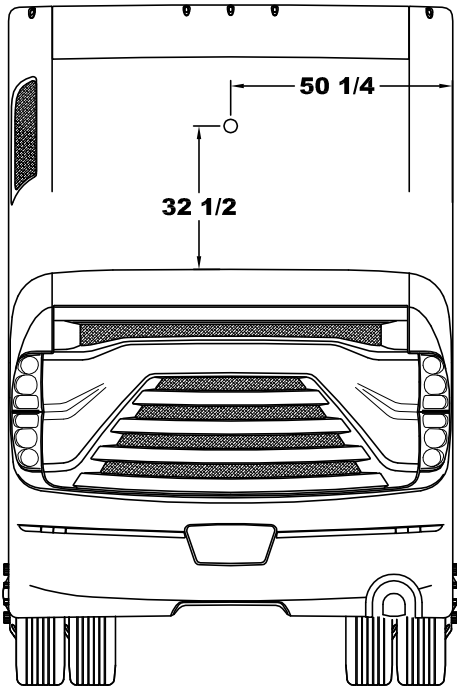

REAR

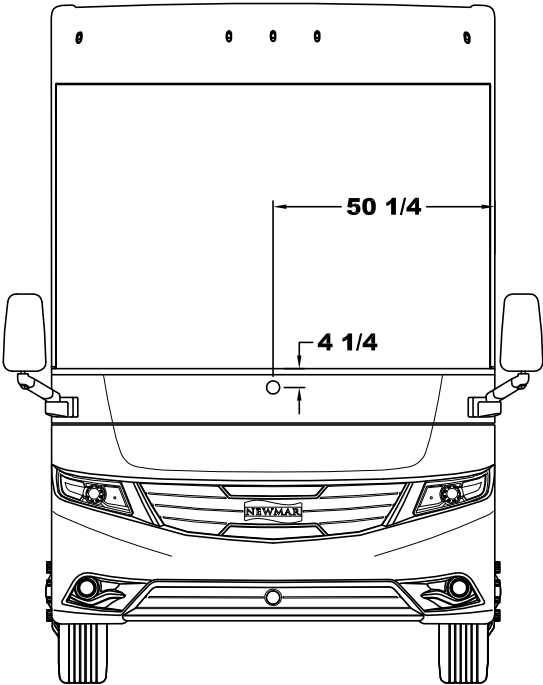

FRONT

UNIT: # 501458
DEALER: Newmar Corp.
SPECIAL: # 509

NOTE:
SIZES SHOWN ARE FOR SKINS ONLY.
3/8” GAP BETWEEN DOORS TYPICAL

ATTENTION:
THE PURPOSE OF THIS PRINT IS TO PROVIDE A VISUAL REPRESENTATION OF THIS FLOOR PLAN. DUE TO CONSTANT UPDATES TO EXTERIOR FEATURES, DO NOT TAKE DIMENSIONAL REFERENCES FROM THIS DRAWING WITHOUT VERIFYING THEM WITH THE ACTUAL UNIT.

<div>NEWMAR CORP</div> <div>P.O. Box 30,</div> <div>Nappanee, IN. 46550</div> <div>UNITS: INCHES</div> <div>TITLE BLOCK: 3125TB</div>	Model:	(C140)	Sheet	Drawn by:	Checked by:	Revision:	By:
		LA DP 4539	3 OF 3	Z. R.	A. M.		Date:
	Title:	ODS PROFILE	I.D. # 2017\	Date:	Date:	Revision:	By:
			SPECIALS\MOT\	6/20/16	6/22/16		Date:
			509CAM360				