

PLEASE ACKNOWLEDGE AND DATE THE FOLLOWING ORDER/PRINT FOR APPROVAL TO BUILD, AND FAX TO NEWMAR (AT 574-773-2895) AS SOON AS POSSIBLE
DATE: _____
SIGN: _____

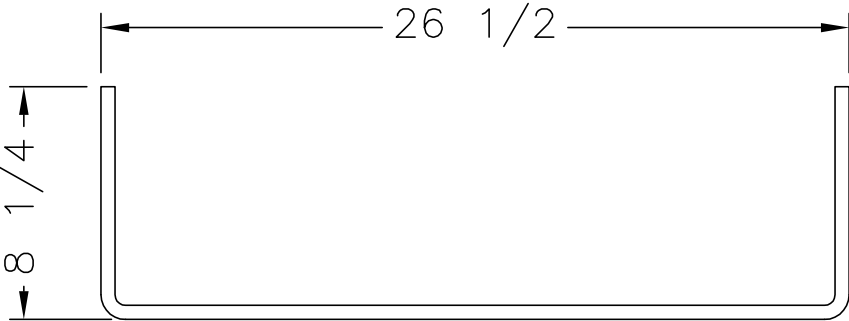
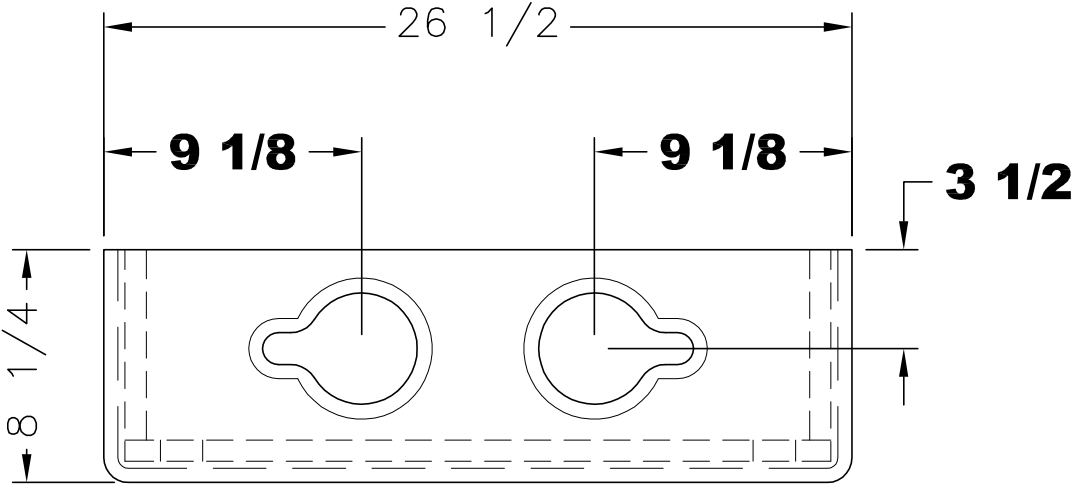

FIXED COUNTERTOP AND
EDGE TREATMENT

UNIT: # 501467
DEALER: Coachlight RV Sales
SPECIAL: # 789

<div>NEWMAR CORP</div> <div>P.O. Box 30,</div> <div>Nappanee, IN. 46550</div> <div>UNITS: INCHES</div> <div>TITLE BLOCK: 1TB</div>	Model:	(K674)	Sheet	Drawn by:	Checked by:	Revision:	By:
		LA DP 4533	1 OF 1	Z. R.	A. M.		Date:
	Title:		I.D. # 2017\	Date:	Date:	Revision:	By:
		EURO BOOTH DINETTE TABLE	SPECIALS\MOT\789DK	8/17/16	8/19/16		Date:

3 X 18 X 3/4 PLYWOOD FOR
CORD BOX ATTACHMENT
(ATTACH WITH ADHESIVE)

12 7/8

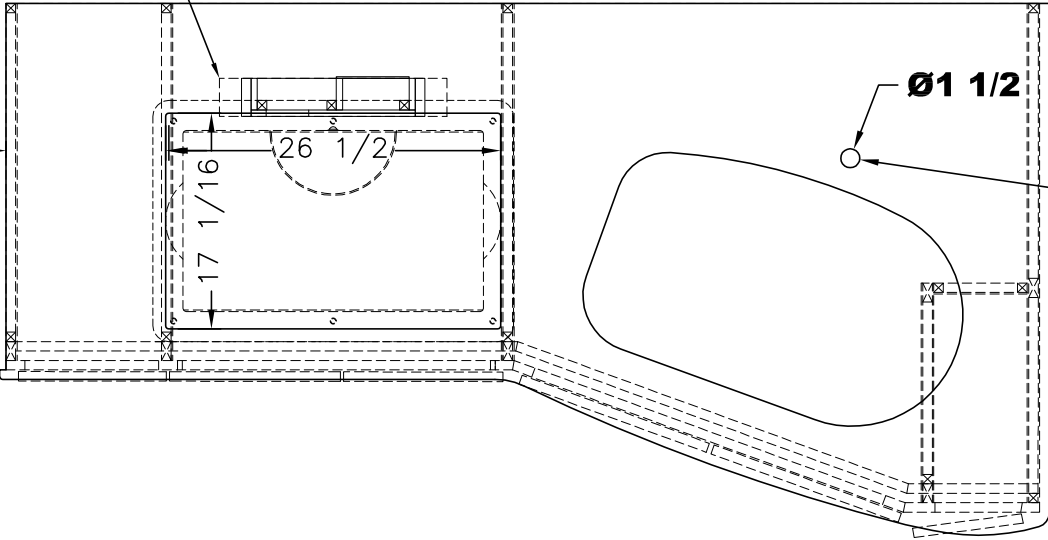

Ø1 1/2

**DS DP KITCHEN
FAUCET**

PLEASE ACKNOWLEDGE AND DATE THE
FOLLOWING ORDER/PRINT FOR APPROVAL
TO BUILD, AND FAX TO NEWMAR (AT
574-773-2895) AS SOON AS POSSIBLE
DATE: _____
SIGN: _____

UNIT: # 501467
DEALER: Coachlight RV Sales
SPECIAL: # 789

COUNTERTOP AND EDGE TREATMENT

<div>NEWMAR CORP</div> <div>P.O. Box 30,</div> <div>Nappanee, IN. 46550</div> <div>UNITS: INCHES</div> <div>TITLE BLOCK: 75TB</div>	Model:	(J611)	Sheet	Drawn by:	Checked by:	Revision:	By:
		LA DP 4533	1 OF 2	Z. R.	A. M.		Date:
	Title:	81 3/4 KITCHEN CABINETS	I.D. # 2017\	Date:	Date:	Revision:	By:
			SPECIALS\MOT\	8/17/16	8/19/16		Date:
			789KT				

2017 LA DP BATHROOM BACKSPLASH TILE

PLEASE ACKNOWLEDGE AND DATE THE
FOLLOWING ORDER/PRINT FOR APPROVAL
TO BUILD, AND FAX TO NEWMAR (AT
574-773-2895) AS SOON AS POSSIBLE
DATE: _____
SIGN: _____

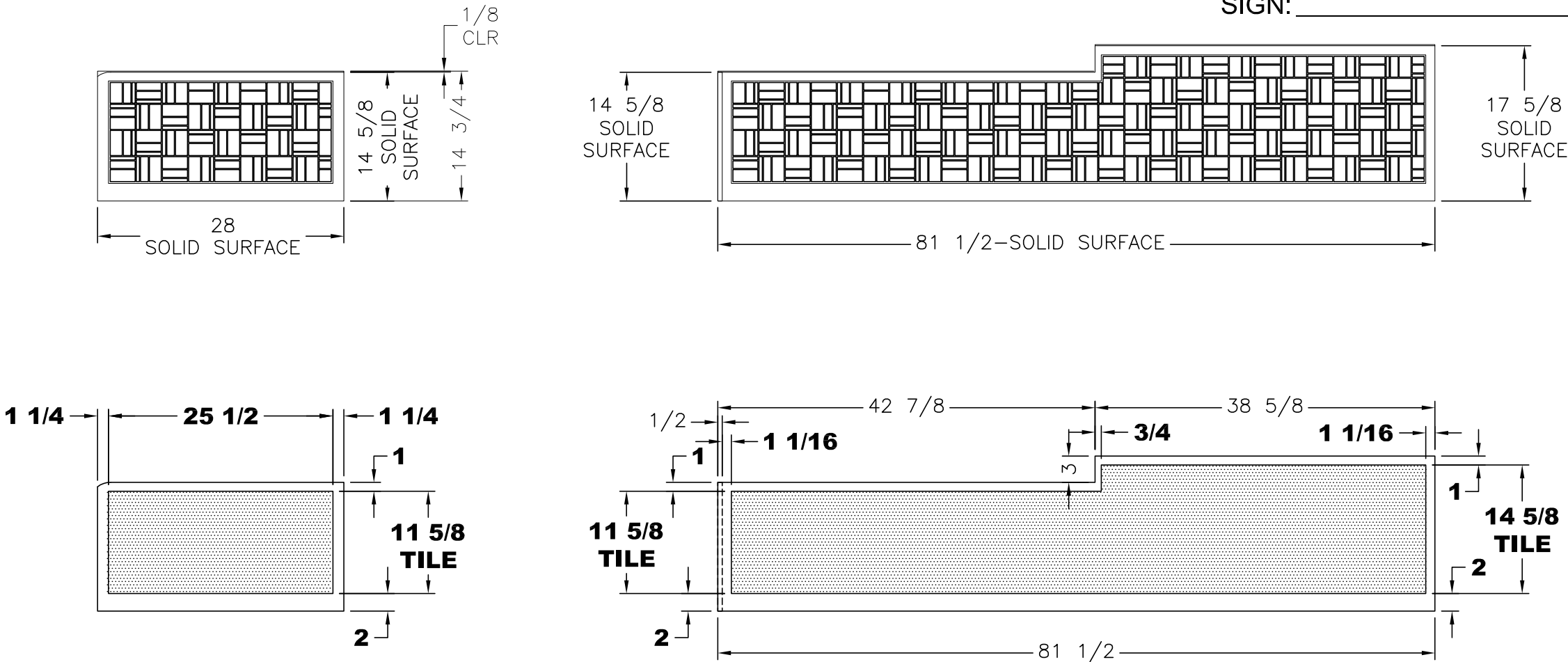

UNIT: # 501467
DEALER: Coachlight RV Sales
SPECIAL: # 789

BACK SPLASH
SHADED DENOTES 3/8"
RECESS FOR TILE INLAY

<div>NEWMAR CORP</div> <div>P.O. Box 30,</div> <div>Nappanee, IN. 46550</div> <div>UNITS: INCHES</div> <div>TITLE BLOCK: 75TB</div>	Model:	Sheet	Drawn by:	Checked by:	Revision:	By:
	LA DP 4533	2 OF 2	Z. R.	A. M.		Date:
	Title:	I.D. # 2017\	Date:	Date:	Revision:	By:
	81 3/4 KITCHEN CABINETS	SPECIALS\MOT\789KT	8/17/16	8/19/16		Date:

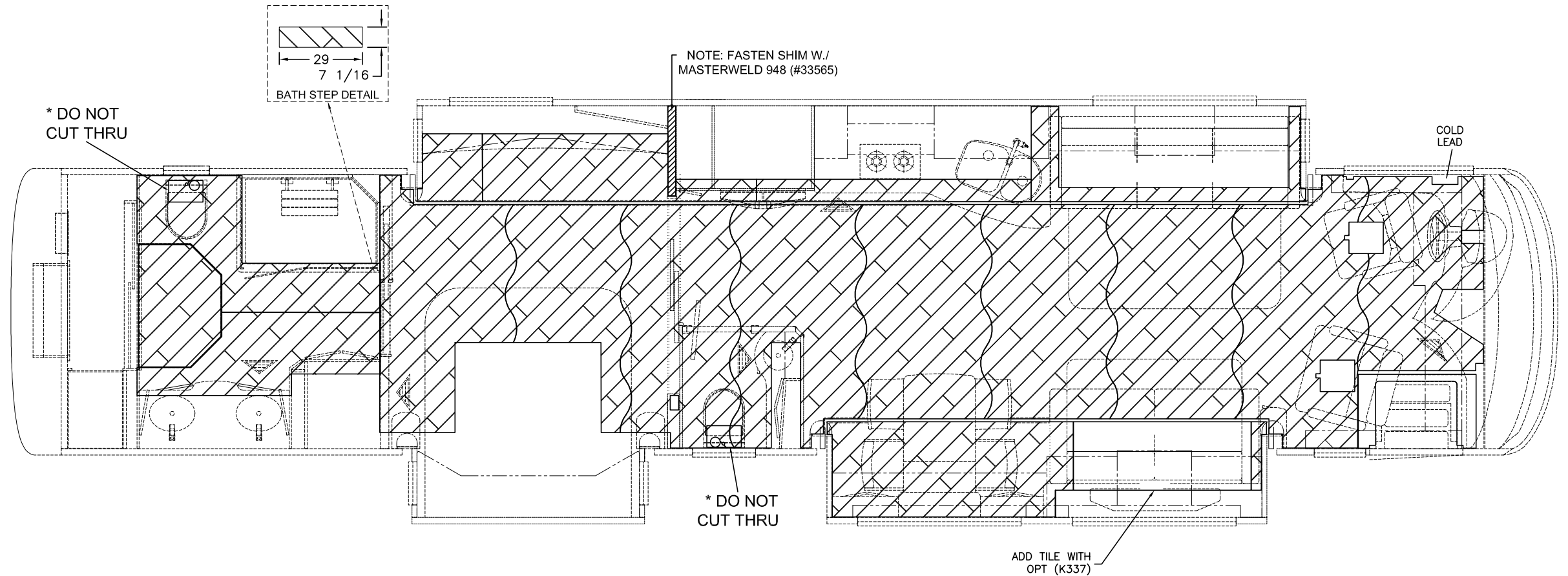

2017 KG DB TILE
32 7/8 x 5 3/8
(LAID IN KG DB PATTERN
ROTATED 45.25°)

PLEASE ACKNOWLEDGE AND DATE THE FOLLOWING ORDER/PRINT FOR APPROVAL TO BUILD, AND FAX TO NEWMAR (AT 574-773-2895) AS SOON AS POSSIBLE
 DATE: _____
 SIGN: _____

UNIT: # 501467
 DEALER: Coachlight RV Sales
 SPECIAL: # 789

NEWMAR CORP <i>P.O. Box 30, Nappanee, IN. 46550</i> UNITS: INCHES TITLE BLOCK: 3125TB	Model:	Sheet	Drawn by:	Checked by:	Revision:	By:
	LA DP 4533	1 OF 1	Z. R.	A. M.		Date:
	Title:	I.D. # 2017\	Date:	Date:	Revision:	By:
	STANDARD TILE LAYOUT	SPECIALS\MOT\789TILE	8/17/16	8/19/16		Date: