

2016 LA DP BACKSPLASH TILE

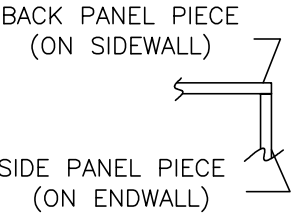

PLEASE ACKNOWLEDGE AND DATE THE FOLLOWING ORDER/PRINT FOR APPROVAL TO BUILD, AND FAX TO NEWMAR (AT 574-773-2895) AS SOON AS POSSIBLE

DATE: _____

SIGN: _____

INSTALLATION DETAIL
(SCALE 4X)

SOLID DENOTES 3/8" RECESS FOR TILE INLAY

CENTER TILE LAYOUT

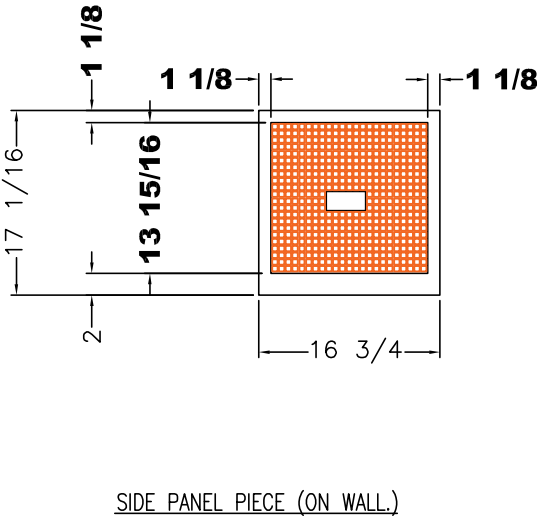
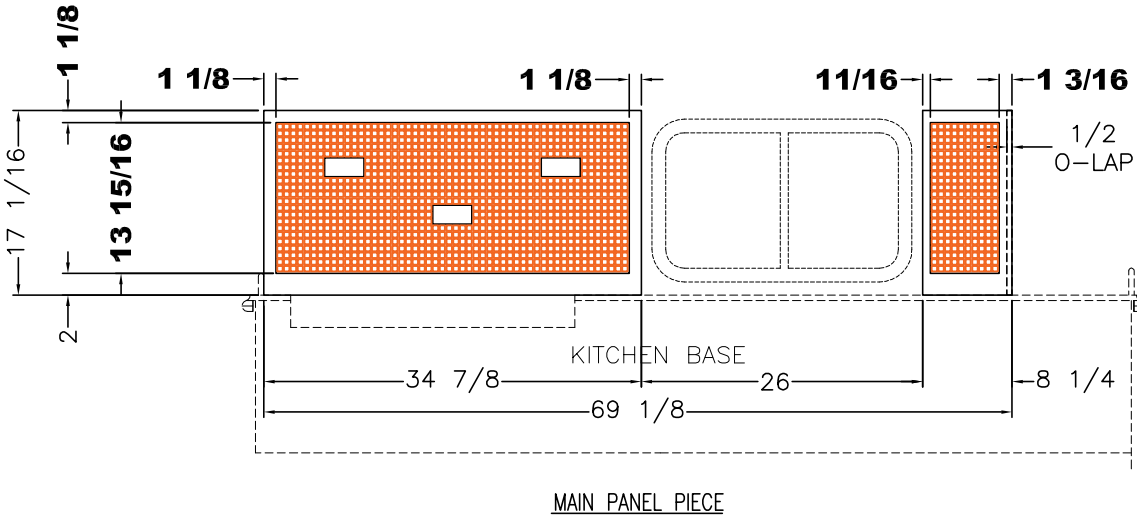

TILE/SOLID SURFACE BACKSPLASH
(T360) KITCHEN WINDOW

UNIT: # 606005
DEALER: Daves RV Center
SPECIAL: # 1390

<div>NEWMAR CORP</div> <div>P.O. Box 30,</div> <div>Nappanee, IN. 46550</div> <div>UNITS: INCHES</div> <div>TITLE BLOCK--75TB</div>	Model:	(T360)	Sheet	Drawn by:	Checked by:	Revision:	By:
	DS DP 3736		1 OF 1	Z. R.	A. M.		Date:
	Title:		I.D. # 2016\	Date:	Date:	Revision:	By:
	70 5/8 KIT S-O BASE		SPECIALS\MOT\	2/8/16	2/9/16		Date:
			1390KT				

2016 LA DP BACKSPLASH TILE

PLEASE ACKNOWLEDGE AND DATE THE FOLLOWING ORDER/PRINT FOR APPROVAL TO BUILD, AND FAX TO NEWMAR (AT 574-773-2895) AS SOON AS POSSIBLE
DATE: _____
SIGN: _____

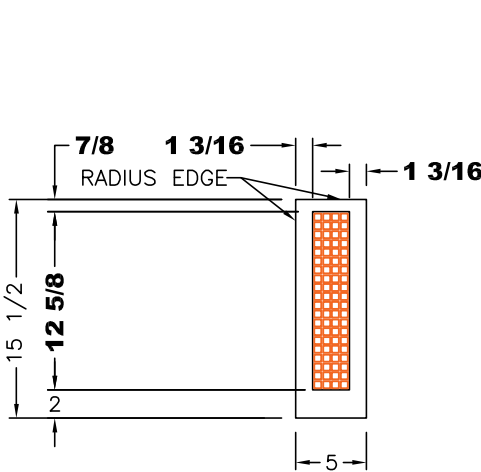

VIEW A

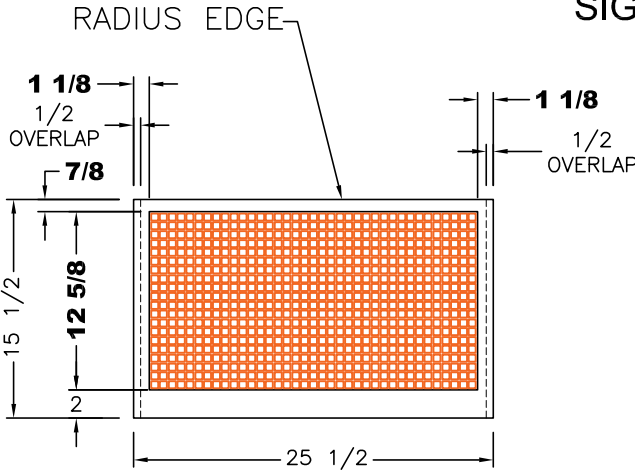

VIEW B

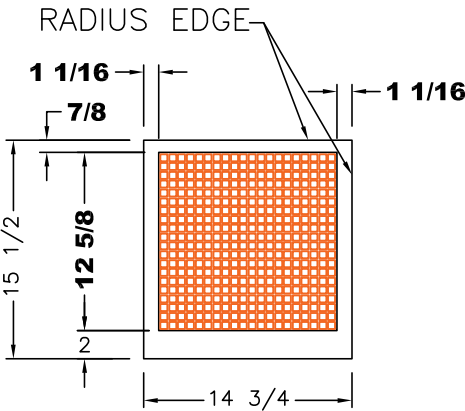

VIEW C

1/2" SOLID SURFACE
SHADED DENOTES 3/8"
RECESS FOR TILE INLAY

UNIT: # 606005
DEALER: Daves RV Center
SPECIAL: # 1390

<div>NEWMAR CORP</div> <div>P.O. Box 30,</div> <div>Nappanee, IN. 46550</div> <div>UNITS: INCHES</div> <div>TITLE BLOCK: 1TB</div>	Model:	Sheet	Drawn by:	Checked by:	Revision:	By:
	DS DP 3736	1 OF 1	Z. R.	A. M.		Date:
	Title: STOOL ROOM	I.D. # 2016\	Date:	Date:	Revision:	By:
	LAV BASE & TOP	SPECIALS\MOT\	2/8/16	2/9/16		Date:
		1390LV				

2016 LA DP BACKSPLASH TILE

PLEASE ACKNOWLEDGE AND DATE THE FOLLOWING ORDER/PRINT FOR APPROVAL TO BUILD, AND FAX TO NEWMAR (AT 574-773-2895) AS SOON AS POSSIBLE
DATE: _____
SIGN: _____

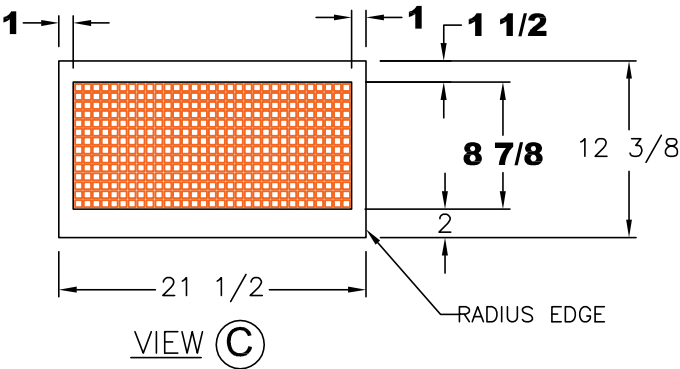
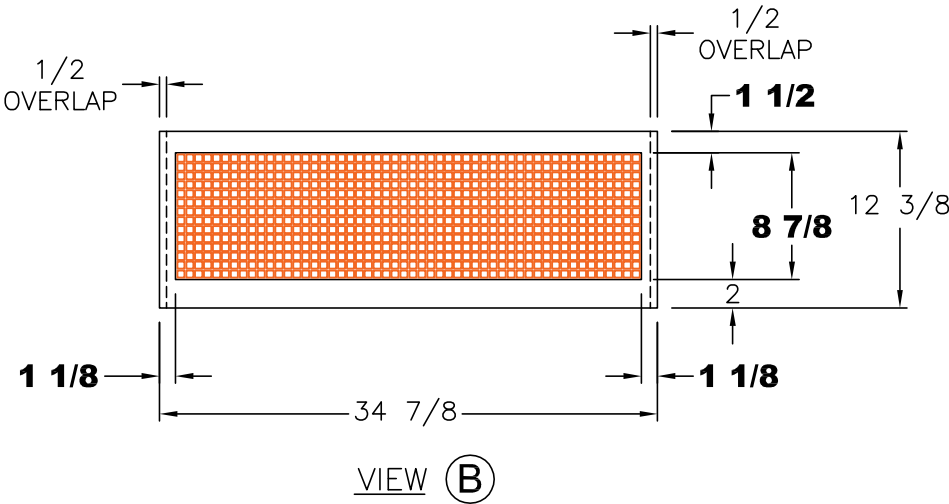
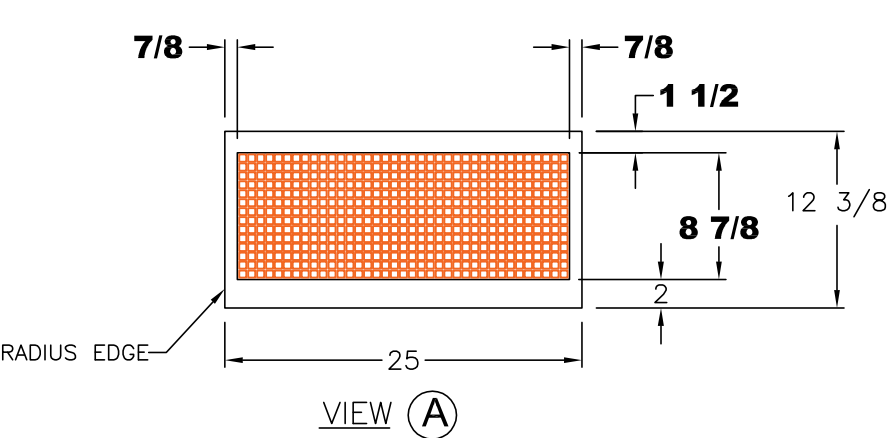

UNIT: # 606005
DEALER: Daves RV Center
SPECIAL: # 1390

1/2" SOLID SURFACE
SHADED DENOTES 3/8"
RECESS FOR TILE INLAY

<div>NEWMAR CORP</div> <div>P.O. Box 30,</div> <div>Nappanee, IN. 46550</div> <div>UNITS: INCHES</div> <div>TITLE BLOCK: 1TB</div>	Model:	Sheet	Drawn by:	Checked by:	Revision:	By:
	DS DP 3736	1 OF 1	Z. R.	A. M.		Date:
	Title:	I.D. # 2016\	Date:	Date:	Revision:	By:
	LAV BASE/TOP/SPLASH	SPECIALS\MOT\1390LV1	2/8/16	2/9/16		Date:

NOTE: ALL DIMENSIONS POINT TO TILE
GEOMETRY EXCEPT WHERE NOTED

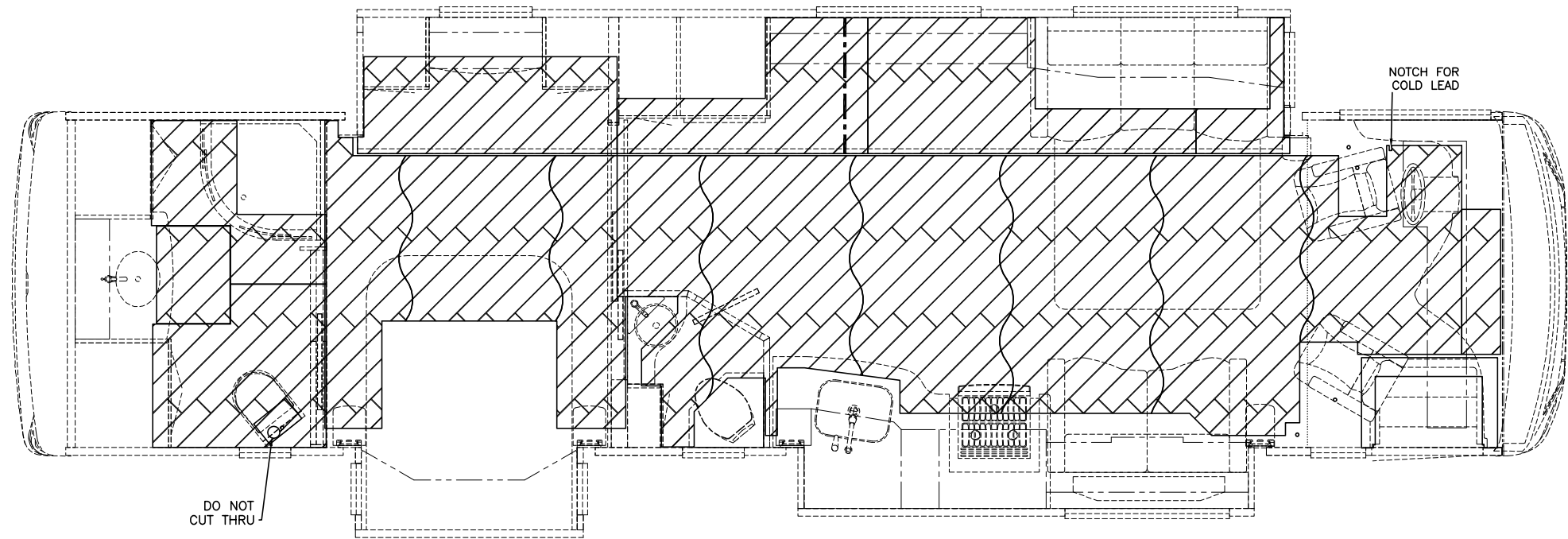

USE PART #84422
TO TRIM AROUND TILE
ON FLOOR AND
ENGINE COVER TILE
1/16" GAP TYP.

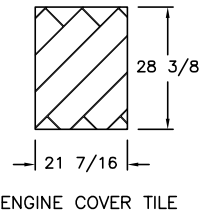

ENGINE COVER TILE

2016 EX DP TILE

5 13/16 x 35 3/16

PLEASE ACKNOWLEDGE AND DATE THE
FOLLOWING ORDER/PRINT FOR APPROVAL
TO BUILD, AND FAX TO NEWMAR (AT
574-773-2895) AS SOON AS POSSIBLE
DATE: _____
SIGN: _____

UNIT: # 606005
DEALER: Daves RV Center
SPECIAL: # 1390

NEWMAR CORP <i>P.O. Box 30, Nappanee, IN. 46550</i>	Model:	Sheet	Drawn by:	Checked by:	Revision:	By:
	DS DP 3736	1 OF 1	Z. R.	A. M.		Date:
	Title:	I.D. # 2016\	Date:	Date:	Revision:	By:
	STANDARD TILE LAYOUT	SPECIALS\MOT\1390TILE	2/8/16	2/9/16		Date: