

SIGN: _____

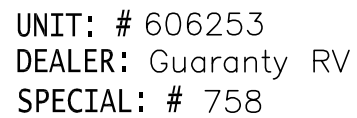

NEWMAR CORP P.O. Box 30, Nappanee, IN. 46550	Model:	(K128)	Sheet	Drawn by:	Checked by:	Revision:	By:
		DS DP 3736	1 OF 1	Z. R.	A. M.		Date:
	Title:	2 ODS RECLINERS AND DS FOLD & TUMBLE	I.D. # 2017\	Date:	Date:	Revision:	By:
			SPECIALS\MOT\	8/11/16	8/16/16		Date:
UNITS: INCHES							
TITLE BLOCK: 75TB							

NOTE: ALL DIMENSIONS POINT TO TILE
GEOMETRY EXCEPT WHERE NOTED

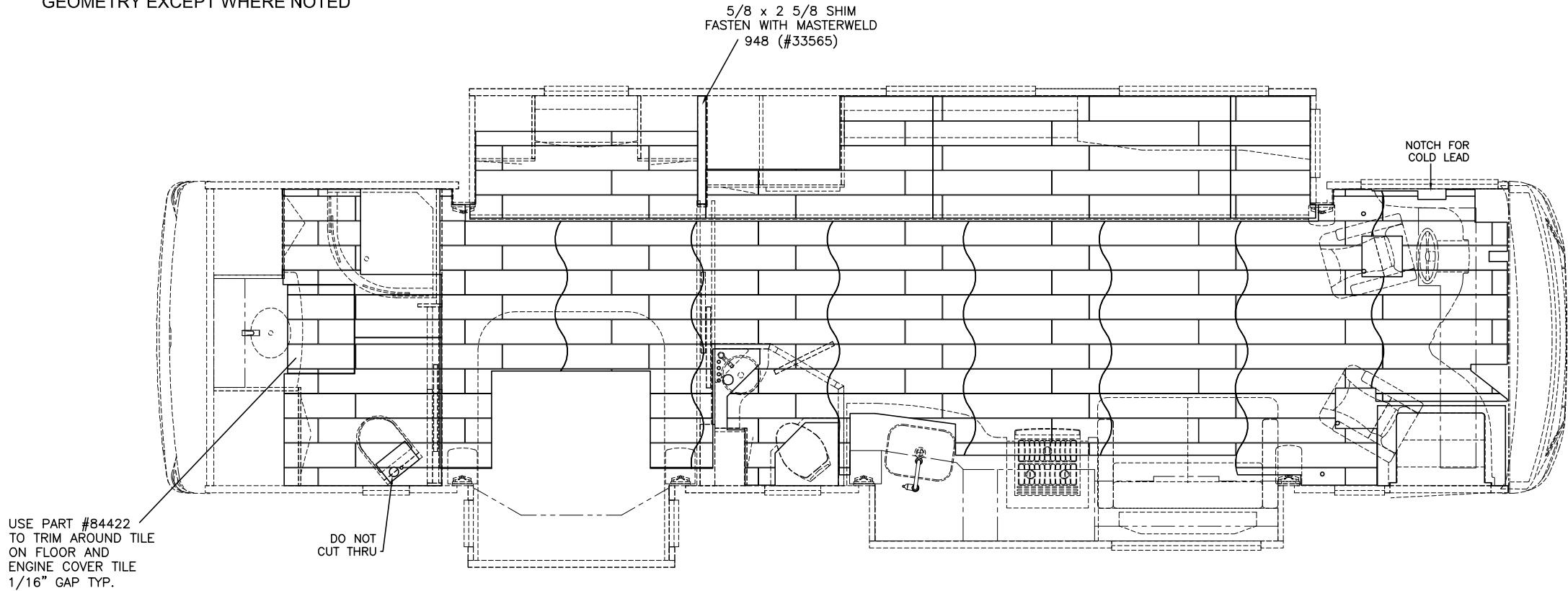

2017 EX DP TILE
7 3/4 x 47

UNIT: # 606253
DEALER: Guaranty RV
SPECIAL: # 758

PLEASE ACKNOWLEDGE AND DATE THE
FOLLOWING ORDER/PRINT FOR APPROVAL
TO BUILD, AND FAX TO NEWMAR (AT
574-773-2895) AS SOON AS POSSIBLE
DATE: _____
SIGN: _____

<div>NEWMAR CORP</div> <div>P.O. Box 30,</div> <div>Nappanee, IN. 46550</div> <div>UNITS: INCHES</div> <div>TITLE BLOCK: 3125TB</div>	Model:	Sheet	Drawn by:	Checked by:	Revision:	By:
	DS DP 3736	1 OF 1	Z. R.	A. M.		Date:
	Title:	I.D. # 2017\	Date:	Date:	Revision:	By:
	STANDARD TILE LAYOUT	SPECIALS\MOT\758TILE	8/11/16	8/16/16		Date: