

PLEASE ACKNOWLEDGE AND DATE THE  
FOLLOWING ORDER/PRINT FOR APPROVAL  
TO BUILD, AND FAX TO NEWMAR (AT  
574-773-2895) AS SOON AS POSSIBLE  
DATE: \_\_\_\_\_  
SIGN: \_\_\_\_\_

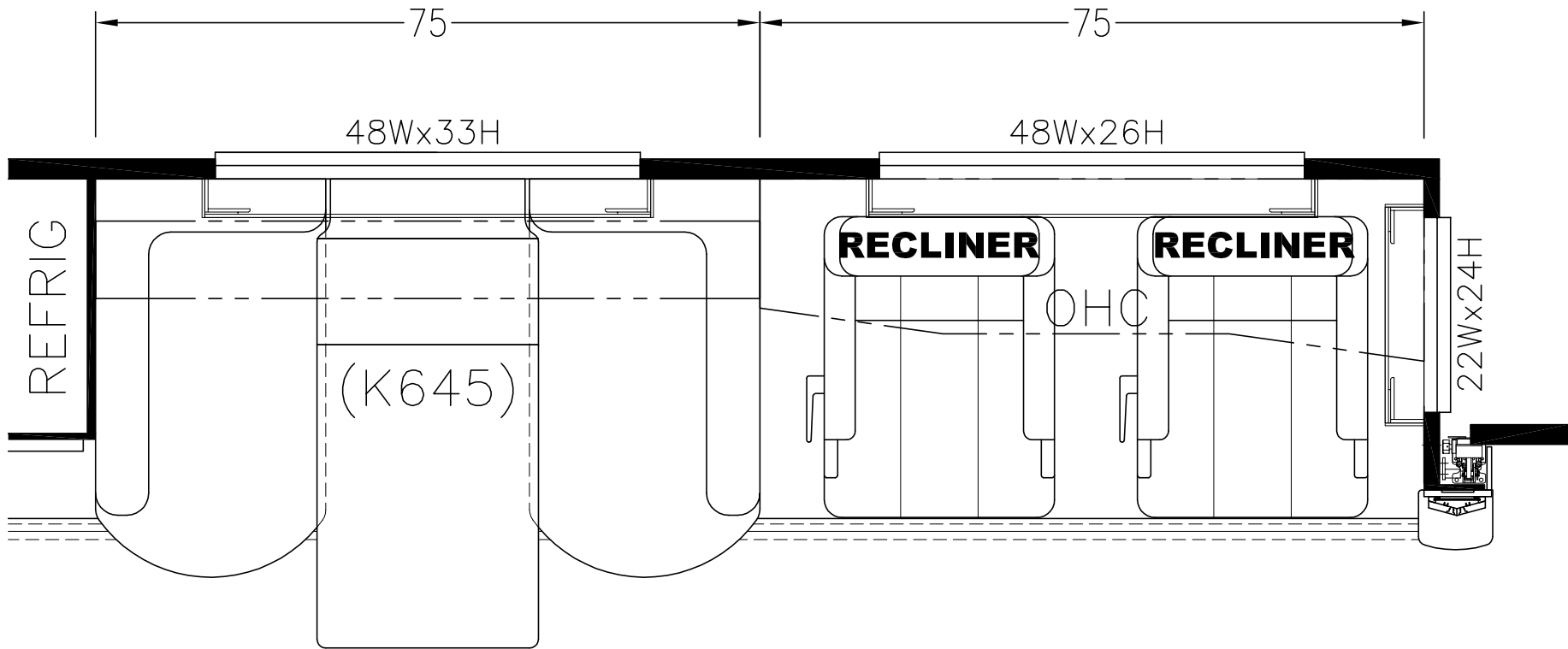

UNIT: # 606304  
DEALER: North Trail RV  
SPECIAL: # 899

<div>NEWMAR CORP</div> <div>P.O. Box 30,</div> <div>Nappanee, IN. 46550</div> <div>UNITS: INCHES</div> <div>TITLE BLOCK: 75TB</div>	Model:	(K645)	Sheet	Drawn by:	Checked by:	Revision:	By:
		DS DP 3736	1 OF 1	Z. R.	A. M.		Date:
	Title:	2 ODS RECLINERS AND	I.D. # 2017\	Date:	Date:	Revision:	By:
		DS FOLD & TUMBLE	SPECIALS\MOT\	9/1/16	9/1/16		Date:
			899FP				

NOTE: ALL DIMENSIONS POINT TO TILE  
GEOMETRY EXCEPT WHERE NOTED

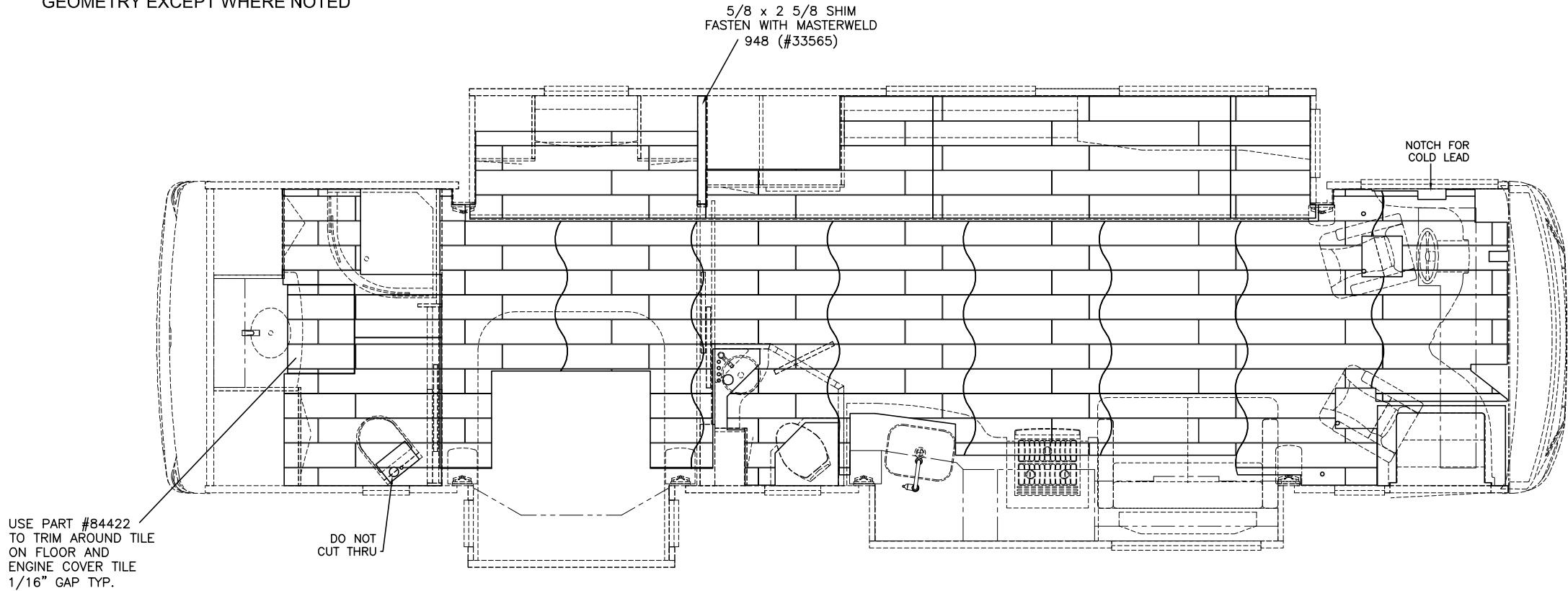

**2017 EX DP TILE**  
**7 3/4 x 47**

UNIT: # 606304  
DEALER: North Trail RV  
SPECIAL: # 899

PLEASE ACKNOWLEDGE AND DATE THE  
FOLLOWING ORDER/PRINT FOR APPROVAL  
TO BUILD, AND FAX TO NEWMAR (AT  
574-773-2895) AS SOON AS POSSIBLE  
DATE: \_\_\_\_\_  
SIGN: \_\_\_\_\_

<div>NEWMAR CORP</div> <div>P.O. Box 30,</div> <div>Nappanee, IN. 46550</div> <div>UNITS: INCHES</div> <div>TITLE BLOCK: 3125TB</div>	Model:	Sheet	Drawn by:	Checked by:	Revision:	By:
	DS DP 3736	1 OF 1	Z. R.	A. M.		Date:
	Title:	I.D. # 2017\	Date:	Date:	Revision:	By:
	STANDARD TILE LAYOUT	SPECIALS\MOT\899TILE	9/1/16	9/1/16		Date: