

PLEASE ACKNOWLEDGE AND DATE THE
FOLLOWING ORDER/PRINT FOR APPROVAL
TO BUILD, AND FAX TO NEWMAR (AT
574-773-2895) AS SOON AS POSSIBLE
DATE: _____
SIGN: _____

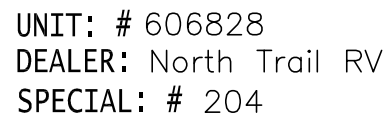

NEWMAR CORP P.O. Box 30, Nappanee, IN. 46550	Model: (T360)	Sheet 1 OF 1	Drawn by: Z. R.	Checked by: A. M.	Revision:	By:
	DS DP 3736					Date:
UNITS: INCHES	Title: KITCHEN BACKSPLASH	I.D. # 2018\ SPECIALS\MOT\ 204KT	Date: 5/10/17	Date: 5/10/17	Revision:	By:
TITLE BLOCK: 75TB						Date:

2018 NA DP BACKSPLASH TILE

PLEASE ACKNOWLEDGE AND DATE THE FOLLOWING ORDER/PRINT FOR APPROVAL TO BUILD, AND FAX TO NEWMAR (AT 574-773-2895) AS SOON AS POSSIBLE
DATE: _____
SIGN: _____

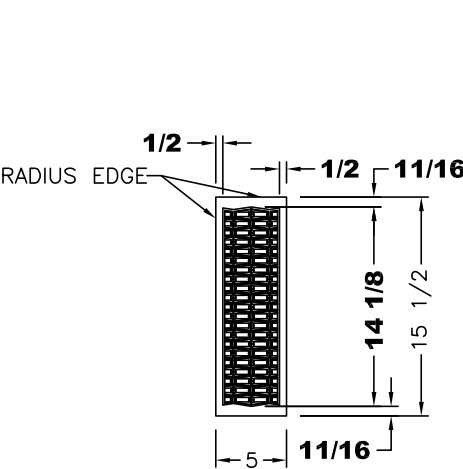

VIEW A

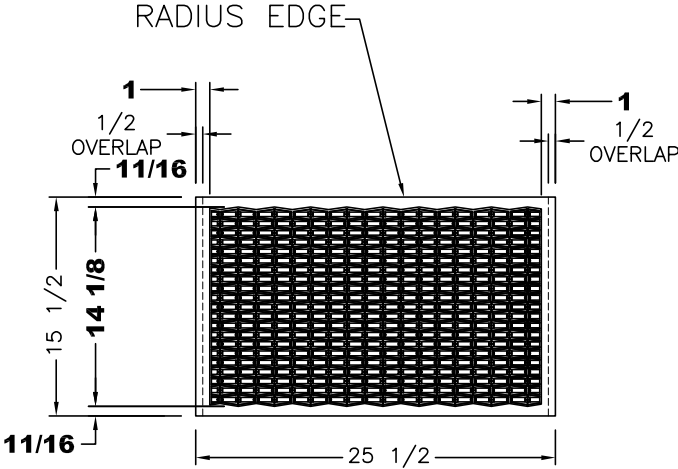

VIEW B

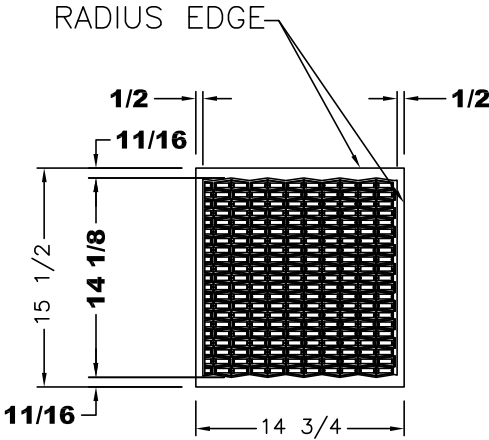

VIEW C

**SOLID DENOTES 1/4"
RECESS FOR TILE INLAY**

UNIT: # 606828
DEALER: North Trail RV
SPECIAL: # 204

<div>NEWMAR CORP</div> <div>P.O. Box 30,</div> <div>Nappanee, IN. 46550</div> <div>UNITS: INCHES</div> <div>TITLE BLOCK: 1TB</div>	Model:	Sheet	Drawn by:	Checked by:	Revision:	By:
	DS DP 3736	1 OF 1	Z. R.	A. M.		Date:
	Title:	I.D. # 2018\	Date:	Date:	Revision:	By:
	25 1/2 LAV BASE & TOP	SPECIALS\MOT\204LV	5/10/17	5/10/17		Date:

2018 NA DP BACKSPLASH TILE

PLEASE ACKNOWLEDGE AND DATE THE FOLLOWING ORDER/PRINT FOR APPROVAL TO BUILD, AND FAX TO NEWMAR (AT 574-773-2895) AS SOON AS POSSIBLE
DATE: _____
SIGN: _____

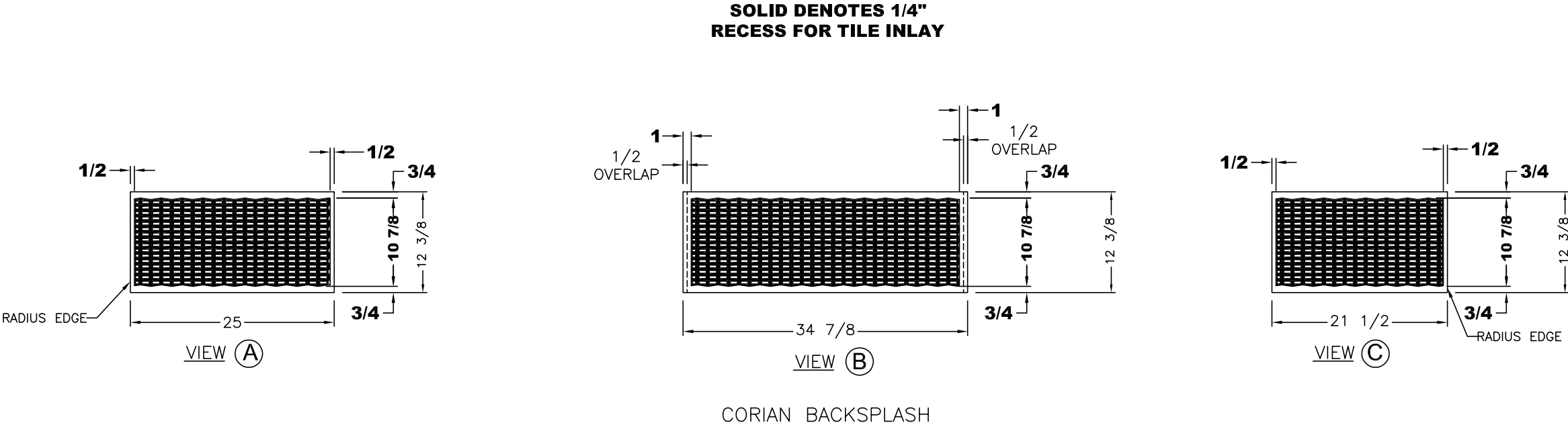

UNIT: # 606828
DEALER: North Trail RV
SPECIAL: # 204

<div>NEWMAR CORP</div> <div>P.O. Box 30,</div> <div>Nappanee, IN. 46550</div> <div>UNITS: INCHES</div> <div>TITLE BLOCK: 1TB</div>	Model:	Sheet	Drawn by:	Checked by:	Revision:	By:
	DS DP 3736	1 OF 1	Z. R.	A. M.		Date:
	Title:	I.D. # 2018\	Date:	Date:	Revision:	By:
	35 3/4 LAV BASE & TOP	SPECIALS\MOT\204LV1	5/10/17	5/10/17		Date:

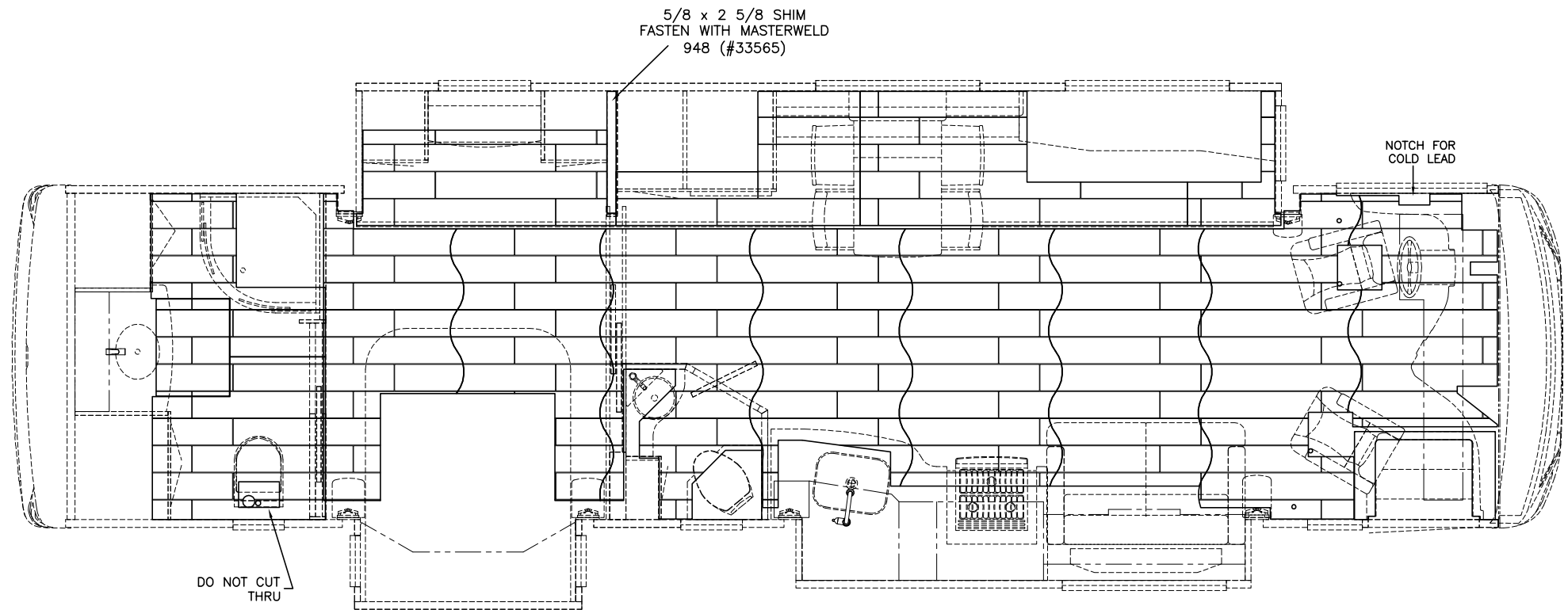

2018 EX DP TILE 7 3/4 x 47

PLEASE ACKNOWLEDGE AND DATE THE FOLLOWING ORDER/PRINT FOR APPROVAL TO BUILD, AND FAX TO NEWMAR (AT 574-773-2895) AS SOON AS POSSIBLE
DATE: _____
SIGN: _____

UNIT: # 606828
DEALER: North Trail RV
SPECIAL: # 204

NEWMAR CORP <i>P.O. Box 30, Nappanee, IN. 46550</i>	Model:	Sheet	Drawn by:	Checked by:	Revision:	By:
	DS DP 3736	1 OF 1	Z. R.	A. M.		Date:
	Title:	I.D. # 2018\	Date:	Date:	Revision:	By:
	STANDARD TILE LAYOUT	SPECIALS\MOT\204TILE	5/10/17	5/10/17		Date:
UNITS: INCHES						
TITLE BLOCK: 3125TB						