

PLEASE ACKNOWLEDGE AND DATE THE FOLLOWING ORDER/PRINT FOR APPROVAL TO BUILD, AND FAX TO NEWMAR (AT 574-773-2895) AS SOON AS POSSIBLE
DATE: _____
SIGN: _____

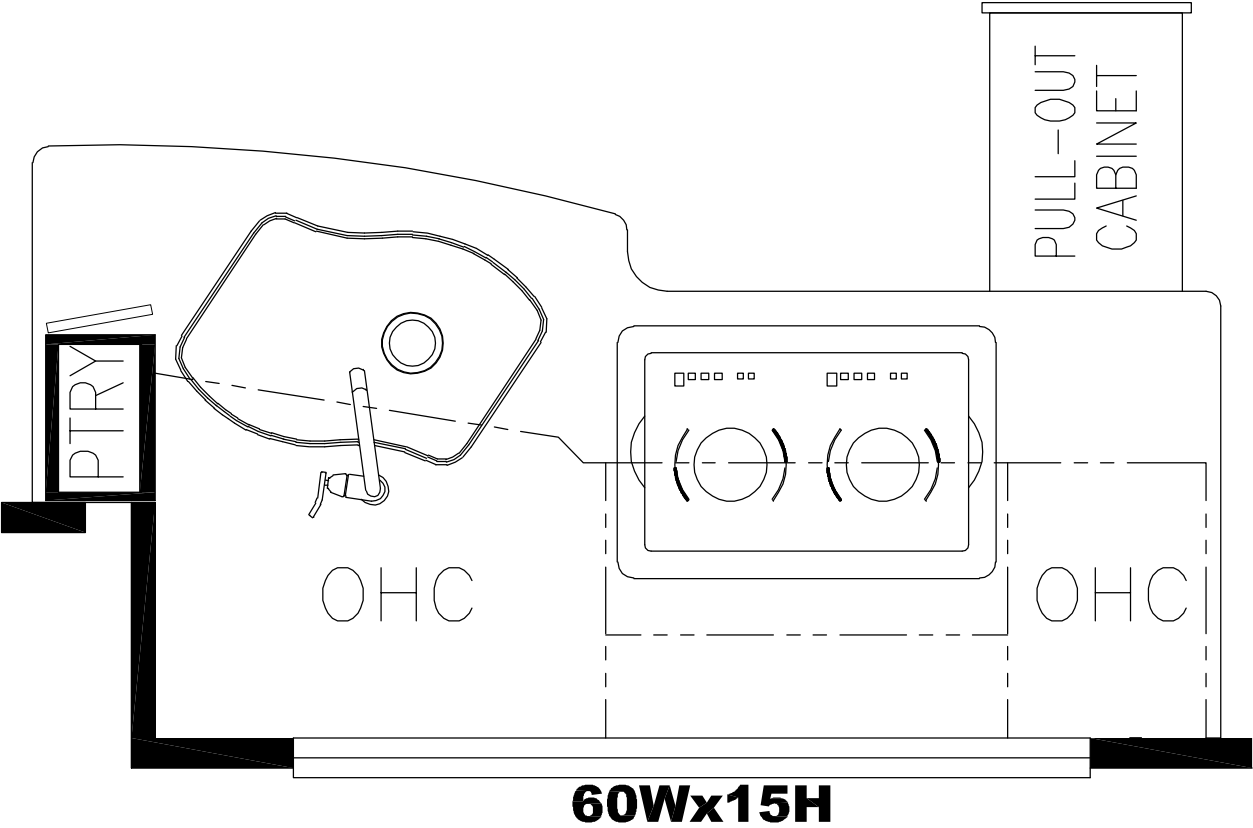

UNIT: # 801310
DEALER: TRANSWEST TRUCK
SPECIAL: # 373

<div>NEWMAR CORP</div> <div>P.O. Box 30,</div> <div>Nappanee, IN. 46550</div> <div>UNITS: INCHES</div> <div>TITLE BLOCK: 3125TB</div>	Model:	Sheet	Drawn by:	Checked by:	Revision:	By:
	EX DP 4579	1 OF 1	R. N.	Z. R.		Date:
	Title:	I.D. # 2019\	Date:	Date:	Revision:	By:
	FLOOR PLAN	SPECIALS\MOT\373FP	4/19/18	4/19/18		Date:

OMIT GALLEY SHELF ON COUNTERTOP

PLEASE ACKNOWLEDGE AND DATE THE
FOLLOWING ORDER/PRINT FOR APPROVAL
TO BUILD, AND FAX TO NEWMAR (AT
574-773-2895) AS SOON AS POSSIBLE
DATE: _____
SIGN: _____

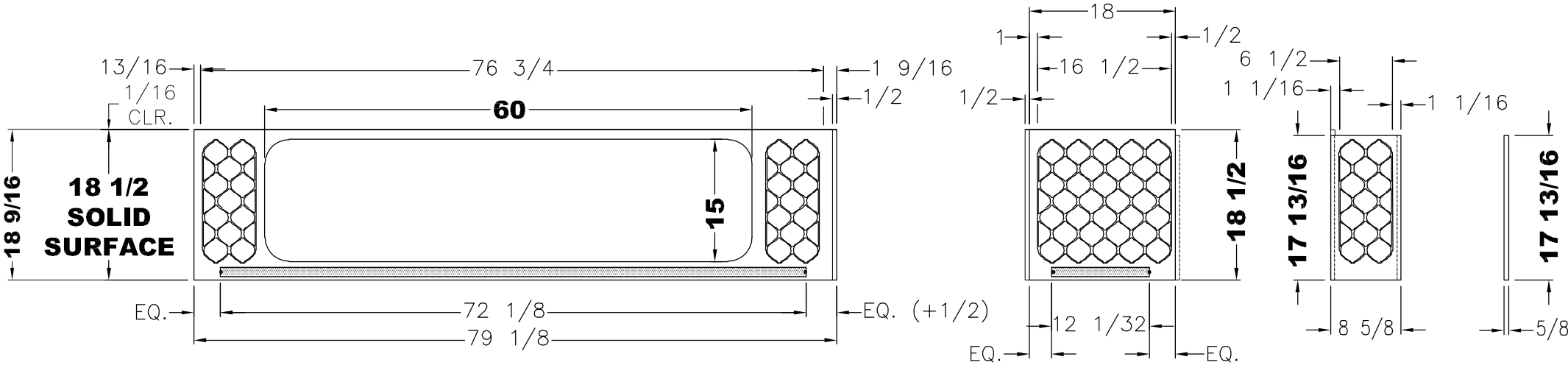

SHADED DENOTES 3/8”
RECESS FOR TILE INLAY

UNIT: # 801310
DEALER: TRANSWEST TRUCK
SPECIAL: # 373

<div>NEWMAR CORP</div> <div>P.O. Box 30,</div> <div>Nappanee, IN. 46550</div> <div>UNITS: INCHES</div> <div>TITLE BLOCK: 75TB</div>	Model:	Sheet	Drawn by:	Checked by:	Revision:	By:
	EX DP 4579	1 OF 1	R. N.	Z. R.		Date:
	Title:	I.D. # 2019\	Date:	Date:	Revision:	By:
	KITCHEN BACKSPLASH	SPECIALS\MOT\373KT	4/19/18	4/19/18		Date:

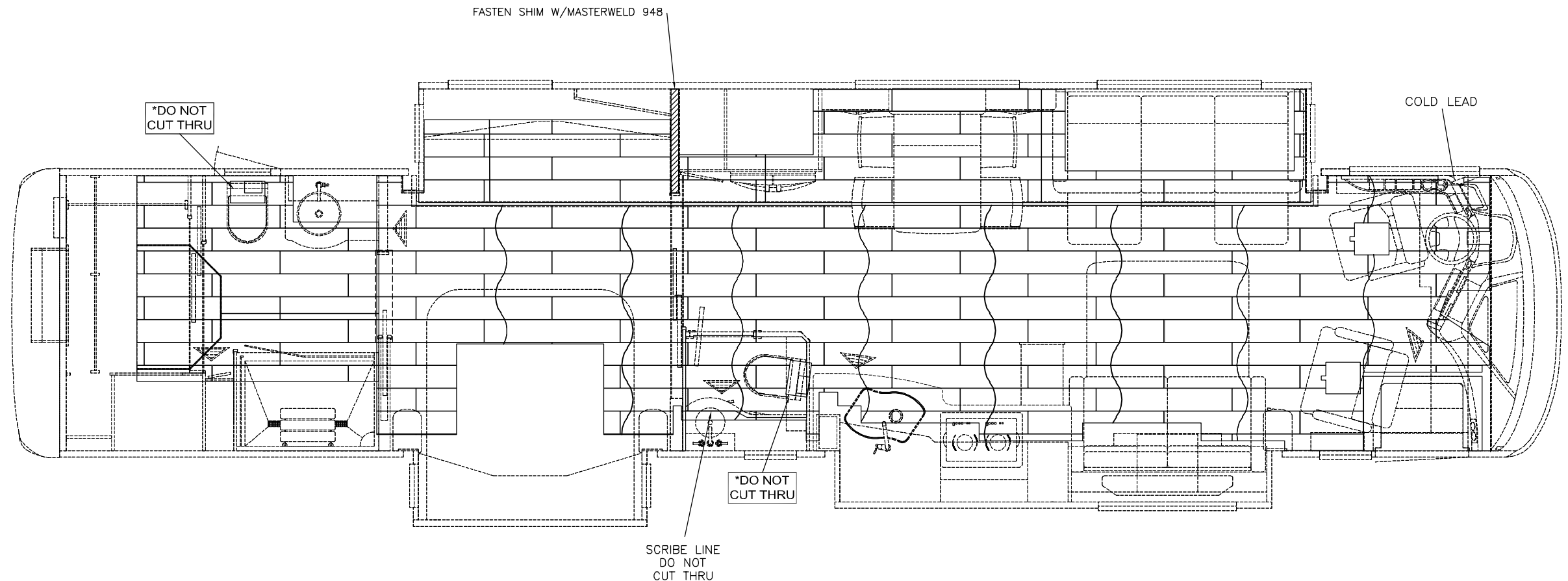

2019 KG DB TILE 7 3/4 x 47

UNIT: # 801310
DEALER: Transwest Truck
SPECIAL: # 373

PLEASE ACKNOWLEDGE AND DATE THE
FOLLOWING ORDER/PRINT FOR APPROVAL
TO BUILD, AND FAX TO NEWMAR (AT
574-773-2895) AS SOON AS POSSIBLE
DATE: _____
SIGN: _____

NEWMAR CORP P.O. Box 30, Nappanee, IN. 46550 UNITS: INCHES TITLE BLOCK: 3125TB	Model:	Sheet	Drawn by:	Checked by:	Revision:	By:
	EX DP 4579	1 OF 1	R. N.	Z. R.		Date:
	Title:	I.D. # 2019\	Date:	Date:	Revision:	By:
	TILE LAYOUT	SPECIALS\MOT\373TILE	4/19/18	4/19/18		Date: