

# 2016 KG DB KITCHEN TILE

**ROUT TILE OPENINGS**  
**3/8" DEEP**

PLEASE ACKNOWLEDGE AND DATE THE FOLLOWING ORDER/PRINT FOR APPROVAL TO BUILD, AND FAX TO NEWMAR (AT 574-773-2895) AS SOON AS POSSIBLE  
DATE: \_\_\_\_\_  
SIGN: \_\_\_\_\_

UNIT: # 904466  
DEALER: Midway RV Center  
SPECIAL: # 1550

<b>NEWMAR CORP</b> <i>P.O. Box 30, Nappanee, IN. 46550</i>	Model:	Sheet	Drawn by:	Checked by:	Revision:	By:
	MA DP 4519	1 OF 1	Z. R.	A. M.		Date:
	Title:	I.D. # 2016\	Date:	Date:	Revision:	By:
	SOLID SURFACE SHOWER WALLS	SPECIALS\MOT\1550SHWR	4/1/16	4/1/16		Date:

2016 KG DB KITCHEN TILE

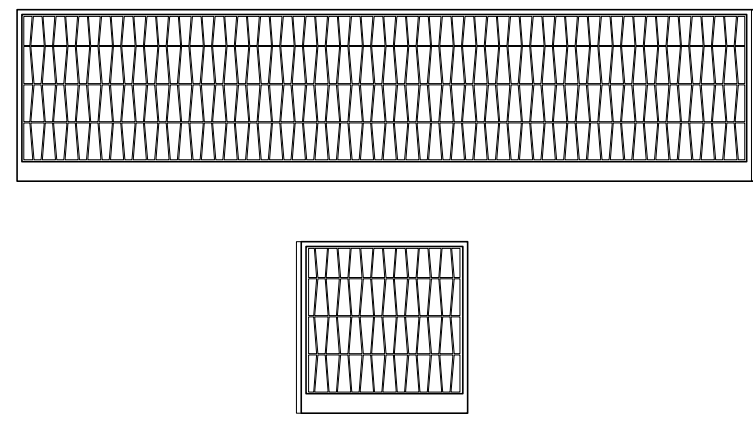
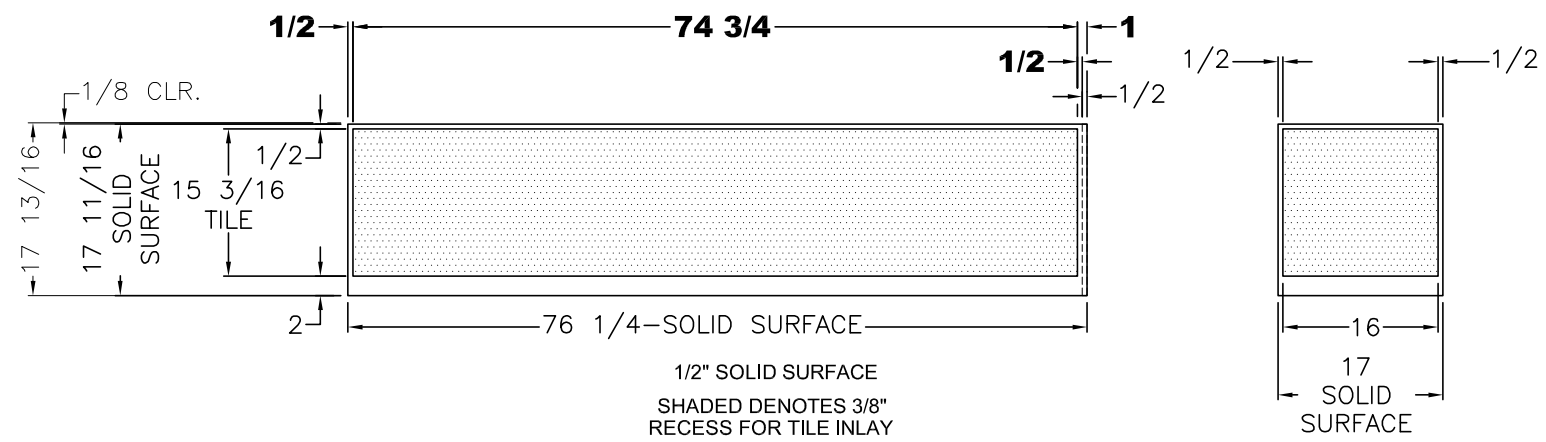

KITCHEN BASE BACK SPLASH

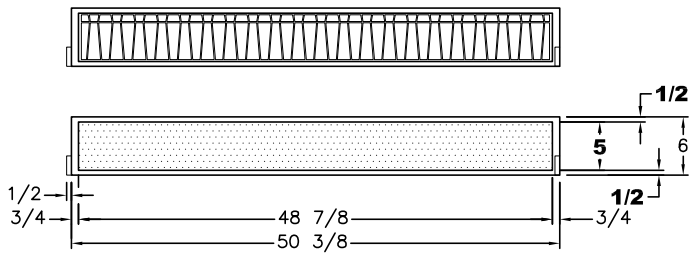
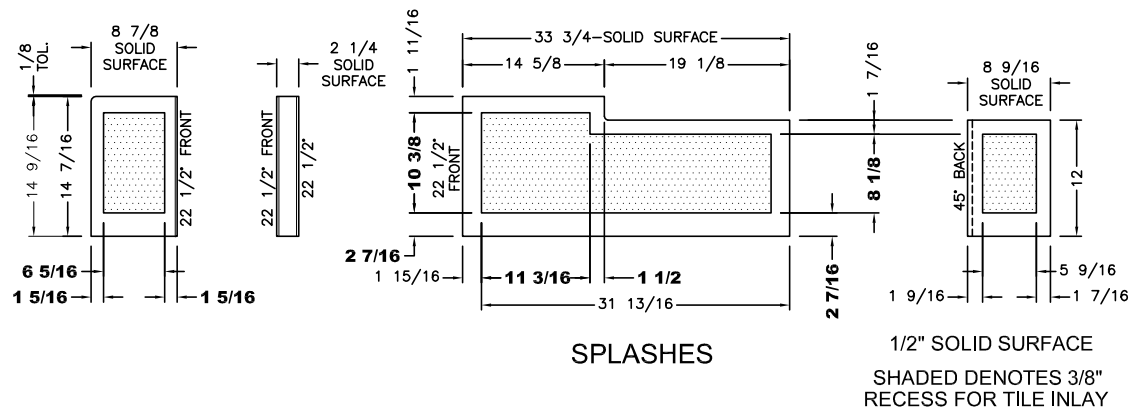

REAR BATH BACK SPLASH

SHADED DENOTES 3/8" RECESS FOR TILE INLAY

PLEASE ACKNOWLEDGE AND DATE THE FOLLOWING ORDER/PRINT FOR APPROVAL TO BUILD, AND FAX TO NEWMAR (AT 574-773-2895) AS SOON AS POSSIBLE  
DATE: \_\_\_\_\_  
SIGN: \_\_\_\_\_

STOOL ROOM BACK SPLASH

UNIT: # 904466  
DEALER: Midway RV Center  
SPECIAL: # 1550

NEWMAR CORP P.O. Box 30, Nappanee, IN. 46550	Model:	Sheet	Drawn by:	Checked by:	Revision:	By:
	MA DP 4519	1 OF 1	Z. R.	A. M.		Date:
	Title: KIT AND BATH	I.D. # 2016\	Date:	Date:	Revision:	By:
	BACK SPLASHES	SPECIALS\MOT\	4/1/16	4/1/16		Date:
		1550SPLASH				

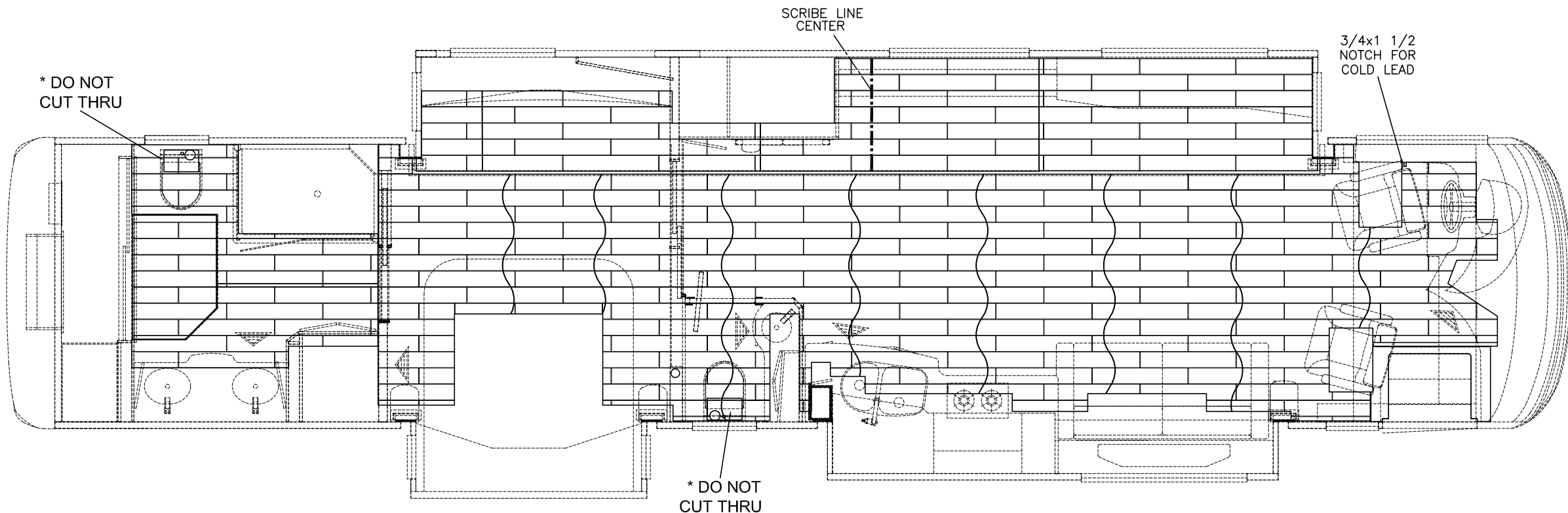

NOTE: ALL PANELS AT 47 3/4 WIDE  
UNLESS SPECIFIED OTHERWISE

## 2016 KG DB TILE

### 32 7/8 x 5 3/8

PLEASE ACKNOWLEDGE AND DATE THE  
FOLLOWING ORDER/PRINT FOR APPROVAL  
TO BUILD, AND FAX TO NEWMAR (AT  
574-773-2895) AS SOON AS POSSIBLE  
DATE: \_\_\_\_\_  
SIGN: \_\_\_\_\_

UNIT: # 904466  
DEALER: Midway RV Center  
SPECIAL: # 1550

<b>NEWMAR CORP</b> <i>P.O. Box 30, Nappanee, IN. 46550</i>	Model:	(K049)	Sheet	Drawn by:	Checked by:	Revision:	By:
		MA DP 4519	1 OF 1	Z. R.	A. M.		Date:
	Title:		I.D. # 2016\	Date:	Date:	Revision:	By:
		STANDARD TILE LAYOUT	SPECIALS\MOT\	4/1/16	4/1/16		Date:
	UNITS: INCHES		1550TILE				
	TITLE BLOCK: 3125TB						