

NEWMAR CORPORATION WARRANTY DEPARTMENT

| TECHNICAL SERVICE BULLETIN | | | | | | | |
|--|-------------------------------------|------------------------|--------------------------|-------------------|--------------------------|-------|--|
| DATE ISSUED | | MODEL YEAR(S) AFFECTED | | MODEL(S) AFFECTED | | TSB # | |
| 1/15/08 | | 2008 | | All Star ME | | 328 | |
| BRAND | | | | | | TYPE | |
| All | <input type="checkbox"/> | American Star | <input type="checkbox"/> | Mountain Aire | <input type="checkbox"/> | All | <input type="checkbox"/> T T <input type="checkbox"/> |
| Cypress | <input type="checkbox"/> | Dutch Star | <input type="checkbox"/> | Kountry Aire | <input type="checkbox"/> | F W | <input type="checkbox"/> C A <input type="checkbox"/> |
| Northern Star | <input type="checkbox"/> | Kountry Star | <input type="checkbox"/> | Essex | <input type="checkbox"/> | D P | <input checked="" type="checkbox"/> D B <input type="checkbox"/> |
| Scottsdale | <input type="checkbox"/> | King Aire | <input type="checkbox"/> | London Aire | <input type="checkbox"/> | | |
| All Star ME | <input checked="" type="checkbox"/> | Ventana | <input type="checkbox"/> | | | | |
| <div style="display: flex; justify-content: space-between;"> <div> <input type="checkbox"/> Air Conditioning & Heating <input type="checkbox"/> Appliances & Accessories <input type="checkbox"/> Cabinets & Furniture <input checked="" type="checkbox"/> Chassis Components <input type="checkbox"/> Construction Components </div> <div> <input type="checkbox"/> Electrical Components <input type="checkbox"/> Exterior Components <input type="checkbox"/> Interior Components <input type="checkbox"/> Plumbing & Bath Components <input type="checkbox"/> Windows, Awnings, Vents, & Doors </div> </div> | | | | | | | |
| DESCRIPTION OF PROBLEM | | | | | | | |
| <p>Poor ride quality on All Star ME chassis equipped with Airtek front suspension.</p> | | | | | | | |
| RECOMMENDED SOLUTION | | | | | | | |
| <p>Replacement of front shock absorbers. Spartan procedure for replacement of the shocks is attached; be sure to READ THE ATTACHED PROCEDURE PRIOR TO BEGINNING REPAIRS. Contact Spartan Motors regarding any questions you may have on this Technical Service Bulletin.</p> | | | | | | | |



SPARTAN CHASSIS, INC.

TSB07-250-002

December 19, 2007

Page 1 of 3

TECHNICAL SERVICE BULLETIN

SUBJECT: Front Suspension – Shock(s)

APPLIES TO: Certain 2008 Newmar Allstars produced with an Airtek front suspension having a VDM between December 8, 2006 and November 1, 2007.

CONDITION: The shocks on the Airtek front suspension produce an unacceptable ride of the coach.

PLEASE READ THE ENTIRE BULLETIN BEFORE PROCEEDING WITH ANY WORK. CONTACT SPARTAN CHASSIS IF THERE ARE ANY CONCERNS WITH THE PROCEDURES CONTAINED IN THIS DOCUMENT

PARTS/SERVICE INFORMATION:

Labor Time: 1.5 hours

| <u>QTY</u> | <u>Kit Part Number/Description:</u> |
|-------------------|--|
|-------------------|--|

| | |
|---|---|
| 1 | S-1921 – Shock Absorber Replacement Kit |
|---|---|

| <u>QTY</u> | <u>Service kit contains:</u> |
|-------------------|-------------------------------------|
|-------------------|-------------------------------------|

| | |
|---|---|
| 2 | 0499-SS5-003 – Shock Absorber |
| 4 | 12FWUSS8Y – ¾ Flat Washer |
| 1 | TSB07-250-002 – Removal and Installation Instructions |

Technical Service Bulletins are intended for use by Professional Technicians only. They are written to guide Professional Technicians in performing service to vehicles of product specific nature in conjunction with industry standards. Professional Technicians are appropriately trained on industry standards and have the tools and equipment to perform procedures safely and properly.



SPARTAN CHASSIS, INC.

TSB07-250-002

December 19, 2007

Page 2 of 3

TECHNICAL SERVICE BULLETIN

STEP-BY-STEP INSTRUCTIONS:

1. Observe all industry safety standards while proceeding with the instructions of this bulletin.
2. Locate the driver side front suspension shock absorber.
3. Using appropriate tool, remove the nut from the lower shock absorber mounting bolt. Retain the nut for reuse.
4. Remove the bolt from the shock absorber. Discard the outer most flat washer. Retain the fastener and the inner most flat washer.
5. Remove the upper mounting fastener from the shock absorber. Retain hardware for reuse.
6. Discard shock absorber.
7. Remove new shock absorber from service kit. Install upper end of shock absorber per the illustration provided in Figure 1-1, utilizing appropriate hardware. Tighten fastener but do not tighten to final torque.
8. Attach the lower end of the shock absorber to the lower mounting bracket using the appropriate fastener and inner flat washer that was previously removed.
9. Install 2 new flat washers per the illustration, provided in the service kit. One on each side of the shock absorber eye must be installed.
10. Tighten the lower mounting hardware but do not tighten to final torque.
11. After shock absorber is installed and secured, using an appropriate tool, torque both the upper and lower shock mounting fasteners to 240 lbs ft. from the nut side.
12. For the passenger side, repeat steps 3 thru 11.

Technical Service Bulletins are intended for use by Professional Technicians only. They are written to guide Professional Technicians in performing service to vehicles of product specific nature in conjunction with industry standards. Professional Technicians are appropriately trained on industry standards and have the tools and equipment to perform procedures safely and properly.



SPARTAN CHASSIS, INC.

TSB07-250-002

December 19, 2007

Page 3 of 3

TECHNICAL SERVICE BULLETIN

Figure 1-1:

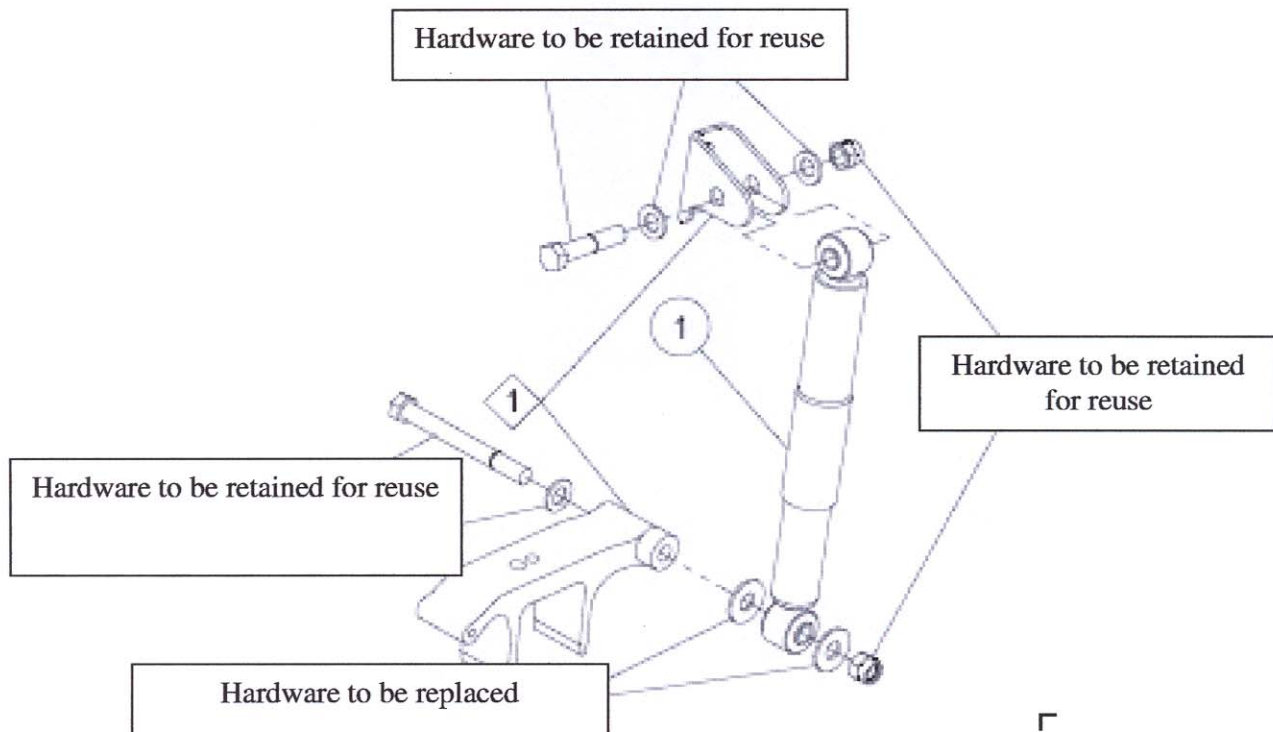

Technical Service Bulletins are intended for use by Professional Technicians only. They are written to guide Professional Technicians in performing service to vehicles of product specific nature in conjunction with industry standards. Professional Technicians are appropriately trained on industry standards and have the tools and equipment to perform procedures safely and properly.