

# Newmar Corporation

## Warranty Department

### Technical Service Bulletin

Date Issued	Model Year(s) Affected	Model(s) Affected	TSB #										
04/30/2010	2007-2009	EXDP, MADP, DADP, DSDP	371										
Brand			Type										
All <input type="checkbox"/>	American Star <input type="checkbox"/>	Mountain Aire <input checked="" type="checkbox"/>	All <input type="checkbox"/> T T <input type="checkbox"/>										
Cypress <input type="checkbox"/>	Dutch Star <input checked="" type="checkbox"/>	Kountry Aire <input type="checkbox"/>	FW <input type="checkbox"/> C A <input type="checkbox"/>										
Northern Star <input type="checkbox"/>	Kountry Star <input type="checkbox"/>	Essex <input checked="" type="checkbox"/>	DP <input checked="" type="checkbox"/> DB <input type="checkbox"/>										
Scottsdale <input type="checkbox"/>	King Aire <input type="checkbox"/>	London Aire <input type="checkbox"/>											
All Star ME <input type="checkbox"/>	Ventana <input type="checkbox"/>	Bay Star <input type="checkbox"/>											
<table border="0"><tr><td><input type="checkbox"/> Air Conditioning &amp; Heating</td><td><input type="checkbox"/> Electrical Components</td></tr><tr><td><input type="checkbox"/> Appliances &amp; Accessories</td><td><input type="checkbox"/> Exterior Components</td></tr><tr><td><input type="checkbox"/> Cabinets &amp; Furniture</td><td><input type="checkbox"/> Interior Components</td></tr><tr><td><input checked="" type="checkbox"/> Chassis Components</td><td><input type="checkbox"/> Plumbing &amp; Bath Components</td></tr><tr><td><input type="checkbox"/> Construction Components</td><td><input type="checkbox"/> Windows, Awnings, Vents, &amp; Doors</td></tr></table>				<input type="checkbox"/> Air Conditioning & Heating	<input type="checkbox"/> Electrical Components	<input type="checkbox"/> Appliances & Accessories	<input type="checkbox"/> Exterior Components	<input type="checkbox"/> Cabinets & Furniture	<input type="checkbox"/> Interior Components	<input checked="" type="checkbox"/> Chassis Components	<input type="checkbox"/> Plumbing & Bath Components	<input type="checkbox"/> Construction Components	<input type="checkbox"/> Windows, Awnings, Vents, & Doors
<input type="checkbox"/> Air Conditioning & Heating	<input type="checkbox"/> Electrical Components												
<input type="checkbox"/> Appliances & Accessories	<input type="checkbox"/> Exterior Components												
<input type="checkbox"/> Cabinets & Furniture	<input type="checkbox"/> Interior Components												
<input checked="" type="checkbox"/> Chassis Components	<input type="checkbox"/> Plumbing & Bath Components												
<input type="checkbox"/> Construction Components	<input type="checkbox"/> Windows, Awnings, Vents, & Doors												
Description of Problem													
Certain Spartan Motors Chassis, Inc. Motor homes equipped with a Tuthill 1460 or 1660 IFS front axle having a VDM (Vehicle Date of Manufacture) of May 3, 2007 through August 27, 2009 have experienced Shock eye wall fracture.													
Recommended Solution													
Please read the entire 2 pages of the Spartan Technical Service Bulletin #TSB10-250-001 before proceeding with any work repair. Contact Spartan Chassis if there are any concerns with the procedures contained in this document.													

If you have any questions regarding this T.S.B., please contact a Warranty Service Representative at Newmar Corporation.

# SPARTAN MOTORS CHASSIS, INC.



**TSB10-250-001**

February, 2010

Page 1 of 2

## **TECHNICAL SERVICE BULLETIN**

---

**SUBJECT:** Front Suspension – Shock Eye

**APPLIES TO:** Certain Spartan Chassis Inc, Motorhomes equipped with a Tuthill 1460 or 1660 IFS front axle having a VDM (Vehicle Date of Manufacturing) May 3, 2007 through August 27, 2009

**CONDITION:** Shock eye wall fracture

**PLEASE READ THE ENTIRE BULLETIN BEFORE PROCEEDING WITH ANY WORK. CONTACT SPARTAN CHASSIS IF THERE ARE ANY CONCERNS WITH THE PROCEDURES CONTAINED IN THIS DOCUMENT.**

### **PART / SERVICE INFORMATION:**

**Labor Time: 1.50 Hrs.**

<b><u>QTY.</u></b>	<b><u>Part Number</u></b>	<b><u>Description</u></b>
1	S-2225-001	Kit- Bilstein Shock IFS1460 & 1660

**Kit # S-2225-001 Contains:**

<b><u>QTY.</u></b>	<b><u>Part Number</u></b>	<b><u>Description</u></b>
2	0924-DD1-801011	Bilstein Shock
1	TSB10-250-001	Document Instructions

### **STEP-BY-STEP INSTRUCTIONS:**

1. Observe all industry safety standards, disconnect any necessary power source, and secure vehicle for replacing front shock(s).

**NOTE: The shock absorber is gas pressurized and must not be punctured or be subjected to excessive heat which can result in serious personal injury. The shock will expand to its full extended length if not restrained.**

2. Refer to FIG. 2-1. Remove lower shock thru bolt and retain for installation. Do not remove lower shock mount bracket from lower control arm.

Technical Service Bulletins are intended for use by Professional Technicians only. They are written to guide Professional Technicians in performing service to vehicles of product specific nature in conjunction with industry standards. Professional Technicians are appropriately trained on industry standards and have the tools and equipment to perform procedures safely and properly.

# SPARTAN MOTORS CHASSIS, INC.



TSB10-250-001

February, 2010

Page 2 of 2

## TECHNICAL SERVICE BULLETIN

3. Refer to FIG. 2-1. Remove upper shock bushing mounting hardware and retain for installation. Shock(s) must be returned to Spartan Chassis Inc. for reimbursement.
4. Position shock in suspension such that the thru bolt is connected to the lower shock mounting bracket tabs.
5. Attach upper shock bushing to suspension subframe with mounting hardware. Do not tighten.
6. Refer to FIG. 2-1. Attach lower shock bar pin to lower mounting bracket with mounting hardware. Tighten lower thru mounting bolt and nut to 180 lbs. ft. Tighten nuts to 35 lbs. ft.
7. Tighten upper mounting nut to 180 lbs. ft.
8. Repeat steps for opposite side.
9. Reconnect any power source previously disconnected.

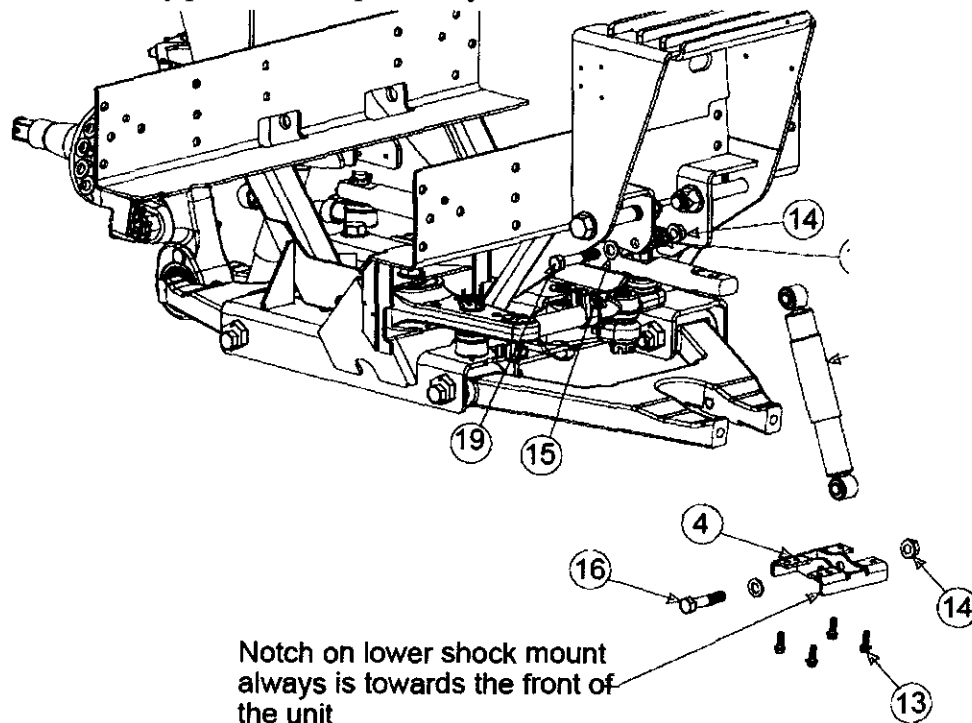

### SHOCK REMOVAL

**FIG. 2-1**

Technical Service Bulletins are intended for use by Professional Technicians only. They are written to guide Professional Technicians in performing service to vehicles of product specific nature in conjunction with industry standards. Professional Technicians are appropriately trained on industry standards and have the tools and equipment to perform procedures safely and properly.